

N. M. OIL CONS. COMMISSION

P. O. BOX 1980

HOBBS, NEW MEXICO 88240

UNITED STATES  
DEPARTMENT OF THE INTERIOR

GEOLOGICAL SURVEY

SUBMIT IN TRIPLICATE\*

(Other instructions on  
reverse side)Form approved.  
Budget Bureau No. 42-R1425.

30-025-27762

5. LEASE DESIGNATION AND SERIAL NO.

NM-15316

6. IF INDIAN, ALLOTTEE OR TRIBE NAME

7. UNIT AGREEMENT NAME

8. FARM OR LEASE NAME

DIPPEL FEDERAL COM

9. WELL NO.

1

10. FIELD AND POOL, OR WILDCAT

UNDESIGNATED MORROW GAS

11. SEC., T., R., M., OR BLK.  
AND SURVEY OR AREA

SEC. 10, T. 22 S., R. 32 E. (ND)

12. COUNTY OR PARISH

LEA

13. STATE

NEW MEXICO

1a. TYPE OF WORK

DRILL ☒DEEPEN ☐PLUG BACK ☐

b. TYPE OF WELL

OIL  
WELL ☐GAS  
WELL ☒

OTHER

SINGLE  
ZONE ☒MULTIPLE  
ZONE ☐

2. NAME OF OPERATOR

UNION OIL COMPANY OF CALIFORNIA

3. ADDRESS OF OPERATOR

P.O. BOX 671, MIDLAND, TEXAS 79702

4. LOCATION OF WELL (Report location clearly and in accordance with any State requirements.)\*

At surface

660' FNL AND 1980' FWL OF SECTION 10

At proposed prod. zone

14. DISTANCE IN MILES AND DIRECTION FROM NEAREST TOWN OR POST OFFICE\*

29 MILES WEST OF EUNICE NEW MEXICO

15. DISTANCE FROM PROPOSED\*

LOCATION TO NEAREST  
PROPERTY OR LEASE LINE, FT.  
(Also to nearest drlg. unit line, if any)

660'

16. NO. OF ACRES IN LEASE

120

17. NO. OF ACRES ASSIGNED  
TO THIS WELL

320

18. DISTANCE FROM PROPOSED LOCATION\*  
TO NEAREST WELL, DRILLING, COMPLETED,  
OR APPLIED FOR, ON THIS LEASE, FT.

-

19. PROPOSED DEPTH

15,100'

20. ROTARY OR CABLE TOOLS

ROTARY

21. ELEVATIONS (Show whether DF, RT, GR, etc.)

3812 GR

22. APPROX. DATE WORK WILL START\*

UPON APPROVAL

23.

PROPOSED CASING AND CEMENTING PROGRAM

| SIZE OF HOLE | SIZE OF CASING | WEIGHT PER FOOT | SETTING DEPTH | QUANTITY OF CEMENT      |
|--------------|----------------|-----------------|---------------|-------------------------|
| 17-1/2"      | 13-3/8"        | 48#             | 500'          | SUFFICIENT TO CIRCULATE |
| 12-1/4"      | 10-3/4"        | 45.5#           | 4800'         | SUFFICIENT TO CIRCULATE |
| 9-1/2"       | 7-5/8"         | 29.7#           | 12,900'       | CALCULATED TO TIE-BACK  |
| 6-1/2"       | 5" (Liner)     | 18#             | 15,100'       | CIRCULATE LINER         |

PRODUCING ZONE WILL BE PERFORATED AND STIMULATED AS NECESSARY.

SEE ATTACHED FOR: SUPPLEMENTAL DRILLING DATA  
BOP SKETCH  
SURFACE USE AND OPERATIONS PLAN

GAS IS NOT DEDICATED.

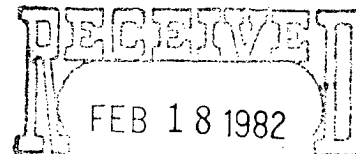
OIL & GAS  
U.S. GEOLOGICAL SURVEY  
ROSWELL, NEW MEXICO

IN ABOVE SPACE DESCRIBE PROPOSED PROGRAM: If proposal is to deepen or plug back, give data on present productive zone and proposed new productive zone. If proposal is to drill or deepen directionally, give pertinent data on subsurface locations and measured and true vertical depths. Give blowout preventer program, if any.

24.

SIGNED

Arthur R. Brown

TITLE

Agent for  
UNION OIL CO. OF CALIFORNIA

DATE FEBRUARY 9, 1982

(This space for Federal or State office use)

PERMIT NO.

APPROVAL DATE

APPROVED BY

TITLE

DATE

CONDITIONS OF APPROVAL, IF ANY:

**NEW MEXICO OIL CONSERVATION COMMISSION  
WELL LOCATION AND ACREAGE DEDICATION PLAT**

Form C-102  
Supersedes C-128  
Effective 1-1-65

All distances must be from the outer boundaries of the Section.

|   |                                      |                             |  |                      |  |
|---|--------------------------------------|-----------------------------|--|----------------------|--|
| Operator<br><b>UNION OIL CO. OF CALIFORNIA</b>  |                                      |                             | Lease<br><b>DIPPEL FED. COM.</b>       |                      | Well No.<br><b>1</b>                   |
| Unit Letter<br><b>C</b>   | Section<br><b>10</b>                 | Township<br><b>22 SOUTH</b> | Range<br><b>32 EAST</b>                | County<br><b>LEA</b> |  |
| Actual Footage Location of Well:<br><b>660</b> feet from the <b>NORTH</b> line and <b>1980</b> feet from the <b>WEST</b> line |                                      |                             |  |                      |  |
| Ground Level Elev.<br><b>3812.0</b>   | Producing Formation<br><b>MORROW</b> |                             | Pool<br><b>UNDESIGNATED MORROW GAS</b> |                      | Dedicated Acreage:<br><b>320</b> Acres |

1. Outline the acreage dedicated to the subject well by colored pencil or hachure marks on the plat below.
2. If more than one lease is dedicated to the well, outline each and identify the ownership thereof (both as to working interest and royalty).
3. If more than one lease of different ownership is dedicated to the well, have the interests of all owners been consolidated by communitization, unitization, force-pooling, etc?

☐ Yes ☒ No If answer is "yes," type of consolidation TO BE COMMUNITIZED

If answer is "no," list the owners and tract descriptions which have actually been consolidated. (Use reverse side of this form if necessary.) \_\_\_\_\_

No allowable will be assigned to the well until all interests have been consolidated (by communitization, unitization, forced-pooling, or otherwise) or until a non-standard unit, eliminating such interests, has been approved by the Commission.

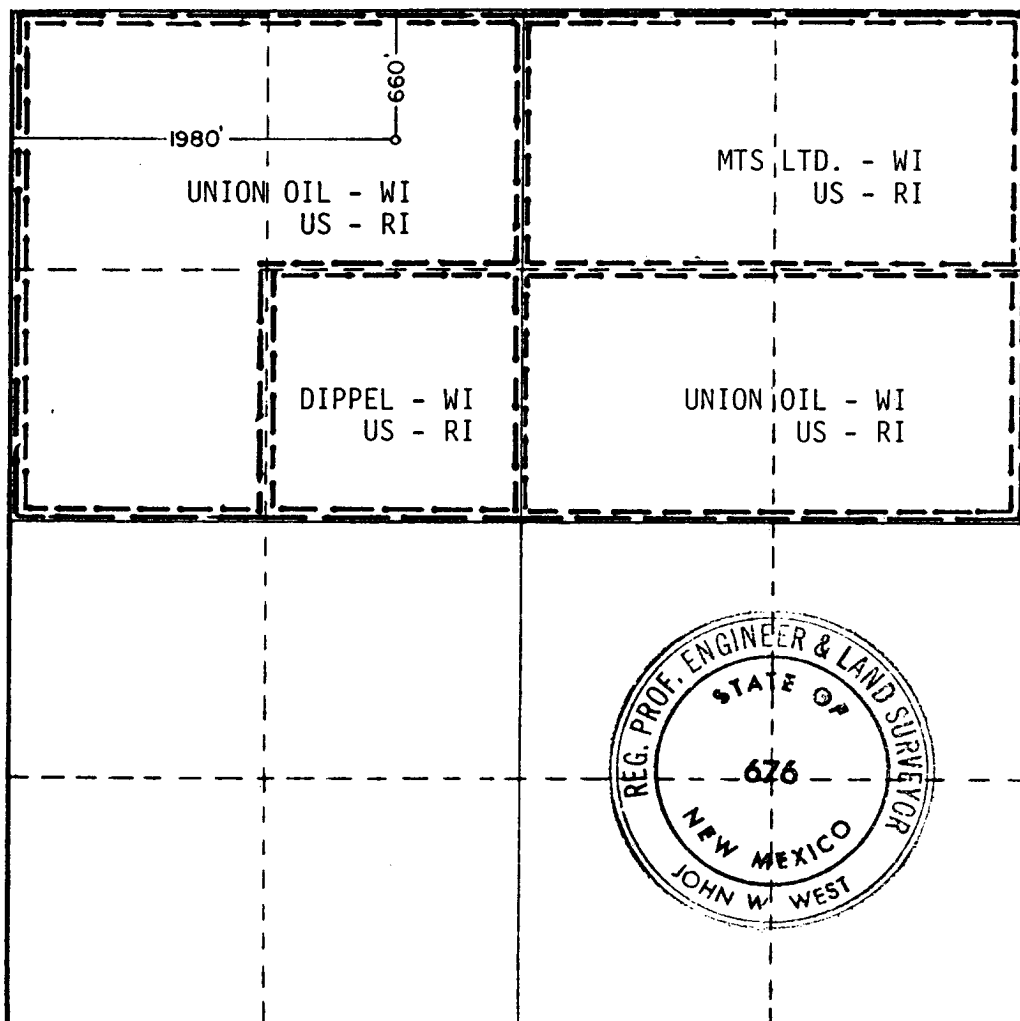

**CERTIFICATION**

I hereby certify that the information contained herein is true and complete to the best of my knowledge and belief.

Name Arthur R. Brown  
Position Agent for

Company  
**UNION OIL CO. OF CALIFORNIA**

Date  
**FEBRUARY 9, 1982**

I hereby certify that the well location shown on this plat was plotted from field notes of actual surveys made by me or under my supervision, and that the same is true and correct to the best of my knowledge and belief.

Date Surveyed  
**2-4-82**

Registered Professional Engineer and/or Land Surveyor

John W. West  
Certificate No. **JOHN W. WEST 676**  
**PATRICK A. ROMERO 6663**  
**Donald L. Eldred 3270**

0 330 660 990 1320 1650 1980 2310 2640 2970 3300 3630 3960 4290 4620 4950 5280 5610 5940 6270 6600

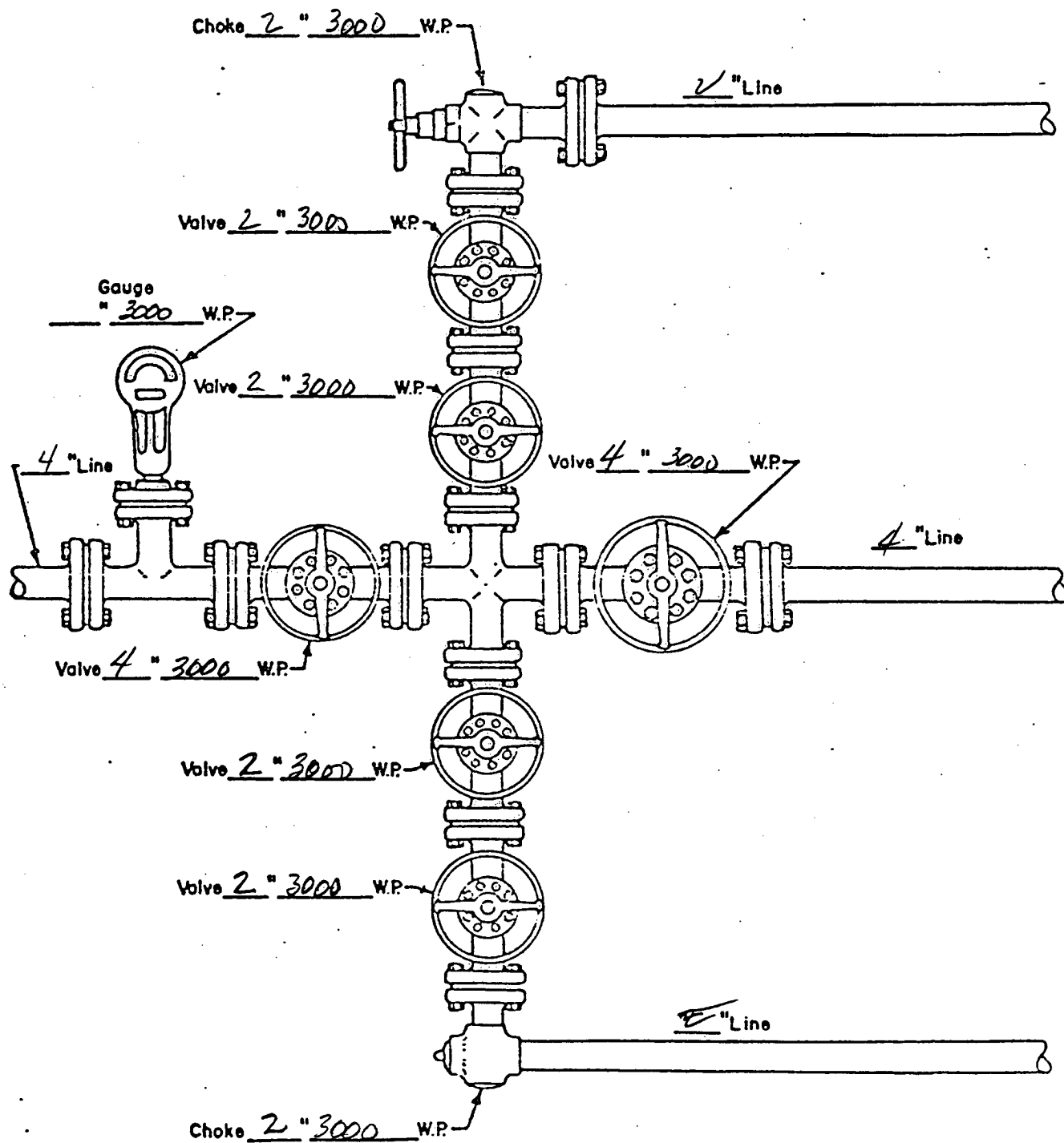

MANIFOLD  
3000 #W.P.

- ☒ Manuel
- ☐ Hydraulic

WELL NAME: DIPPEL Fed Comm #1  
 LOCATION: \_\_\_\_\_  
 \_\_\_\_\_

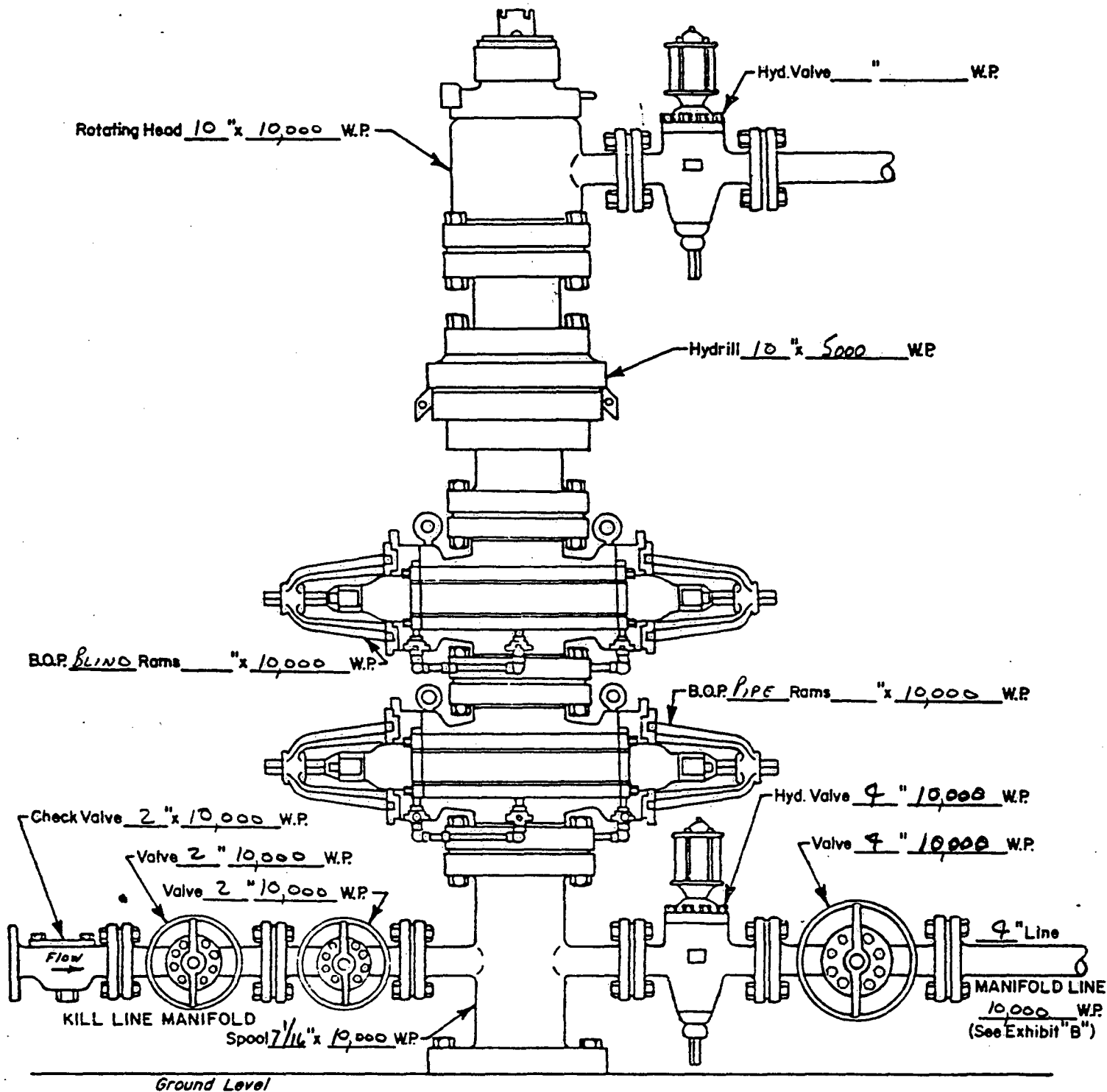

WELL HEAD B.O.P.  
10,000 #W.P.

☐ Manual  
☒ Hydraulic

WELL NAME: DIPPEL FED Comm #1

LOCATION: \_\_\_\_\_

