

## District I

1625 N. French Dr., Hobbs, NM 88240

## District II

1301 W. Grand Avenue, Artesia, NM 88210

## District III

1000 Rio Brazos Road, Aztec, NM 87410

## District IV

1220 S. St. Francis Dr., Santa Fe, NM 87505

State of New Mexico  
Energy Minerals and Natural ResourcesOil Conservation Division  
1220 South St. Francis Dr.  
Santa Fe, NM 87505Form C-101  
Revised June 10, 2003Submit to appropriate District Office  
State Lease - 6 Copies  
Fee Lease - 5 Copies☐ AMENDED REPORT

## APPLICATION FOR PERMIT TO DRILL, RE-ENTER, DEEPEN, PLUGBACK, OR ADD A ZONE

<sup>1</sup> Operator Name and Address Chesapeake Operating, Inc. P. O. Box 18496 Oklahoma City, OK 73154-0496		<sup>2</sup> OGRID Number 147179
<sup>3</sup> Property Code 24402		<sup>3</sup> API Number 30-025-36475
<sup>5</sup> Property Name Boyce 15		<sup>6</sup> Well No. 5

<sup>7</sup> Surface Location

UL or lot no.	Section	Township	Range	Lot Idn	Feet from the	North/South line	Feet from the	East/West line	County
B	15	16S	35E		330	North	1650	East	Lea

<sup>8</sup> Proposed Bottom Hole Location If Different From Surface

UL or lot no.	Section	Township	Range	Lot Idn	Feet from the	North/South line	Feet from the	East/West line	County
Shoe-Bar, 5th NW Townsend perma upper Penn									

<sup>11</sup> Work Type Code N	<sup>12</sup> Well Type Code O	<sup>13</sup> Cable/Rotary R	<sup>14</sup> Lease Type Code P	<sup>15</sup> Ground Level Elevation 3991'
<sup>16</sup> Multiple N	<sup>17</sup> Proposed Depth 11,400'	<sup>18</sup> Formation Strawn	<sup>19</sup> Contractor Unknown	<sup>20</sup> Spud Date 01/01/04

<sup>21</sup> Proposed Casing and Cement Program

Hole Size	Casing Size	Casing weight/foot	Setting Depth	Sacks of Cement	Estimated TOC
17-1/2"	13-3/8"	48#	0-450'	± 500	Surface
11"	8-5/8"	32#	0-4,200'	± 1400	Surface
7-7/8"	5-1/2"	17#	0-11,400'	± 1100	4,200'

<sup>22</sup> Describe the proposed program. If this application is to DEEPEN or PLUG BACK, give the data on the present productive zone and proposed new productive zone.  
Describe the blowout prevention program, if any. Use additional sheets if necessary.

Chesapeake Operating, Inc. proposes to drill to a T.D. of 11,400' in the Strawn formation.

BOP should consist of 13-5/8" 10M# blind & pipe rams & 13-5/8" 5M# Annular (See Schematic)  
Permit Expires 1 Year From Approval  
Date Unless Drilling Underway

<sup>23</sup> I hereby certify that the information given above is true and complete to the best of my knowledge and belief.

Signature: *Barbara J. Bale*

Printed name: Barbara J. Bale

Title: Regulatory Analyst

E-mail Address: bbale@chkenergy.com

Date:  
10/29/03Phone:  
(405)848-8000

## OIL CONSERVATION DIVISION

Approved by:

Title:

PETROLEUM ENGINEER

Approval Date:

NOV 10 2003

Expiration Date:

Conditions of Approval:

Attached ☐

DISTRICT I  
P.O. Box 1980, Hobbs, NM 88241-1980

DISTRICT II  
P.O. Drawer DD, Artesia, NM 88211-0719

DISTRICT III  
1000 Rio Brazos Rd., Aztec, NM 87410

DISTRICT IV  
P.O. Box 2088, Santa Fe, N.M. 87504-2088

State of New Mexico  
Energy, Minerals and Natural Resources Department

OIL CONSERVATION DIVISION  
P.O. Box 2088  
Santa Fe, New Mexico 87504-2088

Form C-102  
Revised February 10, 1994  
Submit to Appropriate District Office  
State Lease - 4 Copies  
Fee Lease - 3 Copies

WELL LOCATION AND ACREAGE DEDICATION PLAT

☐ AMENDED REPORT

API Number <b>30-025-36475</b>	Pool Code <b>59847</b>	Pool Name <b>Shoe-Bar; Straw</b>
Property Code <b>24402</b>	Property Name <b>BOYCE 15</b>	Well Number <b>5</b>
OGRID No. <b>147179</b>	Operator Name <b>CHESAPEAKE OPERATING, INC.</b>	Elevation <b>3991'</b>

Surface Location

UL or lot No.	Section	Township	Range	Lot Idn	Feet from the	North/South line	Feet from the	East/West line	County
B	15	16-S	35-E		330'	NORTH	1650'	EAST	LEA

Bottom Hole Location If Different From Surface

UL or lot No.	Section	Township	Range	Lot Idn	Feet from the	North/South line	Feet from the	East/West line	County

Dedicated Acres	Joint or Infill	Consolidation Code	Order No.
40			

NO ALLOWABLE WILL BE ASSIGNED TO THIS COMPLETION UNTIL ALL INTERESTS HAVE BEEN CONSOLIDATED  
OR A NON-STANDARD UNIT HAS BEEN APPROVED BY THE DIVISION

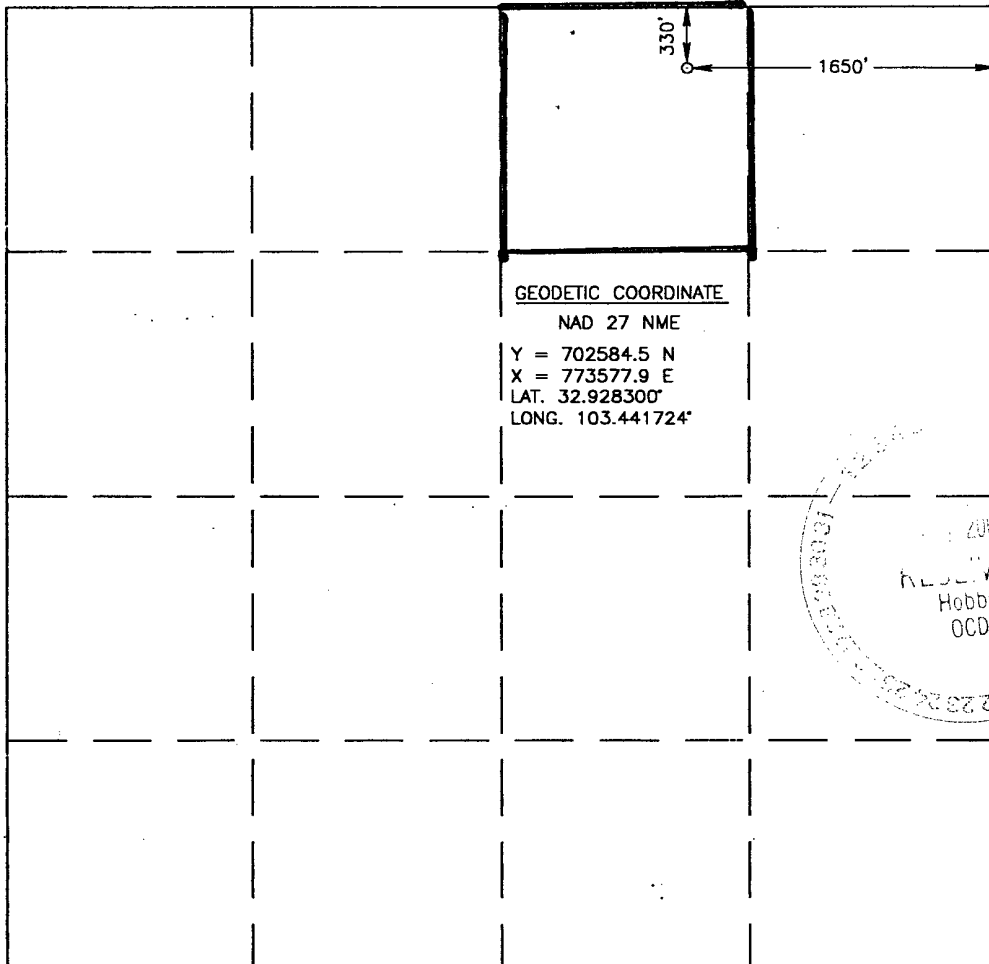
	<p>GEODETIC COORDINATE NAD 27 NME Y = 702584.5 N X = 773577.9 E LAT. 32.928300° LONG. 103.441724°</p>	<p><b>OPERATOR CERTIFICATION</b></p> <p>I hereby certify the the information contained herein is true and complete to the best of my knowledge and belief.</p> <p><i>Barbara J. Bale</i> Signature Barbara J. Bale Printed Name Regulatory Analyst Title 10/29/03 Date</p>
		<p><b>SURVEYOR CERTIFICATION</b></p> <p>I hereby certify that the well location shown on this plat was plotted from field notes of actual surveys made by me or under my supervision and that the same is true and correct to the best of my belief.</p> <p>October 20, 2003 Date Surveyed AWB</p>
		<p>Signature &amp; Seal of Professional Surveyor <i>Gary E. Edson</i> 10/22/03 03.11.1150</p>
		<p>Certificate No. GARY E. EDSON 12641</p>

# VICINITY MAP

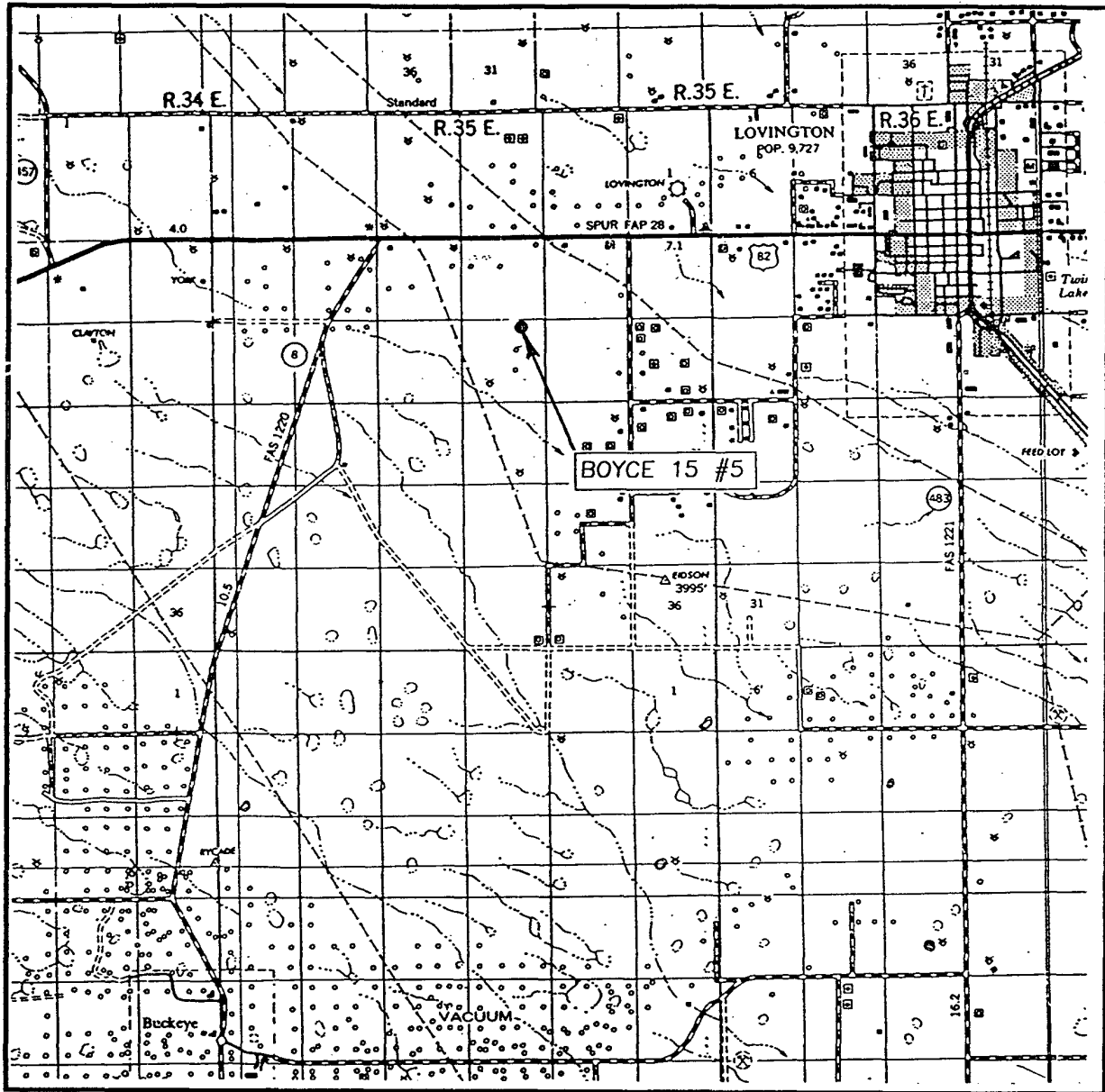

SCALE: 1" = 2 MILES

SEC. 15 TWP. 16-S RGE. 35-E

SURVEY N.M.P.M.

COUNTY LEA

DESCRIPTION 330' FNL & 1650' FEL

ELEVATION 3991'

OPERATOR CHESAPEAKE OPERATING, INC.

LEASE BOYCE 15

## DRIVING DIRECTIONS

FROM THE INTERSECTION OF U.S. HIGHWAY 8 AND HIGHWAY 82, GO EAST ALONG U.S. HIGHWAY 82 APPROXIMATELY 1.6 MILES TO A CALICHE RD. TURN SOUTH CROSSING A CATTLEGUARD AND A CHESAPEAKE OPERATING, INC. SIGN. CONTINUE SOUTH ALONG CALICHE RD. APPROXIMATELY 1.0 MILE TO ANOTHER CATTLEGUARD. CONTINUE SOUTH ALONG SAME CALICHE RD. APPROXIMATELY 330 FEET, DRIVE EAST ACROSS PASTURE APPROXIMATELY 350 FEET MORE OR LESS TO STAKED LOCATION.

JOHN WEST SURVEYING  
HOBBS, NEW MEXICO  
(505) 393-3117

# LOCATION VERIFICATION MAP

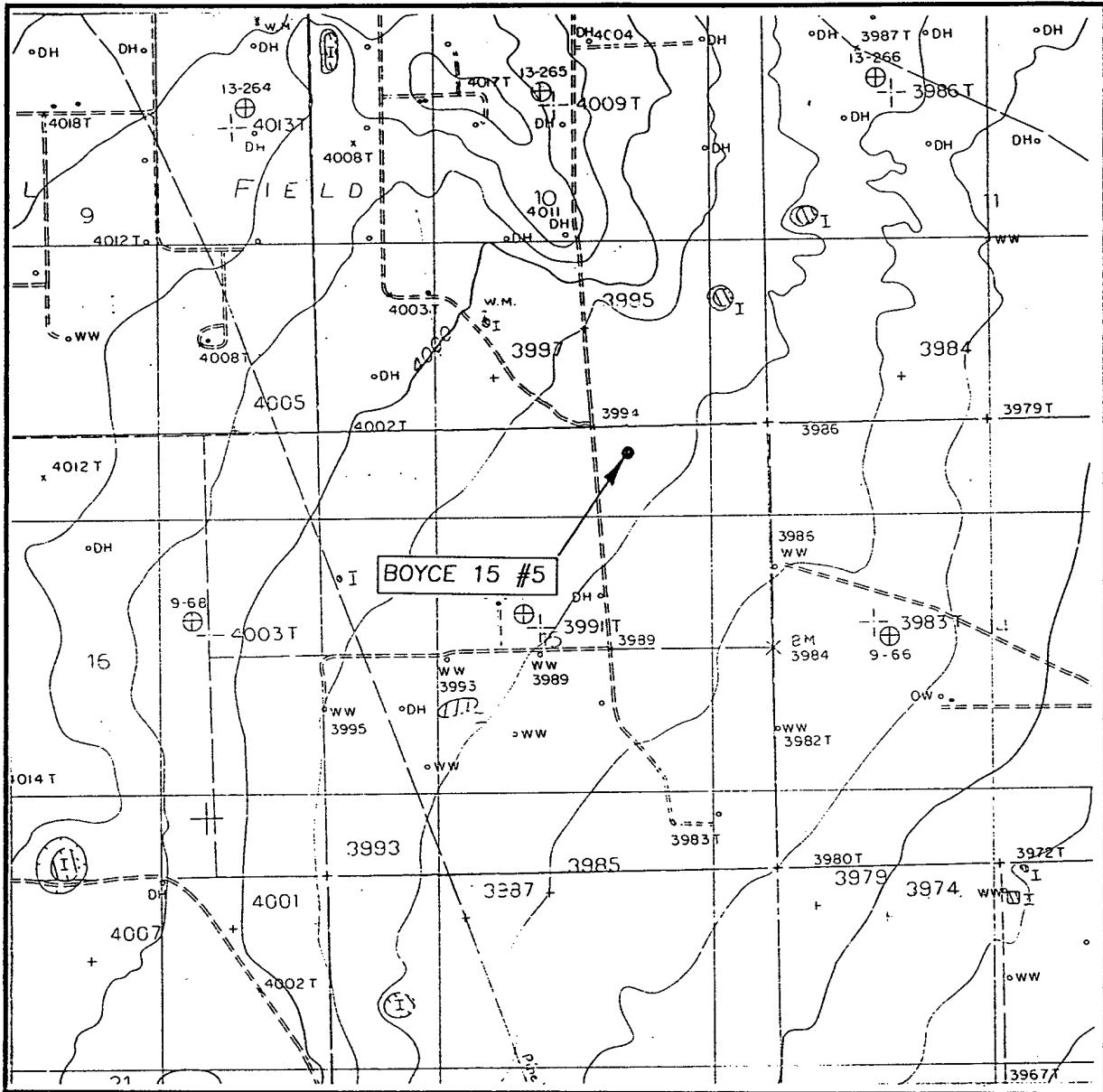

SCALE: 1" = 2000'

CONTOUR INTERVAL: 5'  
LOVINGTON NW, N.M.

SEC. 15 TWP. 16-S RGE. 35-E

SURVEY N.M.P.M.

COUNTY LEA

DESCRIPTION 330' FNL & 1650' FEL

ELEVATION 3991'

OPERATOR CHESAPEAKE OPERATING, INC.

LEASE BOYCE 15

U.S.G.S. TOPOGRAPHIC MAP  
LOVINGTON NW, N.M.

**JOHN WEST SURVEYING**  
**HOBBS, NEW MEXICO**  
**(505) 393-3117**

**BLOWOUT PREVENTOR SCHEMATIC**  
**CHESAPEAKE OPERATING INC**

WELL : Boyce 5-15  
RIG : Unknown  
COUNTY : Lea STATE: New Mexico  
OPERATION Drill out below 13-5/8" Casing

	SIZE	PRESSURE	DESCRIPTION
A	13-5/8"	5,000#	Annular
D	13-5/8"	5,000#	Mud Cross
Spool		13-5/8" 3M x 13-5/8" 5M	
A-Sec		13-5/8" SOW x 13-5/8" 3M	

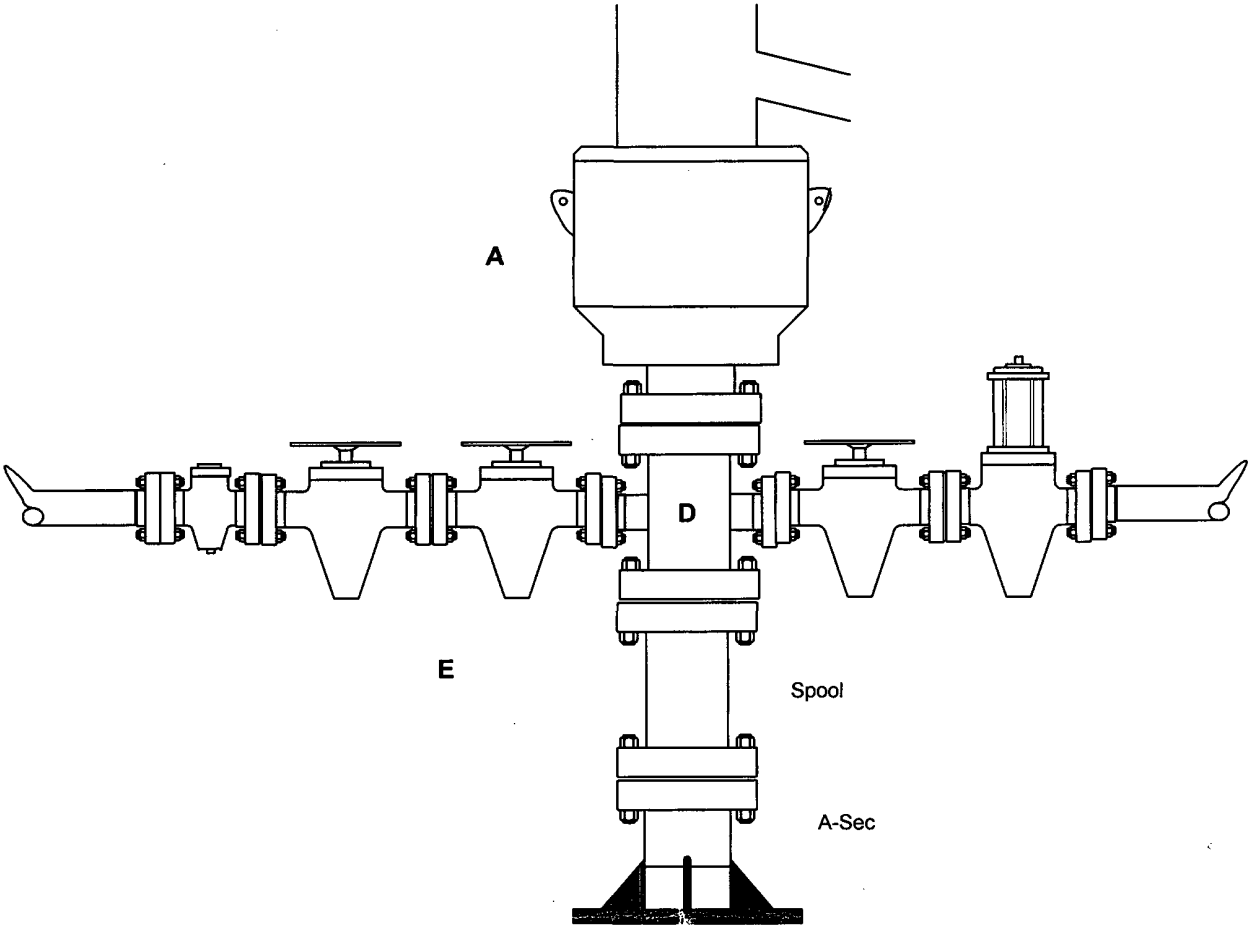

**Kill Line**

SIZE	PRESSURE	DESCRIPTION
2"	10,000#	Check Valve
2"	10,000#	Gate Valve
2"	10,000#	Gate Valve

**Choke Line**

SIZE	PRESSURE	DESCRIPTION
4"	10,000#	Gate Valve
4"	10,000#	HCR Valve

**BLOWOUT PREVENTOR SCHEMATIC**  
**CHESAPEAKE OPERATING INC**

**WELL** : Boyce 5-15

**RIG** : Unknown

**COUNTY** : Lea **STATE:** New Mexico

**OPERATION:** Drill out below 8-5/8" Casing

	SIZE	PRESSURE	DESCRIPTION
A	13-5/8"	500#	Rot Head
B	13-5/8"	5,000#	Annular
C	13-5/8"	5,000#	Pipe Rams
D	13-5/8"	5,000#	Blind Rams
E	13-5/8"	5,000#	Mud Cross
DSA		11" 5M x 13-5/8" 5M	
B-sec		13-5/8" 3M x 11" 5M	
A-Sec		13-5/8" SOW x 13-5/8" 3M	

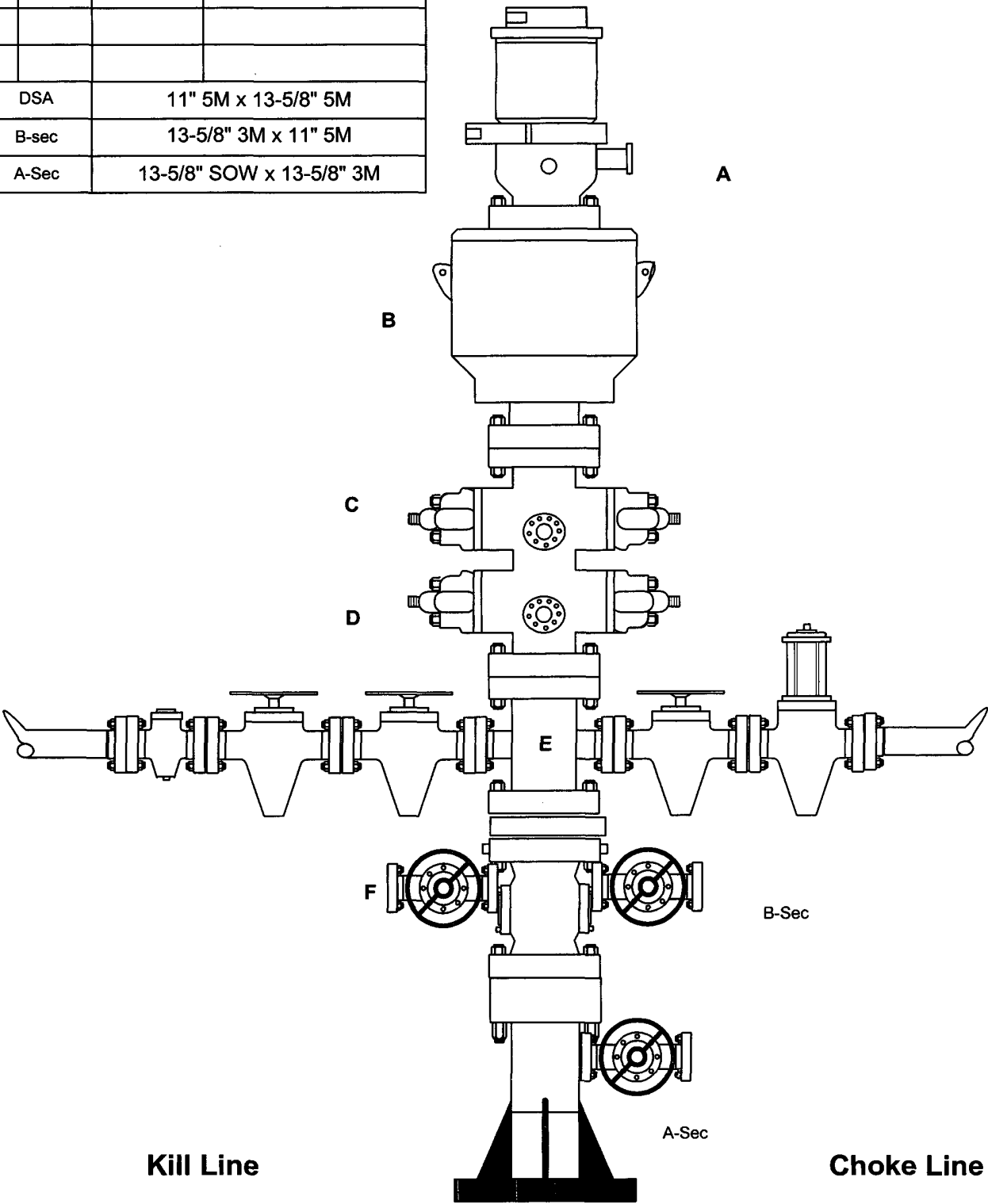

SIZE	PRESSURE	DESCRIPTION
2"	10,000#	Check Valve
2"	10,000#	Gate Valve
2"	10,000#	Gate Valve

SIZE	PRESSURE	DESCRIPTION
4"	10,000#	Gate Valve
4"	10,000#	HCR Valve