

District I
1625 N. French Dr., Hobbs, NM 88240
District II
1301 W. Grand Avenue, Artesia, NM 88210
District III
1000 Rio Brazos Road, Aztec, NM 87410
District IV
1220 S. St. Francis Dr., Santa Fe, NM 87505

State of New Mexico
Energy Minerals and Natural Resources

Form C-101
Revised March 17, 1999

Oil Conservation Division
1220 South St. Francis Dr.
Santa Fe, NM 87505

Submit to appropriate District Office
State Lease - 6 Copies
Fee Lease - 5 Copies

☐ AMENDED REPORT

APPLICATION FOR PERMIT TO DRILL, RE-ENTER, DEEPEN, PLUGBACK, OR ADD A ZONE

¹ Operator Name and Address Cambrian Management, Ltd P.O. Box 272 Midland, Texas 79702		² GRID Number 198688
³ Property Code 33110		⁴ API Number 30-025-23336
⁵ Property Name McCrory		⁶ Well No. 1

⁷ Surface Location									
UL or lot no.	Section	Township	Range	Lot Idn	Feet from the	North/South line	Feet from the	East/West line	County
0	24	13-S	37-E		660	South	1980	East	Lea

⁸ Proposed Bottom Hole Location If Different From Surface									
UL or lot no.	Section	Township	Range	Lot Idn	Feet from the	North/South line	Feet from the	East/West line	County
⁹ Proposed Pool 1 King; Upper Wolfcamp					¹⁰ Proposed Pool 2				

¹¹ Work Type Code E	¹² Well Type Code 0	¹³ Cable/Rotary Rotary	¹⁴ Lease Type Code P	¹⁵ Ground Level Elevation 3860
¹⁶ Multiple N	¹⁷ Proposed Depth 9800'	¹⁸ Formation Upper Wolfcamp	¹⁹ Contractor Key Energy	²⁰ Spud Date 12/15/03

²¹ Proposed Casing and Cement Program					
Hole Size	Casing Size	Casing weight/foot	Setting Depth	Sacks of Cement	Estimated TOC
Surface	See Initial	Application			
Intermediate	"	"			
7 7/8	4 1/2	11.6	9700'	1000sx	4500'

²² Describe the proposed program. If this application is to DEEPEN or PLUG BACK, give the data on the present productive zone and proposed new productive zone.
Describe the blowout prevention program, if any. Use additional sheets if necessary.

See attached

Permit Expires 1 Year From Approval
Date Unless Drilling Underway
Re-Entry

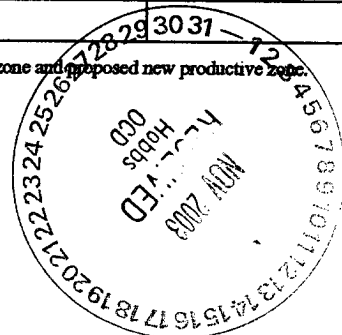

²³ I hereby certify that the information given above is true and complete to the best of my knowledge and belief.		OIL CONSERVATION DIVISION	
Signature:		Approved by:	
Printed name: Alan D. Means		Title: PETROLEUM ENGINEER	
Title: Owner/Engineer		Approval Date: NOV 17 2003	
Date: 11/10/03		Expiration Date:	
Phone: (432) 620-9181		Conditions of Approval: Attached <input type="checkbox"/>	

District I
1625 N. French Dr., Hobbs, NM 88240
District II
1301 W. Grand Avenue, Artesia, NM 88210
District III
1000 Rio Brazos Rd., Aztec, NM 87410
District IV
1220 S. St. Francis Dr., Santa Fe, NM 87505

State of New Mexico
Energy, Minerals & Natural Resources Department
OIL CONSERVATION DIVISION
1220 South St. Francis Dr.
Santa Fe, NM 87505

Form C-102
Revised June 10, 2003
Submit to Appropriate District Office
State Lease - 4 Copies
Fee Lease - 3 Copies

☐ AMENDED REPORT

WELL LOCATION AND ACREAGE DEDICATION PLAT

API Number 30-025-23336		Pool Code 36100	Pool Name King's Upper Wolfcamp
Property Code 33110	Property Name McCrory		Well Number 1
OGRID No. 198 688	Operator Name Cambrian Management, Ltd.		Elevation 3800

10 Surface Location

UL or lot no.	Section	Township	Range	Lot Idn	Feet from the	North/South line	Feet from the	East/West line	County
0	24	13-S	37E		660	South	1980	East	Lea

11 Bottom Hole Location If Different From Surface

UL or lot no.	Section	Township	Range	Lot Idn	Feet from the	North/South line	Feet from the	East/West line	County

Dedicated Acres 40	Joint or Infill -	Consolidation Code -	Order No.
-----------------------	----------------------	-------------------------	-----------

NO ALLOWABLE WILL BE ASSIGNED TO THIS COMPLETION UNTIL ALL INTERESTS HAVE BEEN CONSOLIDATED OR A NON-STANDARD UNIT HAS BEEN APPROVED BY THE DIVISION

16				24	17 OPERATOR CERTIFICATION I hereby certify that the information contained herein is true and complete to the best of my knowledge and belief.  Signature Alan D. Means Printed Name Owner/Engineer Title and E-mail Address ameans@cambrianmgmt.com Date 11/10/03
					18 SURVEYOR CERTIFICATION I hereby certify that the well location shown on this plat was plotted from field notes of actual surveys made by me or under my supervision, and that the same is true and correct to the best of my belief.
					Date of Survey Signature and Seal of Professional Surveyor:
					Certificate Number

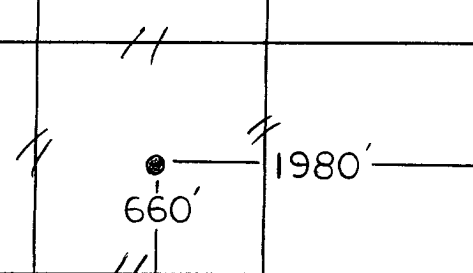



Attachment to Form C-101
November 10, 2003

McCrory #1
Plan of Operation

- Rig-up Completion rig with rotary and mud pumps
- Drill out cement plugs:
 - Surface
 - 320'-400'
 - 930'-1015'
- Bowl over 8 5/8" casing stub
- Continue to drill out cement plugs:
 - 4454'-4600'
 - 5968'-6114'
 - 7969'-8115'
 - 9204'-9350'
- Run and cement 4 1/2" casing from 9700' to surface.
- Complete in the Upper Wolfcamp.



Cambrian
MANAGEMENT, LTD.

P.O.Box 272
Midland, Texas 79702
Ofc: 915-620-9181
Fax: 915-570-0102

BOP CONFIGURATION

Minimum Standard

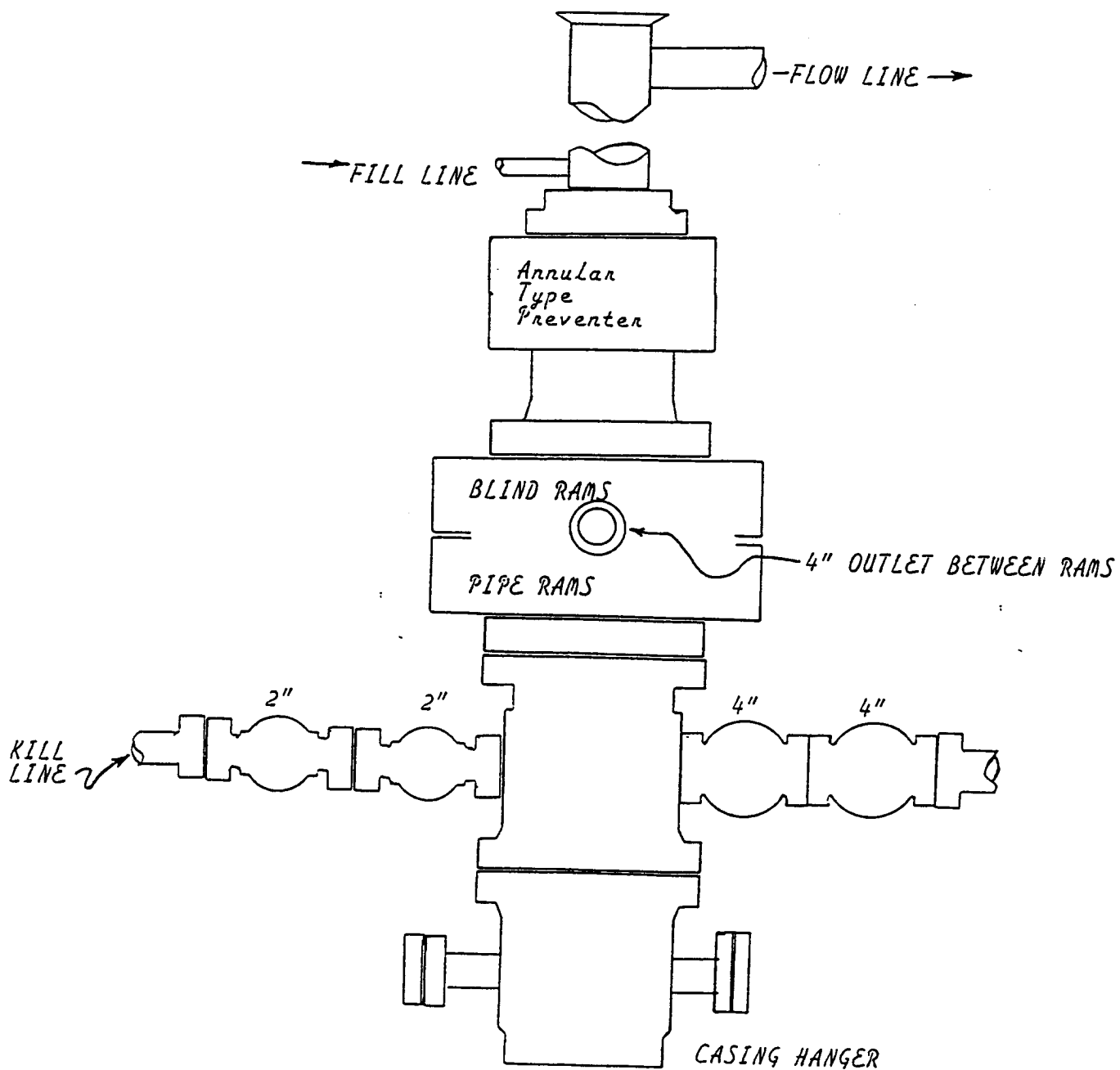



Cambrian
MANAGEMENT, LTD.

P.O.Box 272
Midland, Texas 79702
Ofc: 915-620-9181
Fax: 915-570-0102

CHOKE MANIFOLD

Minimum Standard

