

UNITED STATES
DEPARTMENT OF THE INTERIOR
BUREAU OF LAND MANAGEMENT

RECEIVED

FORM APPROVED
OMB NO 1004-0135
Expires: July 31, 2010

SEP 17 2008

Case Serial No.
NMLC030133B

SUNDRY NOTICES AND REPORTS ON WELLS
Do not use this form for proposals to drill or to re-enter an abandoned well. Use form 3160-3 (APD) for such proposals.

HOBBBS (11)

SUBMIT IN TRIPLICATE - Other instructions on reverse side.

1. Type of Well <input type="checkbox"/> Oil Well <input checked="" type="checkbox"/> Gas Well <input type="checkbox"/> Other		7. If Unit or CA/Agreement. Name and/or No.
2. Name of Operator CHESAPEAKE OPERATING, INC. ✓		8. Well Name and No. LANGLEY DEEP FEDERAL 24 ✓
Contact LINDA GOOD E-Mail: linda.good@chk.com		9. API Well No. 30-025-39116 ✓
3a. Address P.O. BOX 18496 OKLAHOMA CITY, OK 73154-0496	3b. Phone No. (include area code) Ph: 405-767-4275	10. Field and Pool, or Exploratory LANGLEY; DEVONIAN ✓
4. Location of Well (Footage, Sec., T., R., M. or Survey Description) Sec 28 T22S R36E NWNE 330FNL 1990FEL Unit B ✓		11. County or Parish, and State LEA COUNTY, NM ✓

12. CHECK APPROPRIATE BOX(ES) TO INDICATE NATURE OF NOTICE, REPORT, OR OTHER DATA

TYPE OF SUBMISSION	TYPE OF ACTION			
<input type="checkbox"/> Notice of Intent	<input type="checkbox"/> Acidize	<input type="checkbox"/> Deepen	<input type="checkbox"/> Production (Start/Resume)	<input type="checkbox"/> Water Shut-Off
<input type="checkbox"/> Subsequent Report	<input type="checkbox"/> Alter Casing	<input type="checkbox"/> Fracture Treat	<input type="checkbox"/> Reclamation	<input type="checkbox"/> Well Integrity
<input type="checkbox"/> Final Abandonment Notice	<input type="checkbox"/> Casing Repair	<input type="checkbox"/> New Construction	<input type="checkbox"/> Recomplete	<input checked="" type="checkbox"/> Other
	<input type="checkbox"/> Change Plans	<input type="checkbox"/> Plug and Abandon	<input type="checkbox"/> Temporarily Abandon	Change to Original
	<input type="checkbox"/> Convert to Injection	<input type="checkbox"/> Plug Back	<input type="checkbox"/> Water Disposal	PD

13. Describe Proposed or Completed Operation (clearly state all pertinent details, including estimated starting date of any proposed work and approximate duration thereof. If the proposal is to deepen directionally or recompleat horizontally, give subsurface locations and measured and true vertical depths of all pertinent markers and zones. Attach the Bond under which the work will be performed or provide the Bond No. on file with BLM/BIA. Required subsequent reports shall be filed within 30 days following completion of the involved operations. If the operation results in a multiple completion or recompleat in a new interval, a Form 3160-4 shall be filed once testing has been completed. Final Abandonment Notices shall be filed only after all requirements, including reclamation, have been completed, and the operator has determined that the site is ready for final inspection.)

PLEASE FIND THE ATTACHED FINAL RIG LAYOUT.

OK B-40 AT 9/10/08

(CHK PN 621654)

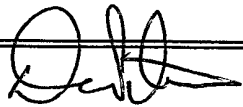
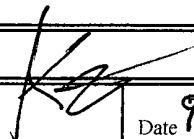
14. I hereby certify that the foregoing is true and correct. Electronic Submission #62859 verified by the BLM Well Information System For CHESAPEAKE OPERATING, INC., sent to the Hobbs	
Name (Printed/Typed) LINDA GOOD	Title REGULATORY COMPLIANCE SPEC.
Signature (Electronic Submission)	Date 09/08/2008
THIS SPACE FOR FEDERAL OR STATE OFFICE USE	
Approved By 	FIELD MANAGER  Date 9/10/08
Conditions of approval, if any, are attached. Approval of this notice does not warrant or certify that the applicant holds legal or equitable title to those rights in the subject lease which would entitle the applicant to conduct operations thereon	
Office CARLSBAD FIELD OFFICE	
Title 18 U.S.C. Section 1001 and Title 43 U.S.C. Section 1212, make it a crime for any person knowingly and willfully to make to any department or agency of the United States any false, fictitious or fraudulent statements or representations as to any matter within its jurisdiction	

**** OPERATOR-SUBMITTED ** OPERATOR-SUBMITTED ** OPERATOR-SUBMITTED ****

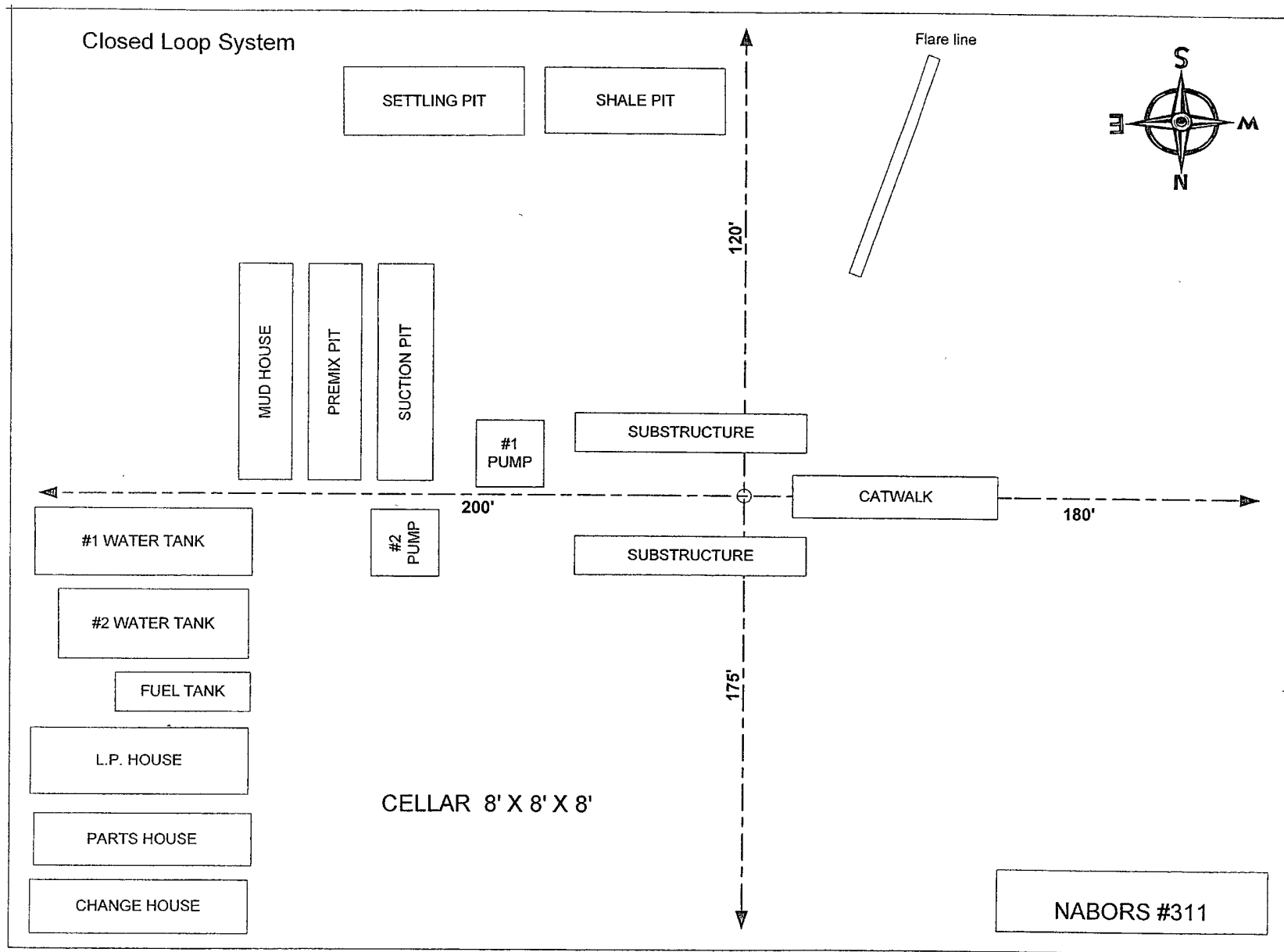

Prevailing Winds from the North in Winter and from the South in Summer.

Exhibit_D