

District I
1625 N. French Dr., Hobbs, NM 88240
District II
1301 W. Grand Avenue, Artesia, NM 88210
District III
1000 Rio Brazos Road, Aztec, NM 87410
District IV
1220 S. St. Francis Dr., Santa Fe, NM 87505

State of New Mexico
Energy Minerals and Natural Resources

Oil Conservation Division
1220 South St. Francis Dr.
Santa Fe, NM 87505

Form C-101
Revised March 17, 1999

Submit to appropriate District Office
State Lease - 6 Copies
Fee Lease - 5 Copies

☐ AMENDED REPORT

APPLICATION FOR PERMIT TO DRILL, RE-ENTER, DEEPEN, PLUGBACK, OR ADD A ZONE

¹ Operator Name and Address Cimarex Energy Co. 1437 S. Boulder, Suite 1300 Tulsa, OK 74119		² OGRID Number 215099
		³ API Number 30 - 025 - 36191
³ Property Code 30730	⁵ Property Name R. E. Graham "7"	⁶ Well No. 8

⁷ Surface Location

UL or lot no.	Section	Township	Range	Lot Idn	Feet from the	North/South line	Feet from the	East/West line	County
M	7	18-S	32-E		660	South	400	West	Lea

⁸ Proposed Bottom Hole Location If Different From Surface

UL or lot no.	Section	Township	Range	Lot Idn	Feet from the	North/South line	Feet from the	East/West line	County
⁹ Proposed Pool 1 Young (Queen)						¹⁰ Proposed Pool 2			

¹¹ Work Type Code N	¹² Well Type Code O	¹³ Cable/Rotary R	¹⁴ Lease Type Code P	¹⁵ Ground Level Elevation 3760'
¹⁶ Multiple No	¹⁷ Proposed Depth 3700'	¹⁸ Formation Queen	¹⁹ Contractor United Drilling	²⁰ Spud Date ASAP

²¹ Proposed Casing and Cement Program

Hole Size	Casing Size	Casing weight/foot	Setting Depth	Sacks of Cement	Estimated TOC
12-1/4"	8-5/8"	24# J-55	700'	450	surface
7-7/8"	4-1/2"	10.5# J-55	3700'	200	2600'

²² Describe the proposed program. If this application is to DEEPEN or PLUG BACK, give the data on the present productive zone and proposed new productive zone.
Describe the blowout prevention program, if any. Use additional sheets if necessary.

2-3/8" tbg. @ 3650'

8" - 2000 Annular BOP

Permit Expires 1 Year From Approval
Date Unless Drilling Underway

APPROVED
MAR 04 2003

²³ I hereby certify that the information given above is true and complete to the best of my knowledge and belief. Signature: Printed name: Erik Block Title: Drilling Engineer Date: 2-17-03		OIL CONSERVATION DIVISION Approved by: Title: PETROLEUM ENGINEER Approval Date: MAR 04 2003 Expiration Date: Conditions of Approval: Attached <input type="checkbox"/>	
Phone: (918) 295-1746			

DISTRICT II
P.O. Drawer DD, Artesia, NM 88211-0719

OIL CONSERVATION DIVISION

P.O. Box 2088
Santa Fe, New Mexico 87504-2088

DISTRICT III
1000 Rio Brazos Rd., Aztec, NM 87410

DISTRICT IV
P.O. BOX 2088, SANTA FE, N.M. 87504-2088

WELL LOCATION AND ACREAGE DEDICATION PLAT

☐ AMENDED REPORT

API Number 30-025-36191	Pool Code 65360	Pool Name Young (Queen)
Property Code 30730	Property Name GRAHAM "7"	Well Number 8
OGRID No. 215099	Operator Name CIMAREX ENERGY COMPANY	Elevation 3760'

Surface Location

UL or lot No.	Section	Township	Range	Lot Idn	Feet from the	North/South line	Feet from the	East/West line	County
M	7	18-S	32-E		660	SOUTH	400	WEST	LEA

Bottom Hole Location If Different From Surface

UL or lot No.	Section	Township	Range	Lot Idn	Feet from the	North/South line	Feet from the	East/West line	County
Dedicated Acres 40	Joint or Infill	Consolidation Code		Order No.					

NO ALLOWABLE WILL BE ASSIGNED TO THIS COMPLETION UNTIL ALL INTERESTS HAVE BEEN CONSOLIDATED
OR A NON-STANDARD UNIT HAS BEEN APPROVED BY THE DIVISION

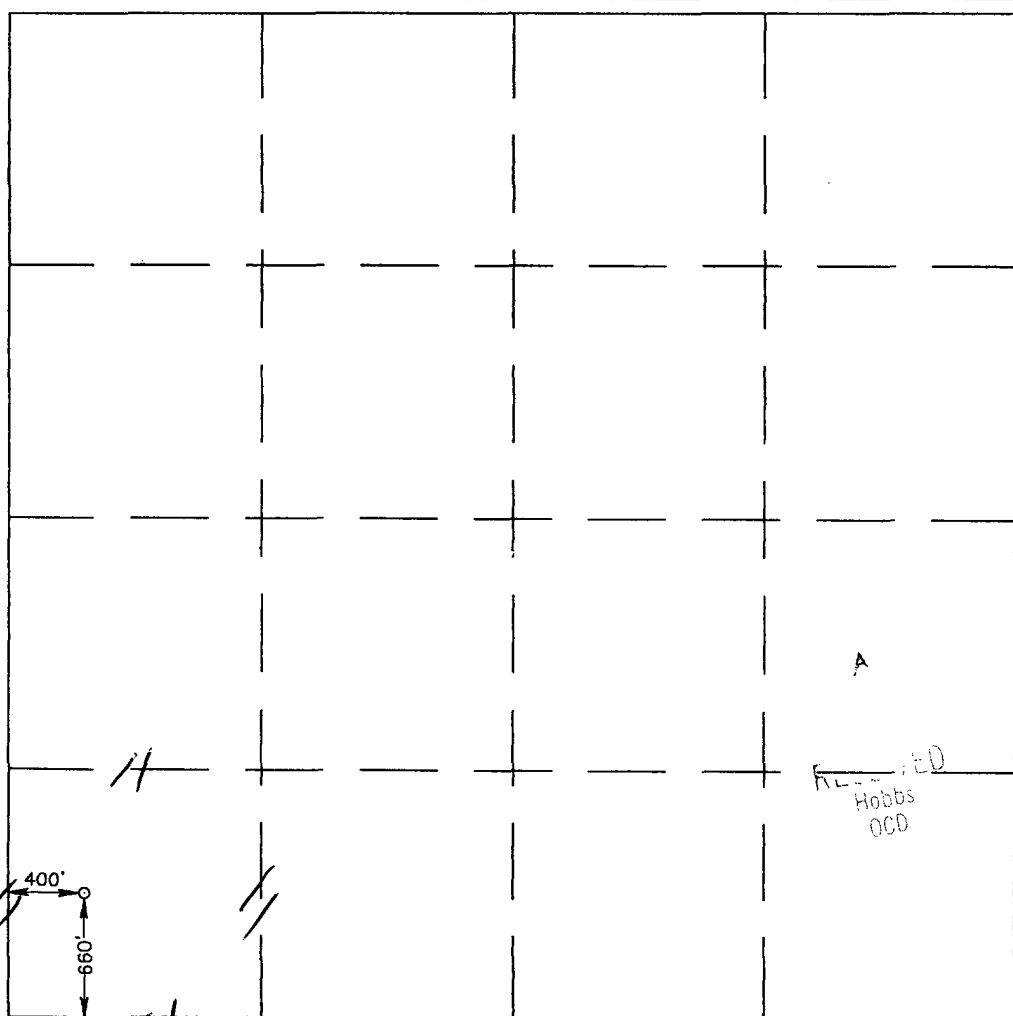
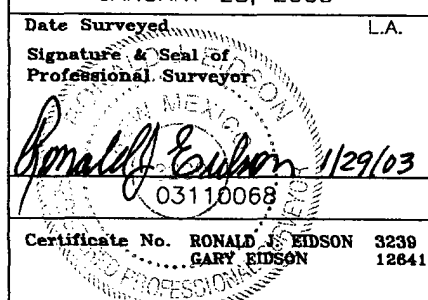
	OPERATOR CERTIFICATION	
	<i>I hereby certify the the information contained herein is true and complete to the best of my knowledge and belief.</i>	
	<u>Erik Black</u> Signature	
	<u>Erik Black</u> Printed Name	
<u>Engineer</u> Title		
<u>2-18-03</u> Date		
SURVEYOR CERTIFICATION		
<i>I hereby certify that the well location shown on this plat was plotted from field notes of actual surveys made by me or under my supervision, and that the same is true and correct to the best of my belief.</i>		
<u>JANUARY 28, 2003</u> Date Surveyed		
<u>Professional Surveyor</u> Signature & Seal of		
		
Certificate No. <u>RONALD J. EIDSON</u> 3239 <u>GARY EIDSON</u> 12641		

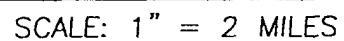

SEC. 7 TWP. 18-S RGE. 32-E
SURVEY _____ N.M.P.M. _____
COUNTY _____ LEA _____
DESCRIPTION 660' FSL & 400' FEL
ELEVATION _____ 3760'
OPERATOR CIMAREX ENERGY COMPANY
LEASE _____ GRAHAM "7"

JOHN WEST SURVEYING
HOBBS, NEW MEXICO
(505) 393-3117

LOCATION VERIFICATION MAP

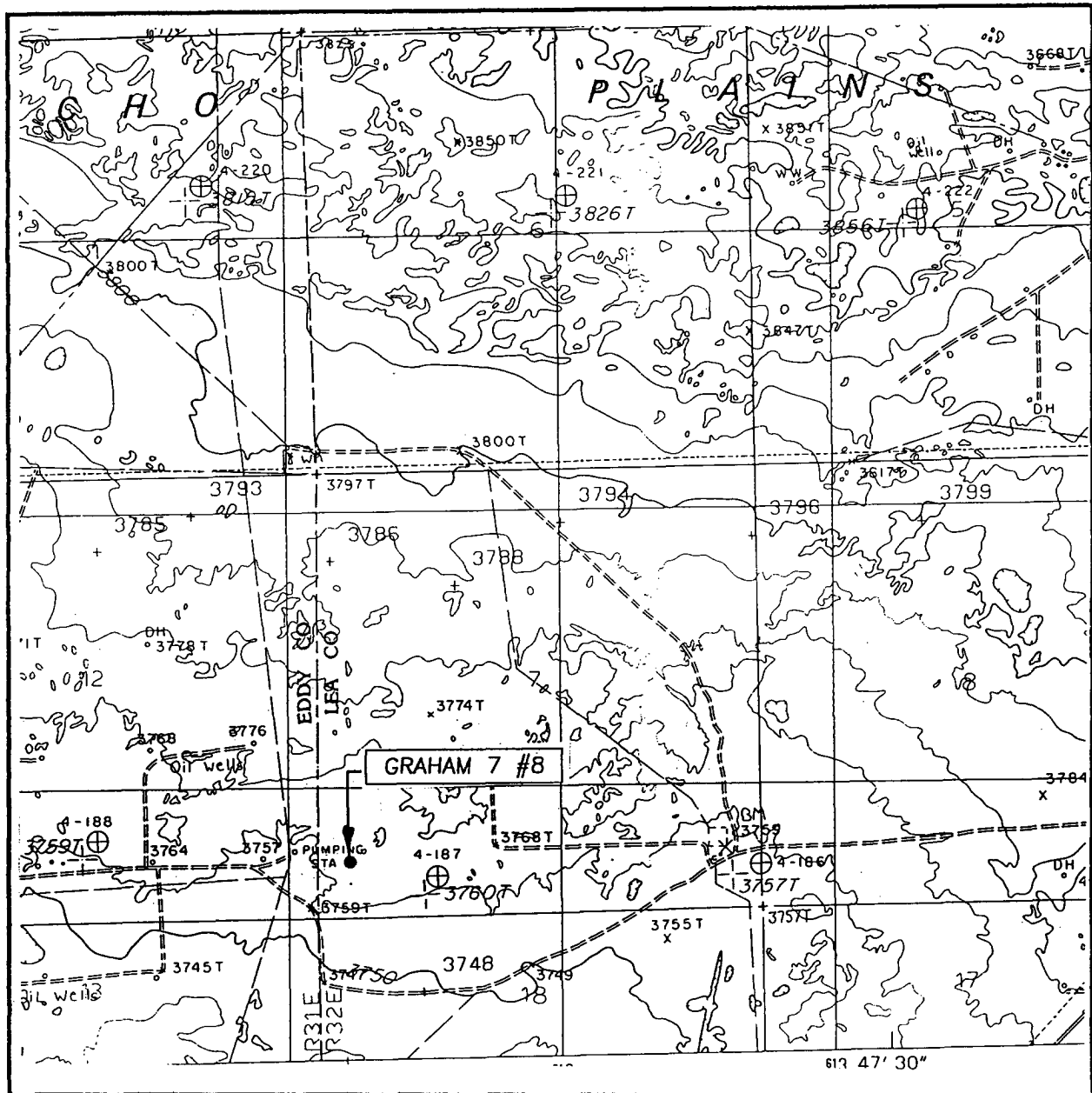

SCALE: 1" = 2000'

CONTOUR INTERVAL: 10'
MALJAMAR, N.M.

SEC. 7 TWP. 18-S RGE. 32-E

SURVEY N.M.P.M.

COUNTY LEA

DESCRIPTION 660' FSL & 400' FWL

ELEVATION 3760'

OPERATOR CIMAREX ENERGY COMPANY

LEASE GRAHAM "7"

U.S.G.S. TOPOGRAPHIC MAP
MALJAMAR, N.M.

JOHN WEST SURVEYING
HOBBS, NEW MEXICO
(505) 393-3117

Cimarex Energy Co.

Graham "7" - 8

Proposed Blowout Preventor Stack

BOPE To Drill 0' - 3700'

Valve Nomenclature

- 1.) CIW 2 1/16" 5m Manual Gate Valve
- 2.) CIW 2 1/16" 5m Manual Gate Valve

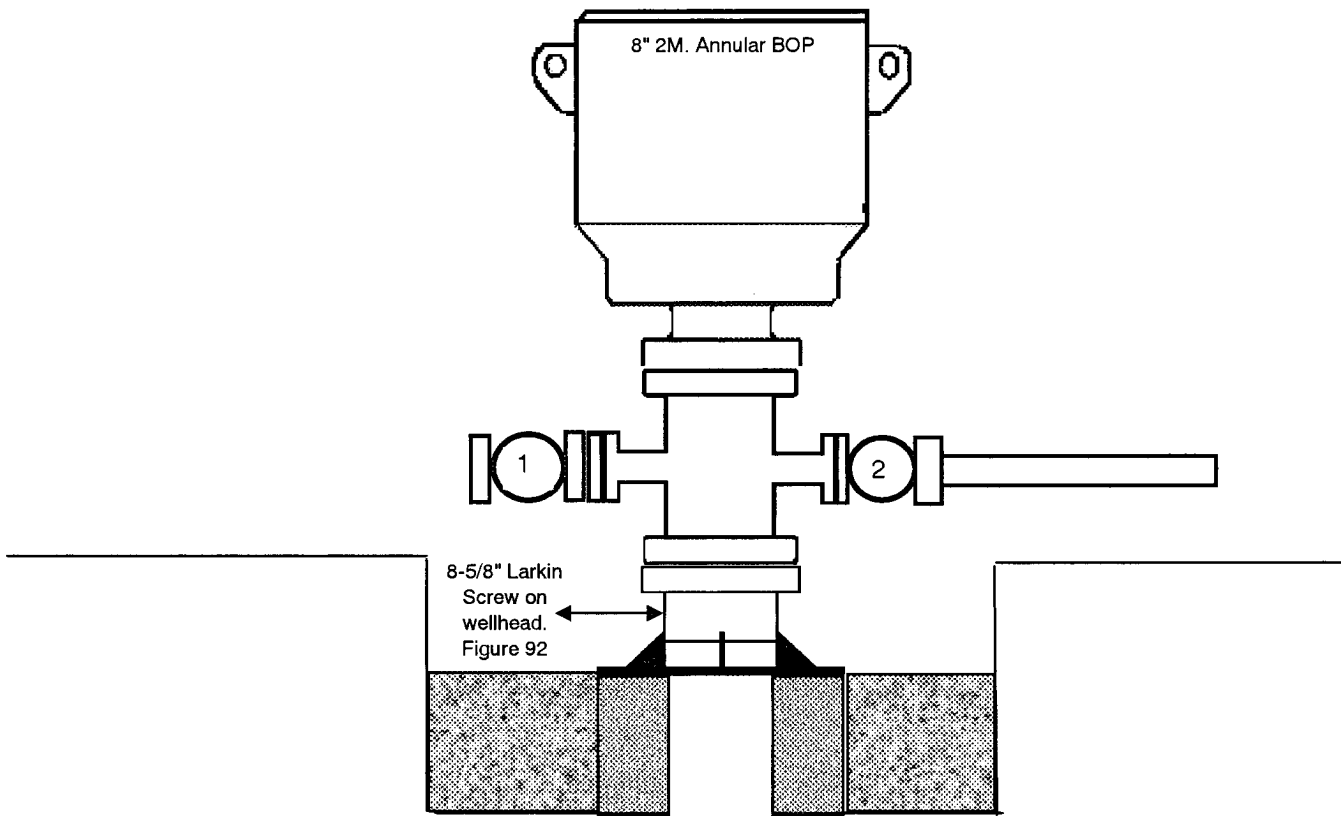

RECEIVED
Hobbs
OCD