

DISTRICT I  
1625 N FRENCH DR., HOBBS, NM 88240

DISTRICT II  
1301 W. GRAND AVENUE, ARTESIA, NM 88210

DISTRICT III  
1000 Rio Brazos Rd., Aztec, NM 87410

DISTRICT IV  
12310 S. ST. FRANCIS DR., SANTA FE, NM 87505

State of New Mexico  
Energy, Minerals and Natural Resources Department

## OIL CONSERVATION DIVISION

12310 SOUTH ST. FRANCIS DR.  
Santa Fe, New Mexico 87505

Form C-102  
Revised October 12, 2005  
Submit to Appropriate District Office  
State Lease - 4 Copies  
Fee Lease - 3 Copies

### WELL LOCATION AND ACREAGE DEDICATION PLAT

☐ AMENDED REPORT

API Number <b>30-025-39222</b>	Pool Code <b>32300</b>	Pool Name <b>Hobbs, San Andres East</b>
Property Code <b>300385</b>	Property Name <b>EAST HOBBS SA UNIT</b>	Well Number <b>210</b>
OGRID No. <b>220420</b>	Operator Name <b>ARENA RESOURCES, INC.</b>	Elevation <b>3587'</b>

#### Surface Location

UL or lot No.	Section	Township	Range	Lot Idn	Feet from the	North/South line	Feet from the	East/West line	County
G	29	18-S	39-E		2310	NORTH	1025	EAST	LEA

#### Bottom Hole Location If Different From Surface

UL or lot No.	Section	Township	Range	Lot Idn	Feet from the	North/South line	Feet from the	East/West line	County
Dedicated Acres <b>25.94</b>	Joint or Infill	Consolidation Code	Order No.						

NO ALLOWABLE WILL BE ASSIGNED TO THIS COMPLETION UNTIL ALL INTERESTS HAVE BEEN CONSOLIDATED  
OR A NON-STANDARD UNIT HAS BEEN APPROVED BY THE DIVISION

<p>LOT 1</p> <p>2310'</p> <p>25.91 AC.</p> <p>LOT 2</p> <p>1025'</p> <p>25.94 AC.</p> <p>LOT 3</p> <p>25.96 AC.</p> <p>LOT 4</p> <p>25.99 AC.</p> <p>LEA COUNTY, STATE OF NEW MEXICO</p> <p>STATE OF TEXAS</p> <p>GEODETIC COORDINATES NAD 27 NME SURFACE LOCATION</p> <p>Y=627705.7 N X=889300.7 E</p> <p>LAT.=32.719269° N LONG.=103.067566° W</p>	<p><b>OPERATOR CERTIFICATION</b></p> <p>I hereby certify that the information herein is true and complete to the best of my knowledge and belief, and that this organization either owns a working interest or unleased mineral interest in the land including the proposed bottom hole location or has a right to drill this well at this location pursuant to a contract with an owner of such mineral or working interest, or to a voluntary pooling agreement or a compulsory pooling order heretofore entered by the division.</p> <p><i>Colleen Robinson</i> 10-7-08 Signature Date</p> <p><b>COLLEEN ROBINSON</b> Printed Name</p>
	<p><b>SURVEYOR CERTIFICATION</b></p> <p>I hereby certify that the well location shown on this plat was plotted from field notes of actual surveys made by me or under my supervision, and that the same is true and correct to the best of my belief.</p> <p>SEPTEMBER 29 2008 DSS</p> <p>Date Surveyed Signature &amp; Seal of Professional Surveyor <i>Ronald J. Eidson</i> 10/02/08 RECEIVED SURVEYOR</p>
	<p>Certificate No. <b>GARY G. EIDSON 12641</b> <b>RONALD J. EIDSON 3239</b></p>

**SECTION 29, TOWNSHIP 18 SOUTH, RANGE 39 EAST, N.M.P.M.,**  
LEA COUNTY, NEW MEXICO

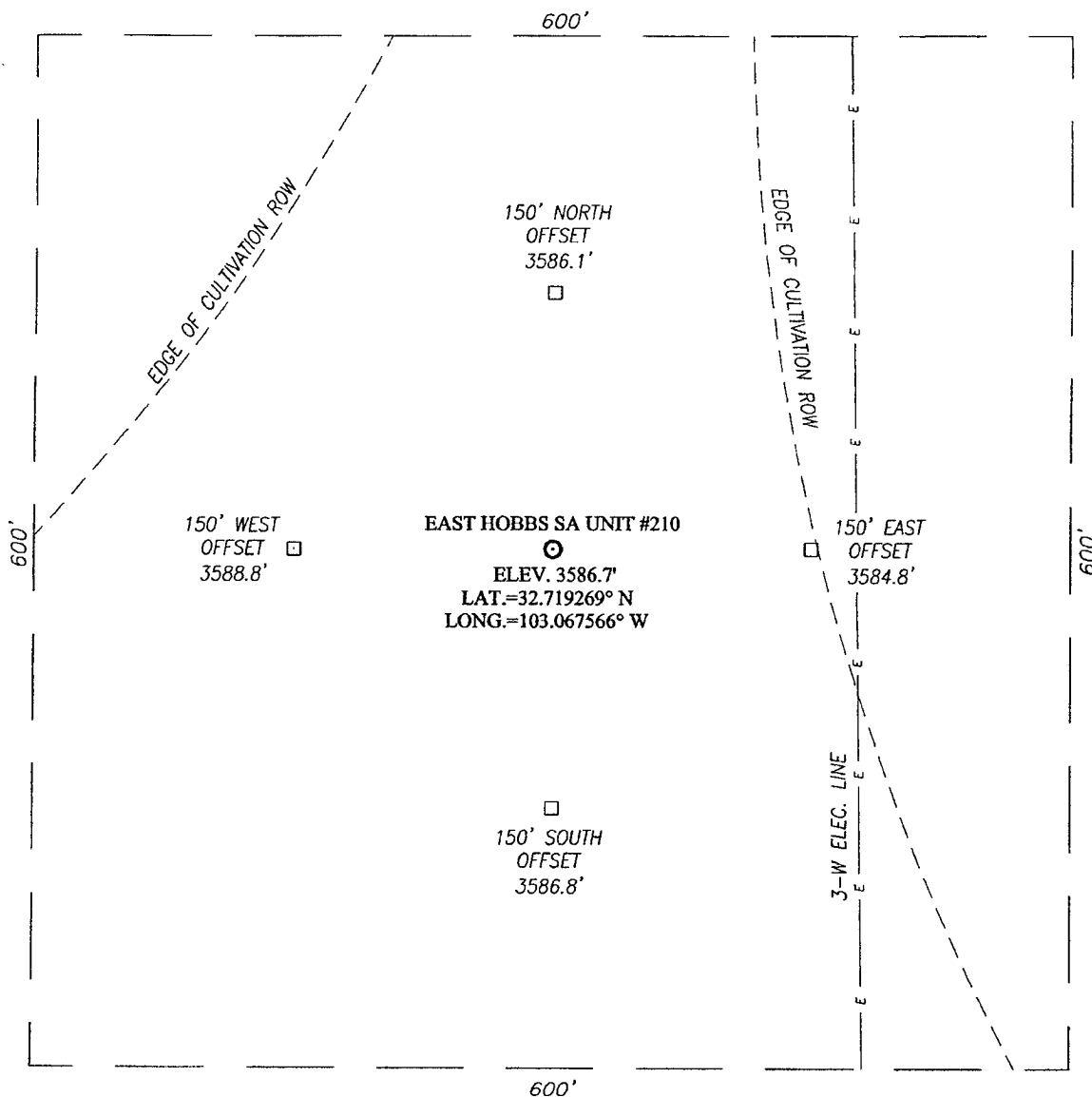

**DIRECTIONS TO LOCATION**

FROM THE INTERSECTION OF HIGHWAY 62-180 AT THE STATE LINE, GO WEST ON HIGHWAY 62-180 APPROX. 0.1 MILE. TURN LEFT AND GO SOUTH APPROX. 0.2 MILES TO EDGE OF CULTIVATION ROW. FOLLOW CULTIVATION ROW APPROX. 0.2 MILES. THIS LOCATION IS APPROX. 150 FEET WEST.

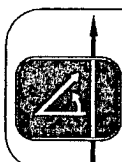

PROVIDING SURVEYING SERVICES  
SINCE 1946  
**JOHN WEST SURVEYING COMPANY**  
412 N. DAL PASO  
HOBBS, N.M. 88240  
(575) 393-3117

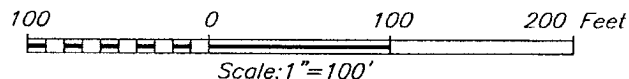

**ARENA RESOURCES, INC.**

EAST HOBBS SA UNIT #210 WELL  
LOCATED 2310 FEET FROM THE NORTH LINE  
AND, 1025 FEET FROM THE EAST LINE OF SECTION 29,  
TOWNSHIP 18 SOUTH, RANGE 39 EAST, N.M.P.M.,  
LEA COUNTY, NEW MEXICO.

Survey Date: 9/29/08	Sheet 1 of 1 Sheets
W.O. Number: 08.11.1413	Dr By: DSS
Date: 10/2/08	Rev 1:
08111413	Scale: 1"=100'

# VICINITY MAP

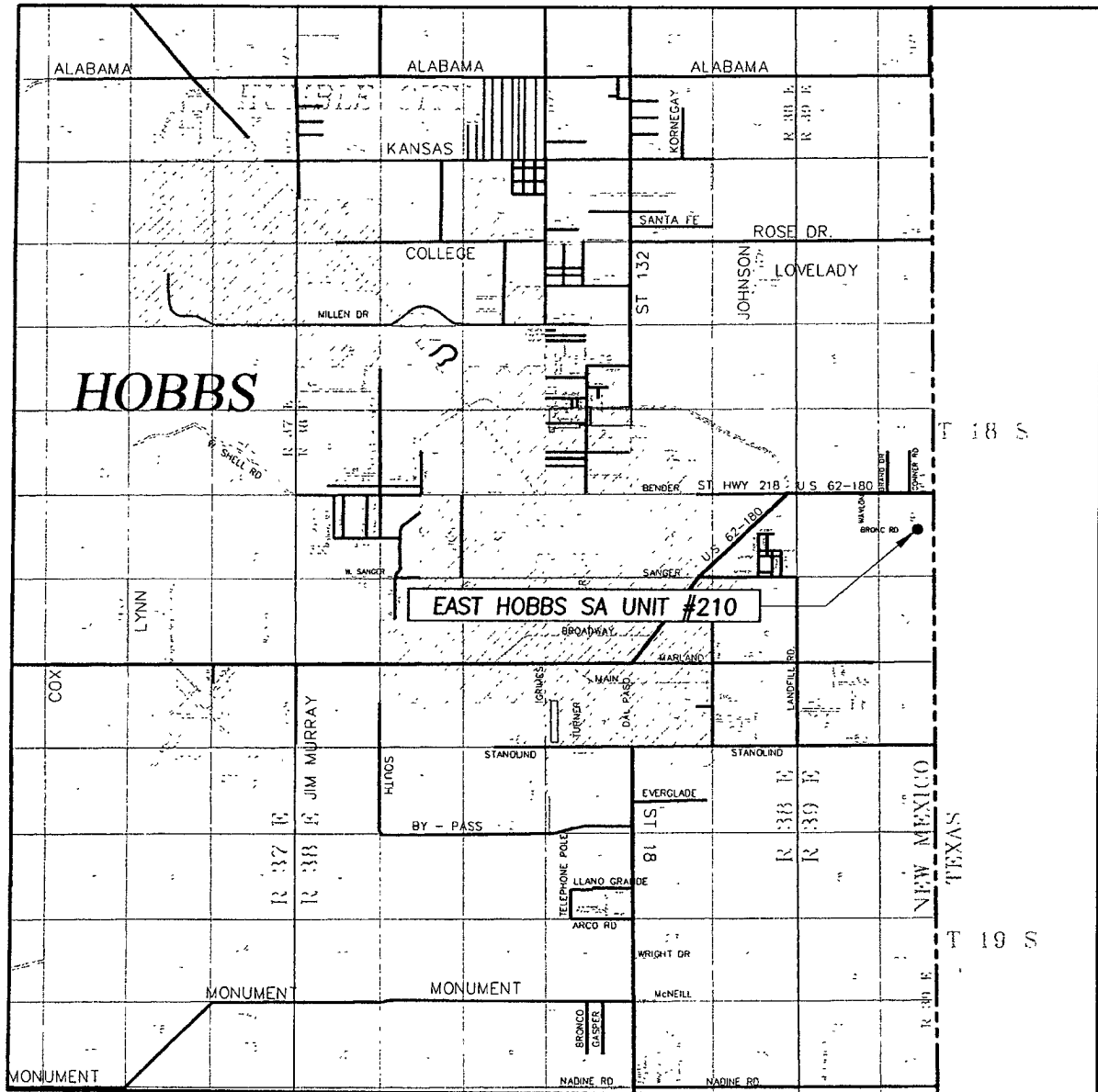

SCALE: 1" = 2 MILES

SEC. 29 TWP. 18-S RGE. 39-E

SURVEY N.M.P.M.

COUNTY LEA STATE NEW MEXICO

DESCRIPTION 2310' FNL & 1025' FEL

ELEVATION 3587'

OPERATOR ARENA RESOURCES, INC.

LEASE EAST HOBBS SA UNIT



PROVIDING SURVEYING SERVICES  
SINCE 1946  
JOHN WEST SURVEYING COMPANY  
412 N. DAL PASO  
HOBBS, N.M. 88240  
(575) 393-3117

NORTH

