

District I
1625 N. French Dr., Hobbs, NM 88240
District II
811 South First, Artesia, NM 88210
District III
1000 Rio Brazos Road, Aztec, NM 87410
District IV
2040 South Pacheco, Santa Fe, NM 87505

State of New Mexico
Energy Minerals and Natural Resources

Form C-101
Revised March 17, 1999

Oil Conservation Division
2040 South Pacheco
Santa Fe, NM 87505

Submit to appropriate District Office
State Lease - 6 Copies
Fee Lease - 5 Copies

☐ AMENDED REPORT

APPLICATION FOR PERMIT TO DRILL, RE-ENTER, DEEPEN, PLUGBACK, OR ADD A ZONE

¹ Operator Name and Address CONCHO RESOURCES INC. 550 W. TEXAS, SUITE 1300 MIDLAND TX 79701		² OGRID Number 193407
		³ API Number 30-025-22374
⁴ Property Code 33135	⁵ Property Name Natural-State	⁶ Well No. 1

⁷ Surface Location

UL or lot no.	Section	Township	Range	Lot Idn	Feet from the	North/South line	Feet from the	East/West line	County
E	4	12S	36E		1980	North	660	West	Lea

⁸ Proposed Bottom Hole Location If Different From Surface

UL or lot no.	Section	Township	Range	Lot Idn	Feet from the	North/South line	Feet from the	East/West line	County
⁹ Proposed Pool 1 Undesignated Wildcat, Atoka						¹⁰ Proposed Pool 2			

¹¹ Work Type Code Re-entry	¹² Well Type Code Gas	¹³ Cable/Rotary Rotary	¹⁴ Lease Type Code State	¹⁵ Ground Level Elevation 4029'
¹⁶ Multiple	¹⁷ Proposed Depth 13927	¹⁸ Formation Atoka	¹⁹ Contractor Unknown	²⁰ Spud Date 12/20/2003

²¹ Proposed Casing and Cement Program

Hole Size	Casing Size	Casing weight/foot	Setting Depth	Sacks of Cement	Estimated TOC
17 1/2"	12 3/4"	34#	412'	325 sx	Surface
11"	8 5/8"	32#	4496' **	1025 sx	Circ.
7 7/8"	5 1/2"	17#	12600'	2275 sx Poz H	

²² Describe the proposed program. If this application is to DEEPEN or PLUG BACK, give the data on the present productive zone and proposed new productive zone.

Describe the blowout prevention program, if any. Use additional sheets if necessary.

** Note: 8 5/8" casing: We will tie into the existing 8 5/8" @ 1117' & cement to surface.

BOP Type	Working Pressure	Test Pressure
Annular	5000	3000
Double Ram	5000	5000

Permit Expires 1 Year From Approval Date Unless Drilling Underway

Re-entry

²³ I hereby certify that the information given above is true and complete to the best of my knowledge and belief.

Signature: *Brenda Coffman*

Printed Name: BRENDA COFFMAN

Title: REGULATORY ANALYST

Date: 11/17/2003

Phone: (432)685-4373

OIL CONSERVATION DIVISION

Approved by: *Paul G. King*

Title:

PETROLEUM ENGINEER

Approval Date: NOV 24 2003

Expiration Date:

Conditions of Approval:

Attached ☐

District I
1625 N. French Dr., Hobbs, NM 88240
District II
811 South First, Artesia, NM 88210
District III
1000 Rio Brazos Rd., Aztec, NM 87410
District IV
2040 South Pacheco, Santa Fe, NM 87505

State of New Mexico
Energy, Minerals & Natural Resources Department

Form C-102
Revised August 15, 2000

OIL CONSERVATION DIVISION
2040 South Pacheco
Santa Fe, NM 87505

Submit to Appropriate District Office
State Lease - 4 Copies
Fee Lease - 3 Copies

☐ AMENDED REPORT

WELL LOCATION AND ACREAGE DEDICATION PLAT

1 API Number 30-025-22374		2 Pool Code L		3 Pool Name Undesignated Wildcat, Atoka	
4 Property Code 33135		5 Property Name Natural-State			6 Well Number 1
7 OGRID No. 193407		8 Operator Name CONCHO RESOURCES INC.			9 Elevation 4039

10 Surface Location

UL or lot no.	Section	Township	Range	Lot Idn	Feet from the	North/South line	Feet from the	East/West line	County
E	4	12S	36E		1980	North	660	West	Lea

11 Bottom Hole Location If Different From Surface

UL or lot no.	Section	Township	Range	Lot Idn	Feet from the	North/South line	Feet from the	East/West line	County

12 Dedicated Acres 320	13 Joint or Infill	14 Consolidation Code	15 Order No.
---------------------------	--------------------	-----------------------	--------------

NO ALLOWABLE WILL BE ASSIGNED TO THIS COMPLETION UNTIL ALL INTERESTS HAVE BEEN CONSOLIDATED OR A NON-STANDARD UNIT HAS BEEN APPROVED BY THE DIVISION

16 	17 OPERATOR CERTIFICATION I hereby certify that the information contained herein is true and complete to the best of my knowledge and belief. Signature: <u>Brenda Coffman</u> Printed Name: <u>BRENDA COFFMAN</u> Title: <u>REGULATORY ANALYST</u> Date: <u>11/17/2003</u>		
	18 SURVEYOR CERTIFICATION I hereby certify that the well location shown on this plat was plotted from field notes of actual surveys made by me or under my supervision, and that the same is true and correct to the best of my belief. Date of Survey: Signature and Seal of Professional Surveyor:		
	Certificate Number		

NEW MEXICO OIL CONSERVATION COMMISSION
WELL LOCATION AND ACREAGE DEDICATION PLAT

Form C-102
 Supersedes C-128
 Effective 1-1-65

All distances must be from the outer boundaries of the Section.

Operator WILLIAMSON, BRUNNER & DUNLAP			Lessee Natural STATE		Well No. 1
Unit Letter E	Section 4	Township 12 SOUTH	Range 36 EAST	County LEA	
Actual Footage Location of Well: 1980 feet from the NORTH line and 660 feet from the WEST line					
Ground Level Elev. 4029.2	Producing Formation <i>Permian</i>	Pool <i>Wildcat</i>	Dedicated Acreage 40		

1. Outline the acreage dedicated to the subject well by colored pencil or hachure marks on the plat below.
2. If more than one lease is dedicated to the well, outline each and identify the ownership thereof (both as to working interest and royalty).
3. If more than one lease of different ownership is dedicated to the well, have the interests of all owners been consolidated by communitization, unitization, force-pooling, etc?

☐ Yes ☐ No If answer is "yes," type of consolidation _____

If answer is "no," list the owners and tract descriptions which have actually been consolidated. (Use reverse side of this form if necessary.) _____

No allowable will be assigned to the well until all interests have been consolidated (by communitization, unitization, forced-pooling, or otherwise) or until a non-standard unit, eliminating such interests, has been approved by the Commission.

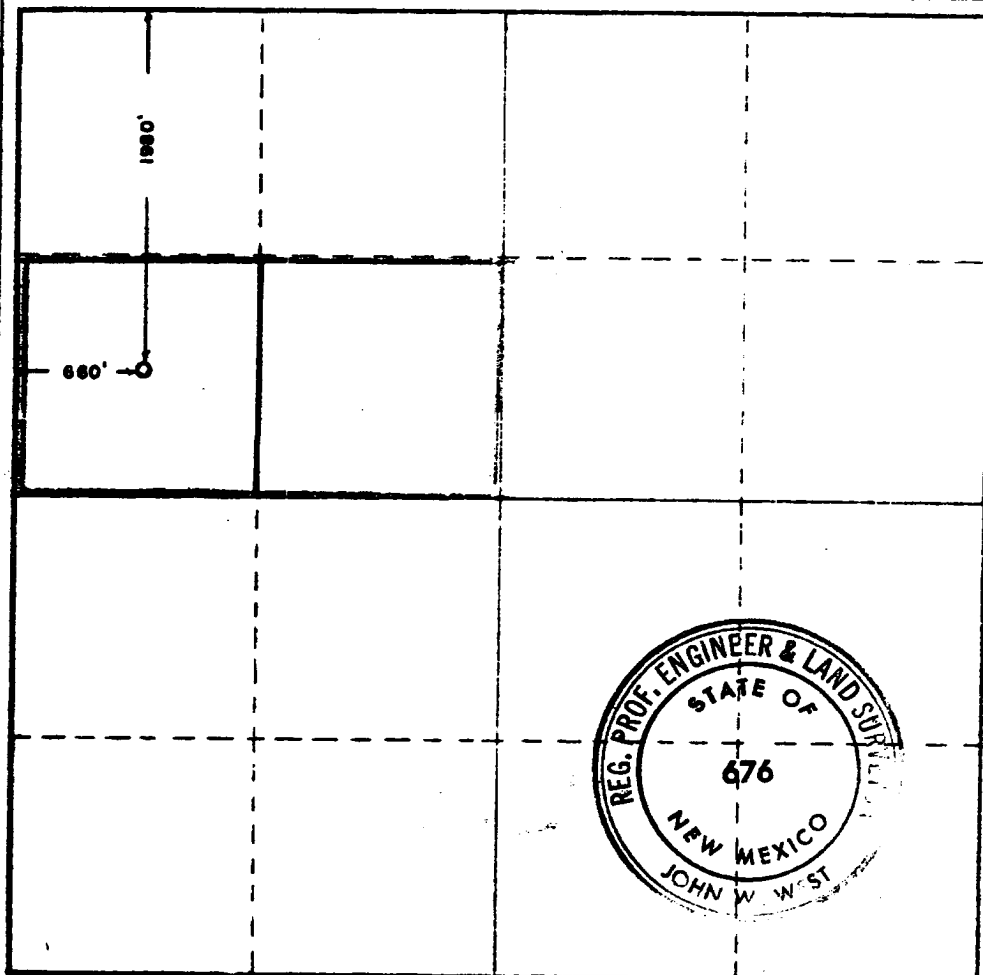

CERTIFICATION

I hereby certify that the information contained herein is true and complete to the best of my knowledge and belief.

Ross Brunner
 Name
Partner
 Position
Williamson, Brunner & Dunlap
 Company
12/20/67
 Date

I hereby certify that the well location shown on this plat was plotted from field notes of actual surveys made by me or under my supervision, and that the same is true and correct to the best of my knowledge and belief.

Dec. 12, 1967

Date Surveyed

Registered Professional Engineer and/or Land Surveyor

John W. West
 Certificate No. **676**

