

Jones, William V., EMNRD

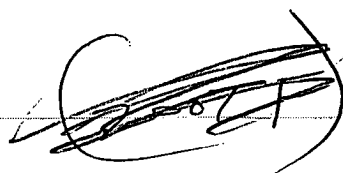

From: Jones, William V., EMNRD
Sent: Tuesday, July 31, 2007 11:08 AM
To: 'Billy Prichard'
Cc: Ezeanyim, Richard, EMNRD
Subject: SWD Application on behalf of Bobby McKay dba 5 A Oil Company: Wm Snyder #1 30-025-02703 San Andres and Glorieta

Hello Mr. Bill Prichard:

This application on behalf of Bobby McKay is to re-activate SWD-931 which allowed Marks & Garner to inject into the lower SA and upper Glorieta near Lovington. Apparently Marks&Garner never used this well for injection - the well file does not show it to be used.

This area and this injection interval has been the subject of numerous Division and Commission cases in recent years the worst of which involved injection into this interval which traveled almost a mile and entered corroded wellbores and may have ruined some late-stage Permian oil production. The wellbores in this area that were not cemented across the San Andres and Glorieta and were drilled in the 50s and 60s have corroded casing and present a danger - if injection is allowed - to lower oil and gas producing pools. Affected owners would be the operators in at least these Pools: Big Dog-Miss gas NW Big Dog-Strawn, South Big Dog-Strawn, West Lovington-Strawn, and Townsend-Permian.

Since we cannot be sure of the extent of "affected" area due to this injection, and very similar and nearby injection has caused damage in the past and could cause damage from this well's injection, this application is being denied.

You could make a similar case to a Division Examiner by presenting technical testimony. Please note, that if this is to be pursued, all affected parties should be notified including those operators in the aforementioned pools. Also, all lands without an operator of record from the San Andres to the Morrow must have the lessee notified or if no lessee, the mineral interest owner. The AOR should be at least one mile or as determined by other methods.

Thank You,

William V. Jones PE
New Mexico Oil Conservation Division
1220 South St. Francis
Santa Fe, NM 87505
505-476-3448

7/31/2007

**Bobby McKay DBA 5"A" Oil Company
C108 (Application for Authorization to Inject)
WM Snyder # 001
API # 30-025-02703
1980 FNL X 1980 FEL
Unit Letter G, Section 35, T15S, R35E
Lea County, New Mexico**

RECEIVED
2007 JUL 16 PM 1 30

EMNRD
New Mexico Oil Conservation Division
Engineering Bureau
1220 South St. Francis Drive
Santa Fe, NM 87505

Attention: William V. Jones

Please find enclosed form C108 for the above well. Per SWD-931 NMOCD District 1 will be notified to witness PBTD check. Seating Nipple and tubing will be run to a depth of 6500 feet and the disposal interval will be swabbed for fluid production. Static bottom hole pressure will be calculated from the swab test. Should you have questions or need further information to not hesitate to call or email.

Sincerely,



Billy (Bill) E. Prichard
Agent for Bobby McKay
505-390-9100
Email: shabillron01@warpdriveonline.com

Injection Permit Checklist 2/8/07

SWD Order Number _____ **Dates:** Division Approved _____ District Approved _____

Well Name/Num: WM SNYDER #1 Date Spudded: 5/23/59

API Num: (30-) 025-02723 County: LEA

Footages 1980 FNL/1980 FEL Sec 35 Tsp 15S Rge 35E BILL E. PRITCHARD

Operator Name: BOBBY McKAY DBA 5" A" OIL CO. Contact _____

Operator Address: 46 PUEBLO WEST LLC 1611 SE 5th St. SEMINOLE TX 79360

Current Status of Well: WC OIL Planned Work: SWD Inj. Tubing Size: 2 7/8" @ 4700'

	Hole/Pipe Sizes	Depths	Cement	Top/Method
Surface	13 3/8"	390'	425	CIRC
Intermediate	11" 8 5/8"	4750	1800+300	Calc to surf.
Production	7 7/8" 5 1/2"	10,765'	300 SX	
Last DV Tool				
Open Hole/Liner				
Plug Back Depth				

Diagrams Included (Y/N): Before Conversion ☒ After Conversion ☒

Checks (Y/N): Well File Reviewed ☒ ELogs in Imaging only on old injection logs

Intervals:	Depths	Formation	Producing (Yes/No)
Salt/Potash			
Capitan Reef			
Cliff House, Etc:			
Formation Above	<u>4750</u>	<u>WC SA</u>	
Top Inj Interval	<u>4750</u>	<u>SA</u>	
Bottom Inj Interval	<u>6800</u>	<u>GLR</u>	
Formation Below			

Depleted WC OIL
was Marked as Cones

970 PSI Max. WHIP

Yes Open Hole (Y/N)

No Deviated Hole (Y/N)

Fresh Water: Depths: 60'-240' Wells(Y/N) Yes Analysis Included (Y/N): ☒ Affirmative Statement ☒

Salt Water Analysis: Injection Zone (Y/N/NA) _____ DispWaters (Y/N/NA) _____ Types: ABO WC Tournai

Notice: Newspaper(Y/N) ☒ Surface Owner: John Bussell Mineral Owner(s) _____

Other Affected Parties: Munk? Connor, EOG, Chesapeake, acreage, Yates, SNYDER Ranch, Tournai/AOR

AOR/Repairs: NumActiveWells 0 Repairs? _____ Producing in Injection Interval in AOR _____

AOR Num of P&A Wells 2 Repairs? _____ Diagrams Included? _____ RBDMS Updated (Y/N) _____

Well Table Adequate (Y/N) _____ AOR STRs: Sec _____ Tsp _____ Rge _____ UIC Form Completed (Y/N) _____

New AOR Table Filename _____ Sec _____ Tsp _____ Rge _____ This Form completed _____

Conditions of Approval: Sec _____ Tsp _____ Rge _____ Data Request Sent _____

Test Plug / Run in Survey
Confirm INJ depth to Laura #1 or VICE versa

AOR Required Work: _____

Required Work to this Well: _____

OPERATOR <u>Tamarack Pet. Co. Inc.</u>		DATE <u>P+A 1987</u>	
LEASE <u>Laura #</u>	WELL No. <u>1</u>	LOCATION <u>Unit B Sect 35 T.15 R.35</u>	

P+A

Surface plug

13 3/8 " casing set at 440 ' with 420 sx of C cement

Hole size 12 1/4 "

Circ to Surface

OFFSET

plug 1943

plug 4924

8 5/8 " casing set at 4750 ' with 3080 sx of lite cement

Total Depth 10750 ' Hole size 11 "

plug 6343

plug 7826

plug 9817

plug 10592

Circ to surface

TD 10750

OPERATOR	Integrity Oil & Gas		DATE	PLA 1999
LEASE	Aaron State	WELL No.	Unit J	LOC. 35 T15 R35E

PLA

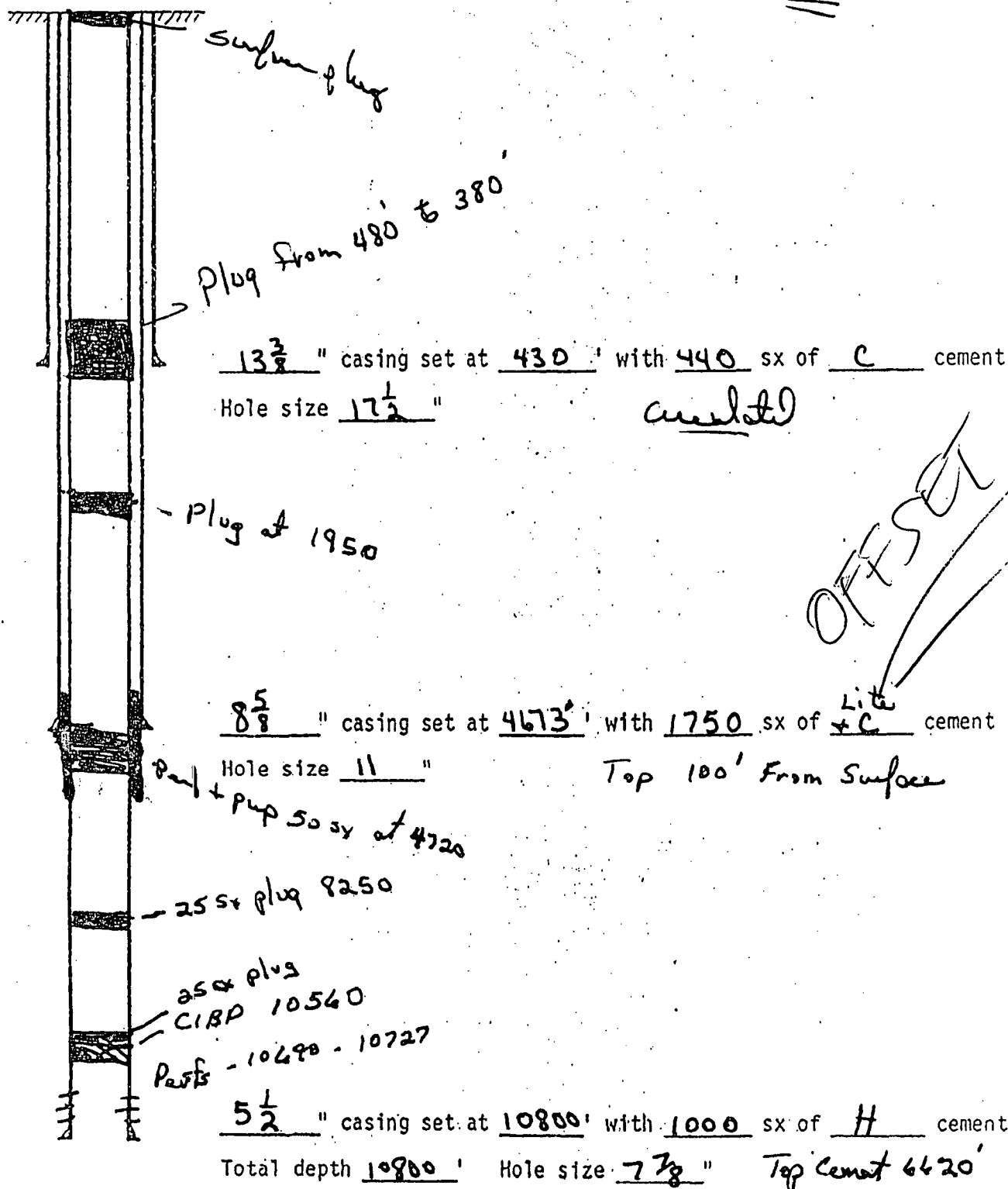

OFFSE

CMD :
OG5SECT

ONGARD
INQUIRE LAND BY SECTION

07/31/07 09:34:16
OGOWVJ -TPOM
PAGE NO: 2

Sec : 35 Twp : 15S Rng : 35E Section Type : NORMAL

L 40.00 Fee owned U A	K 40.00 Fee owned	J 40.00 MI VB0600 0000 YATES PETROLEUM C 12/01/09 A	I 40.00 MI VB0600 0000 YATES PETROLEUM C 12/01/09
M 40.00 Fee owned U A	N 40.00 Fee owned	O 40.00 MI VB0600 0000 YATES PETROLEUM C 12/01/09	P 40.00 MI VB0600 0000 YATES PETROLEUM C 12/01/09 A

PF01 HELP
PF07 BKWD

PF02
PF08 FWD

PF03 EXIT
PF09 PRINT

PF04 GoTo
PF10 SDIV

PF05
PF11

PF06
PF12

CMD :
OG5SECT

ONGARD
INQUIRE LAND BY SECTION

07/31/07 09:33:52
OGOWVJ -TP0M
PAGE NO: 1

Sec : 35 Twp : 15S Rng : 35E Section Type : NORMAL

D 40.00 Fee owned A	C 40.00 Fee owned	B 40.00 Fee owned A	A 40.00 Fee owned
E 40.00 Fee owned C	F 40.00 Fee owned	G 40.00 Fee owned A	H 40.00 Fee owned

PF01 HELP
PF07 BKWD

PF02
PF08 FWD

PF03 EXIT
PF09 PRINT

PF04 GoTo
PF10 SDIV

PF05
PF11

PF06
PF12

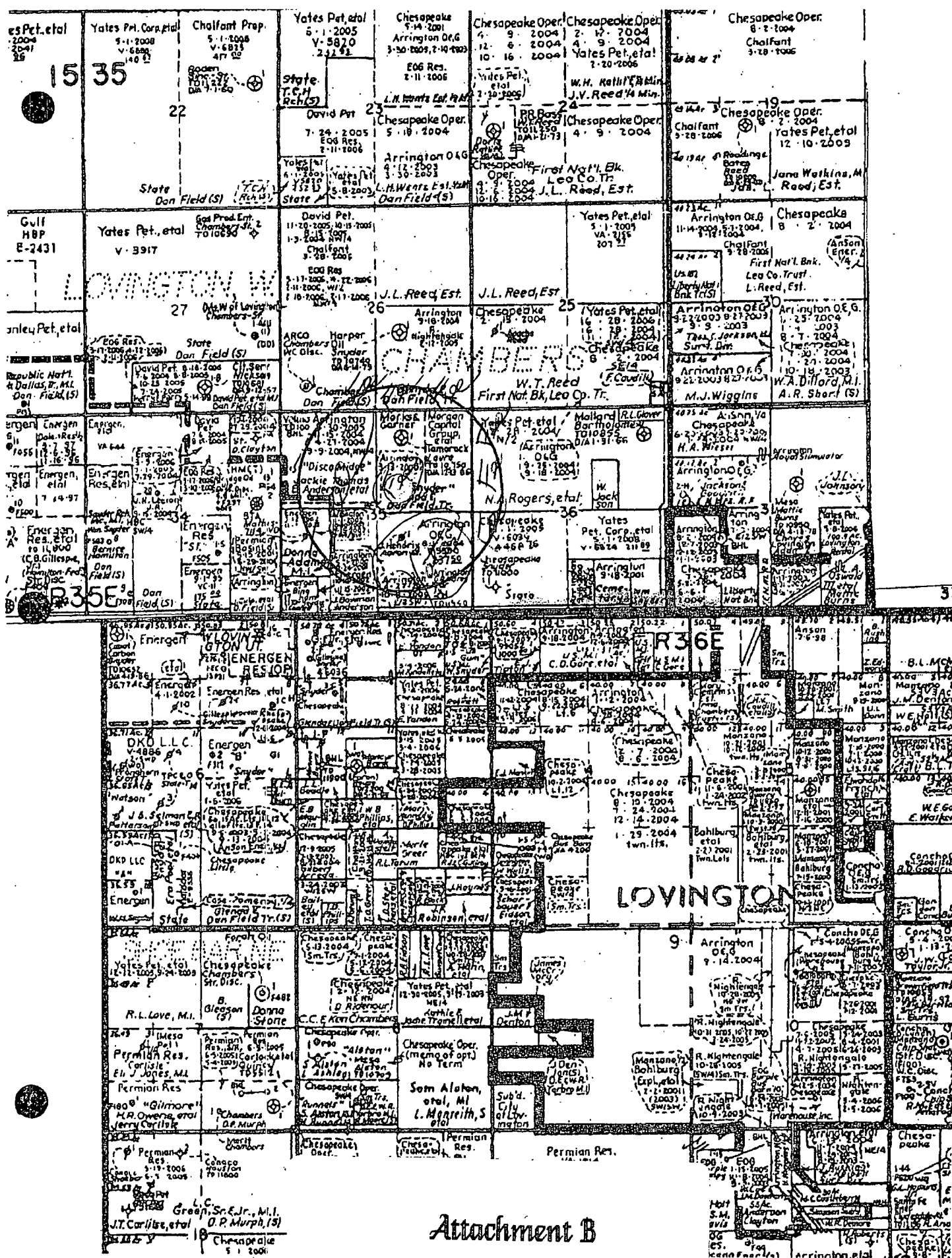

3002502703	WM SNYDER 001	MARKS AND GARNER PRODUCTION LTD CO	1980 N	1980 E	G	35 15S	35E	3,002,502,703	10765
3002528777	AARON STATE 001	INTEGRITY OIL & GAS, INC.	1980 S	1980 E	J	35 15S	35E	1,320	10800
3002529785	LAURA 001	TAMARACK PETROLEUM CO INC	660 N	1980 E	B	35 15S	35E	1,320	10750
3002523971	MATHIS 7114 JV-D 001	BTA OIL PRODUCERS	1980 S	660 W	L	35 15S	35E	2,952	10700
300253295	G R HARE'S EAR 001	DAVID H ARRINGTON OIL & GAS INC	455 S	869 E	P	35 15S	35E	3,054	10525
3002536634	FISHER 35 FEE 001	EOG RESOURCES INC	1247 N	233 W	D	35 15S	35E	3,153	11917
3002502696	DAISY CHAMBERS 001	DEVON ENERGY PRODUCTION COMPANY, LP	660 S	660 W	M	26 15S	35E	3,734	14015
3002535236	SNYDER 36 001	CHESAPEAKE OPERATING, INC.	660 S	660 W	M	36 15S	35E	3,734	11000
3002526339	SNYDER 001	HARPER OIL CO	1980 S	1980 E	J	26 15S	35E	3,960	10740
3002534606	WEST LOVINGTON STRAWN UNIT 017	ENERGEN RESOURCES CORPORATION	330 S	330 W	M	35 15S	35E	4,200	11803
3002521640	BARTHOLOMEW 001	MALLARD PETROLEUM I	660 N	660 E	A	36 15S	35E	6,731	10855

APPLICATION FOR AUTHORIZATION TO INJECT

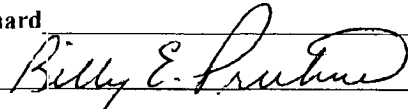
- I. PURPOSE: _____ Secondary Recovery _____ Pressure Maintenance ☒ Disposal _____ Storage
Application qualifies for administrative approval? ☒ Yes _____ No
- II. OPERATOR: **Bobby McKay DBA 5 A Oil Company** Ogrid # **215322**
ADDRESS: **c/o Pueblo West LLC, 1611 SE 5th Street, Seminole, TX 79360**
CONTACT PARTY: **Billy E. Prichard** PHONE: **505-390-9100**
- III. WELL DATA: Complete the data required on the reverse side of this form for each well proposed for injection.
Additional sheets may be attached if necessary.
- IV. Is this an expansion of an existing project? _____ Yes ☒ No
If yes, give the Division order number authorizing the project: _____
- V. Attach a map that identifies all wells and leases within two miles of any proposed injection well with a one-half mile radius circle drawn around each proposed injection well. This circle identifies the well's area of review.
- VI. Attach a tabulation of data on all wells of public record within the area of review which penetrate the proposed injection zone. Such data shall include a description of each well's type, construction, date drilled, location, depth, record of completion, and a schematic of any plugged well illustrating all plugging detail.
- VII. Attach data on the proposed operation, including:
1. Proposed average and maximum daily rate and volume of fluids to be injected;
 2. Whether the system is open or closed;
 3. Proposed average and maximum injection pressure;
 4. Sources and an appropriate analysis of injection fluid and compatibility with the receiving formation if other than reinjected produced water; and,
 5. If injection is for disposal purposes into a zone not productive of oil or gas at or within one mile of the proposed well, attach a chemical analysis of the disposal zone formation water (may be measured or inferred from existing literature, studies, nearby wells, etc.).
- *VIII. Attach appropriate geologic data on the injection zone including appropriate lithologic detail, geologic name, thickness, and depth. Give the geologic name, and depth to bottom of all underground sources of drinking water (aquifers containing waters with total dissolved solids concentrations of 10,000 mg/l or less) overlying the proposed injection zone as well as any such sources known to be immediately underlying the injection interval.
- IX. Describe the proposed stimulation program, if any.
- *X. Attach appropriate logging and test data on the well. (If well logs have been filed with the Division, they need not be resubmitted).
- *XI. Attach a chemical analysis of fresh water from two or more fresh water wells (if available and producing) within one mile of any injection or disposal well showing location of wells and dates samples were taken.
- XII. Applicants for disposal wells must make an affirmative statement that they have examined available geologic and engineering data and find no evidence of open faults or any other hydrologic connection between the disposal zone and any underground sources of drinking water.
- XIII. Applicants must complete the "Proof of Notice" section on the reverse side of this form.
- XIV. Certification: I hereby certify that the information submitted with this application is true and correct to the best of my knowledge and belief.
- NAME: Billy E. Prichard TITLE: Agent
SIGNATURE:  DATE: 7/11/07
E-MAIL ADDRESS: shabillron01@warpdiveonline.com
- * If the information required under Sections VI, VIII, X, and XI above has been previously submitted, it need not be resubmitted. Please show the date and circumstances of the earlier submittal: NMOCD SWD-931 issued August 2, 2004 has expired

**Bobby McKay DBA 5"A" Oil Company
C108 (Application for Authorization to Inject)
WM Snyder # 001
API # 30-025-02703
1980 FNL X 1980 FEL
Unit Letter G, Section 35, T15S, R35E
Lea County, New Mexico**

- I. The purpose of this application is for the conversion of the above well from a Wolfcamp oil well to a commercial salt water disposal well. This application qualifies for administrative approval.
- II. Bobby McKay DBA 5 "A" Oil Company Ogrid # 215322
c/o Pueblo West LLC
1611 SE 5th Street
Seminole, TX 79360
Contact ; Billy E. Prichard 505-390-9100
- III. Well data – Attachment A
- IV. This is not an expansion of an existing project
- V. Map of Area of Review – Attachment B
- VI. Wells in AOR – Attachment C
- VII. The proposed average daily disposal rate is expected to be 1500 BWPD with a maximum disposal rate of 5000 BWPD.
This will be an open system
The proposed average daily disposal pressure is expected to be 250 psig with a maximum disposal pressure of 950 psig.
The disposal fluid will be produced water trucked in from numerous producing formations in southeastern New Mexico. – Attachment D
- VIII. Geological Data – Attachment E
- IX. No stimulation is planned unless rates and pressures dictate.
- X. Logs and completion data submitted by previous operator.
- XI. Numerous fresh water wells were identified in the 1.0 mile AOR. – Attachment F
- XII. Affirmative Water Statement – Attachment G
- XIII. Proof of Notify and Proof of Publication – Attachment H

Bobby McKay DBA 5"A" Oil Company Ogrid # 215322 printed 7/4/2007
See attached documentation of transfer of API # 30-025-02703 to Bobby McKay
when SWD permit is issued.

WM Stryder # 001
 API # 30-025-02703
 1980 FNL X 1980 FEL
 Unit Letter G, Section 35, T15S, R35E
 Lea County, New Mexico
 Prior to Conversion to SWD

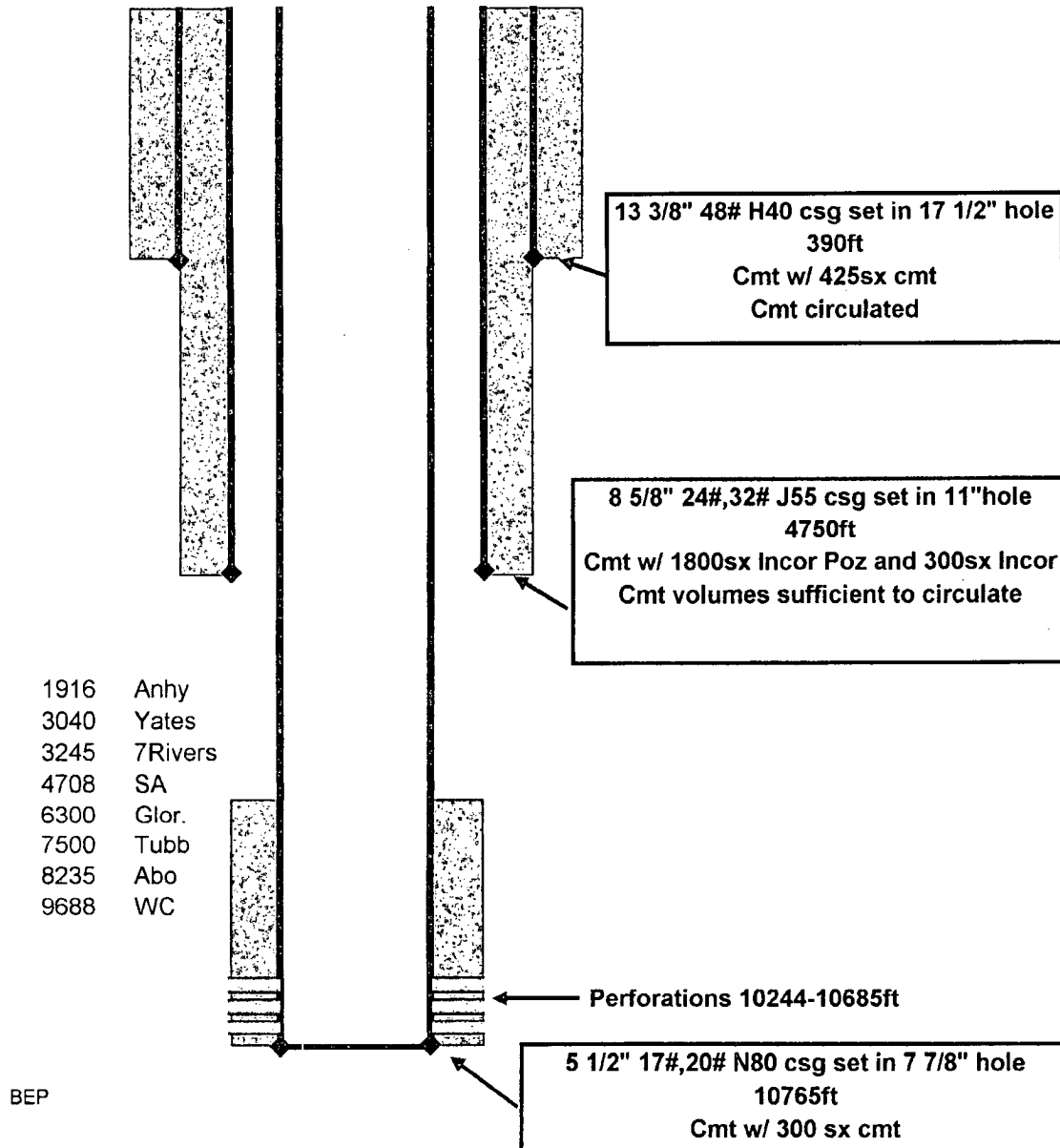

Attachment A

**Bobby McKay DBA 5"A" Oil Company
C108 (Application for Authorization to Inject)
WM Snyder # 001
API # 30-025-02703
1980 FNL X 1980 FEL
Unit Letter G, Section 35, T15S, R35E
Lea County, New Mexico**

Well Data

Spud 5/23/1959 as Townsend Wolfcamp Oil well

13 3/8" 48# H-40 casing set in 17 1/2" hole at 390 feet. Cemented with 425 sacks cement. Cement Circulated

8 5/8" 24# & 32# J55 casing set in 11" hole at 4750 feet. Cemented with 1800 sacks Incor Poz with 6% gel and 300 sacks Incor Neat. Records do not indicate that cement circulated to surface. Cement volumes are sufficient to circulate.

5 1/2" 17# & 20# N80 casing set in 7 7/8" hole at 10765 feet. Cemented with 300 sacks cement.

Perforations

10244-10252 feet

10590-10598 feet

10628-10660 feet

10675-10685 feet

Production Summary of api:3002502703 pool:TOWNSEND;PERMO UPPER PENN

producing year	Oil	Gas	Water	Co2
1992	77812	102578	47485	0
1993	706	0	2334	0
1994	568	0	1558	0
1995	532	0	853	0
1996	677	0	1599	0
1997	605	0	1248	0
1998	15	0	0	0
1999	21	0	0	0
2000	244	0	382	0
2001	31	0	71	0
2002	9	0	3	0
2003	0	0	0	0
2004	0	0	0	0
2005	0	0	0	0
2006	0	0	0	0
2007	0	0	0	0
SUP			18	0

Attachment A

WM Snyder # 001
 API # 30-025-02703
 1980 FNL X 1980 FEL
 Unit Letter G, Section 35, T15S, R35E
 Lea County, New Mexico
 After conversion to SWD

NOT DONE

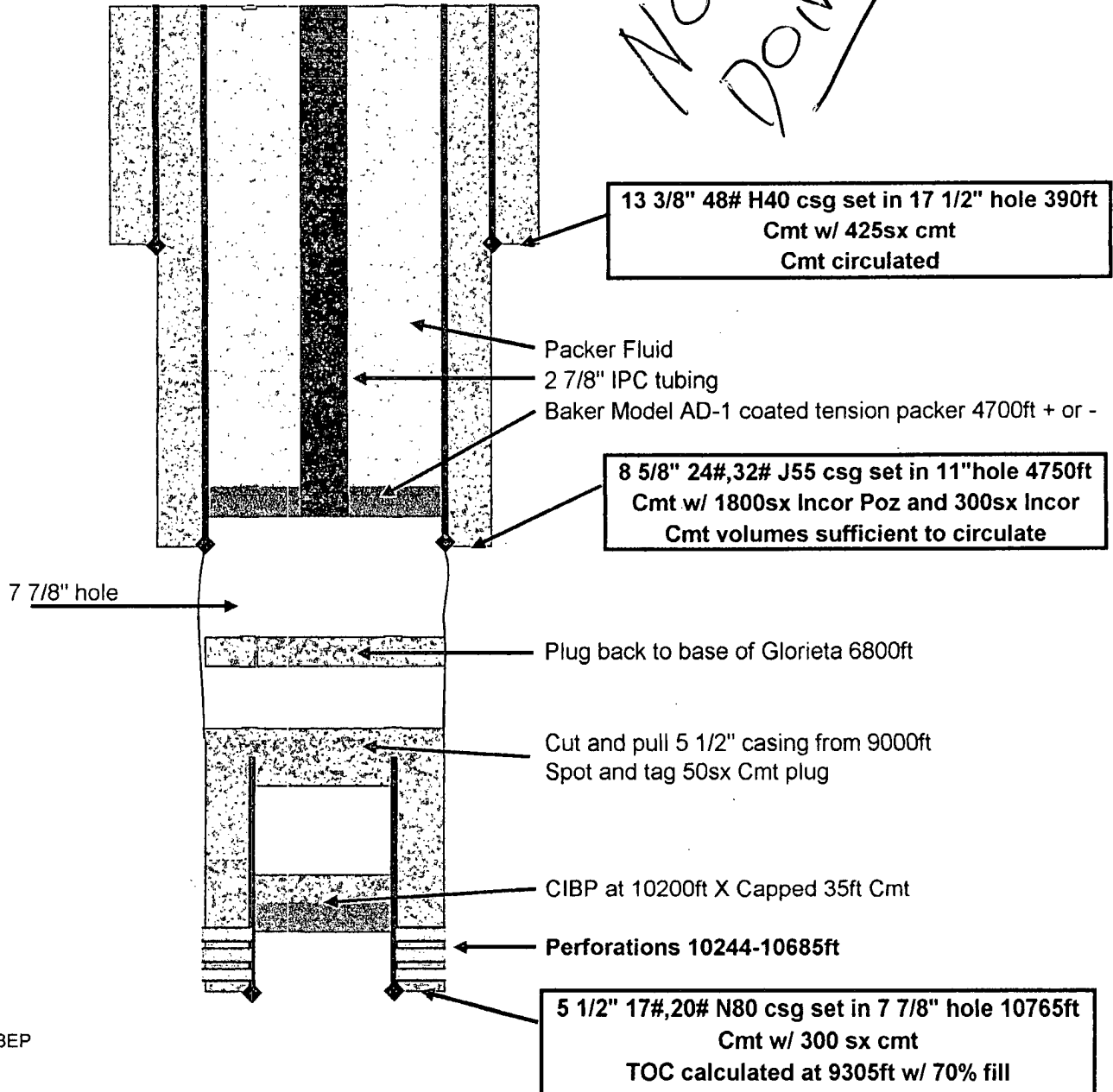

Attachment A

**Bobby McKay DBA 5"A" Oil Company
C108 (Application for Authorization to Inject)
WM Snyder # 001
API # 30-025-02703
1980 FNL X 1980 FEL
Unit Letter G, Section 35, T15S, R35E
Lea County, New Mexico**

Wells in the 0.5 mile Area of Review

~~Harper Oil Company
Snyder #001
API # 30-025-26339
1980 FSL & 1980 FEL
Unit Letter "J", Section 26, T15S, R35E
Plugged and Abandoned as Dry Hole 6/7/1979~~

OUT of
AOR

Tamarack Petroleum Company, Inc
Laura # 001
API # 30-025-29785
660 FNL & 1980 FEL
Unit Letter "B", Section 35, T15S, R35E
Plugged and Abandoned 1990

Integrity Oil and Gas, Inc
Aaron State # 001
API # 30-025-28777
1980 FSL & 1980 FEL
Unit Letter "J", Section 35, T15S, R35E
Plugged and Abandoned 1999

OK

~~EOG RESOURCES INC
Fisher 35 # 001
API # 30-025-36634
1247 FNL & 233 FWL
Unit Letter "D", Section 35, T15S, R35E
Plugged and Abandoned 2004~~

OUT
of AOR