

DISTRICT I

1625 N. FRENCH DR., HOBBES, NM 88240

DISTRICT II

1301 W. GRAND AVENUE, ARTESIA, NM 88210

DISTRICT III

1000 Rio Brazos Rd., Aztec, NM 87410

DISTRICT IV

1225 S. ST. FRANCIS DR., SANTA FE, NM 87505

State of New Mexico

Energy, Minerals and Natural Resources Department

OIL CONSERVATION DIVISION
1220 SOUTH ST. FRANCIS DR.
Santa Fe, New Mexico 87505

Form C-102

Revised JUNE 10, 2003

Submit to Appropriate District Office

State Lease - 4 Copies

Fee Lease - 3 Copies

WELL LOCATION AND ACREAGE DEDICATION PLAT

X AMENDED REPORT

API Number 30-025-37729		Pool Code 22900	Pool Name Eunice; Bli - Tu - Dr, North
Property Code 22503	Property Name NEDU		Well Number 530
OGRID No. 873	Operator Name APACHE CORPORATION		Elevation 3436'

Surface Location

UL or lot No.	Section	Township	Range	Lot Idn	Feet from the	North/South line	Feet from the	East/West line	County
K	11	21-S	37-E		2310	SOUTH	1485	WEST	LEA

Bottom Hole Location If Different From Surface

UL or lot No.	Section	Township	Range	Lot Idn	Feet from the	North/South line	Feet from the	East/West line	County

Dedicated Acres	Joint or Infill	Consolidation Code	Order No.

NO ALLOWABLE WILL BE ASSIGNED TO THIS COMPLETION UNTIL ALL INTERESTS HAVE BEEN CONSOLIDATED
OR A NON-STANDARD UNIT HAS BEEN APPROVED BY THE DIVISION

	OPERATOR CERTIFICATION I hereby certify the the information contained herein is true and complete to the best of my knowledge and belief <i>Lana Williams</i> Signature Lana Williams Printed Name Engr. Tech Title 3/3/2009 Date
	SURVEYOR CERTIFICATION I hereby certify that the well location shown on this plat was plotted from field notes of actual surveys made by me or under my supervision, and that the same is true and correct to the best of my belief MAY 27, 2005 Date Surveyed Signature & Seal Professional Surveyor
	Date Surveyed Signature & Seal Professional Surveyor
	Date Surveyed Signature & Seal Professional Surveyor

SECTION 11, TOWNSHIP 21 SOUTH, RANGE 37 EAST, N.M.P.M.,
 LEA COUNTY, NEW MEXICO

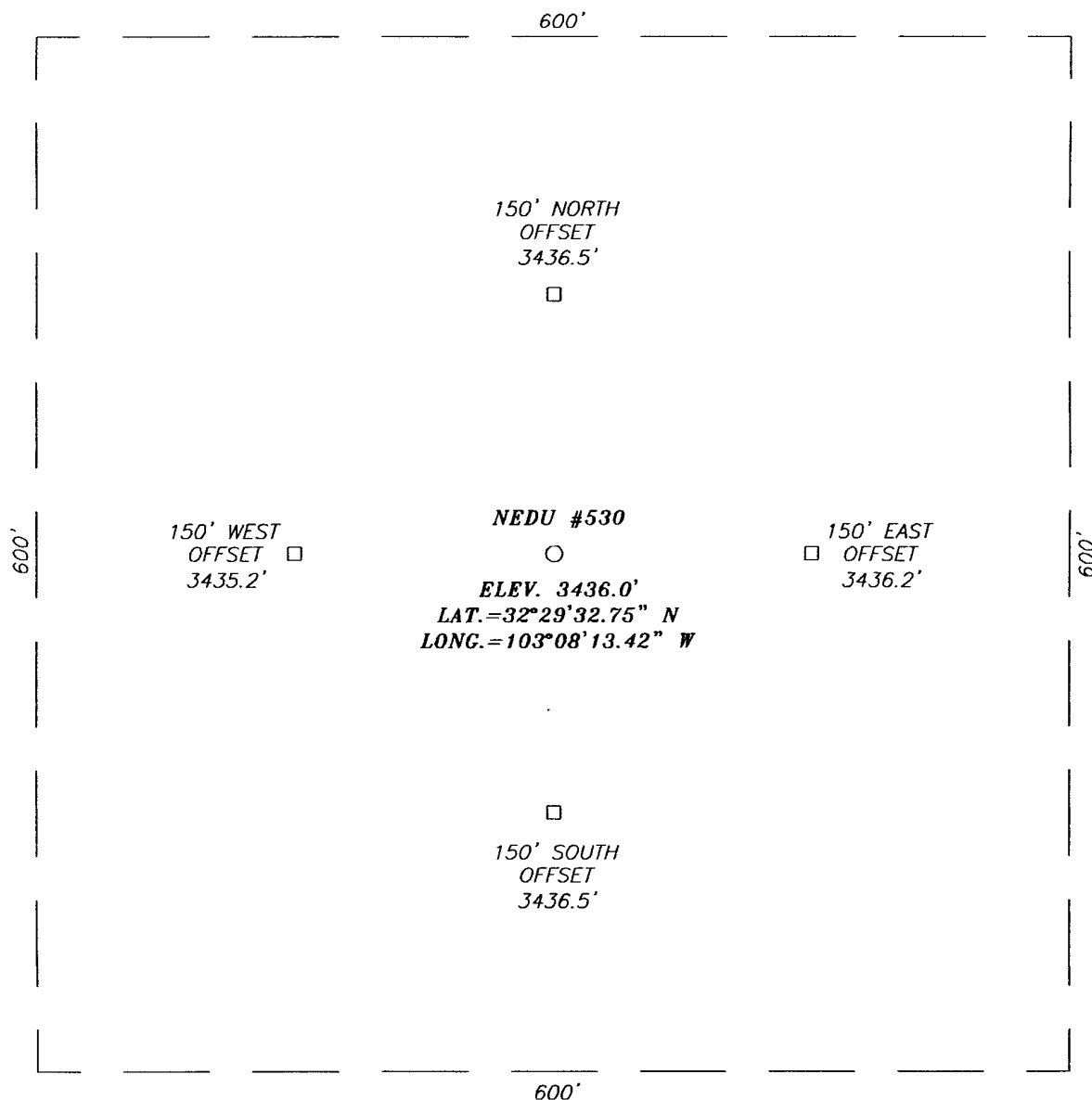

DRIVING DIRECTIONS:

FROM THE INTERSECTION OF ST. HWY. LOOP #18 AND APACHE ROAD #16 GO SOUTH ON ROAD 16 FOR APPROX. 200' TO A CALICHE ROAD ON THE RIGHT. TURN RIGHT AND GO SOUTHWEST FOR APPROX. 0.6 MILES TO A "T" INTERSECTION. TURN LEFT AND GO EAST APPROX. 0.3 MILES TO A ROAD INTERSECTION. TURN RIGHT AND GO SOUTH APPROX. 0.15 MILES TO A "Y" INTERSECTION. TURN LEFT AND GO SOUTHEAST APPROX. 0.5 MILES TO A "T" INTERSECTION. TURN LEFT AND GO EAST APPROX. 0.15 MILES TO A ROAD ON THE EAST SIDE OF A PUMPJACK. GO NORTH FOR APPROX. 0.3 MILES UNTIL ROAD ENDS. THIS LOCATION IS NORTHWEST APPROX. 421'.

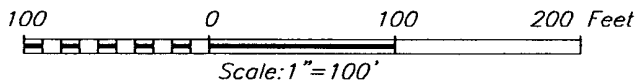

APACHE CORPORATION

NEDU #530 WELL
 LOCATED 2310 FEET FROM THE SOUTH LINE
 AND 1485 FEET FROM THE WEST LINE OF SECTION 11,
 TOWNSHIP 21 SOUTH, RANGE 37 EAST, N.M.P.M.,
 LEA COUNTY, NEW MEXICO.

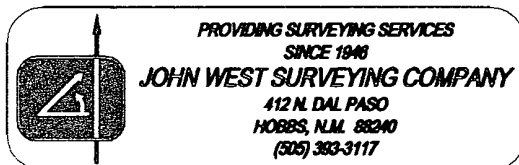

Survey Date: 5/27/05		Sheet 1 of 1 Sheets	
W.O. Number: 05.11.0810		Dr By: LA	Rev 1:N/A
Date: 6/2/05	Disk: CD#4	05110810	Scale: 1"=100'

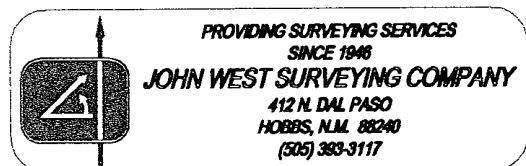
[illegible]

LOCATION VERIFICATION MAP

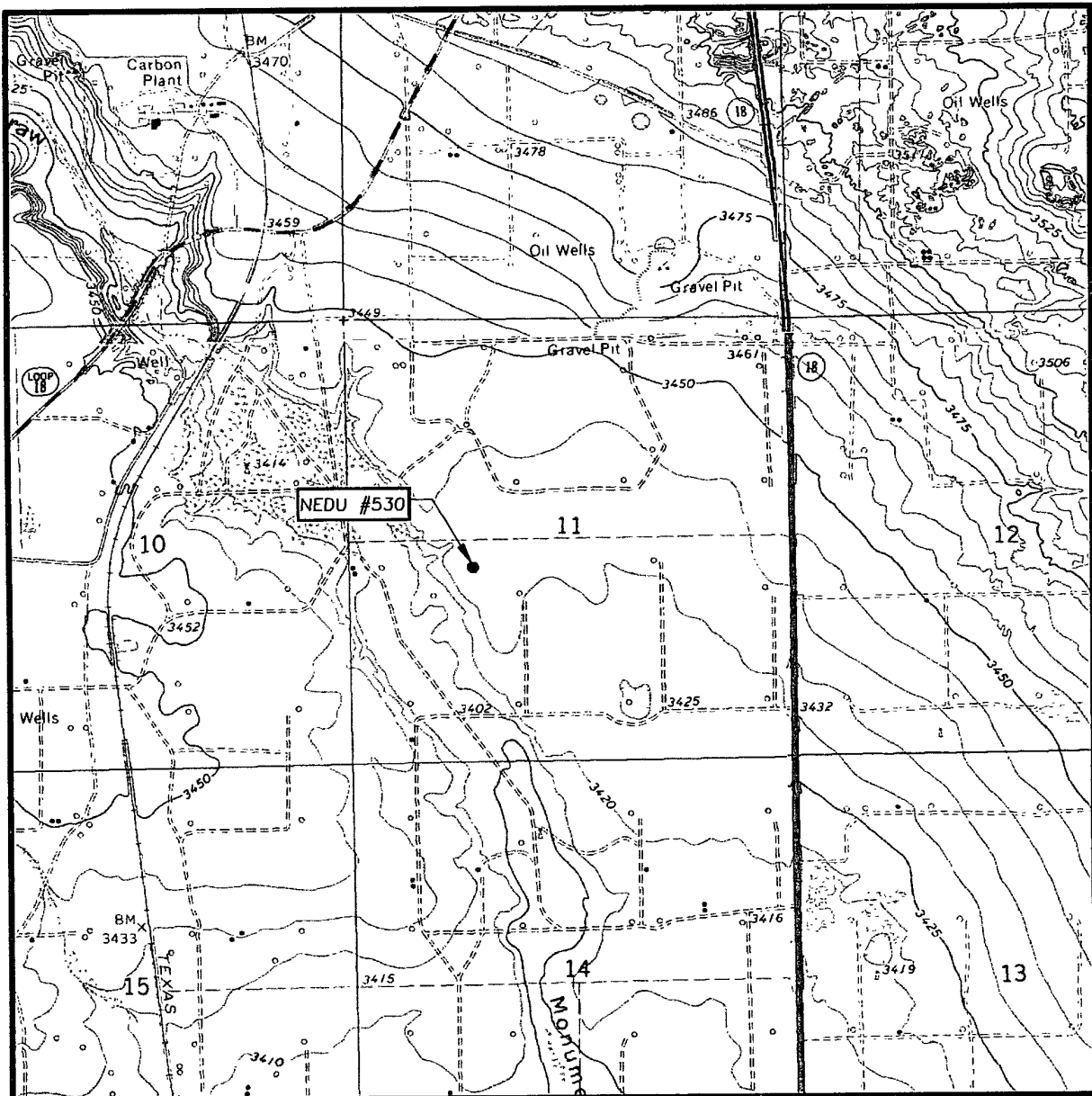

SCALE: 1" = 2000'

CONTOUR INTERVAL:
EUNICE, N.M. - 10'

SEC. 11 TWP. 21-S RGE. 37-E

SURVEY N.M.P.M.

COUNTY LEA

DESCRIPTION 2310' FSL & 1485' FWL

ELEVATION 3436'

OPERATOR APACHE CORPORATION

LEASE NEDU

U.S.G.S. TOPOGRAPHIC MAP
EUNICE, N.M.

