

District I
1625 N. French Dr., Hobbs, NM 88240
District II
811 S. 1st Street, Artesia, NM 88210
District III
1000 Rio Brazos Rd., Aztec, NM 87410
District IV
2040 South Pacheco, Santa Fe, NM 87505

State of New Mexico
Energy, Minerals & Natural Resources

Form C-101
Revised March 17, 1999

Oil Conservation Division
2040 South Pacheco
Santa Fe, NM 87505

Submit to appropriate District Office
State Lease - 6 Copies
Fee Lease - 5 Copies

☒ AMENDED REPORT

APPLICATION FOR PERMIT TO DRILL, RE-ENTER, DEEPEN, PLUGBACK, OR ADD A ZONE

| | | |
|---|--|--|
| ¹ Operator Name and Address Chevron U.S.A. Inc. 15 Smith Road, Midland Texas 79705 | | ² OGRID Number 4323 |
| | | ³ API Number 30-025-06944 |
| ⁴ Property Code 2606 | ⁵ Property Name CENTRAL DRINKARD UNIT | ⁶ Well No. 1508 |

⁷ Surface Location

| UL or lot no. | Section | Township | Range | Lot. Idn | Feet from the | North/South Line | Feet from the | East/West line | County |
|---------------|---------|----------|-------|----------|---------------|------------------|---------------|----------------|--------|
| J | 32 | 21-S | 37-E | | 2086' | SOUTH | 2086' | EAST | LEA |

⁸ Proposed Bottom Hole Location If Different From Surface

| UL or lot no. | Section | Township | Range | Lot. Idn | Feet from the | North/South Line | Feet from the | East/West line | County |
|---------------|---------|----------|-------|----------|---------------|------------------|---------------|----------------|--------|
| E | 33 | 21-S | 37-E | | 2055' | NORTH | 180' | WEST | LEA |

⁹ Proposed Pool 1

CENTRAL DRINKARD

¹⁰ Proposed Pool 2

| | | | | |
|---|--|---|---|--|
| ¹¹ Work Type Code P (HORIZONTAL) | ¹² Well Type Code OIL | ¹³ Cable/Rotary ROTARY | ¹⁴ Lease Type Code P | ¹⁵ Ground Level Elevation |
| ¹⁶ Multiple NO | ¹⁷ Proposed Depth 9120' | ¹⁸ Formation DRINKARD | ¹⁹ Contractor | ²⁰ Spud Date 01-01-04 |

²¹ Proposed Casing and Cement Program

| Hole Size | Casing Size | Casing weight/foot | Setting Depth | Sacks of Cement | Estimated TOC |
|-----------|-------------|--------------------|---------------|-----------------|---------------|
| NO CHANGE | | | | | |
| | | | | | |
| | | | | | |
| | | | | | |
| | | | | | |

²² Describe the proposed program. If this application is to DEEPEN or PLUG BACK, give the data on the present productive zone and proposed new productive zone. Describe the blowout prevention program, if any. Use additional sheets if necessary.

CHEVRON U.S.A. INTENDS TO DRILL A HORIZONTAL LATERAL IN THE SUBJECT WELL.

KICK-OFF POINT - 6450'

TOP OF WINDOW - 6445'

BOTTOM OF WINDOW - 6455'

TARGET INTERVAL - 6495-6595'

LENGTH OF LATERAL - 2670'

PERFORATIONS - 5710-6837' SQUEEZED, 6495-6645' OPEN HOLE

Permit Expires 1 Year From Approval
Date Unless Drilling Underway

Horizontal

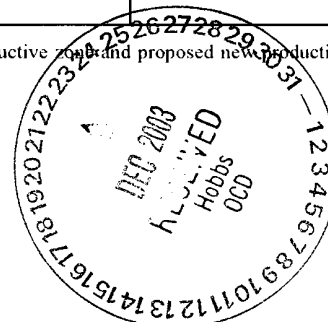

²³ I hereby certify that the information given above is true and complete to the best of my knowledge and belief.

Signature: *Laura Skinner*

Printed name: **Laura Skinner**

Title: **Regulatory Specialist**

Date: **12-18-03**

Phone: **432-687-7355**

OIL CONSERVATION DIVISION

Approved by: *Chris Williams*

Title: **OC DISTRICT SUPERVISOR/GENERAL MANAGER**

Approval Date: Expiration Date:

Conditions of Approval: **DEC 23 2003**
Attached ☐

District I
1625 N. French Dr., Hobbs, NM 88240

District II
811 S. 1st Street, Artesia, NM 88210

District III
1000 Rio Brazos Rd., Aztec, NM 87410

District IV
2040 South Pacheco, Santa Fe, NM 87505

State of New Mexico
Energy, Minerals & Natural Resources

OIL CONSERVATION DIVISION
2040 South Pacheco
Santa Fe, NM 87505

Form C-102
Revised March 17, 1999

Submit to Appropriate District Office
State Lease - 4 Copies
Fee Lease - 3 Copies

☒ AMENDED REPORT

WELL LOCATION AND ACREAGE DEDICATION PLAT

| | | |
|--|--|---|
| ¹ API Number 30-025-06944 | ² Pool Code 19190 | ³ Pool Name DRINKARD |
| ⁴ Property Code 2606 | ⁵ Property Name CENTRAL DRINKARD UNIT | ⁶ Well Number 15018 |
| ⁷ OGRID No. 4323 | ⁸ Operator Name Chevron U.S.A. Inc. | ⁹ Elevation |

¹⁰ Surface Location

| | | | | | | | | | |
|---------------------------|----------------------|-------------------------|----------------------|----------|-------------------------------|----------------------------------|-------------------------------|-------------------------------|----------------------|
| UL or lot no. J | Section 32 | Township 21-S | Range 37-E | Lot. Idn | Feet from the 2086' | North/South line SOUTH | Feet from the 2086' | East/West line EAST | County LEA |
|---------------------------|----------------------|-------------------------|----------------------|----------|-------------------------------|----------------------------------|-------------------------------|-------------------------------|----------------------|

¹¹ Bottom Hole Location If Different From Surface

| | | | | | | | | | |
|---------------------------|----------------------|-------------------------|----------------------|----------|-------------------------------|----------------------------------|------------------------------|-------------------------------|----------------------|
| UL or lot no. E | Section 33 | Township 21-S | Range 37-E | Lot. Idn | Feet from the 2055' | North/South line NORTH | Feet from the 180' | East/West line WEST | County LEA |
|---------------------------|----------------------|-------------------------|----------------------|----------|-------------------------------|----------------------------------|------------------------------|-------------------------------|----------------------|

| | | | |
|---|--|----------------------------------|-------------------------|
| ¹² Dedicated Acres 160 | ¹³ Joint or Infill NO | ¹⁴ Consolidation Code | ¹⁵ Order No. |
|---|--|----------------------------------|-------------------------|

NO ALLOWABLE WILL BE ASSIGNED TO THIS COMPLETION UNTIL ALL INTERESTS HAVE BEEN CONSOLIDATED OR A NON-STANDARD UNIT HAS BEEN APPROVED BY THE DIVISION

| | | | | | |
|------------------------|-------------------|----------|-------------------|----------|--|
| ¹⁶ B | SECTION 32 | A | SECTION 33 | C | ¹⁷ OPERATOR CERTIFICATION I hereby certify that the information contained herein is true and complete to the best of my knowledge and belief. <i>Laura Skinner</i> Signature Laura Skinner Printed Name Regulatory Specialist Title 12-18-03 Date |
| G | H | E | F | | |
| J | I | L | K | | ¹⁸ SURVEYOR CERTIFICATION I hereby certify that the well location shown on this plat was plotted from field notes of actual surveys made by me or under my supervision, and that the same is true and correct to the best of my belief. Date of Survey Signature and Seal of Professional Surveyer: Certificate Number |
| O | P | M | N | | |

SHL

BHL

2086'

2055'

180'

1980'

IN UNIT

SEE ATTACHED PLAT

ChevronTexaco

New Mexico Waterflood

Central Drinkard Unit

Proposed 2004 Horizontal Locations

0 2,718 5,436

FEET

POSTED WELL DATA

Well Number

WELL SYMBOLS

- Oil Well
- Gas Well
- Dry Hole
- Plugged and Abandoned
- Plugged & Abandoned Oil Well
- Plugged & Abandoned Gas Well
- Shut-In Well
- Temporarily Abandoned
- Abandoned Water Injector
- △ Injector Well

By: Cynthia L. Welch

October 13, 2003

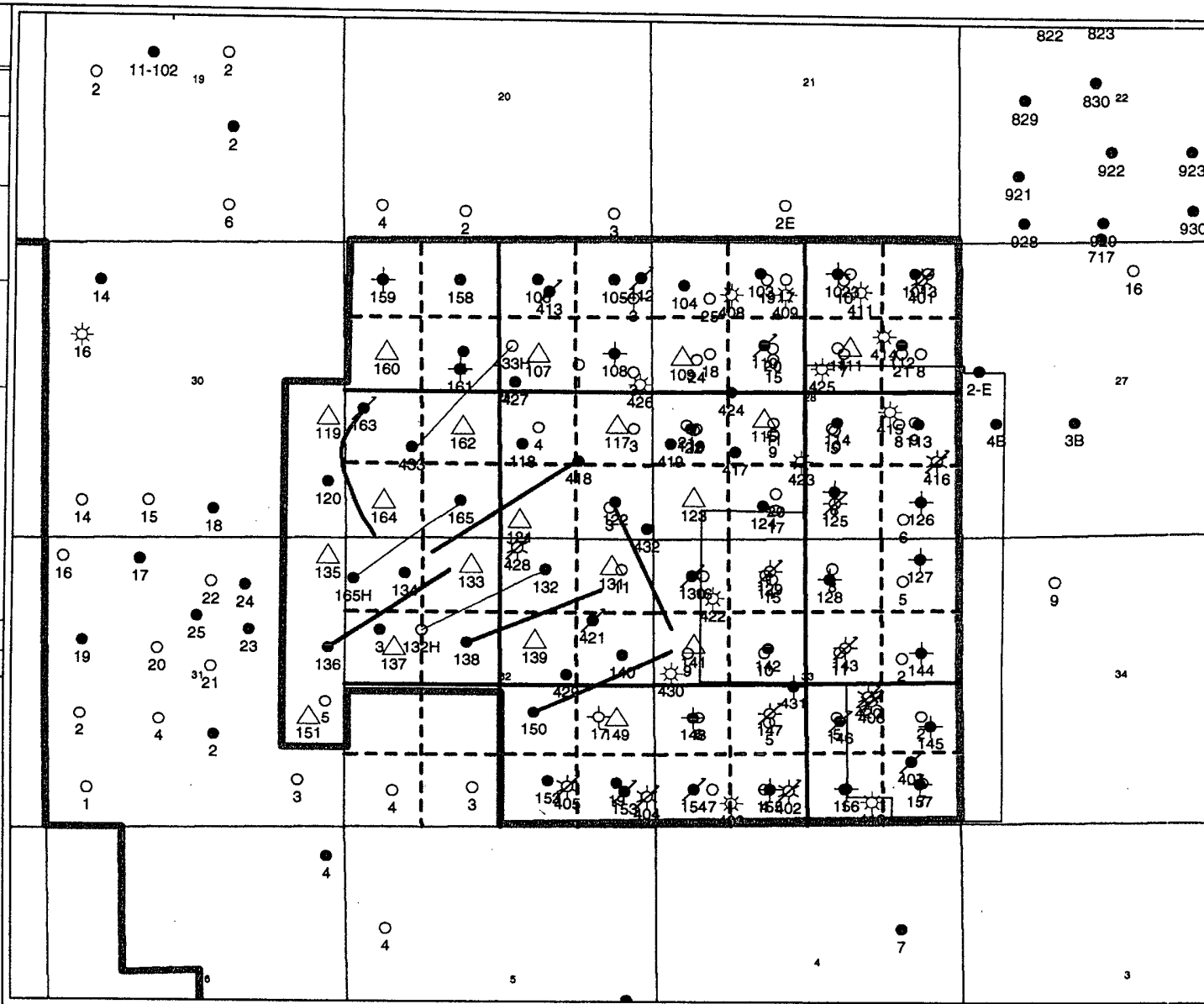

PETRA 10/13/2003 2:37:08 PM