

ATS-09-208

RECEIVED

OCD-HOBBS

JUN 10 2009

HOBBSOCD

Form 3160-3
(April 2004)UNITED STATES
DEPARTMENT OF THE INTERIOR
BUREAU OF LAND MANAGEMENTFORM APPROVED
OMB No. 1004-0137
Expires March 31, 2007

APPLICATION FOR PERMIT TO DRILL OR REENTER

1a. Type of work: <input checked="" type="checkbox"/> DRILL <input type="checkbox"/> REENTER			Split Estate		
1b. Type of Well: <input checked="" type="checkbox"/> Oil Well <input type="checkbox"/> Gas Well <input type="checkbox"/> Other			<input checked="" type="checkbox"/> Single Zone <input type="checkbox"/> Multiple Zone		
2. Name of Operator APACHE CORPORATION (LANA WILLIAMS 918-491-4980) <873>					
3a. Address 6120 SOUTH YALE SUITE 1500 TULSA, OKLAHOMA 74136-4224			3b. Phone No. (include area code) 918-491-4980		
4. Location of Well (Report location clearly and in accordance with any State requirements.) At surface 1295' FSL & 330' FEL SECTION 9 T21S-R37E At proposed prod. zone SAME Unit P					
10. Field and Pool, or Exploratory EUNICE, BLINB, TUBB, DRINK-N					
11. Sec., T. R. M. or Blk. and Survey or Area SECTION 9 T21S-R37E					
14. Distance in miles and direction from nearest town or post office* Approximately 4 miles North of Eunice New Mexico			12. County or Parish LEA CO.		13. State NM
15. Distance from proposed* location to nearest property or lease line, ft. (Also to nearest drig. unit line, if any) 330'		16. No. of acres in lease 958		17. Spacing Unit dedicated to this well 40	
18. Distance from proposed location* to nearest well, drilling, completed, applied for, on this lease, ft. 250'		19. Proposed Depth 6900'		20. BLM/BIA Bond No. on file BLM-CO-1463 NATION WIDE	
21. Elevations (Show whether DF, KDB, RT, GL, etc.) 3470' GL		22. Approximate date work will start* WHEN APPROVED		23. Estimated duration 18	

24. Attachments

The following, completed in accordance with the requirements of Onshore Oil and Gas Order No.1, shall be attached to this form:

- Well plat certified by a registered surveyor.
- A Drilling Plan.
- A Surface Use Plan (if the location is on National Forest System Lands, the SUPO shall be filed with the appropriate Forest Service Office).
- Bond to cover the operations unless covered by an existing bond on file (see Item 20 above).
- Operator certification
- Such other site specific information and/or plans as may be required by the authorized officer.

25. Signature <i>Joe T. Janica</i>		Name (Printed/Typed) Joe T. Janica		Date 03/04/09
Title Permit Engineer				
Approved by (Signature) /S/ DAVID D. EVANS		Name (Printed/Typed)		Date JUN 8 2009
Title FIELD MANAGER		Office CARLSBAD FIELD OFFICE		

Application approval does not warrant or certify that the applicant holds legal or equitable title to those rights in the subject lease which would entitle the applicant to conduct operations thereon.
Conditions of approval, if any, are attached.

APPROVAL FOR TWO YEARS

Title 18 U.S.C. Section 1001 and Title 43 U.S.C. Section 1212, make it a crime for any person knowingly and willfully to make to any department or agency of the United States any false, fictitious or fraudulent statements or representations as to any matter within its jurisdiction.

*(Instructions on page 2)

Capitan Controlled Water Basin

Approval Subject to General Requirements
& Special Stipulations AttachedSEE ATTACHED FOR
CONDITIONS OF APPROVAL

RECEIVED

JUN 10 2009

HOBBSDO

DISTRICT I
1625 N. FRENCH DR., HOBBS, NM 88240

State of New Mexico
Energy, Minerals and Natural Resources Department

DISTRICT II
1301 W. GRAND AVENUE, ARTESIA, NM 88210

DISTRICT III
1000 Rio Brazos Rd., Aztec, NM 87410

DISTRICT IV
1220 S. ST. FRANCIS DR., SANTA FE, NM 87505

OIL CONSERVATION DIVISION
1220 SOUTH ST. FRANCIS DR.
Santa Fe, New Mexico 87505

Form C-102

Revised October 12, 2005

Submit to Appropriate District Office

State Lease - 4 Copies

Fee Lease - 3 Copies

WELL LOCATION AND ACREAGE DEDICATION PLAT

☐ AMENDED REPORT

API Number 30-025-38442	Pool Code 22900	Pool Name EUNICE BLINBREY TUBB DRINKARD-NORTH
Property Code 32346	Property Name WEST BLINEBRY DRINKARD UNIT	Well Number 112
OGRID No. 873	Operator Name APACHE CORPORATION	Elevation 3470'

Surface Location

UL or lot No.	Section	Township	Range	Lot Idn	Feet from the	North/South line	Feet from the	East/West line	County
P	9	21-S	37-E		1295	SOUTH	330	EAST	LEA

Bottom Hole Location If Different From Surface

UL or lot No.	Section	Township	Range	Lot Idn	Feet from the	North/South line	Feet from the	East/West line	County

Dedicated Acres	Joint or Infill	Consolidation Code	Order No.
40			

NO ALLOWABLE WILL BE ASSIGNED TO THIS COMPLETION UNTIL ALL INTERESTS HAVE BEEN CONSOLIDATED
OR A NON-STANDARD UNIT HAS BEEN APPROVED BY THE DIVISION

<p>GEODETIC COORDINATES NAD 27 NME</p> <p>Y=543820.1 N X=861777.4 E</p> <p>LAT.=32.489602° N LONG.=103.160047° W</p> <p>LAT.=32°29'22.57" N LONG.=103°09'36.17" W</p>	<p>DETAIL</p>	<p>SEE DETAIL</p>	<p>OPERATOR CERTIFICATION</p> <p>I hereby certify that the information herein is true and complete to the best of my knowledge and belief, and that this organization either owns a working interest or unleased mineral interest in the land including the proposed bottom hole location or has a right to drill this well at this location pursuant to a contract with an owner of such mineral or working interest, or to a voluntary pooling agreement or a compulsory pooling order heretofore entered by the division.</p> <p><i>Joe T. Janica</i> Signature Date</p> <p>Joe T. Janica 03/04/09 Printed Name</p>	
			<p>SURVEYOR CERTIFICATION</p> <p>I hereby certify that the well location shown on this plat was plotted from field notes of actual surveys made by me or under my supervision, and that the same is true and correct to the best of my belief.</p> <p>OCTOBER 09, 2008</p> <p>Date Surveyed REV# 10/21/08 AR</p> <p>Signature & Seal of Professional Surveyor 3239</p> <p><i>Ronald J. Eidson</i> 10/22/08</p> <p>Certificate No. GARY EIDSON 12641 RONALD J. EIDSON 3239</p>	

EXHIBIT "A"

LOCATION VERIFICATION MAP

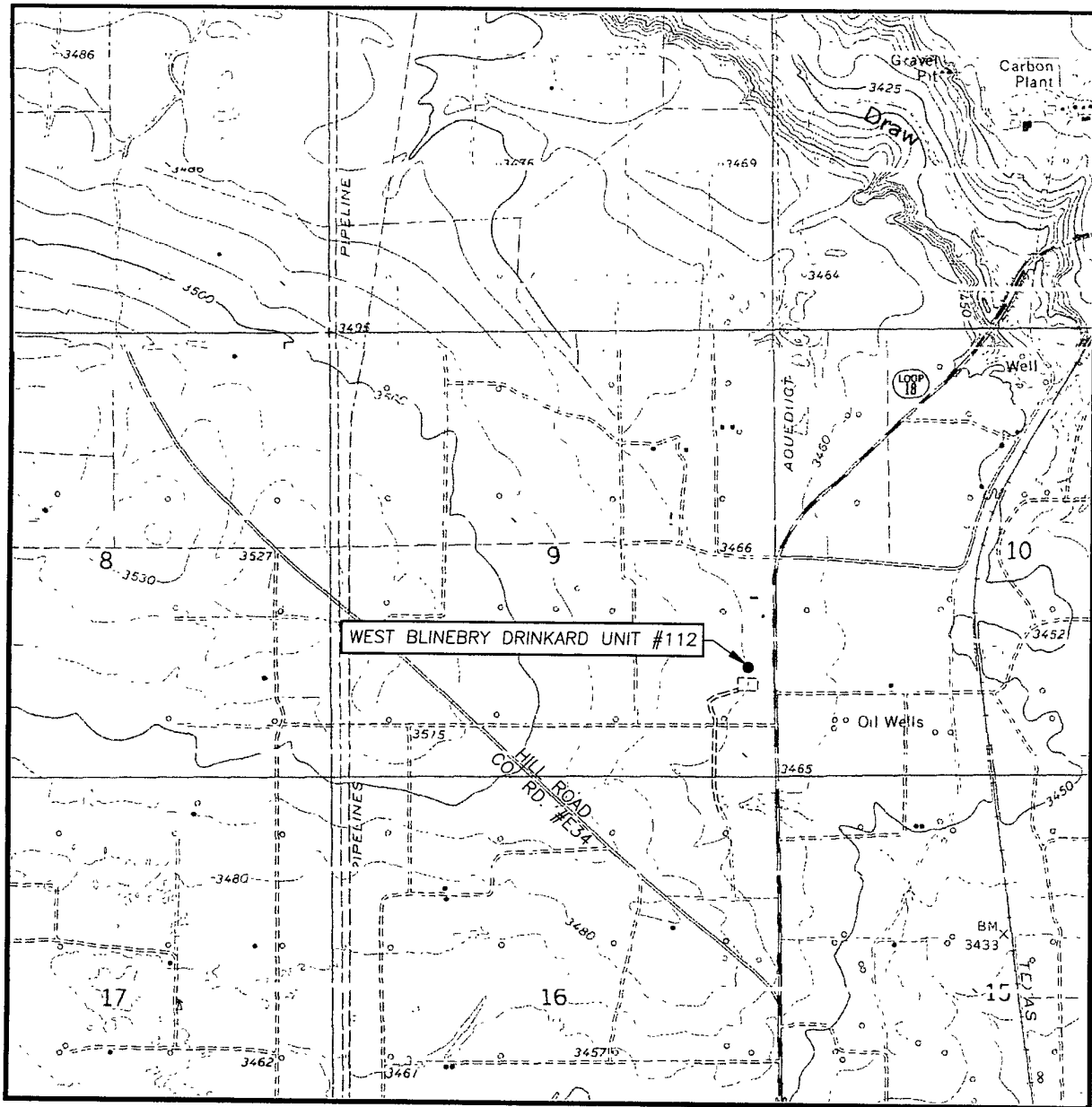

SCALE: 1" = 2000'

CONTOUR INTERVAL:
EUNICE, N.M. - 10'
HOBBS SW, N.M. - 5'

SEC. 9 TWP. 21-S RGE. 37-E

SURVEY N.M.P.M.

COUNTY LEA STATE NEW MEXICO

DESCRIPTION 1295' FSL & 330' FEL

ELEVATION 3470'

OPERATOR APACHE CORPORATION

LEASE WEST BLINEBRY DRINKARD UNIT

U.S.G.S. TOPOGRAPHIC MAP
EUNICE, N.M.

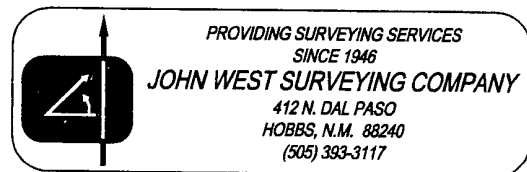

PROVIDING SURVEYING SERVICES
SINCE 1946

JOHN WEST SURVEYING COMPANY

412 N. DAL PASO
HOBBS, N.M. 88240
(505) 393-3117

VICINITY MAP

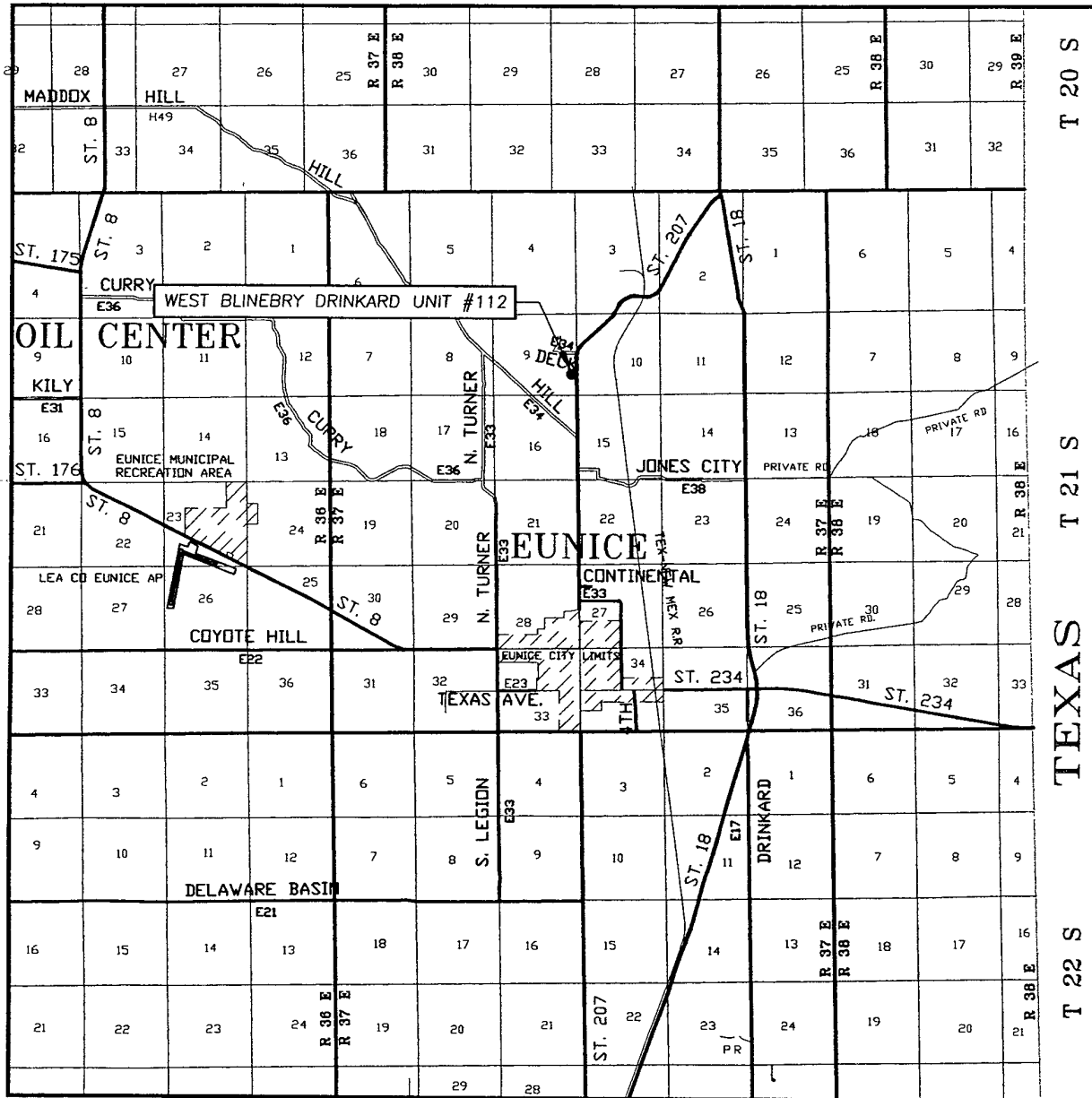

SCALE: 1" = 2 MILES

SEC. 9 TWP. 21-S RGE. 37-E
 SURVEY N.M.P.M.
 COUNTY LEA STATE NEW MEXICO
 DESCRIPTION 1295' FSL & 330' FEL
 ELEVATION 3470'
 OPERATOR APACHE CORPORATION
 LEASE WEST BLINEBRY DRINKARD UNIT

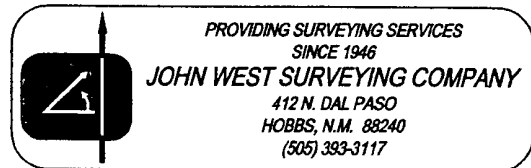

SECTION 9, TOWNSHIP 21 SOUTH, RANGE 37 EAST, N.M.P.M.,
 LEA COUNTY, NEW MEXICO

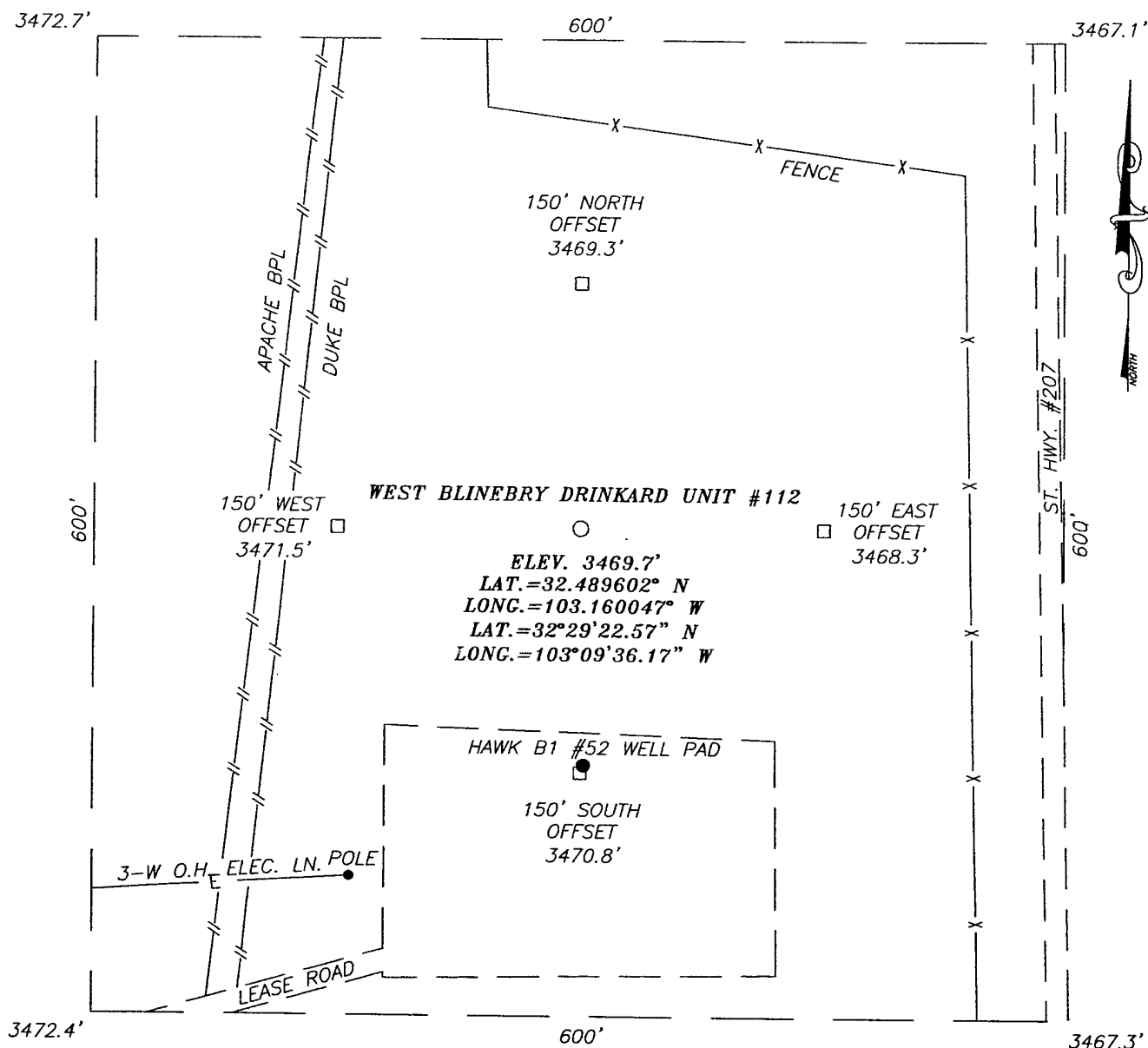

DIRECTIONS TO LOCATION

FROM THE INTERSECTION OF ST. RD. #207 AND
 GO. RD. #E-34 (HILL ROAD), GO NORTH ON ST.
 RD. #207 APPROX. 0.75 MILES. THIS LOCATION IS
 WEST OF ROAD APPROX. 330 FEET.

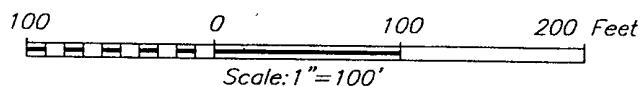

PROVIDING SURVEYING SERVICES
 SINCE 1946
JOHN WEST SURVEYING COMPANY
 412 N. DAL PASO
 HOBBS, N.M. 88240
 (505) 393-3117

APACHE CORPORATION

WEST BLINEBRY DRINKARD UNIT #112 WELL
 LOCATED 1295 FEET FROM THE SOUTH LINE
 AND 330 FEET FROM THE EAST LINE OF SECTION 9,
 TOWNSHIP 21 SOUTH, RANGE 37 EAST, N.M.P.M.,
 LEA COUNTY, NEW MEXICO.

Survey Date: 10/09/08	Sheet 1 of 1 Sheets
W.O. Number: 08.11.1567	Dr By: AR
Date: 10/15/08	Disk: 08111567
	Scale: 1"=100'

APPLICATION TO DRILL

APACHE CORPORATION
 W. BLINEBRY DRINKARD UNIT #112
 UNIT "P" SECTION 9
 T21S-R37E LEA CO. NM

In response to questions asked under Section II of Bulliten NTL-6, the following information on the above will be provided.

1. LOCATION: 1295' FSL & 330' FEL SECTION 9 T21S-R37E LEA CO. NM
2. ELEVATION ABOVE SEA LEVEL: 3470' GL.
3. GEOLOGICAL NAME OF SURFACE FORMATION: Quaternary Aeolian Deposits.
4. DRILLING TOOLS AND ASSOCIATED EQUIPMENT: Conventional rotary drilling rig using drilling mud as a circulating medium for solids removal from hole.
5. PROPOSED DRILLING DEPTH: 6900'
6. ESTIMATED TOPS OF GEOLOGICAL FORMATIONS:

Rustler Anhydrite	1284'	Glorieta	5180'
Yates	2640'	Blinebry Marker	5660'
Seven Rivers	2861'	Tubb	6137'
Queen	3433'	Drinkard	6462'
Grayburg	3754'	Abo	6728'
San Andres	4002'	TD	6900'
7. POSSIBLE MINERAL BEARING FORMATIONS:

Blinebry	Oil
Tubb	Oil
Drinkard	Oil
8. CASING PROGRAM:

HOLE SIZE	INTERVAL	OD OF CASING	WEIGHT	THREAD	COLLAR	GRADE	CONDITION
26"	0-40	20"	NA	NA	NA	Conductor	New
12½"	0-1300'	8 5/8"	24#	8-R	ST&C	J-55	New
7 7/8"	0-6900'	5½"	17#	8-R	LT&C	L-80 Jo55	New

Casing Design Factors:

Collapse	1.125	Burst	1.0	Body Yield	1.5	Joint Strength:	Buttress	1.6
							8-R	1.8

APPLICATION TO DRILL

APACHE CORPORATION
W. BLINEBRY DRINKARD UNIT #112
UNIT "P" SECTION 9
T21S-R37E LEA CO. NM

9. CASING CEMENTING & SETTING DEPTHS:

20"	Conductor	Set 40' of 20" conductor pipe and cement to surface with Redi-mix. <i>See cert</i>
8 5/8"	Surface	Run and set 1300' of 8 5/8" 24# J-55 ST&C casing. Cement with 450 Sx. of Class "C" Premium cement + 3% Salt, + 3# LCM-1/Sx., + 0.25# Cello Flakes/Sx., + 0.005 gps FP-6L, + 4% Bentonite, Yield 1.7, tail in with 200 Sx. of Class "C" cement + 2% CaCl, + 0.25# Cello Flakes/Sx., + 0.005 gps FL-L6, Yield 1.3. circulate cement to surface.
5 1/2"	Production	Run and set 6900' of 5 1/2" 17# Casing as follows: 5900' of 5 1/2" 17# J-55 LT&C, 1000' of 5 1/2" 17# L-80 LT&C. Cement with 800 Sx. of 35/65 Class "C" POZ cement + 5% Salt, + 0.25# Cello Flakes/Sx., + 3# LCM-1/Sx., + 0.0005% gps FP-6L, + 6% Bentonite, + 0.5% FL-52A, Yield 2.0 tail in with 350 Sx. of 50/50 Class "C" POZ, + 5% Salt, + 0.2% FL-52A, + 0.25# Cello Flakes/Sx., + 3# LCM-1/Sx. + 2% Bentonite, Yield 1.3, circulate cement to surface.

10. PRESSURE CONTROL EQUIPMENT:

Exhibit "I" shows a 900 Series 3000 PSI working pressure B.O.P. consisting of an annular bag type preventor, middle blind rams, bottom pipe rams. This B.O.P. will be nipped up on the 8 5/8" casing. The B.O.P. will be tested by a third party at 2000 PSI, maxium surface pressure is not expected to exceed 2000 PSI, BHP is calculated to be approximately 3080 PSI. The B.O.P. will be worked at least once in each 24 hout period and the blind rams will be worked when the drill pipe is out of the hole on trips. Exhibit "I" also shows a 3000 PSI choke manifold with a 3" blowdown line. Full opening stabbing valve and kelly cock will be on derrick floor in case of need. No abnormal pressures of temperatures are expected in this well no nearby wells have encountered any problems.

APPLICATION TO DRILL

APACHE CORPORATION
W. BLINEBRY DRINKARD UNIT #112
UNIT "P" SECTION 9
T21S-R37E LEA CO. NM

11. PROPOSED MUD CIRCULATING SYSTEM:

DEPTH	MUD WT.	VISC.	FLUID LOSS	TYPE SYSTEM
40-1300'	8.6-9.2	28-34	NC	Fresh water Spud Mud, add paper to control seepage, high viscosity sweeps to clean hole pH 9.0-9.5
1300-6500'	10.0-10.2	28-32	NC	Brine water add paper to control seepage and high viscosity sweeps to clean hole, pH 9.5-10.
6500-TD	10.0-10.2	36-42	8-10 cc or less	Same as above but add starch to water loss, add caustic soda to pH at 9.5-10

THIS WILL BE A CLOSED MUD SYSTEM

Sufficient mud materilas will be kept on location at all times in order to combat last circulation, or unexpected kicks. In order to run open hole logs and casing the above mud properties may have to be altered to meet these needs.

APPLICATION TO DRILL

APACHE CORPORATION
W. BLINEBRY DRINKARD UNIT #112
UNIT "P" SECTION 9
T21S-R37E LEA CO. NM

12. LOGGING, CORING, AND TESTING PROGRAM:

- A. Open hole logs: Dual Laterolog, MSFL, CNL, Litho-Density, Gamma Ray, Caliper, and Sonic from TD back to 8 5/8" casing shoe.
- B. Run CNL, Gamma Ray from 8 5/8" casing shoe back to surface.
- C. No cores, DST's or mud logger are planned at this time.

13. POTENTIAL HAZARDS:

No abnormal pressures or temperatures are expected. There is no known presence of H²S in this area. If H²S is encountered the operator will comply with the provisions of Onshore Oil and Gas Order No. 6. No lost circulation is expected to occur. All personnel will be familiar with all aspects of safe operation of equipment being used to drill this well. Estimated BHP Est 3036 PSI, and Estimated BHT 115°.

14. ANTICIPATED STARTING DATE AND DURATION OF OPERATION:

Road and location construction will begin after the BLM has approved the APD. Anticipated spud date will be as soon after BLM approval and as soon as a rig will be available. Move in operation and drilling is expected to take 14-20 days. If production casing is run then an additional 30 days will be needed to complete well and construct surface facilities and/or lay flowlines in order to place well on production.

15. OTHER FACETS OF OPERATIONS:

After running casing, cased hole Gamma Ray, Neutron Collar logs will be run from TD back to all possible productive zones. The Blin. Tubb, Drin. formation will be perforated and stimulated in order to establish production. The well will be swab tested and potentialized as an oil well.

WEST BLINEBRY DRINKARD UNIT # 112

DRILLING PROGRAM

Surface Location

1295' FSL & 330' FEL

SE ¼ of Section 9, Unit Letter P, Township 21 South, Range 37 East, N.M.P.M.

Lea County, New Mexico

The geological surface formation is recent Permian with quaternary alluvium and other surficial deposits.

Estimated Tops of Geological Markers:

<u>FORMATION</u>	<u>DEPTH</u>
Quaternary alluvials	Surface
Rustler	1284'
Yates	2640'
Seven Rivers	2961'
Queen	3433'
Grayburg	3754'
San Andres	4002'
Glorieta	5180'
Blinebry Marker	5660'
Tubb	6137'
Drinkard	6462'
Abo	6728'
TD	6900'

Estimated depths at which water, oil, gas, or other mineral-bearing formations are expected to be encountered:

<u>SUBSTANCE</u>	<u>DEPTH</u>
Oil	Blinebry@ 5660' Tubb@ 6137' Drinkard@ 6462'
Gas	None anticipated
Fresh Water	None anticipated

All fresh water and prospectively valuable minerals (as described by BLM) encountered during drilling will be recorded by depth and adequately protected. All oil and gas shows within zones of correlative rights will be tested to determine commercial potential.

Proposed Casing Program

<u>HOLE</u> <u>SIZE</u>	<u>CASING</u> <u>SIZE</u> OD / ID	<u>GRAD</u> <u>E</u>	<u>WEIGHT</u> <u>PER</u> <u>FOOT</u>	<u>DEPTH</u>	<u>SACKS</u> <u>CEMENT</u> <u>T</u>	<u>ESTIMATED TOC -</u> <u>REMARKS</u>
12 1/4"	8 5/8" 8.097"	J55 STC	24#	1,300' <i>See COA</i>	650	TOC - Surface 8.9 ppg Water-based Mud; 89 ° F Est. Static Temp; 83 ° F Est. Circ. Temp.
7 7/8"	5 1/2" 4.892"	L80 LTC	17#	0 – 1,000'	1,150	TOC – Surface Float Collar set @ 6,960'
	5 1/2" 4.892"	J55 LTC	17#	1,000 – 6,900'		10.10 ppg Brine Mud; 126 ° F Est. Static Temp; 115 ° F Est. Circ. Temp.

Proposed Cement Program:

<u>CASING</u>	<u>LEAD SLURRY</u>	<u>TAIL SLURRY</u>	<u>DISPLACEMENT</u>
8 5/8"	450 sacks Premium Class C Cmt + 3% bwoc Sodium Chloride + 0.25 lbs/sack Cello Flake + 3 lbs/sack LCM-1 + 0.005 gps FP-6L + 4% bwoc Bentonite Gel 796 Vol Cu Ft., 1.7 Vol. Factor Slurry Weight 13.5 ppg Slurry yield 1.77 cf/sack Amount of Water mix 9.02 gps Estimated Pumping Time – 70 BC (HH:MM) 4:18	200 sacks Class C Cement + 2% bwoc Calcium Chloride + 0.25 lbs/sack Cello Flake + 0.005 gps FP-L6+56.3% Fresh Water, 270 Vol. Cu Ft 1.3 Vol. Factor Slurry Weight (ppg) 14.8 Slurry Yield (cf/sack) 1.35 Amount of Mix Water (gps) 6.35 Estimated Pumping Time – 70 BC (HH:MM)-2:33	80.1 bbls Fresh Water @ 8.33 ppg

8 5/8" Casing: Volume Calculations:

1,300 ft	x	0.4127 cf/ft	with 75% excess	=	938.5 cf
42 ft	x	0.3576 cf/ft	with 0% excess	=	15.0 cf (inside pipe)
TOTAL SLURRY VOLUME					= 953.5 cf
					= 169.8 bbls

Spacer 20.0 bbls Water @ 8.33 ppg

<u>CASING</u>	<u>LEAD SLURRY</u>	<u>TAIL SLURRY</u>	<u>DISPLACEMENT</u>
5 1/2"	800 sacks (35:65) Poz (Fly Ash): Class C Cement + 5% bwow Sodium Chloride + 0.25 lbs/sack Cello Flake + 3 lbs/sk LCM + 0.005 gps FP-6L + 6% bwoc Bentonite + 0.5% bwoc FL-52A 1,640 Vol. Cu Ft 2.0 Vol. Factor Slurry Weight (ppg) 12.5 Slurry Yield (cf/sack) 2.05 Amount of Mix Water (gps) 10.92; <u>Estimated Pumping</u> <u>Time – 70 BC</u> <u>(HH:MM)-4:00;</u>	350 sacks (50:50) Poz (Fly Ash):Class C Cement + 5% bwow Sodium Chloride +0.2% bwoc FL-52A + 0.6% bwoc FL-25 + 0.25 lb/sk Cello Flake + 3 lbs/sk LCM + 2% bwoc Bentonite 455 Vol. Cu Ft 1.3 Vol. Factor Slurry Weight (ppg) 14.2 Slurry Yield (cf/sack) 1.30 Amount of Mix Water (gps) 5.55; Estimated Pumping Time – 70 BC (HH:MM)-4:00;	159.4 bbls 2% Kcl Water @ 8.43 ppg

5 1/2" Casing: Volume Calculations:

1300 ft	x	0.1925 cf/ft	with 0% excess	=	250.2 cf
3800 ft	x	0.1732 cf/ft	with 100% excess	=	1,316.1 cf
1800 ft	x	0.1732 cf/ft	with 50% excess	=	467.6cf
40 ft	x	0.1305 cf/ft	with 0% excess	=	5.2 cf(inside pipe)
TOTAL SLURRY VOLUME					= 2,039.1 cf
					= 363.2 bbls

All slurries will be tested prior to loading to confirm thickening times and a lab report furnished to Apache. Fluid loss will be tested and reported on slurries with fluid loss additives. Lab test report will be furnished prior to pumping cement.

Proposed Pressure Control Equipment

Will install on the 8 5/8" surface casing a 9" x 3000 psi WP Double Ram BOP with Annular, and will test using a 3rd party tester before drilling out of surface casing. **As maximum anticipated surface pressures do not exceed 2,000 psi, we will test the BOPE as a 2,000 psi system.** Bottom hole pressure calculations are included below. See Exhibit I, 3,000 psi BOPE attached.

Bottom Hole Pressure Calculations

The maximum anticipated bottom hole pressure is calculated by multiplying the depth of the well by 0.44. The maximum anticipated surface pressure is calculated assuming one half of the hole is evacuated of the drilling fluid required to control the maximum anticipated bottom hole pressure.

For the West Blinbry Drinkard Unit # 112 the maximum anticipated bottom hole pressure is $6,900' \times 0.44 \text{ psi/ft.} = 3,036 \text{ psi.}$

The maximum anticipated surface pressure assuming a hole where one half of the mud required to contain the bottom hole pressure has been evacuated is $3,036 \text{ psi} - (3,036 \text{ psi}/2) = 1,518 \text{ psi.}$

EXHIBIT I

3000psi -
BOPE

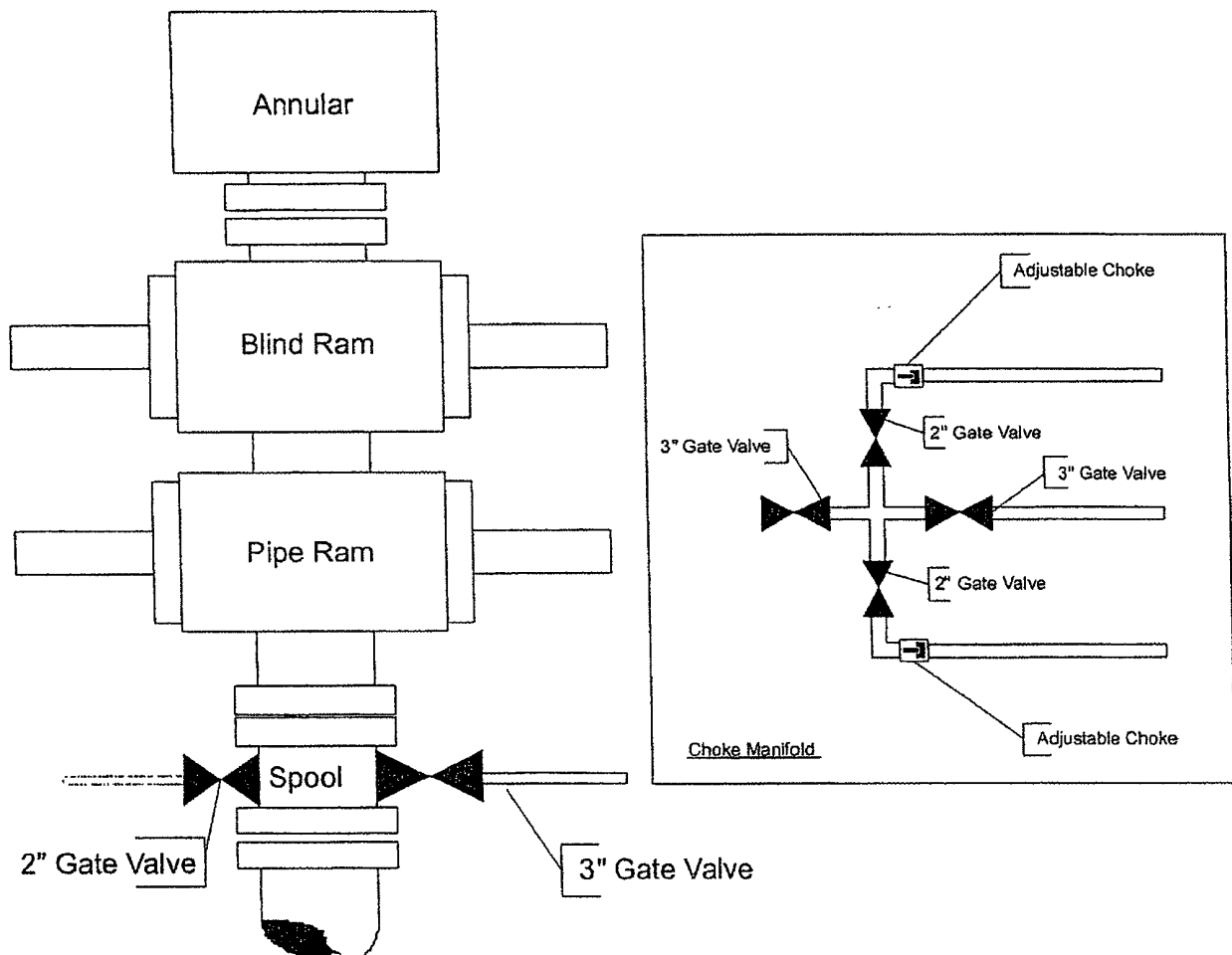

EXHIBIT "I"
SKETCH OF BOP & CHOKE MANIFOLD

APACHE CORPORATION
W BLINEBRY DRINKARD UNIT #112
UNIT "P" SECTION 9
T21S-R37E LEA CO. NM

Proposed Mud Program

<u>DEPTH</u>	<u>MUD PROPERTIES</u>	<u>REMARKS</u>
0 – 1,300'	Weight: 8.6 – 9.2 ppg Viscosity: 28 – 34 sec/qt pH: 9.0 – 9.5 Filtrate: NC	Spud with a Conventional Gel/Lime “Spud mud”. Use gel and native solids to maintain a sufficient viscosity to keep the hole clean. Mix Paper one-two sacks every 100 feet drilled to minimize wall cake build up on water sands and to control seepage loss. Every 500' sweep the hole with 50 bbls of pre-mixed freshwater, gel and lime having a viscosity of 45-50 sec/qt.
1300' – 6500'	Weight: 10 10.0 – 10.2 ppg Viscosity: 28 – 32 sec/qt pH: 9.5 -10 Filtrate: NC	Drill out from under the surface casing with Brine Water. Paper should be added at 2 bags after every 100' drilled to control seepage losses. Use Lime to maintain pH at 9-10. Mix one gallon of Anco Drill N at flowline every 250 feet drilled to promote solids settling
6500' – TD	Weight: 10.0 – 10.2 ppg Viscosity: 36 – 42 sec/qt pH: 9.5 -10 Filtrate: 8-10 cm/30 min	From 6500' to Total Depth, it is recommended the system be restricted to the working pits. Adjust and maintain pH with Caustic Soda. Treat system with WT-22 @ 0.1 ppb. Mix Starch (yellow) to control API filtrate at 8-10 cc. Sweep hole with Anco Drill N every 100'.

Auxiliary Equipment:

9" x 3000 psi double BOP/blind & pipe ram
4 1/2" x 3000 psi Kelly valve
9" x 3000 psi mud cross – H₂S detector on production hole
Gate-type safety valve 3" choke line from BOP to manifold
2" adjustable chokes – 3" blowdown line

Logging Program

The following logs may be run:

CNL, Litho Density, GR, CAL, Dual Laterolog/MSFL, Sonic from TD-1300'
CNL, GR from TD-Surface

Mudlogging Program:

There are no plans to utilize a mud logging service on this well.

Potential Hazards

No abnormal pressures or temperatures are anticipated. In the event abnormal pressures are encountered, however, the proposed mud program will be modified to increase the mud-weight.

The estimated maximum bottom hole pressure is 3,036 psi., estimated BHT is 115°F.

No H₂S is anticipated.

Anticipated Starting Date

When drilling rig becomes available.

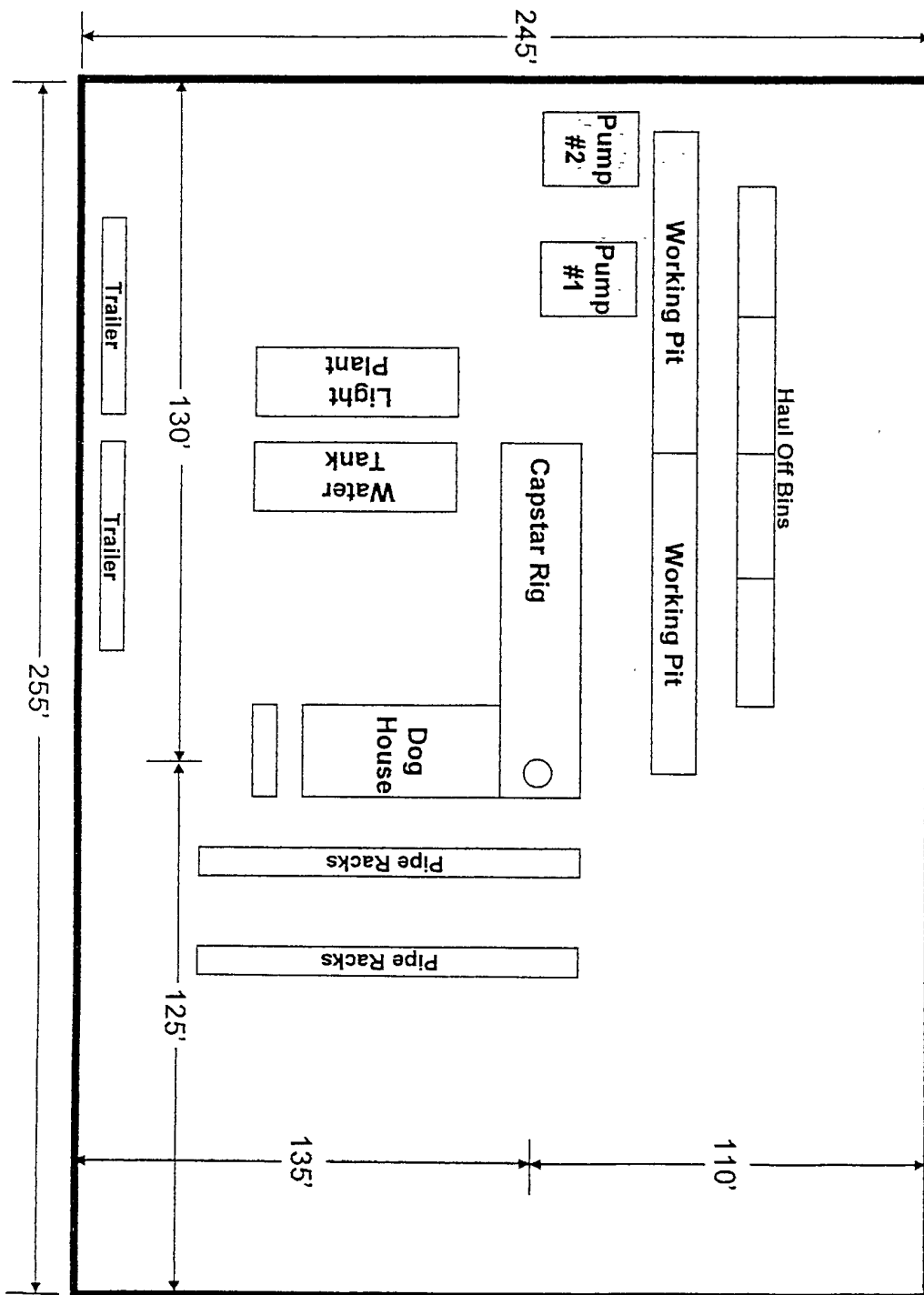

EXHIBIT "G"
RIG LAY OUT PLAT

APACHE CORPORATION
W BLINEBRY DRINKARD UNIT #112
UNIT "P" SECTION 9
T21S-R37E LEA CO. NM

20-mil liner for splash containment

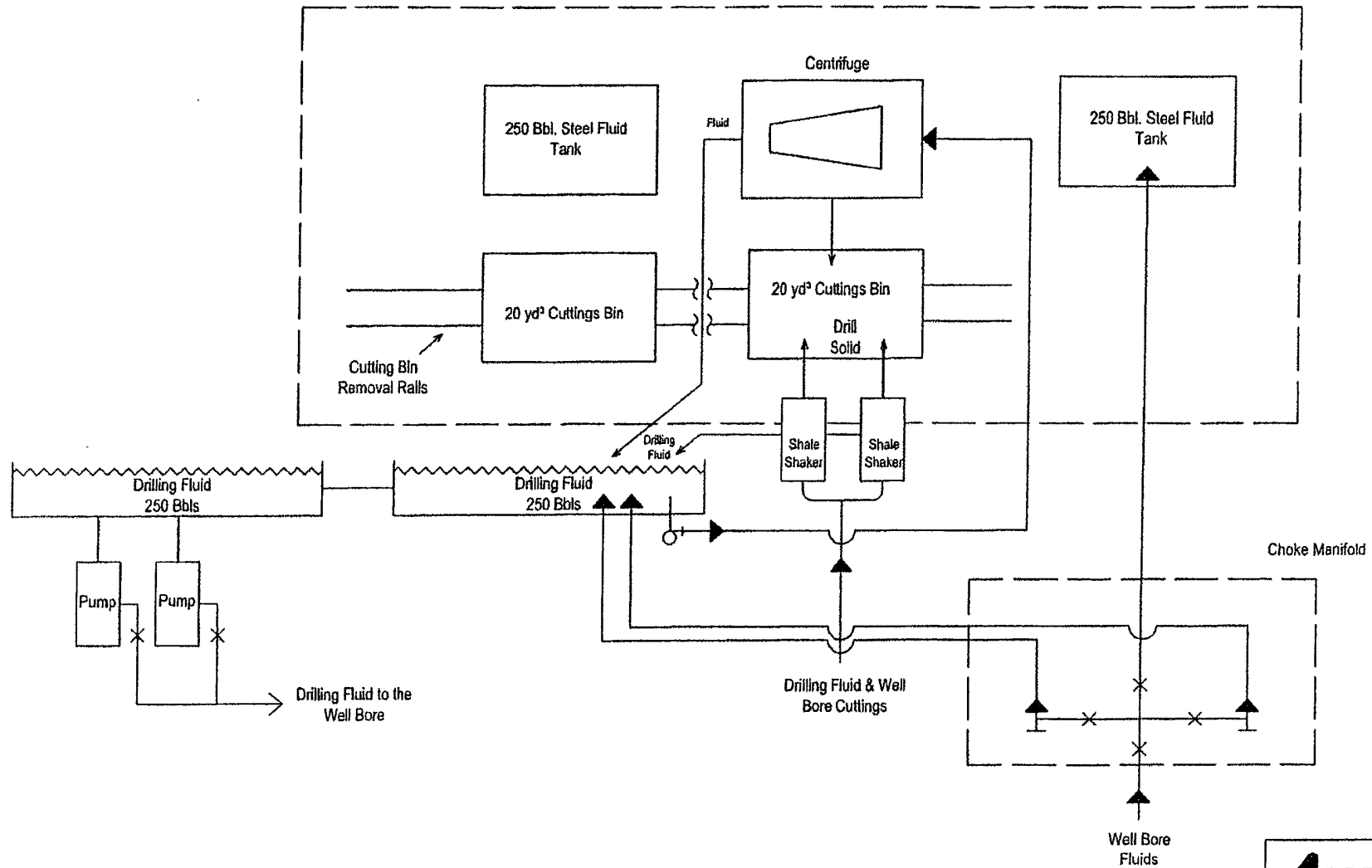
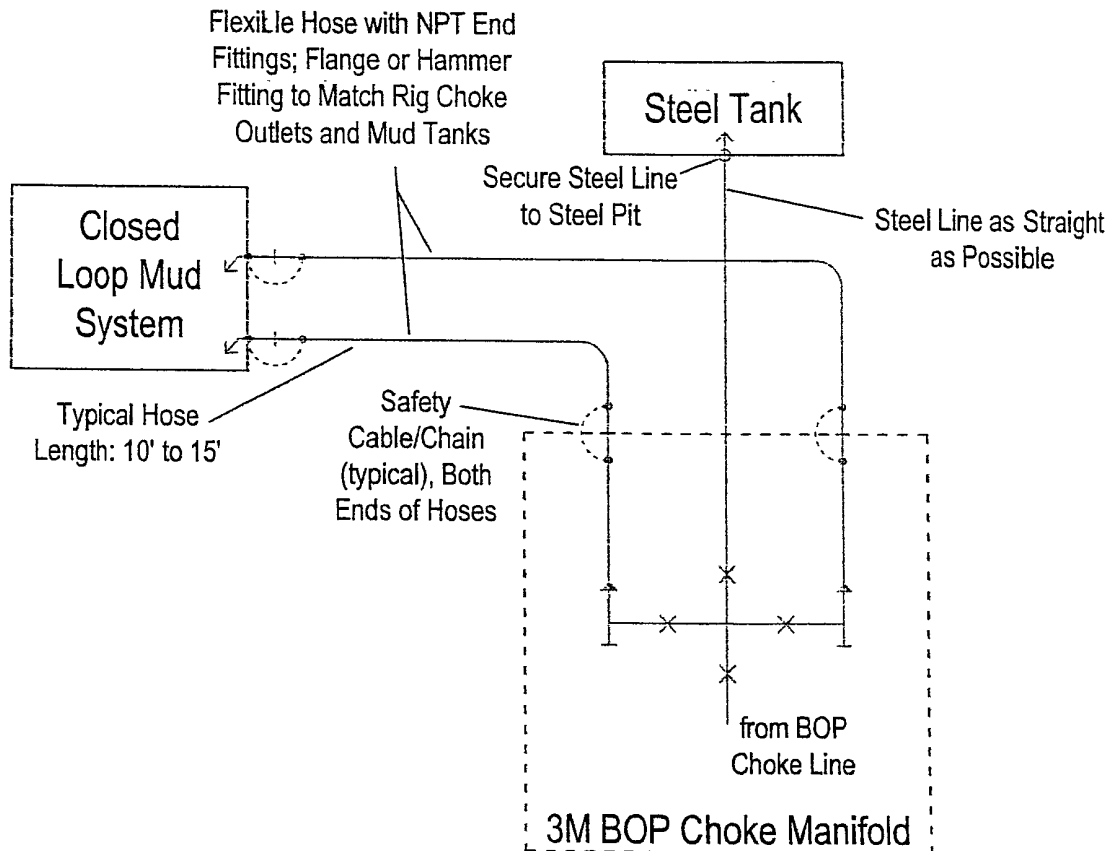

Figure 1
New Mexico Typical
Closed-Loop System

See COA
(H₂S)



abridge CORPORATION
TWO WARREN PLACE, SUITE 1500
6120 SOUTH YALE
TULSA, OKLAHOMA 74136-4224

**Typical Choke Manifold
Schematic for Closed-Loop
Mud System**

POD: SAM HAMPTON SCALE: NTS DATE: 2 MARCH 2008
FILED: H:\Tulsa\Dept\Land\Private\AutoCAD\BIM\CHOKES-CHOKES-HAMPTON.dwg

Hydrogen Sulfide Contingency Plan For Drilling/Workover/Facility

If at this time the supervising person determines the release of H₂S cannot be contained to the site location and the general public is in harm's way he will take the necessary steps to protect the workers and the public.

EMERGENCY CALL LIST: (Start and continue until ONE of these people has been contacted)

	OFFICE	MOBILE	HOME
Harold Swain	432-527-3311	575-390-4368	
Danny Chaney	405-574-4249		
Sam Hampton	918-491-4954	918-978-0121	

EMERGENCY RESPONSE NUMBERS:

State Police	Eddy County		575 -748-9718
State Police	Lea County		575-392-5588
Sheriff	Eddy County		
Sheriff	Lea County		575-746-2701
Emergency Medical Service (Ambulance)	Eddy County		911 or 505-746-2701
	Lea County	Eunice	911 or 505-394-3258
Emergency Response	Eddy County SERC		575-476-9620
	Lea County		
Artesia Police Dept			575-746-5001
Artesia Fire Dept			575-746-5001
Carlsbad Police Dept			575-385-2111
Carlsbad Fire Dept			575-385-5125

EMERGENCY CALL LIST (CONT.)

Loco Hills Police Dept		575- 677-2349
Jal Police Dept		575- 395-2501
Jal Fire Dept		575-395-2221
Jal Ambulance		575-395-2221
Eunice Police Dept		575- 394-0112
Eunice Fire Dept		575-394-3258
Eunice Ambulance		575-394-3258
Hobbs Police Dept		575- 397-3365
Hobbs Fire Dept		575-397-9308
NMOCD	District 1 (Lea, Roosevelt, Curry)	575- 393-6161
	District 2 (Eddy, Chavez)	575-.748-1283
Lea County Information		575-393-8203
Callaway Safety	Eddy/Lea Counties	575-392-2973
BJ Services	Artesia	575--746-3140
	Hobbs	575-392-5556
Halliburton	Artesia	1-800-523-2482
	Hobbs	1-800-523-2482
Wild Well Control	Midland	432-550-6202
	Mobile	432-553-1166

Lessee's or Operator's Representative and Certification.

I hereby certify that I, or persons under my direct supervision, have inspected the proposed drill site and access route; that I am familiar with the conditions which currently exist; that the statements made in this plan are, to the best of my knowledge, true and correct; and that the work associated with operations proposed herein will be performed by APACHE CORPORATION and its contractors and subcontractors in conformity with this plan and the terms and conditions under which it is approved. This statement is subject to the provisions of 18 U.S.C. 1001 for the filing of a false statement.

Date 03/04/09

Name and Title Joot Janica Permit Eng

Senior Representative (Manager, Engineering & Production):

Ross Murphy
Apache Corporation
6120 South Yale Avenue
Suite 1500
Tulsa, Oklahoma 74136
(918) 491-4834

Project (Operations Engineer):

Kevin Mayes
Apache Corporation
6120 South Yale Avenue
Suite 1500
Tulsa, Oklahoma 74136
(918) 491-4972

Drilling Operations (Operations Engineer):

Sam Hampton
Apache Corporation
6120 South Yale Avenue
Suite 1500
Tulsa, Oklahoma 74136
(918) 491-4954

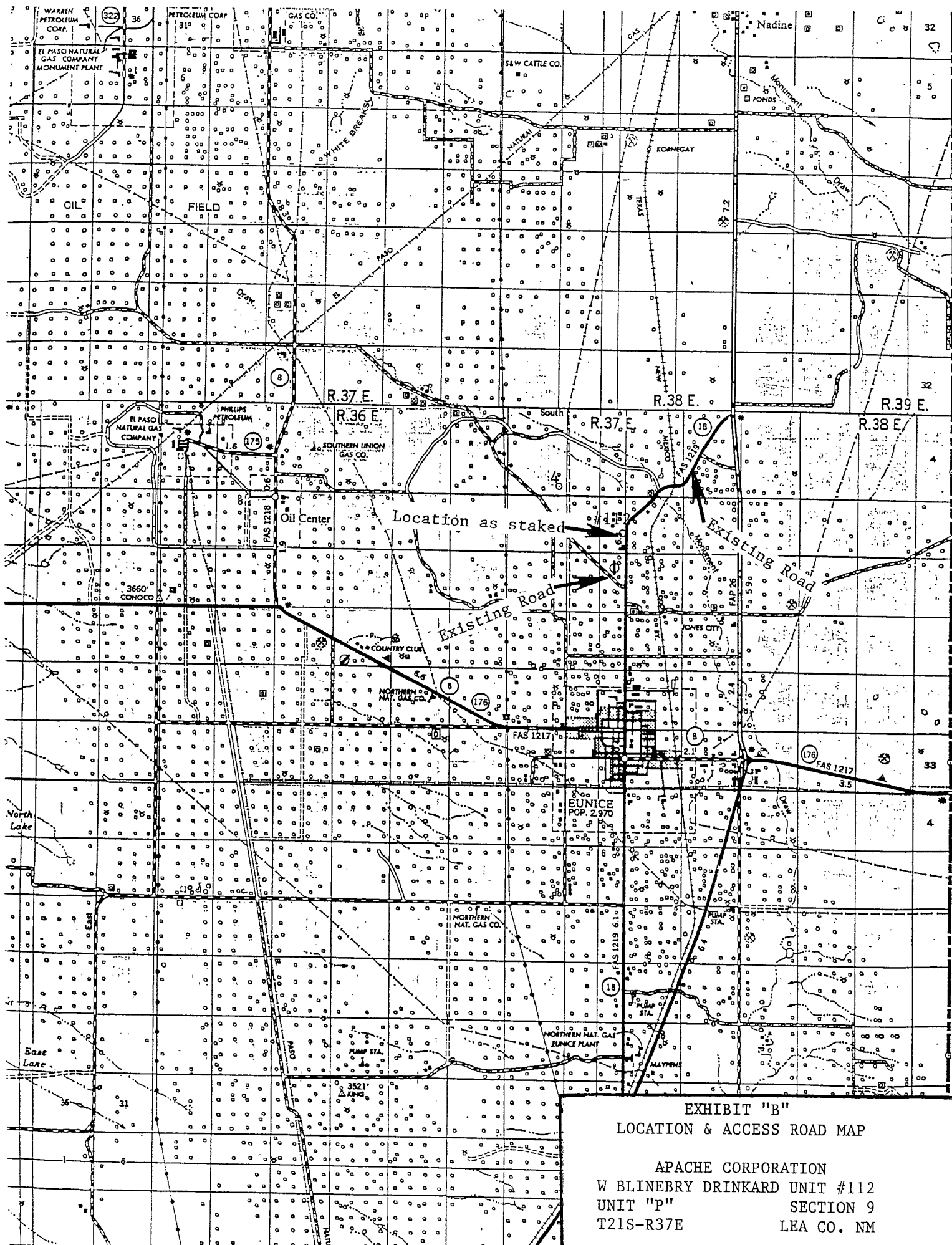
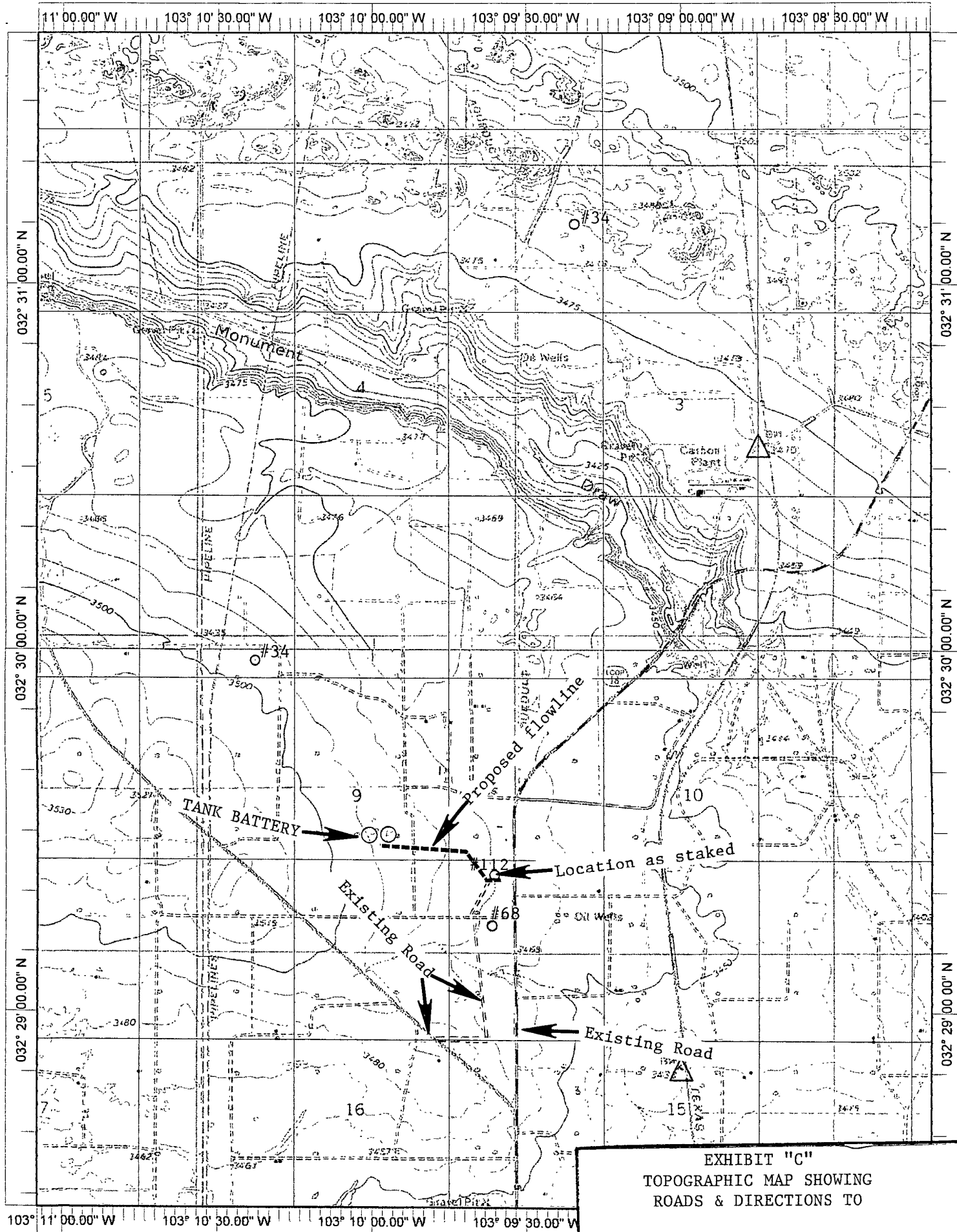

EXHIBIT "B"
LOCATION & ACCESS ROAD MAP

APACHE CORPORATION
W BLINEBRY DRINKARD UNIT #112
UNIT "P" SECTION 9
T21S-R37E LEA CO. NM



Datum NAD27

Copyright (C) 1999, Maptech, Inc.

EXHIBIT "C"
TOPOGRAPHIC MAP SHOWING
ROADS & DIRECTIONS TO

APACHE CORPORATION
W BLINBERRY DRINKARD UNIT #112
UNIT "P" SECTION 9
T21S-R37E IFA CO. NM

PECOS DISTRICT CONDITIONS OF APPROVAL

OPERATOR'S NAME:	Apache Corporation
LEASE NO.:	NM90161
WELL NAME & NO.:	West Blinery Drinkard Unit 112W
SURFACE HOLE FOOTAGE:	1295' FSL & 330' FEL
BOTTOM HOLE FOOTAGE:	Same
LOCATION:	Section 9, T. 21 S., R 37 E., NMPM
COUNTY:	Lea County, New Mexico

TABLE OF CONTENTS

Standard Conditions of Approval (COA) apply to this APD. If any deviations to these standards exist or special COAs are required, the section with the deviation or requirement will be checked below.

- ☐ **General Provisions**
- ☐ **Permit Expiration**
- ☐ **Archaeology, Paleontology, and Historical Sites**
- ☐ **Noxious Weeds**
- ☐ **Special Requirements**
- ☒ **Construction**
 - Notification
 - Topsoil
 - Reserve Pit – Closed-loop mud system
 - Federal Mineral Material Pits
 - Well Pads
 - Roads
- ☐ **Road Section Diagram**
- ☒ **Drilling**
 - Onshore Order 6 – H2S Requirements
- ☒ **Production (Post Drilling)**
 - Pipelines
- ☐ **Reserve Pit Closure/Interim Reclamation**
- ☐ **Final Abandonment/Reclamation**

I. GENERAL PROVISIONS

The approval of the Application For Permit To Drill (APD) is in compliance with all applicable laws and regulations: 43 Code of Federal Regulations 3160, the lease terms, Onshore Oil and Gas Orders, Notices To Lessees, New Mexico Oil Conservation Division (NMOCD) Rules, National Historical Preservation Act As Amended, and instructions and orders of the Authorized Officer. Any request for a variance shall be submitted to the Authorized Officer on Form 3160-5, Sundry Notices and Report on Wells.

II. PERMIT EXPIRATION

If the permit terminates prior to drilling and drilling cannot be commenced within 60 days after expiration, an operator is required to submit Form 3160-5, Sundry Notices and Reports on Wells, requesting surface reclamation requirements for any surface disturbance. However, if the operator will be able to initiate drilling within 60 days after the expiration of the permit, the operator must have set the conductor pipe in order to allow for an extension of 60 days beyond the expiration date of the APD. (Filing of a Sundry Notice is required for this 60 day extension.)

III. ARCHAEOLOGICAL, PALEONTOLOGY & HISTORICAL SITES

Any cultural and/or paleontological resource discovered by the operator or by any person working on the operator's behalf shall immediately report such findings to the Authorized Officer. The operator is fully accountable for the actions of their contractors and subcontractors. The operator shall suspend all operations in the immediate area of such discovery until written authorization to proceed is issued by the Authorized Officer. An evaluation of the discovery shall be made by the Authorized Officer to determine the appropriate actions that shall be required to prevent the loss of significant cultural or scientific values of the discovery. The operator shall be held responsible for the cost of the proper mitigation measures that the Authorized Officer assesses after consultation with the operator on the evaluation and decisions of the discovery. Any unauthorized collection or disturbance of cultural or paleontological resources may result in a shutdown order by the Authorized Officer.

IV. NOXIOUS WEEDS

The operator shall be held responsible if noxious weeds become established within the areas of operations. Weed control shall be required on the disturbed land where noxious weeds exist, which includes the roads, pads, associated pipeline corridor, and adjacent land affected by the establishment of weeds due to this action. The operator shall consult with the Authorized Officer for acceptable weed control methods, which include following EPA and BLM requirements and policies.

CONSTRUCTION

A. NOTIFICATION

The BLM shall administer compliance and monitor construction of the access road and well pad. Notify the Hobbs Field Station at (575) 393-3612 at least 3 working days prior to commencing construction of the access road and/or well pad.

When construction operations are being conducted on this well, the operator shall have the approved APD and Conditions of Approval (COA) on the well site and they shall be made available upon request by the Authorized Officer.

B. TOPSOIL

There is no measurable soil on this well pad to stockpile. No topsoil stockpile is required.

C. RESERVE PITS

The operator has applied for a closed-loop system. The operator shall properly dispose of drilling contents at an authorized disposal site.

D. FEDERAL MINERAL MATERIALS PIT

If the operator elects to surface the access road and/or well pad, mineral materials extracted during construction of the reserve pit may be used for surfacing the well pad and access road and other facilities on the lease.

Payment shall be made to the BLM prior to removal of any additional federal mineral materials from any site other than the reserve pit. Call the Carlsbad Field Office at (575) 234-5972.

E. WELL PAD SURFACING

Surfacing of the well pad is not required.

If the operator elects to surface the well pad, the surfacing material may be required to be removed at the time of reclamation.

The well pad shall be constructed in a manner which creates the smallest possible surface disturbance, consistent with safety and operational needs.

V. DRILLING

A. DRILLING OPERATIONS REQUIREMENTS

The BLM is to be notified a minimum of 4 hours in advance for a representative to witness:

- a. Spudding well
- b. Setting and/or Cementing of all casing strings
- c. BOPE tests

☒ **Lea County**

Call the Hobbs Field Station, 414 West Taylor, Hobbs NM 88240,
(575) 393-3612

1. A Hydrogen Sulfide (H₂S) Drilling Plan should be activated 500 feet prior to drilling into the **Blinberry** formation. **As a result, the Hydrogen Sulfide area must meet Onshore Order 6 requirements, which includes equipment and personnel/public protection items. If Hydrogen Sulfide is encountered, please provide measured values and formations to the BLM.**
2. Unless the production casing has been run and cemented or the well has been properly plugged, the drilling rig shall not be removed from over the hole without prior approval.

B. CASING

Changes to the approved APD casing and cement program require submitting a sundry and receiving approval prior to work. Failure to obtain approval prior to work will result in an Incident of Non-Compliance being issued.

Centralizers required on surface casing per Onshore Order 2.III.B.1.f.

Wait on cement (WOC) time for a primary cement job will be a minimum 18 hours for a water basin, 24 hours in the potash area, or 500 pounds compressive strength, whichever is greater for all casing strings. Provide compressive strengths including hours to reach required 500 pounds compressive strength prior to cementing each casing string. See individual casing strings for details regarding lead cement slurry requirements.

No pea gravel permitted for remedial or fall back remedial without prior authorization from the BLM engineer.

Possible lost circulation in the Glorietta formation.

Possible water flows in the Blinebry.

1. The **8-5/8** inch surface casing shall be **set at approximately 1320 feet (a minimum of 25 feet into the Rustler Anhydrite and above the salt)** and cemented to the surface.
 - a. If cement does not circulate to the surface, the appropriate BLM office shall be notified and a temperature survey utilizing an electronic type temperature survey with a surface log readout will be used or a cement bond log shall be run to verify the top of the cement.
 - b. **Wait on cement (WOC) time for a primary cement job is to include the lead cement slurry.**
 - c. Wait on cement (WOC) time for a remedial job will be a minimum of 4 hours after bringing cement to surface or 500 pounds compressive strength, whichever is greater.
 - d. If cement falls back, a remedial cement job will be done prior to drilling out that string.
2. The minimum required fill of cement behind the **5-1/2** inch production casing is:
 - ☒ Cement to surface. If cement does not circulate, contact the appropriate BLM office.
3. If hardband drill pipe is rotated inside casing, returns will be monitored for metal. If metal is found in samples, drill pipe will be pulled and rubber protectors which have a larger diameter than the tool joints of the drill pipe will be installed prior to continuing drilling operations.

C. PRESSURE CONTROL

1. All blowout preventer (BOP) and related equipment (BOPE) shall comply with well control requirements as described in Onshore Oil and Gas Order No. 2 and API RP 53 Sec. 17.
2. Minimum working pressure of the blowout preventer (BOP) and related equipment (BOPE) required for drilling below the surface casing shoe shall be **2000 (2M) psi. Operator is installing a 3M system and testing as a 2M based on bottom hole pressure gradient. 2M system approved.**
3. The appropriate BLM office shall be notified a minimum of 4-hours in advance for a representative to witness the tests.
 - a. The tests shall be done by an independent service company.

- b. The results of the test shall be reported to the appropriate BLM office.
- c. All tests are required to be recorded on a calibrated test chart. A copy of the BOP/BOPE test chart and a copy of independent service company test will be submitted to the appropriate BLM office.
- d. The BOP/BOPE test shall include a low pressure test from 250 to 300 psi. The test will be held for a minimum of 10 minutes if test is done with a test plug and 30 minutes without a test plug.

D. DRILL STEM TEST

If drill stem tests are performed, Onshore Order 2.III.D shall be followed.

RGH 040809

VI. PRODUCTION (POST DRILLING)

A. WELL STRUCTURES & FACILITIES

Placement of Production Facilities

Production facilities should be placed on the well pad to allow for maximum interim recontouring and revegetation of the well location.

Containment Structures

The containment structure shall be constructed to hold the capacity of the entire contents of the largest tank, plus 24 hour production, unless more stringent protective requirements are deemed necessary by the Authorized Officer.

Painting Requirement

All above-ground structures including meter housing that are not subject to safety requirements shall be painted a flat non-reflective paint color Shale Green, Munsell Soil Color Chart # 5Y 4/2

B. PIPELINES

STANDARD STIPULATIONS FOR SURFACE INSTALLED PIPELINES

A copy of the sundry notice and attachments, including stipulations, survey plat and/or map, will be on location during construction. BLM personnel may request to you a copy of your permit during construction to ensure compliance with all stipulations.

Holder agrees to comply with the following stipulations to the satisfaction of the Authorized Officer:

1. The holder shall indemnify the United States against any liability for damage to life or property arising from the occupancy or use of public lands under this grant.
2. The holder shall comply with all applicable Federal laws and regulations existing or hereafter enacted or promulgated. In any event, the holder shall comply with the Toxic Substances Control Act of 1976 as amended, 15 USC 2601 et seq. (1982) with regards to any toxic substances that are used, generated by or stored on the right-of-way or on facilities authorized under this right-of-way grant. (See 40 CFR, Part 702-799 and especially, provisions on polychlorinated biphenyls, 40 CFR 761.1-761.193.) Additionally, any release of toxic substances (leaks, spills, etc.) in excess of the reportable quantity established by 40 CFR, Part 117 shall be reported as required by the Comprehensive Environmental Response, Compensation, and Liability Act, section 102b. A copy of any report required or requested by any Federal agency or State government as a result of a reportable release or spill of any toxic substances shall be furnished to the authorized officer concurrent with the filing of the reports to the involved Federal agency or State government.
3. The holder agrees to indemnify the United States against any liability arising from the release of any hazardous substance or hazardous waste (as these terms are defined in the

Comprehensive Environmental Response, Compensation and Liability Act of 1980, 42 U.S.C. 9601, et seq. or the Resource Conservation and Recovery Act, 42 U.S.C. 6901, et seq.) on the Right-of-Way (unless the release or threatened release is wholly unrelated to activity of the Right-of-Way holder's activity on the Right-of-Way), or resulting from the activity of the Right-of-Way holder on the Right-of-Way. This agreement applies without regard to whether a release is caused by the holder, its agent, or unrelated third parties.

4. The holder shall be liable for damage or injury to the United States to the extent provided by 43 CFR Sec. 2883.1-4. The holder shall be held to a standard of strict liability for damage or injury to the United States resulting from pipe rupture, fire, or spills caused or substantially aggravated by any of the following within the right-of-way or permit area:

- a. Activities of the holder including, but not limited to construction, operation, maintenance, and termination of the facility.
- b. Activities of other parties including, but not limited to:
 - (1) Land clearing.
 - (2) Earth-disturbing and earth-moving work.
 - (3) Blasting.
 - (4) Vandalism and sabotage.
- c. Acts of God.

The maximum limitation for such strict liability damages shall not exceed one million dollars (\$1,000,000) for any one event, and any liability in excess of such amount shall be determined by the ordinary rules of negligence of the jurisdiction in which the damage or injury occurred.

This section shall not impose strict liability for damage or injury resulting primarily from an act of war or from the negligent acts or omissions of the United States.

5. If, during any phase of the construction, operation, maintenance, or termination of the pipeline, any oil, salt water, or other pollutant should be discharged from the pipeline system, impacting Federal lands, the control and total removal, disposal, and cleaning up of such oil, salt water, or other pollutant, wherever found, shall be the responsibility of the holder, regardless of fault. Upon failure of the holder to control, dispose of, or clean up such discharge on or affecting Federal lands, or to repair all damages resulting therefrom, on the Federal lands, the Authorized Officer may take such measures as he deems necessary to control and clean up the discharge and restore the area, including, where appropriate, the aquatic environment and fish and wildlife habitats, at the full expense of the holder. Such action by the Authorized Officer shall not relieve the holder of any responsibility as provided herein.

6. All construction and maintenance activity will be confined to the authorized right-of-way width of 25 feet.
7. No blading or clearing of any vegetation will be allowed unless approved in writing by the Authorized Officer.
8. The holder shall install the pipeline on the surface in such a manner that will minimize suspension of the pipeline across low areas in the terrain. In hummocky or dune areas, the pipeline will be "snaked" around hummocks and dunes rather than suspended across these features.
9. The pipeline shall be buried with a minimum of 24 inches under all roads, "two-tracks," and trails. Burial of the pipe will continue for 20 feet on each side of each crossing. The condition of the road, upon completion of construction, shall be returned to at least its former state with no bumps or dips remaining in the road surface.
10. The holder shall minimize disturbance to existing fences and other improvements on public lands. The holder is required to promptly repair improvements to at least their former state. Functional use of these improvements will be maintained at all times. The holder will contact the owner of any improvements prior to disturbing them. When necessary to pass through a fence line, the fence shall be braced on both sides of the passageway prior to cutting of the fence. No permanent gates will be allowed unless approved by the Authorized Officer.
11. In those areas where erosion control structures are required to stabilize soil conditions, the holder will install such structures as are suitable for the specific soil conditions being encountered and which are in accordance with sound resource management practices.
12. Excluding the pipe, all above-ground structures not subject to safety requirement shall be painted by the holder to blend with the natural color of the landscape. The paint used shall be a color which simulates "Standard Environmental Colors" – **Shale Green**, Munsell Soil Color No. 5Y 4/2; designated by the Rocky Mountain Five State Interagency Committee.
13. The pipeline will be identified by signs at the point of origin and completion of the right-of-way and at all road crossings. At a minimum, signs will state the holder's name, BLM serial number, and the product being transported. Signs will be maintained in a legible condition for the life of the pipeline.
14. The holder shall not use the pipeline route as a road for purposes other than routine maintenance as determined necessary by the Authorized Officer in consultation with the holder. The holder will take whatever steps are necessary to ensure that the pipeline route is not used as a roadway.
15. Any cultural and/or paleontological resource (historic or prehistoric site or object)

discovered by the holder, or any person working on his behalf, on public or Federal land shall be immediately reported to the authorized officer. Holder shall suspend all operations in the immediate area of such discovery until written authorization to proceed is issued by the authorized officer. An evaluation of the discovery will be made by the authorized officer to determine appropriate cultural or scientific values. The holder will be responsible for the cost of evaluation and any decision as to proper mitigation measures will be made by the authorized officer after consulting with the holder.

(March 1989)

VII. INTERIM RECLAMATION & RESERVE PIT CLOSURE

A. INTERIM RECLAMATION

If the well is a producer, interim reclamation shall be conducted on the well site in accordance with the orders of the Authorized Officer. The operator shall submit a Sundry Notices and Reports on Wells (Notice of Intent), Form 3160-5, prior to conducting interim reclamation.

During the life of the development, all disturbed areas not needed for active support of production operations should undergo interim reclamation in order to minimize the environmental impacts of development on other resources and uses.

operators should work with BLM surface management specialists to devise the best strategies to reduce the size of the location. Any reductions should allow for remedial well operations, as well as safe and efficient removal of oil and gas.

During reclamation, the removal of caliche is important to increasing the success of revegetating the site. Removed caliche may be used for road repairs, fire walls or for building other roads and locations. In order to operate the well or complete workover operations, it may be necessary to drive, park and operate on restored interim vegetation within the previously disturbed area. Disturbing revegetated areas for production or workover operations will be allowed. If there is significant disturbance and loss of vegetation, the area will need to be revegetated. Communicate with the appropriate BLM office for any exceptions/exemptions if needed.

Seed Mixture 2, for Sandy Sites

The holder shall seed all disturbed areas with the seed mixture listed below. The seed mixture shall be planted in the amounts specified in pounds of pure live seed (PLS)* per acre. There shall be no primary or secondary noxious weeds in the seed mixture. Seed will be tested and the viability testing of seed will be done in accordance with State law (s) and within nine (9) months prior to purchase. Commercial seed will be either certified or registered seed. The seed container will be tagged in accordance with State law(s) and available for inspection by the authorized officer.

Seed will be planted using a drill equipped with a depth regulator to ensure proper depth of planting where drilling is possible. The seed mixture will be evenly and uniformly planted over the disturbed area (smaller/heavier seeds have a tendency to drop the bottom of the drill and are planted first). The holder shall take appropriate measures to ensure this does not occur. Where drilling is not possible, seed will be broadcast and the area shall be raked or chained to cover the seed. When broadcasting the seed, the pounds per acre are to be doubled. The seeding will be repeated until a satisfactory stand is established as determined by the authorized officer. Evaluation of growth will not be made before completion of at least one full growing season after seeding.

Species to be planted in pounds of pure live seed* per acre:

<u>Species</u>	<u>lb/acre</u>
Sand dropseed (<i>Sporobolus cryptandrus</i>)	1.0
Sand love grass (<i>Eragrostis trichodes</i>)	1.0
Plains bristlegrass (<i>Setaria macrostachya</i>)	2.0

*Pounds of pure live seed:

Pounds of seed x percent purity x percent germination = pounds pure live seed

X. FINAL ABANDONMENT & REHABILITATION REQUIREMENTS

Upon abandonment of the well and/or when the access road is no longer in service the Authorized Officer shall issue instructions and/or orders for surface reclamation and restoration of all disturbed areas.

On private surface/federal mineral estate land the reclamation procedures on the road and well pad shall be accomplished in accordance with the private surface land owner agreement.