

DISTRICT I
1625 N. French Dr., Hobbs, NM 88240

DISTRICT II
811 South First, Artesia, NM 88210

DISTRICT III
1000 Rio Brazos Rd., Aztec, NM 87410

DISTRICT IV
2040 South Pacheco, Santa Fe, NM 87501

State of New Mexico
Energy, Minerals and Natural Resources Department

OIL CONSERVATION DIVISION

PO BOX 2088
Santa Fe, NM 87504-2088

Form C-101
Revised March 17, 1999
Instructions on back
Submit to appropriate District Office
State Lease - 6 Copies
Fee Lease - 5 Copies

☐ AMENDED REPORT

APPLICATION FOR PERMIT TO DRILL, RE-ENTER, DEEPEN, PLUGBACK, OR ADD A ZONE

¹ Operator Name and Address Yates Petroleum Corporation 105 South Fourth Street Artesia, New Mexico 88210		² OGRID Number 025575
		³ API Number 30-025-29741
⁴ Property Code 28081	⁵ Property Name Kookaburra AZB State	⁶ Well No. 002

⁷ Surface Location

UL or lot no.	Section	Township	Range	Lot Idn	Feet from the	North/South Line	Feet from the	East/West Line	County
B	24	12S	34E		660'	North	1980'	East	Lea

⁸ Proposed Bottom Hole Location If Different From Surface

UL or lot no.	Section	Township	Range	Lot Idn	Feet from the	North/South Line	Feet from the	East/West Line	County
South Lake Four Proposed Pool 1 Austin Wildcat Mississippian					Proposed Pool 2				

¹¹ Work Type Code E	¹² Well Type Code G	¹³ Cable/Rotary R	¹⁴ Lease Type Code S	¹⁵ Ground Level Elevation 4127.5'
¹⁶ Multiple No	¹⁷ Proposed Depth 12,700	¹⁸ Formation Mississippian	¹⁹ Contractor Not Determined	²⁰ Spud Date ASAP

²¹ Proposed Casing and Cement Program

Hole Size	Casing Size	Casing weight/feet	Setting Depth	Sacks of Cement	Estimated TOC
17 1/2"	13 3/8"	54.5#	405'-in place	400 sx	Circulated
12 1/4"	8 5/8"	32#	4200'-in place	1428 sx	Circulated
7 7/8"	5 1/2"	17#	4250' to 10550' in place	1428 sx	TOC-6500'
7 7/8"	5 1/2"	17#	Surface to 4200'	200 sx	Tie Back to 8 5/8"
4 3/4"	3 1/2"	9.6#	10,000 - 12,700'	200 sx	

²² Describe the proposed program. If this application is to DEEPEN or PLUG BACK give the data on the present productive zone and proposed new productivity. Describe the blowout prevention program, if any. Use additional sheets if necessary.

Permit Expires 1 Year From Approval
Date Unless Drilling Underway
See Attached Sheet. Re-Entry

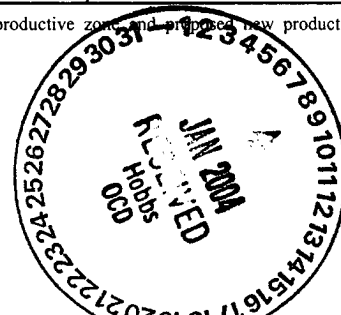

²³ I hereby certify that the information given above is true and complete to the best of my knowledge and belief. Signature: Clifton R. May		OIL CONSERVATION DIVISION Approved by: [Signature] Title: PETROLEUM ENGINEER	
Printed name: Clifton R. May debbiec@ypcnm.com		Approval Date: [Blank] Expiration Date: [Blank]	
Title: Regulatory Agent/Land Department	Date: 01/09/04	Phone: (505) 748-1471	Conditions of Approval: [Blank] 2004

District I

1625 N. French Dr., Hobbs, NM 88240

District II

811 South First, Artesia, NM 88210

District III

1000 Rio Brazos Rd., Aztec, NM 87410

District IV

1220 S. St. Francis Dr., Santa Fe, NM 87505

State of New Mexico

Energy, Minerals & Natural Resources Department

Form C-102

Revised August 15, 2000

OIL CONSERVATION DIVISION

1220 South St. Francis Dr.

Santa Fe, NM 87505

Submit to Appropriate District Office

State Lease - 4 Copies

Fee Lease - 3 Copies

☐ AMENDED REPORT

WELL LOCATION AND ACREAGE DEDICATION PLAT

¹ API Number 30-025-29741	² Pool Code 97164	³ Pool Name SE Four Lakes Austin S1235191: Wildcat Austin
⁴ Property Code 28081	⁵ Property Name Kookaburra AZB State	
⁷ OGRID No. 025575	⁸ Operator Name Yates Petroleum Corporation	⁶ Well Number 2
		⁹ Elevation 4127.5'

¹⁰ Surface Location

UL or lot no.	Section	Township	Range	Lot Idn	Feet from the	North/South line	Feet from the	East/West line	County
B	24	12S	34E		660	North	1980	East	Lea

¹¹ Bottom Hole Location If Different From Surface

UL or lot no.	Section	Township	Range	Lot Idn	Feet from the	North/South line	Feet from the	East/West line	County
¹² Dedicated Acres 320 E/2		¹³ Joint or Infill		¹⁴ Consolidation Code		¹⁵ Order No.			

NO ALLOWABLE WILL BE ASSIGNED TO THIS COMPLETION UNTIL ALL INTERESTS HAVE BEEN CONSOLIDATED OR A NON-STANDARD UNIT HAS BEEN APPROVED BY THE DIVISION

16			17 OPERATOR CERTIFICATION I hereby certify that the information contained herein is true and complete to the best of my knowledge and belief. <i>Clifton R. May</i> Signature Clifton R. May Printed Name Regulatory Agent Title 01/09/04 Date	
				18 SURVEYOR CERTIFICATION I hereby certify that the well location shown on this plat was plotted from field notes of actual surveys made by me or under my supervision, and that the same is true and correct to the best of my belief. REFER TO ORIGINAL PLAT Date of Survey Signature and Seal of Professional Surveyor: Certificate Number

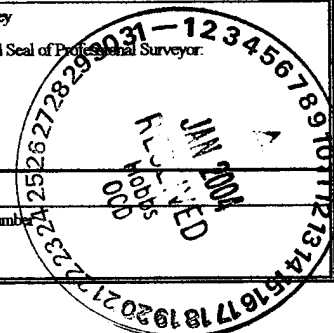

NEW MEXICO OIL CONSERVATION COMMISSION
WELL LOCATION AND ACREAGE DEDICATION PLAT

Form C-102
Supersedes C-128
Effective 1-1-65

All distances must be from the outer boundaries of the Section

Operator TENNECO OIL CO.		Lease STATE OF "24"		Well No. 2
Well Letter B	Section 24	Township 12 SOUTH	Range 34 EAST	County LEA
Actual Footage Location of Well:				
660 feet from the NORTH line and		1980 feet from the EAST line		
Ground Level Elev. 4127.5	Producing Formation Pennsylvanian	Pool Ranger Lake Penn	Dedicated Acreage: 80 Acres	

- Outline the acreage dedicated to the subject well by colored pencil or hatchure marks on the plat below.
- If more than one lease is dedicated to the well, outline each and identify the ownership thereof (both as to working interest and royalty).
- If more than one lease of different ownership is dedicated to the well, have the interests of all owners been consolidated by communitization, unitization, force-pooling, etc?

☐ Yes ☐ No If answer is "yes," type of consolidation _____

If answer is "no," list the owners and tract descriptions which have actually been consolidated. (Use reverse side of this form if necessary.) _____

No allowable will be assigned to the well until all interests have been consolidated (by communitization, unitization, forced-pooling, or otherwise) or until a non-standard unit, eliminating such interests, has been approved by the Commission.

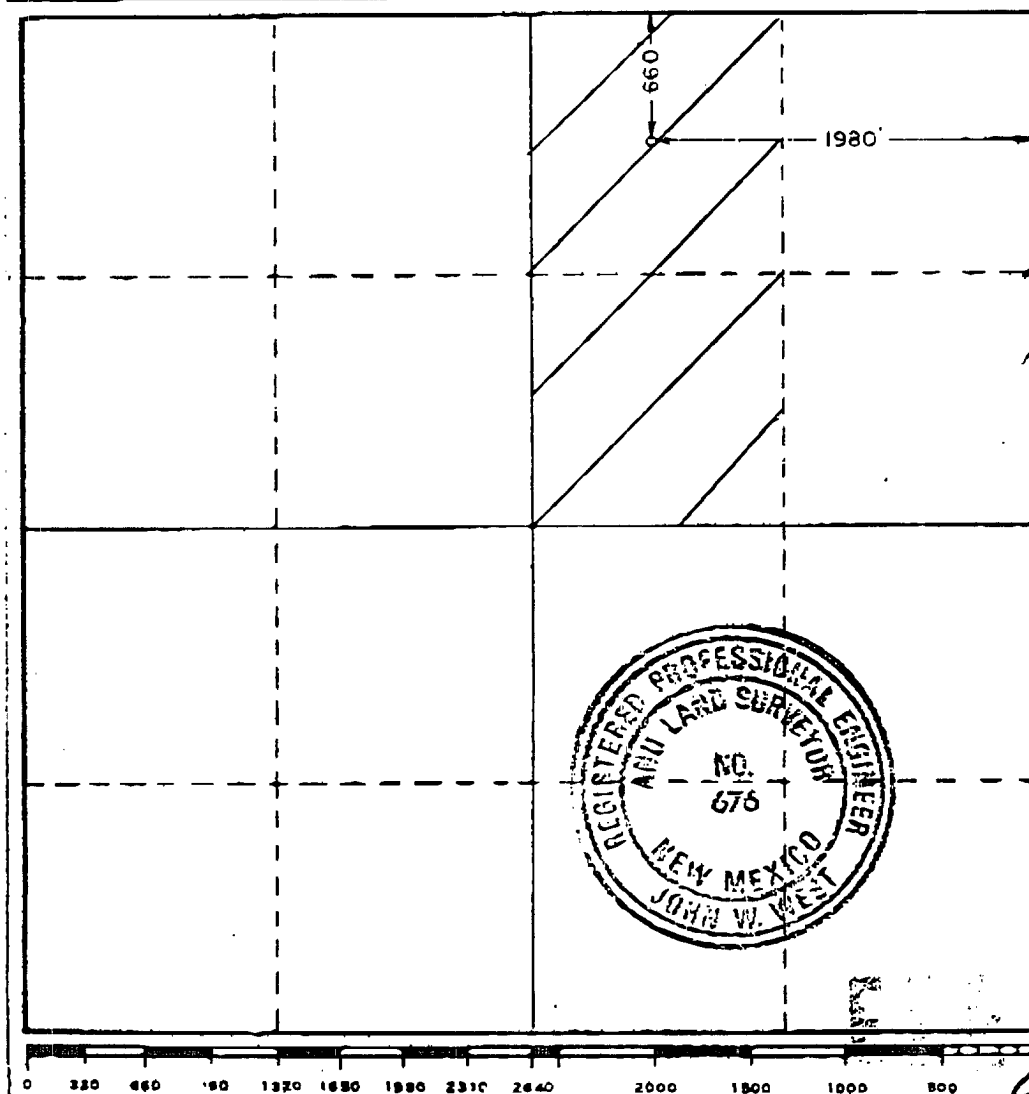

CERTIFICATION

I hereby certify that the information contained herein is true and complete to the best of my knowledge and belief.

Name

Gary Fitzsimmons

Position

Geologist

Company

Tenneco Oil Co.

Date

8/15/86

I hereby certify that the well location shown on this plat was plotted from field notes of actual survey made by me or under my supervision, and that the same is true and correct to the best of my knowledge and belief.

Date Surveyed

AUGUST 11, 1986

Registered Professional Engineer and/or Land Surveyor

Certificate No. **JOHN W. WEST, 676**

RONALD J. EIDSON, 3239

YATES PETROLEUM CORPORATION

Kookaburro AZB State #2 Re-entry

660' FNL & 1980' FEL

Section 24-T12S-R34E

Lea County, New Mexico

Lease VO-5930

Drilling Plans: Yates Petroleum Corporation plans to re-enter this well bore that was originally drilled by Apache Corporation as their State QE "24" #1, which was plugged on December 12, 1986. Yates will use a pulling unit and a reverse unit to drill out the cement plugs using a 7 7/8" bit in the 8 5/8" casing and to the top of the 5 1/2" at 4250'. Run in with 4 3/4" bit and clean out the cement in the 5 1/2" casing to 4350'. Will run 5 1/2" casing with slipjoint and work over 5 1/2" casing stub. Cement casing with 200 sacks of cement. Trip in 5 1/2" casing and drill out plugs to the original TD of 10,550'. During the cleaning out each set of old perms will be squeezed and pressure tested. At that point a drilling rig will be moved in and the well bore will be drilled deeper to a new TD of 12,700' using 4 3/4" bit. After reaching the new TD, a new suite of open hole logs will be ran. Yates will run 3 1/2" casing to TD and will be cemented with approximately 200 sacks of cement to bring the cement top up to 10,000'+/-. The mud program to be used will be 8.5-10 ppg cut brine with salt gel and starch. A 5000# BOPE will be installed on the 8 5/8" casing.

The well will be completed using a pulling unit. The Mississippian formation or the Morrow will be the main target for completion.

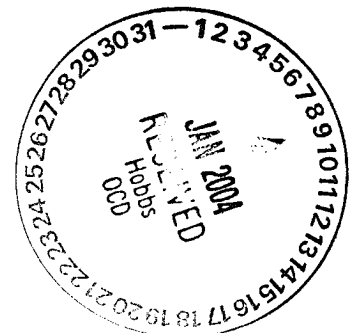

Well Name: Kookaburra AZB No. 2 Field: _____

Location: 660' FNL & 1980' FEL Sec. 24-12S-34E Lea Co, NM

GL: 4127.5' Zero: _____ AGL: _____ KB: _____

Spud Date: 9/13/86 Completion Date: 12/1/86

Comments: Originally drilled by Tenneco and taken over and eventually plugged

by Apache. Original well name State QE 24-1.

Casing Program

Size/Wt/Grade/Conn	Depth Set
13 3/8" 54.5 & 61#	405'
8 5/8" 24# J55 & 32# K55	4200'
5 1/2" 17#	10550'

CURRENT CONFIGURATION

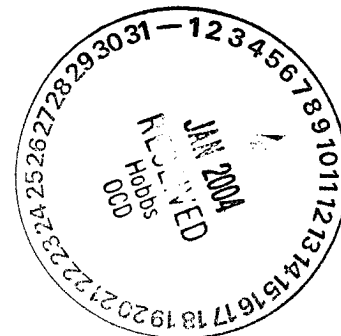
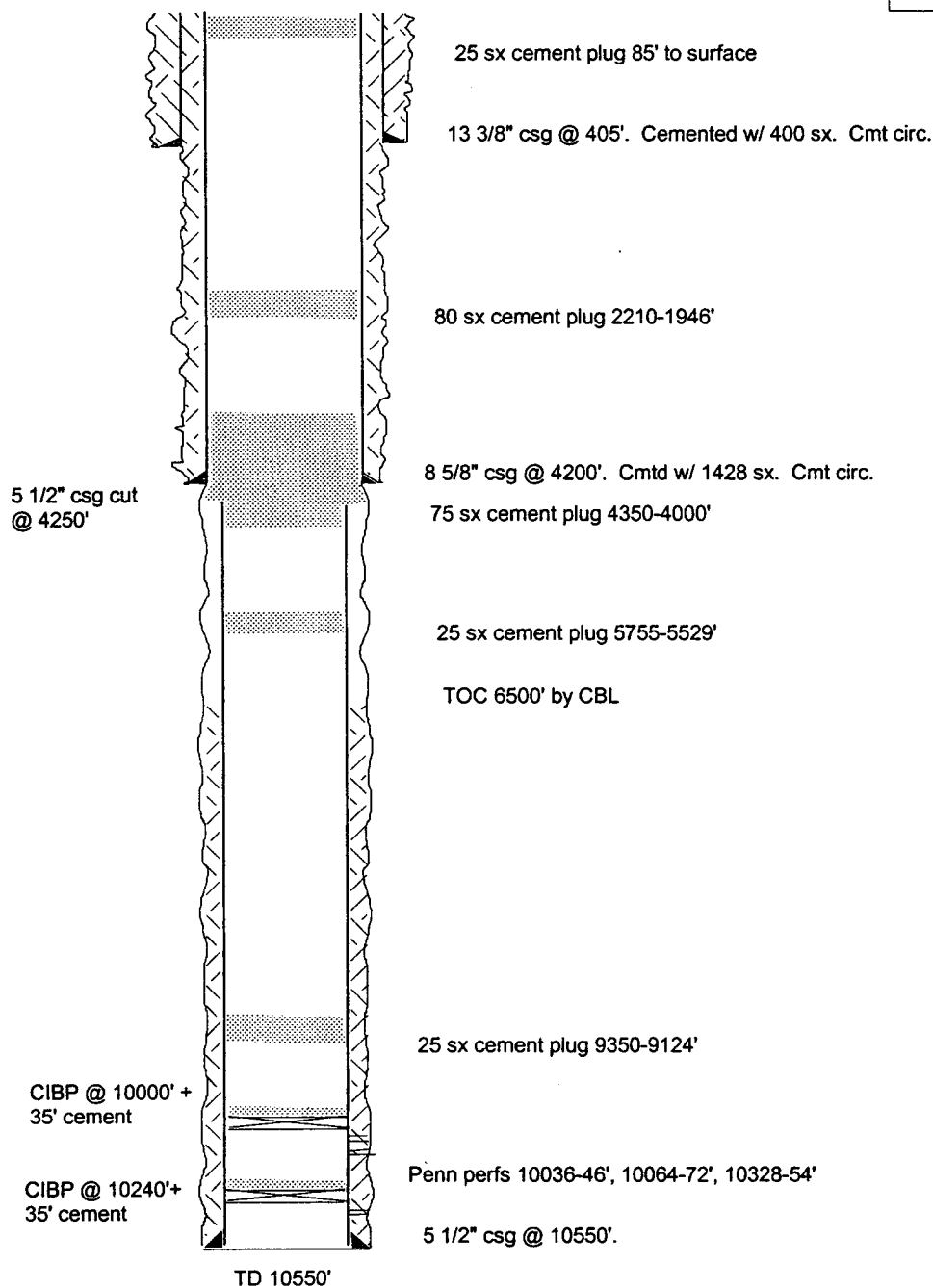

SKETCH NOT TO SCALE

DATE: _____

Well Name: Kookaburra AZB No. 2 Field: _____

Location: 660' FNL & 1980' FEL Sec. 24-12S-34E Lea Co, NM

GL: 4127.5' Zero: _____ AGL: _____ KB: _____

Spud Date: 9/13/86 Completion Date: 12/1/86

Comments: Originally drilled by Tenneco and taken over and eventually plugged

by Apache. Original well name State QE 24-1.

Casing Program

Size/Wt/Grade/Conn	Depth Set
13 3/8" 54.5 & 61#	405'
8 5/8" 24# J55 & 32# K55	4200'
5 1/2" 17#	10550'
3 1/2" 9.6# P110 liner	10000'-12700'

PROPOSED CONFIGURATION

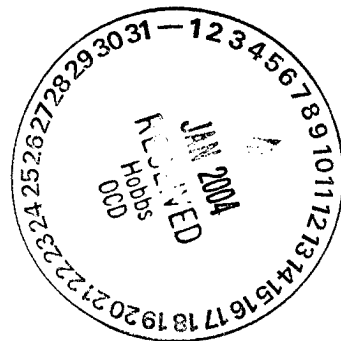
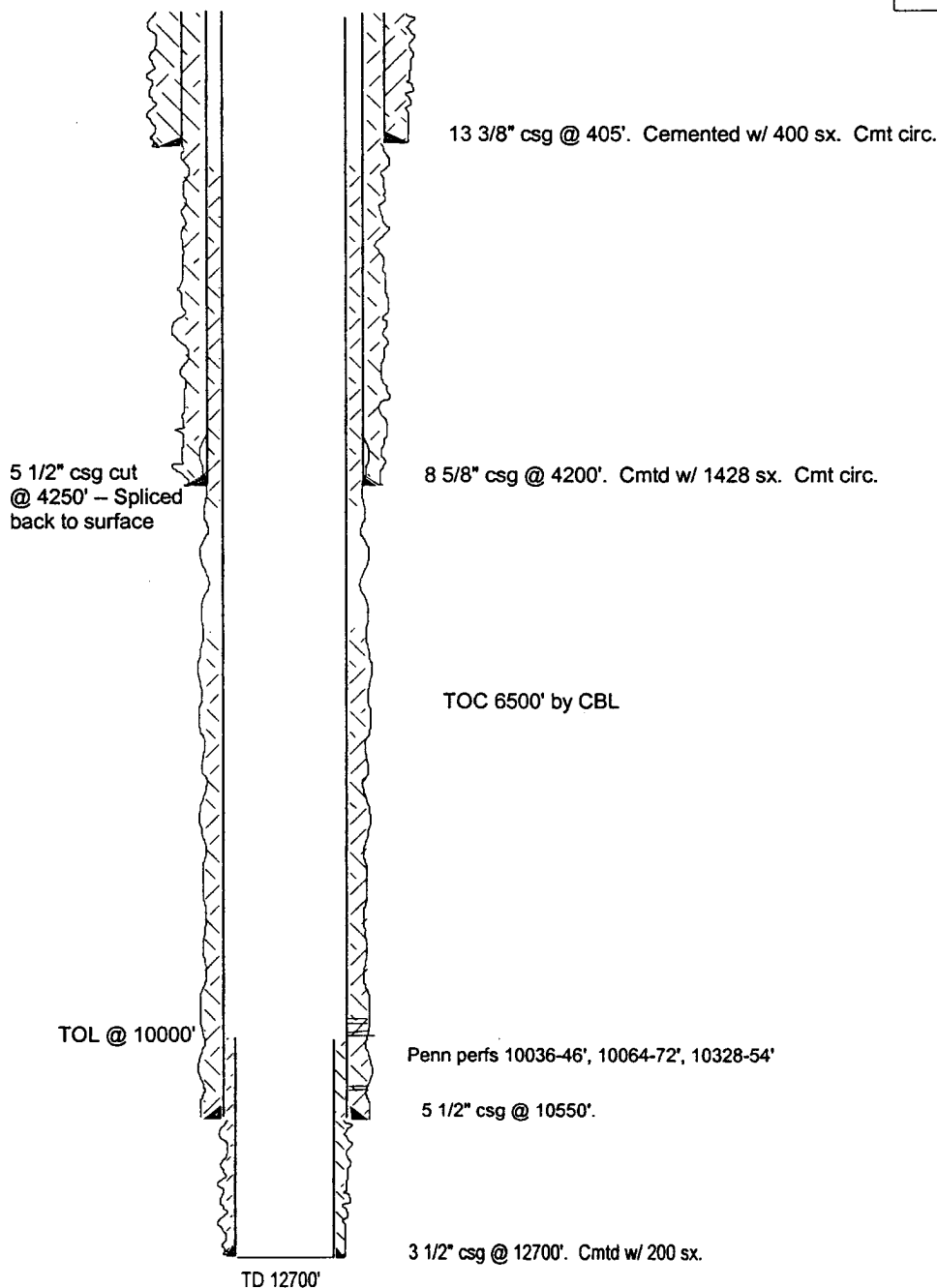

SKETCH NOT TO SCALE

DATE: _____

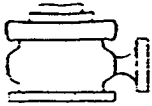

Yates Petroleum Corporation

BOP-4

Typical 5,000 psi Pressure System Schematic Annular with Double Ram Preventer Stack

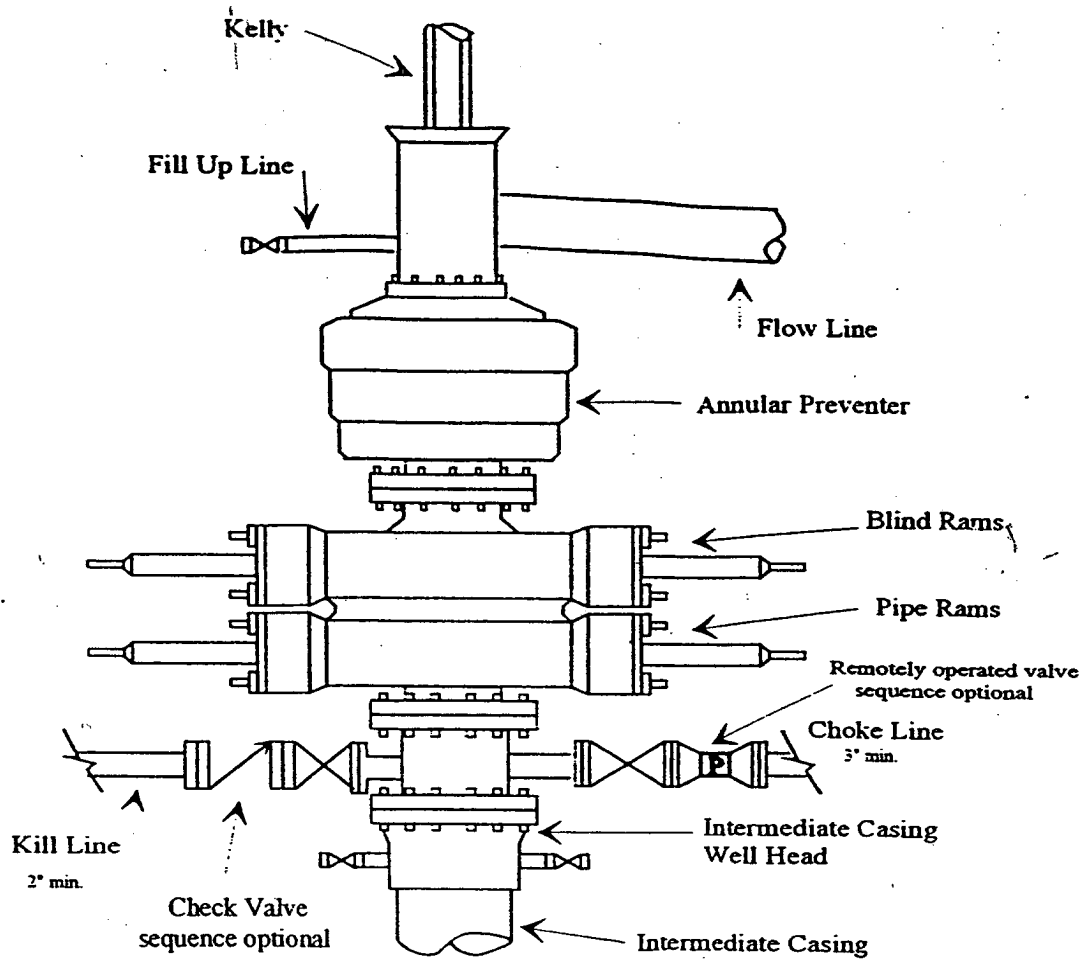

Typical 5,000 psi choke manifold assembly with at least these minimum features

