

District I

1625 N French Dr, Hobbs, NM 88240

District II

1301 W Grand Ave, Artesia, NM 88210

District III

1000 Rio Brazos Rd, Aztec, NM 87410

District IV

1220 S St Francis Dr, Santa Fe, NM 87505

**RECEIVED**

OCT 30 2009

**HOBBSOCD**

OIL CONSERVATION DIVISION

1220 South St. Francis Dr.

Santa Fe, NM 87505

WELL API NO. 30-025-31244	<input checked="" type="checkbox"/>
5. Indicate Type of Lease STATE <input checked="" type="checkbox"/> FEE <input type="checkbox"/>	
6. State Oil & Gas Lease No. E-7653	
7. Lease Name or Unit Agreement Name Nowata AGR State	<input checked="" type="checkbox"/>
8. Well Number 1	<input checked="" type="checkbox"/>
9. OGRID Number 255333	<input checked="" type="checkbox"/>
10. Pool name or Wildcat Vacuum ; Bone Springs, Mid	<input checked="" type="checkbox"/>

**SUNDRY NOTICES AND REPORTS ON WELLS**  
(DO NOT USE THIS FORM FOR PROPOSALS TO DRILL OR TO DEEPEN OR PLUG BACK TO A DIFFERENT RESERVOIR. USE "APPLICATION FOR PERMIT" (FORM C-101) FOR SUCH PROPOSALS)

1. Type of Well: Oil Well ☒ Gas Well ☐ Other ☐

2. Name of Operator  
Lime Rock Resources A, L.P.

3. Address of Operator  
Heritage Plaza, 1111 Bagby St. Suite 4600, Houston, TX 77002

4. Well Location  
Unit Letter: P: 880 feet from the South line and 990 feet from the East line  
Section 9 Township 18S Range 35E NMPM Lea County

11. Elevation (Show whether DR, RKB, RT, GR, etc.)  
3,920' GR

12. Check Appropriate Box to Indicate Nature of Notice, Report or Other Data

**NOTICE OF INTENTION TO:**

- PERFORM REMEDIAL WORK ☐ PLUG AND ABANDON ☒
- TEMPORARILY ABANDON ☐ CHANGE PLANS ☐
- PULL OR ALTER CASING ☐ MULTIPLE COMPL ☐
- DOWNHOLE COMMINGLE ☐
- OTHER: ☐ T/A

**SUBSEQUENT REPORT OF:**

- REMEDIAL WORK ☐ ALTERING CASING ☐
- COMMENCE DRILLING OPNS. ☐ P AND A ☐
- CASING/CEMENT JOB ☐
- OTHER: ☐

13. Describe prop used or completed operations. (Clearly state all pertinent details, and give pertinent dates, including estimated date of starting any proposed work). SEE RULE 1103. For Multiple Completions: Attach wellbore diagram of proposed completion or recompletion.

Current Condition:

13-3/8", 54.5#, J-55, ST&C Surface Casing @ 450'. Cemented with 550 sxs to surface.  
9-5/8", 36 & 40#, J-55 Intermediate Casing @ 3,850'. Cemented with 1,500 sxs to surface.  
7", 26#, J-55, N-80, & S-95; LT&C Casing @ 10,910'. Cemented with 1,400 sxs to surface.  
Perfs: 7,259-65'; 7,314-20'; 7,454-70' & 8,025-36'

Proposed Procedure to TA well:

1. Pull rods, pump and tubing.
2. Set CIBP @ 7,200' with 35' of cement on top of plug to temporarily existing Bone Springs (Vacuum ; Bone Springs, Mid Pool) perforations.
3. Re-run tubing and circulate hole full with brine. POOH and lay down tubing.
4. Install tubing sub and valve.
5. RU pump truck and pressure recorder.
6. Test casing and plug to 500#.

Condition of Approval : Notify OCD Hobbs office 24 hours prior to running MIT Test & Chart

I hereby certify that the information above is true and complete to the best of my knowledge and belief.

SIGNATURE C. Tim Miller TITLE Vice President - Operations DATE 29 October 2009

Type or print name C. Tim Miller E-mail address: tmiller@limerockresources.com PHONE: (713) 292-9514

**For State Use Only**

APPROVED BY: Mary Brown TITLE Compliance Officer DATE 11/3/2009

Conditions of Approval (if any)

# WELLBORE AFTER TA

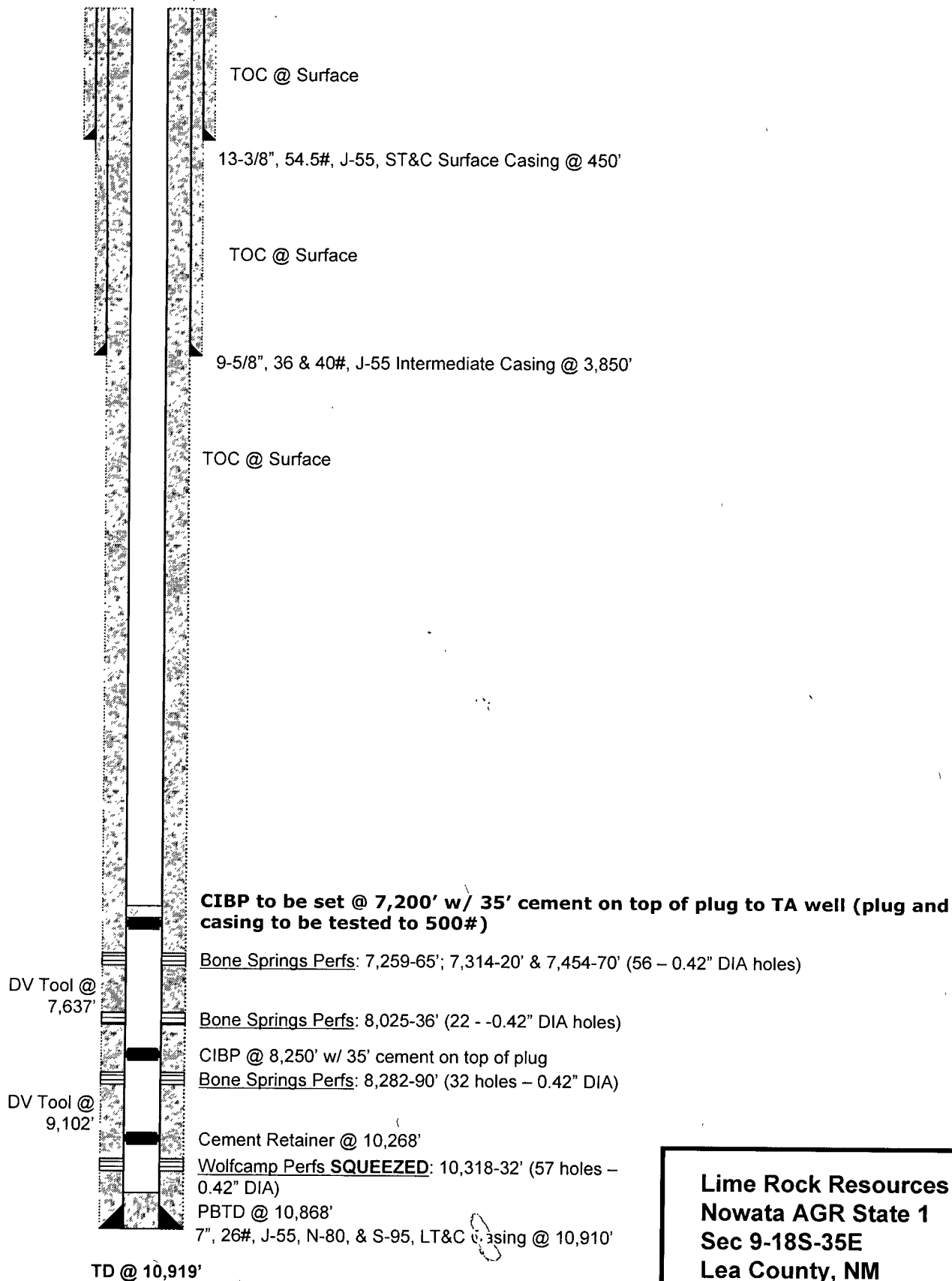

**Lime Rock Resources  
Nowata AGR State 1  
Sec 9-18S-35E  
Lea County, NM**