

UNITED STATES
DEPARTMENT OF THE INTERIOR
BUREAU OF LAND MANAGEMENT

RECEIVED
OCD Hobbs
NOV 23 2009

FORM APPROVED
OMB No. 1004-0135
Expires July 31, 1996

SUNDRY NOTICES AND REPORTS ON WELLS
Do not use this form for proposals to drill or to re-enter an
abandoned well. Use form 3160-3 (APD) for such proposals.

SUBMIT IN TRIPLICATE - Other instructions on reverse side

| | | |
|--|--|---|
| 1. Type of Well <input type="checkbox"/> Oil Well <input checked="" type="checkbox"/> Gas Well <input type="checkbox"/> Other | | 5. Lease Serial No NM-6868 |
| 2. Name of Operator Cimarex Energy Co. of Colorado | | 6. If Indian, Allottee or Tribe Name |
| 3a. Address 600 N. Marienfeld St., Ste. 600; Midland, TX 79701 | | 7. If Unit or CA/Agreement, Name and/or No NM-117278 |
| 3b. Phone No (include area code) 432-571-7800 | | 8. Well Name and No. Pipeline A Federal Com No. 3 ✓ |
| 4. Location of Well (Footage, Sec., T., R., M., or Survey Description) 1150 FNL & 950 FWL 8-19S-34E | | 9. API Well No 30-025-37192 ✓ |
| | | 10. Field and Pool, or Exploratory Area Quail Ridge; Morrow, North (Gas) |
| | | 11. County or Parish, State Lea County, NM ✓ |

12. CHECK APPROPRIATE BOX(ES) TO INDICATE NATURE OF NOTICE, REPORT, OR OTHER DATA

| TYPE OF SUBMISSION | TYPE OF ACTION | | | |
|--|---|---|--|---|
| <input checked="" type="checkbox"/> Notice of Intent | <input type="checkbox"/> Acidize | <input type="checkbox"/> Deepen | <input type="checkbox"/> Production (Start/Resume) | <input type="checkbox"/> Water Shut-Off |
| <input type="checkbox"/> Subsequent Report | <input type="checkbox"/> Alter Casing | <input type="checkbox"/> Fracture Treat | <input type="checkbox"/> Reclamation | <input type="checkbox"/> Well Integrity |
| <input type="checkbox"/> Final Abandonment Notice | <input type="checkbox"/> Casing Repair | <input type="checkbox"/> New Construction | <input checked="" type="checkbox"/> Recomplete | <input checked="" type="checkbox"/> Other Plug Morrow, RC |
| | <input type="checkbox"/> Change Plans | <input type="checkbox"/> Plug and Abandon | <input type="checkbox"/> Temporarily Abandon | in Bone Spring |
| | <input type="checkbox"/> Convert to Injection | <input type="checkbox"/> Plug Back | <input type="checkbox"/> Water Disposal | |

13. Describe Proposed or Completed Operation (clearly state all pertinent details, included estimated starting date of any proposed work and approximate duration thereof.
If the proposal is to deepen directionally or recompleate horizontally, give subsurface locations and measured and true vertical depths of all pertinent markers and zones
Attach the bond under which the work will be performed or provide the Bond No on file with BLM/BIA Required subsequent reports shall be filed within 30 days
following completion of the involved operations If the operation results in a multiple completion or recompleation in a new interval, a Form 3160-4 shall be filed once
testing has been completed. Final Abandonment Notices shall be filed only after all requirements, including reclamation, have been completed, and the operator has
determined that the site is ready for final inspection)
Well SI since July 2008. Well currently completed in the Morrow with perfs @ 13052'-13078' and 13199'-13203.' Junk in hole and a
CBP @ 13221' cover perfs @ 13358'-13363' and a CIBP w/ 2 sx cmt covers Morrow perfs @ 13450'-13462.'

Cimarex proposes to recompleate to the Bone Spring formation by performing the following operations:

- Kill well w/ 7% KCL water. NU 5K BOP. Release pkr and POOH w/ tubing.
- Set CIBP @ 13020.' Dump 35' cmt on top of CIBP.
- Perf Bone Spring w/ 4" casing guns 9372-9386' w/ 3 spf, 120° phasing, 43 holes.
- Acidize 12188'-12208' w/ 1400 gal 15% NeFe Bone Spring Acid blend and 65 ball sealers.
- Install pumping equipment and put to sales.

Please see attached procedure and plat.

**SEE ATTACHED FOR
CONDITIONS OF APPROVAL**

Please note that Cimarex has chosen to leave Strawn behind pipe and not plug back at this time. We have plans to add Strawn in the
future to DHC with proposed Bone Spring @ 9372-9386.'

| | | | |
|---|--------|---|-----------------------------------|
| 14. I hereby certify that the foregoing is true and correct Name (Printed/Typed) Natalie Krueger | | Title Regulatory Date November 16, 2009 | PETROLEUM ENGINEER NOV 24 2009 |
| Signature <i>Natalie Krueger</i> | | APPROVED NOV 19 2009 WESLEY W. INGRAM PETROLEUM ENGINEER | |
| THIS SPACE FOR FEDERAL OR STATE OFFICE USE | | | |
| Approved by | Title | | |
| Conditions of Approval, if any, are attached. Approval of this notice does not warrant or certify that the applicant holds legal or equitable title to those rights in the subject lease which would entitle the applicant to conduct operations thereon. | Office | | |

Title 18 U.S.C. Section 1001, makes it a crime for any person knowingly and willfully to make to any department or agency of the United States any false, fictitious or
fraudulent statements or representations as to any matter within its jurisdiction.

(Instructions on reverse)

DISIRICI II
B11 South First, Artesia. NM 882

DISTRICT IV
2040 South Pacheco, Santa Fe, NM 87505

NOV 23 2009

HOBBSON

Energy, Minerals and Natural Resources Department

Form C-102
Revised March 17, 1999

Submit to Appropriate District Office
State Lease - 4 Copies
Fee Lease - 3 Copies

2040 South Pacheco

Santa Fe, New Mexico 87504-2088

AMENDED REPORT

| | | | |
|----------------------------|---|--------------------|-------------------------------|
| API Number 30-025-37192 | | Pool Code 21650 | Pool Name E-K; Bone Spring |
| Property Code 34750 | Property Name PIPELINE A FEDERAL COM | | Well Number 3 |
| OGRID No. 162683 | Operator Name CIMAREX ENERGY CO. OF COLORADO | | Elevation 3794' |

| | | | | | | | | | |
|---------------|---------|----------|-------|---------|---------------|------------------|---------------|----------------|--------|
| UI or lot No. | Section | Township | Range | Lot Idn | Feet from the | North/South line | Feet from the | East/West line | County |
| D | 8 | 19 S | 34 E | | 1150 | NORTH | 950 | WEST | LEA |

| | | | | | | | | | |
|-----------------------|-----------------|--------------------|-------|--------------------------|---------------|------------------|---------------|----------------|--------|
| UL or lot No. | Section | Township | Range | Lot Idn | Feet from the | North/South line | Feet from the | East/West line | County |
| Dedicated Acres 80 | Joint or Infill | Consolidation Code | | Order No. NSL Pending | | | | | |

NO ALLOWABLE WILL BE ASSIGNED TO THIS COMPLETION UNTIL ALL INTERESTS HAVE BEEN CONSOLIDATED
OR A NON-STANDARD UNIT HAS BEEN APPROVED BY THE DIVISION

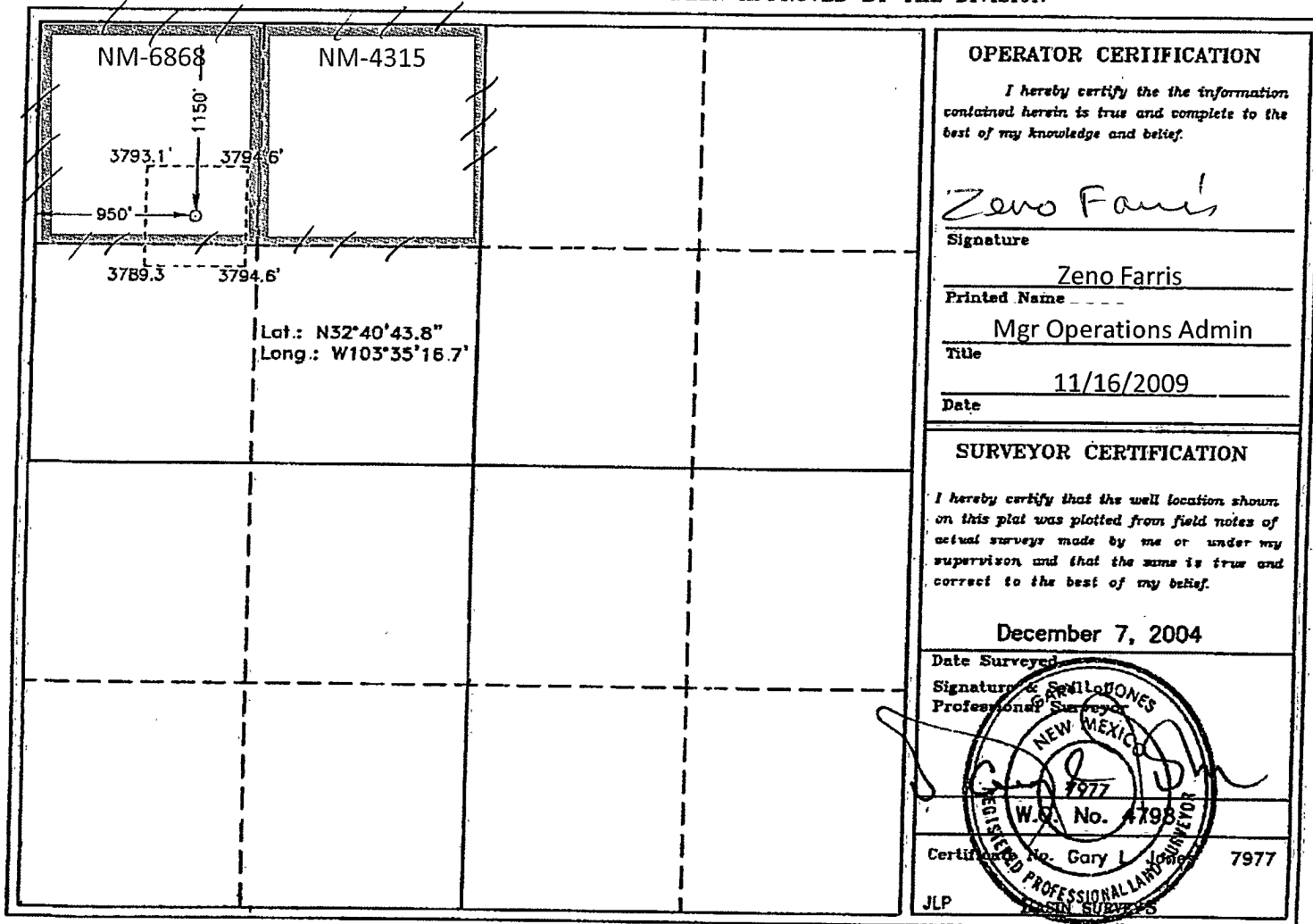

PIPELINE A FEDERAL COM #3 BONE SPRING RECOMPLETION

API # 30-025-37192
1150' FNL & 950' FWL
Section 8, T19S, R34E
Lea County, New Mexico

GL : 3794'
KB : 3819'
TD DRILLER : 13,696'
PBTD : FISH @ 13221'
SURF CSG : 13-3/8" OD 48#/FT H-40 ST&C @ 425' Cmtd W/ 410 SX.(167 SX CIRC)
INTER CSG : 9-5/8" OD 40#/FT J-55 LT&C @ 3490' Cmtd W/ 1080 SX. (NOT CIRC)
PROD CSG : 5-1/2" OD 17#/FT P-110 LT&C@13,696' Cmtd W/2430 SX(TOC@1900'-CBL)
DV TOOL : 9523'
PACKER : 5-1/2" x 2-3/8" PKR W/ 1.87 "X" NIPPLE & ON/OFF TOOL @ 12960'
TUBING : 2-3/8" L-80
PERFS : MORROW PERFS@13052'-059',13072'-078',13199'-203',13358'-363'
CIBP : 13,425' W/ 2 SX CMT
FISH : COMPOSITE PLUG PUSHED TO 13221' W/ FISH COVERING
PERFS 13358'-363'

****BACKSIDE LOADED WITH 7% KCL PACKER FLUID****

BONE SPRING

1. MIRU PULLING UNIT. PERFORM PRE-JOB SAFETY MEETING. ND WELLHEAD NU BOPS. SOFT KILL WELL IF NECESSARY. RELEASE 5-1/2" PACKER AT 12,960'. TOO H W/ 5-1/2" PACKER AND 2-3/8" TUBING. IF PACKER WILL NOT RELEASE, STING OUT OF PACKER AND TOO H.
2. DO NOT BEGIN CONSTRUCTION OF BATTERY OR PUMPING UNIT UNTIL ZONE HAS BEEN TESTED AND APPROVED TO MOVE FORWARD BY MIDLAND ENGINEERING.
3. RIH W/ 5-1/2" CIBP ON 2-3/8" TUBING. SET 5-1/2" CIBP AT 13,020'. DUMP 35' CMNT ON TOP OF CIBP.
4. LOAD HOLE W/ 2% KCL WATER AND TEST TO 3000 PSIG.
5. SET CMNT PLUGS COMING UP THE HOLE ACCORDING TO STATE GUIDELINES
6. RIH W/ 4" PERFORATING GUNS. PERFORATE BONE SPRING INTERVAL FROM 9,372'-9,386' USING 3 SPF W/ 120 DEG. PHASING 43 HOLES. CORRELATE TO OPEN HOLE HALLIBURTON NEUTRON-DENSITY LOG DATED 11/02/05. MONITOR FLUID LEVEL IN AND OUT OF HOLE.
7. RIH WITH 5-1/2" RBP W/ BALL CATCHER AND 5-1/2" TREATING PACKER ON 2-3/8" TUBING, TESTING TUBING IN HOLE TO 8000 PSI. SET 5-1/2" RBP W/ BALL CATCHER @ 9,420'. PULL UP AND SET 5-1/2" TREATING PACKER AT 9,320'.
8. RU BJ STIMULATION. BREAKDOWN PERFORATIONS FROM (9372'-9386') USING 1400 GALLONS 15% NEFE BONE SPRING ACID BLEND AND 65 BALL SEALERS. MAX RATE 8 BPM MAX PRESSURE 5500 PSI. **RECORD 1 SECOND DATA FOR 1 HOUR FOLLOWING ACID JOB.** SWAB PERFS DOWN TO SN ON DAY OF ACID JOB. RECORD CUT AND FLUID ENTRY FOR THE FIRST RUN THE FOLLOWING DAY. CONTINUE SWABBING AND REPORT RESULTS TO ENGINEERING.

9. RELEASE TREATING PACKER AT 9,320'. GO DOWN AND PICK UP RBP AT 9,420'. TOOH W/ PACKER, RBP, AND 2-3/8" TUBING.
10. RIH WITH 2-3/8 TUBING AND BHA CONFIGURED FOR PUMPING AND SET EOT @ ~9420'.
11. INSTALL PUMPING EQUIPMENT AND OBTAIN PRODUCTION TEST FROM BONE SPRING PAY.
12. HAVE BJ MONITOR SCALE INHIBITOR RESIDUALS MONTHLY. OBTAIN DYNO CARD AND FLUID LEVEL AFTER WELL HAS BEEN PUMPING FOR 10 DAYS.

CIMAREX ENERGY CO.

SPUDDED 9/20/05

Pipeline 'A' Federal Com #3

API: 30-025-37192

CURRENT COMPLETION

Laci Luig 12/4/06

KB: 3819' (25' AGL)

DF:

GL: 3794'

1150' FNL & 950' FWL
Unit D, Sec 8, T19S R34E
Lea County, NM

Casing Strings:

20" Conductor @ 40'

13 3/8" 48# H40 STC @ 425'

Lead: 260 sx Prem. Plus

Tail: 150 sx Prem. Plus, circ 167 sx

9 5/8" 40# J55 LTC @ 3490'

Lead: 880 sx Interfill 'C'

Tail: 200 sx Prem. Plus, did not circ

5 1/2" 17# P110 LTC @ 13,696'

1st stage

Lead: 120 sx Interfill 'H'

Tail: 800 sx PB Super 'H'

2nd stage

Lead: 1380 sx Interfill 'H'

Tail: 130 sx PB Super 'H'

TOC @ 1900'

Perf: 13,052'-059' & 13,072'-078' w/6 SPF
(48 holes + 42 holes) 12/23/05

Perf: 13,199'-203' & 13,358'-363' w/6 SPF
(30 holes + 36 holes) 12/7/05

Perf: 13,450'-462' w/ SPF (78 holes)
11/29/2005

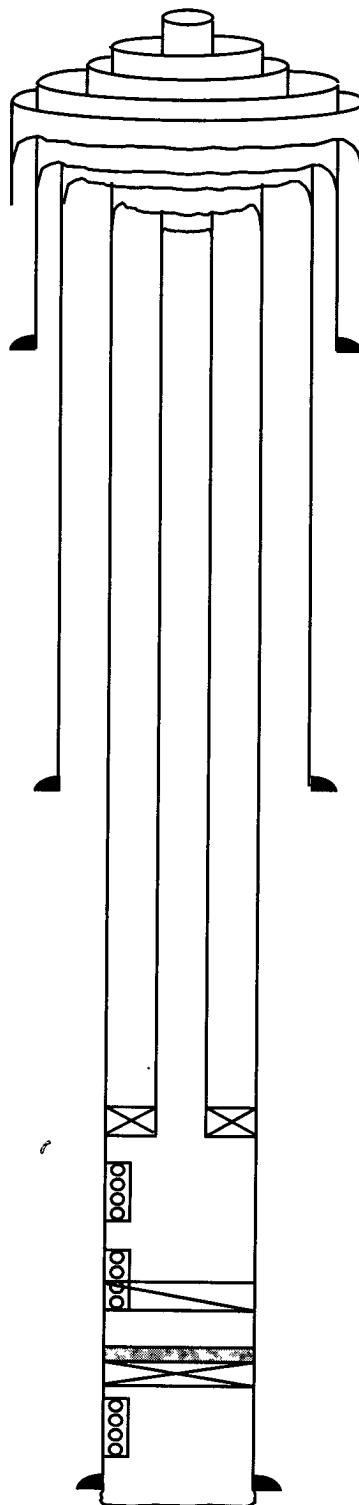

Tubing String: detail from 1/6/06 rpt
240 jts 2 3/8" tbg
On/Off tool
Pkr w/1.87" X nipple @ 12,960'

JUNK IN HOLE

Composite plug pushed to 13,221'
w/fish covering perfs 13,358'-363'

CIBP @ 13,425' w/2 sx cmt on top

TD = 13,696

PBTB: 13,415' (CIBP)
Original PBTB: 13,588'

**Pipeline A Federal Com No. 3
30-025-37192
Cimarex Energy Co. of Colorado
November 19, 2009
Conditions of Approval**

- 1. Well will now be a non-standard location.**
- 2. Operator will be required to address the additional plugs between the Morrow perforations and Bone Spring formation at final abandonment or prior to selling this wellbore to another operator. No plugs will be required at this time since the operator will add the Strawn formation at a later time.**
- 3. Surface disturbance beyond the existing pad must have prior approval.**
- 4. Closed loop system required.**
- 5. Operator to have H2S monitoring equipment on location as H2S has been reported from the Bone Spring formation and in the area.**
- 6. Test BOP equipment.**
- 7. Subsequent sundry and completion report required.**
- 8. A Communitization Agreement covering the acreage dedicated to this well must be filed for approval with the BLM. The effective date of the agreement shall be prior to any sales. Operator to supply NMOCD order, which details the vertical and horizontal extent of pool to verify that requested communitization is within an approved and established pool. NMOCD form C-123 – pool designation request.**

WWI 111909