

NO. OF COPIES RECEIVED	
DISTRIBUTION	
SANTA FE	
FILE	
U.S.G.S.	
LAND OFFICE	
OPERATOR	

NEW MEXICO OIL CONSERVATION COMMISSION

Form C-101  
Revised 1-1-65

5A. Indicate Type of Lease STATE <input checked="" type="checkbox"/> FEE <input type="checkbox"/>
5. State Oil & Gas Lease No. 24037
7. Unit Agreement Name
8. Farm or Lease Name Arnott-Ramsay (NCT-B)
9. Well No. 9
10. Field and Pool, or Wildcat Langlie-Mattix
12. County Lea
19. Proposed Depth 3500'
19A. Formation 7 Rivers-Queen
20. Rotary or C.T. Rotary
21. Elevations (Show whether DF, RT, etc.) 2985' GL
21A. Kind & Status Plug. Bond Blanket
21B. Drilling Contractor Cactus Drlg.
22. Approx. Date Work will start 4-12-80

APPLICATION FOR PERMIT TO DRILL, DEEPEN, OR PLUG BACK

1a. Type of Work b. Type of Well OIL WELL <input checked="" type="checkbox"/> GAS WELL <input type="checkbox"/> OTHER <input type="checkbox"/> 2. Name of Operator GULF OIL CORPORATION 3. Address of Operator P. O. Box 670, Hobbs, NM 88240 4. Location of Well UNIT LETTER K LOCATED 1980 FEET FROM THE South LINE AND 1980 FEET FROM THE West LINE OF SEC. 32 TWP. 25S RGE. 37E NMPM	DEEPEN <input type="checkbox"/> PLUG BACK <input type="checkbox"/> SINGLE ZONE <input checked="" type="checkbox"/> MULTIPLE ZONE <input type="checkbox"/>
23.	

PROPOSED CASING AND CEMENT PROGRAM

SIZE OF HOLE	SIZE OF CASING	WEIGHT PER FOOT	SETTING DEPTH	SACKS OF CEMENT	EST. TOP
11"	8-5/8"	24#	350'		Circ
7-7/8"	5-1/2"	14#	3500'	500	Circ DV tool @ 3000'

Drig Fluids: 0' - 350' Spud mud FW  
350' - 3500' 10# Brine Water

NOTE: See attached BOP Drawing #2

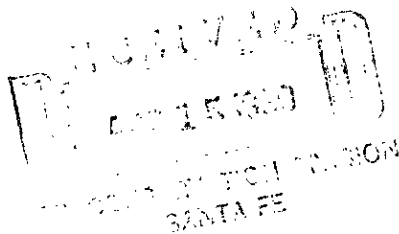

IN ABOVE SPACE DESCRIBE PROPOSED PROGRAM: IF PROPOSAL IS TO DEEPEN OR PLUG BACK, GIVE DATA ON PRESENT PRODUCTIVE ZONE AND PROPOSED NEW PRODUCTIVE ZONE. GIVE BLOWOUT PREVENTER PROGRAM, IF ANY.

I hereby certify that the information above is true and complete to the best of my knowledge and belief.

Signed R. C. Anderson Title Area Production Manager Date 4-9-80

(This space for State Use)

APPROVED BY [Signature] TITLE SUPERVISOR DISTRICT I DATE APR 10 1980

CONDITIONS OF APPROVAL IF ANY:

RECEIVED

APR 10 1980

OIL CONSERVATION DIV.

NEW MEXICO OIL CONSERVATION COMMISSION  
WELL LOCATION AND ACREAGE DEDICATION PLAT

Form C-102  
Supersedes C-128  
Effective 1-1-65

All distances must be from the outer boundaries of the Section.

Operator <b>Gulf oil Corp.</b>		Lease <b>Arnett Ramsey NCT-B</b>		Well No. <b>9</b>
Unit Letter <b>K</b>	Section <b>32</b>	Township <b>25 South</b>	Range <b>37 East</b>	County <b>Lea</b>
Actual Footage Location of Well: <b>1980</b> feet from the <b>South</b> line and <b>1980</b> feet from the <b>West</b> line				
Ground Level Elev. <b>2985.2</b>	Producing Formation <b>7 Rivers-Queen</b>		Pool <b>Langlie-Mattix</b>	Dedicated Acreage: <b>40</b> Acres

1. Outline the acreage dedicated to the subject well by colored pencil or hachure marks on the plat below.
2. If more than one lease is dedicated to the well, outline each and identify the ownership thereof (both as to working interest and royalty).
3. If more than one lease of different ownership is dedicated to the well, have the interests of all owners been consolidated by communitization, unitization, force-pooling, etc?

☐ Yes ☐ No If answer is "yes," type of consolidation \_\_\_\_\_

If answer is "no," list the owners and tract descriptions which have actually been consolidated. (Use reverse side of this form if necessary.) \_\_\_\_\_

No allowable will be assigned to the well until all interests have been consolidated (by communitization, unitization, forced-pooling, or otherwise) or until a non-standard unit, eliminating such interests, has been approved by the Commission.

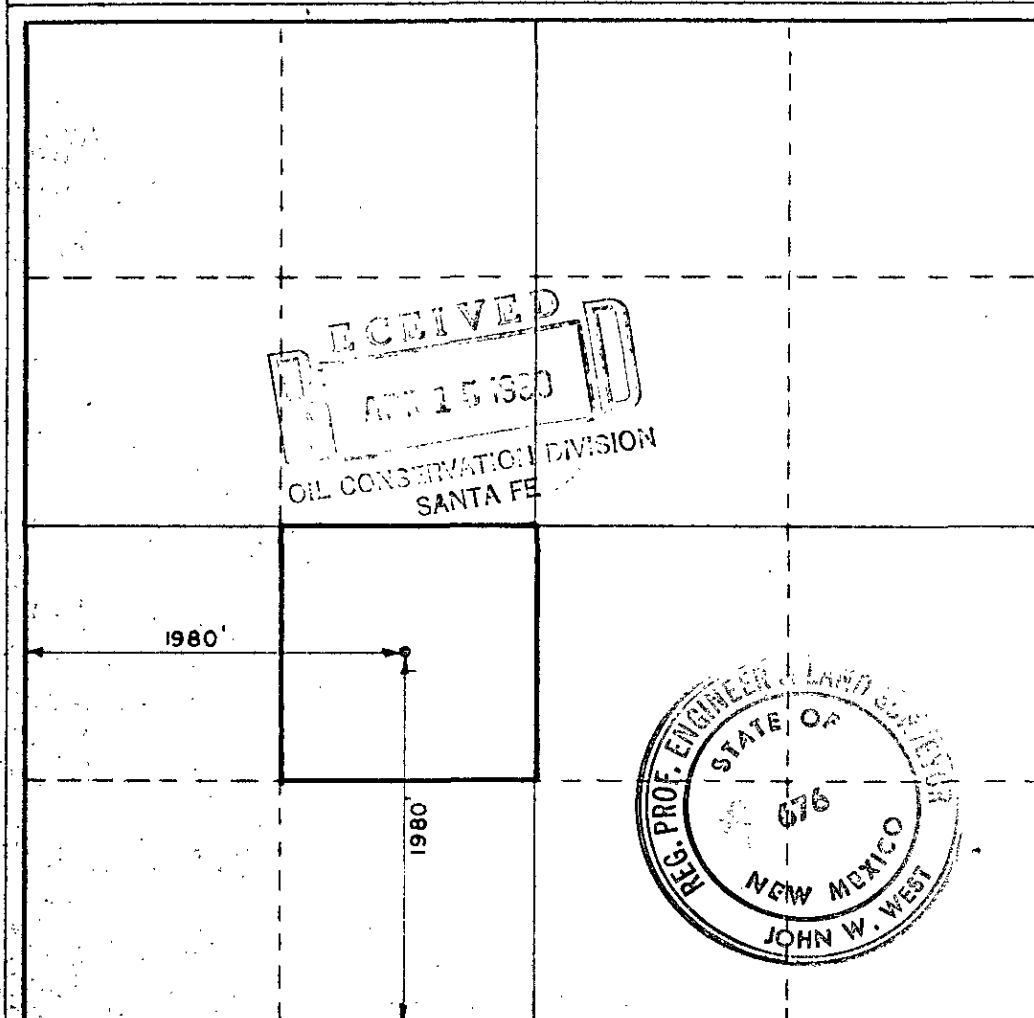

CERTIFICATION

I hereby certify that the information contained herein is true and complete to the best of my knowledge and belief.

*R. C. Anderson*

Name  
**R. C. ANDERSON**  
Position  
**Area Production Manager**  
Company  
**GULF OIL CORPORATION**  
Date  
**4-9-80**

I hereby certify that the well location shown on this plat was plotted from field notes of actual surveys made by me or under my supervision, and that the same is true and correct to the best of my knowledge and belief.

Date Surveyed  
**4-3-1980**  
Registered Professional Engineer and/or Land Surveyor

*John W. West*  
Certificate No. **JOHN W. WEST 676**  
**PATRICK A. ROMERO 6863**  
**Ronald J. Eldson 3239**

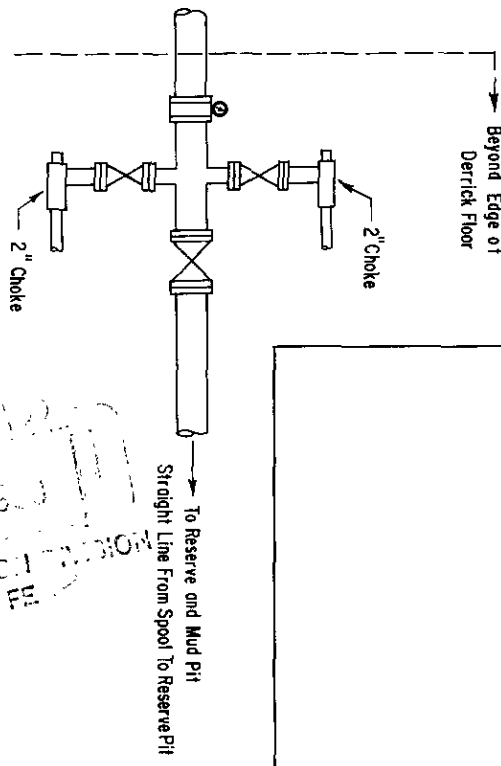
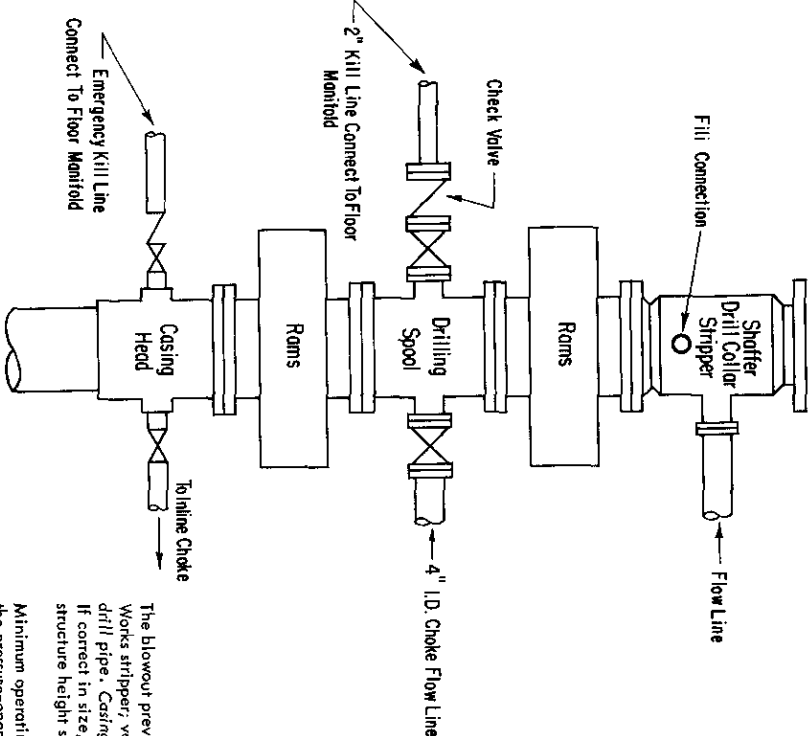

ADDITIONS - DELETIONS - CHANGES SPECIFY

3000 PSI WORKING PRESSURE  
BLOWOUT PREVENTER HOOK-UP

The blowout preventer assembly shall consist of one blind ram preventer and one pipe ram preventer, both hydraulically operated; a Shaffer Tool Works stripper, valves, chokes and connections, as illustrated. If a tapered drill string is used, a ram preventer must be provided for each size of drill pipe. Casing and tubing rams to fit the preventers are to be available as needed. The ram preventers may be two singles or a double type. If correct in size, the flanged outlets of the ram preventer may be used for connecting to the 4-inch I.D. choke flow line and kill line. The sub-structure height shall be sufficient to install a rotating blowout preventer.

Minimum operating equipment for the preventers shall be as follows: (1) Pump (s), driven by a continuous source of power, capable of closing all the pressure-operated devices simultaneously within \_\_\_\_\_ seconds. The pump (s) is to be connected to a closed type hydraulic operating system. (2) When requested, accumulators with a precharge of nitrogen of not less than 750 PSI and connected so as to receive a fluid charge from the above pump (s). With the charging pump (s) shut down, the pressurized fluid volume stored in the accumulators must be sufficient to close all the pressure-operated devices simultaneously within \_\_\_\_\_ seconds; after closure, the remaining accumulator pressure shall be not less than 1000 PSI with the remaining accumulator fluid volume at least \_\_\_\_\_ percent of the original. (3) When requested, an additional source of power, remote and equivalent, is to be available to operate the above pump (s); or there shall be an additional pump (s) operated by separate power and equal in performance capabilities.

The closing manifold shall have a separate control for each pressure-operated device. Controls are to be labeled, with control handles indicating open and closed positions. A pressure reducer and regulator must be provided if a Hydraflo preventer is used. Gulf Legion No. 38 hydraulic oil, or equivalent or better, is to be used as the fluid to operate the hydraulic equipment.

The choke manifold, choke flow line, and choke lines are to be supported by metal stands and adequately anchored. The choke flow line and choke lines shall be constructed as straight as possible and without sharp bends. Easy and safe access is to be maintained to the choke manifold. All valves are to be selected for operation in the presence of oil, gas, and drilling fluids. The choke flow line valve connected to the drilling spool and all ram type preventers must be equipped with stem extensions, universal joints if needed, and hand wheels which are to extend beyond the edge of the derrick substructure. All other valves are to be equipped with handles.

CSG

IP (Seven Rivers-Queen) Perfs 3288-96' F 70 BOPD + 8 BW. Pot based on 24 hr test thru 18/64" chk. GOR 2628; gty 30.2; CP Pkr; TP 340#

CONTR	Cactus #6	OPRS ELEV	2985' GL	PD	3500' RT
-------	-----------	-----------	----------	----	----------

F.R. 4-21-80  
(Seven Rivers-Queen)  
4-28-80 Drlg 3245'  
DST (Yates) 2690-2700', open 35 mins w/fair blow,  
rec 275' DF, 30 mins ISIP 360#, FP 148-254#,  
1 hr 30 mins FSIP 381#, HP 1418-1418#, BHT 88 deg  
Crd (Seven Rivers) 3185-3245', rec 60' no descr  
5-2-80 TD 3450'; PBD 3429'; WOCT  
5-19-80 TD 3450'; PBD 3429'; Swbg  
Perf (Seven Rivers) 3288-96' w/2 SPF  
Acid (3288-96') 1000 gals (15% NEFE)  
Swbd 3 BLW & Swbd dry in 2 hrs 30 mins (3288-96')  
5-22-80 TD 3450'; PBD 3429'; Hooking up tank battery  
Frac (3288-96') 8000 gals + 17,000# sd

6-3-29 NM

LEA  
GULF OIL CORP.

Langlie-Mattix  
2 Arnott Ramsay NCT-B  
Sec 32, T25S, R37E

NM  
Page #2

5-30-80 TD 3450'; PBD 3429'; Flwg to Tank Battery  
Flwd 69 BO + 8 BW + Gas at 184 MCFGPD in 24 hrs  
thru 18/64" chk, TP 340# (3288-96')  
6-16-80 TD 3450'; PBD 3429'; Complete  
LOG TOPS: Salt 1060', Base Salt 2544', Yates  
2690', Seven Rivers 2954', Queen 3358'  
LOG RUN: GRL  
Rig Released 5-1-80  
6-21-80 COMPLETION ISSUED

6-3-29 NM  
IC 30-025-70179-80