

District I
1625 N French Dr., Hobbs, NM 88240
District II
1301 W Grand Avenue, Artesia, NM 88210
District III
1000 Rio Brazos Road, Aztec, NM 87410
District IV
1220 S. St Francis Dr., Santa Fe, NM 87505

RECEIVED
DEC 17 2009
HOBBSOCD

State of New Mexico
Energy Minerals and Natural Resources
Oil Conservation Division
1220 South St. Francis Dr.
Santa Fe, NM 87505

Form C-101
June 16, 2008

Submit to appropriate District Office

AMENDED REPORT

APPLICATION FOR PERMIT TO DRILL, RE-ENTER, DEEPEN, PLUGBACK, OR ADD A ZONE

¹ Operator Name and Address MANZANO, LLC - P.O. BOX 2107 - ROSWELL, NM 88202		² OGRID Number 231429
³ Property Code 37901		⁴ API Number 30-025-39630
⁵ Property Name LOBO 31 STATE		⁶ Well No 1H
⁹ Proposed Pool 1 Bagley Perme Penn, North		¹⁰ Proposed Pool 2

⁷ Surface Location

UL or lot no	Section	Township	Range	Lot Idn	Feet from the	North/South line	Feet from the	East/West line	County
A	31	10-S	33-E		400	NORTH	200	EAST	LEA

⁸ Proposed Bottom Hole Location If Different From Surface

UL or lot no	Section	Township	Range	Lot Idn	Feet from the	North/South line	Feet from the	East/West line	County
D	31	10-S	33-E		400	NORTH	330	WEST	LEA

Additional Well Information

¹¹ Work Type Code N	¹² Well Type Code O	¹³ Cable/Rotary R	¹⁴ Lease Type Code S	¹⁵ Ground Level Elevation 4220'
¹⁶ Multiple N	¹⁷ Proposed Depth 8570' TVD 13000' MD	¹⁸ Formation WOLFCAMP	¹⁹ Contractor	²⁰ Spud Date 01/15/2010

²¹ Proposed Casing and Cement Program

Hole Size	Casing Size	Casing weight/foot	Setting Depth	Sacks of Cement	Estimated TOC
17.5"	13..3.75"	54.5#	400'	500	SURFACE
12.25"	9.625"	40#	3750'	1500	SURFACE
8.75"	7"	26#	8300'	1000	SURFACE
6.125"	4.5"	11.6#	13000'	N/A	N/A

²² Describe the proposed program. If this application is to DEEPEN or PLUG BACK, give the data on the present productive zone and proposed new productive zone Describe the blowout prevention program, if any Use additional sheets if necessary

Drill 17.5" hole to 400', run 13.375" 54.5#/ft casing to TD and cement with sufficient amount to circulate cement to surface. WOC 12 hrs prior to drilling on shoe. NU 3000# BOPE & test to 500 psi w/rig pumps. Drill 12.25" hole to 3750', run 9.625" 40#/ft casing to TD and cement with sufficient volume to circulate cement to surface. WOC 12 hrs prior to drilling on shoe. NU 3000# BOPE and test to 1000psi w/rig pumps. Drill 8.75" hole to 8300', set 7" 26#/ft casing to TD and cement with sufficient volume to circulate cement to surface. Pick up directional tools, drill curve at 10-15 degrees per 100' to end of curve at 8570' TVD in Wolfcamp. Plan is to penetrate Wolfcamp pay @ location 400' FNL & 500' FEL of S31 T10S R33E. Drill 6.125" lateral to MD of 13000'. Run Peak multi-stage packer system on 4.5" 11.6#/ft casing.

²³ I hereby certify that the information given above is true and complete to the best of my knowledge and belief.

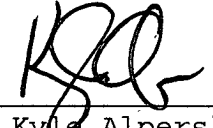
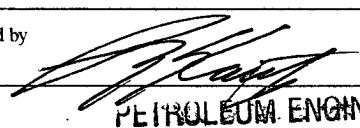
Signature: 	OIL CONSERVATION DIVISION	
Printed name: Kyle Alpers	Approved by: 	Title: PETROLEUM ENGINEER
Title: Engineer	Approval Date: JAN 06 2010	Expiration Date:
E-mail Address: ksalpers@qwestoffice.net		
Date: 12-16-09	Phone: 575-623-1996	Conditions of Approval Attached <input type="checkbox"/>

**Permit Expires 2 Years From Approval
Date Unless Drilling Underway**

DISTRICT I
1625 N. FRENCH DR., HOBBBS, NM 88240

DISTRICT II
1391 W. GRAND AVENUE, ARTESIA, NM 88210

DISTRICT III
1000 Rio Brazos Rd., Aztec, NM 87410

DISTRICT IV
1220 S. ST. FRANCIS DR., SANTA FE, NM 87505

RECEIVED

DEC 17 2009
HOBBSOCD

State of New Mexico
Energy, Minerals and Natural Resources Department

OIL CONSERVATION DIVISION
1220 SOUTH ST. FRANCIS DR.
Santa Fe, New Mexico 87505

Form C-102
Revised October 12, 2005
Submit to Appropriate District Office
State Lease - 4 Copies
Fee Lease - 3 Copies

WELL LOCATION AND ACREAGE DEDICATION PLAT

AMENDED REPORT

API Number 30-025-39630	Pool Code 3820	Pool Name Bagley Permo Penn North
Property Code 37961	Property Name LOBO STATE	Well Number 1H
OGRID No. 231429	Operator Name MANZANO, LLC	Elevation 4220'

Surface Location

UL or lot No.	Section	Township	Range	Lot Idn	Feet from the	North/South line	Feet from the	East/West line	County
A	31	10-S	33-E		400	NORTH	200	EAST	LEA

Bottom Hole Location If Different From Surface

UL or lot No.	Section	Township	Range	Lot Idn	Feet from the	North/South line	Feet from the	East/West line	County
D	31	10-S	33-E		400	NORTH	330	WEST	LEA

Dedicated Acres 160	Joint or Infill	Consolidation Code	Order No.
------------------------	-----------------	--------------------	-----------

NO ALLOWABLE WILL BE ASSIGNED TO THIS COMPLETION UNTIL ALL INTERESTS HAVE BEEN CONSOLIDATED OR A NON-STANDARD UNIT HAS BEEN APPROVED BY THE DIVISION

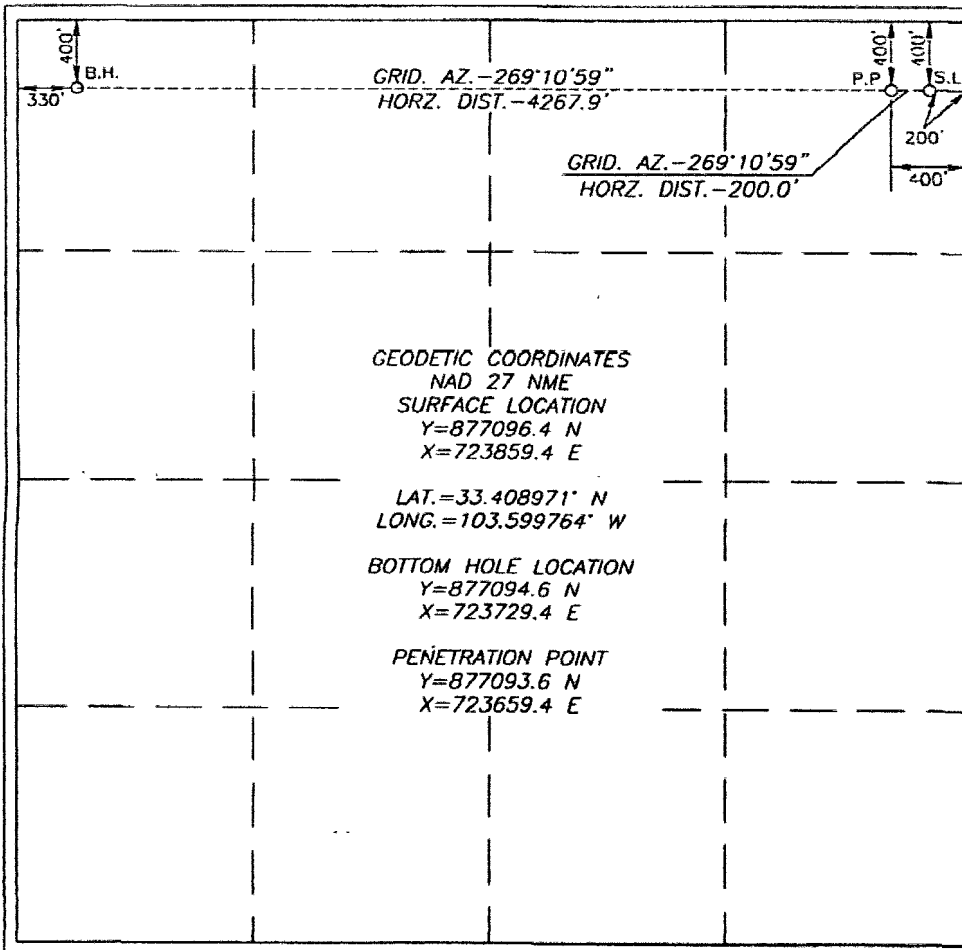

GEODETIC COORDINATES
NAD 27 NME
SURFACE LOCATION
Y=877096.4 N
X=723859.4 E

LAT.=33.408971° N
LONG.=103.599764° W

BOTTOM HOLE LOCATION
Y=877094.6 N
X=723729.4 E

PENETRATION POINT
Y=877093.6 N
X=723659.4 E

OPERATOR CERTIFICATION

I hereby certify that the information herein is true and complete to the best of my knowledge and belief, and that this organization either owns a working interest or unleased mineral interest in the land including the proposed bottom hole location or has a right to drill this well at this location pursuant to a contract with an owner of such mineral or working interest, or to a voluntary pooling agreement or a compulsory pooling order heretofore entered by the Division.

Kyle Alpers 12/16/09
Signature Date
Printed Name

SURVEYOR CERTIFICATION

I hereby certify that the well location shown on this plat was plotted from field notes of actual surveys made by me or under my supervision, and that the same is true and correct to the best of my belief.

RONALD J. EIDSON
DECEMBER 15 2009
Date Surveyed LA BEV:12/15/09
Signature & Seal 3239
Professional Surveyor
Ronald J. Eidson 12-15-09
09:11:116

Certificate No. RONALD EIDSON 3239