

DISTRICT I  
1625 N. French Dr., Hobbs, NM 88240

DISTRICT II  
1801 W. Grand Avenue, Artesia, NM 88210

DISTRICT III  
1000 Rio Brazos Rd., Aztec, NM 87410

DISTRICT IV  
1220 S. St. Francis Dr., Santa Fe, NM 87505

RECEIVED

JAN 11 2010

HOBBSON

State of New Mexico  
Energy, Minerals and Natural Resources Department

Form C-102  
Revised October 15, 2009

Submit one copy to appropriate  
District Office

**CONSERVATION DIVISION**  
1220 South St. Francis Dr.  
Santa Fe, New Mexico 87505

**WELL LOCATION AND ACREAGE DEDICATION PLAT**

☐ AMENDED REPORT

API Number	Pool Code 97722	Pool Name Wildcat Abo Wolfcamp
Property Code	Property Name TICONDEROGA "16" STATE COM	Well Number 2
GRID No. 162683	Operator Name CIMAREX ENERGY CO. OF COLORADO	Elevation 4414'

**Surface Location**

UL or lot No.	Section	Township	Range	Lot Idn	Feet from the	North/South line	Feet from the	East/West line	County
A	16	15 S	31 E		375	NORTH	330	EAST	CHAVES

**Bottom Hole Location If Different From Surface**

UL or lot No.	Section	Township	Range	Lot Idn	Feet from the	North/South line	Feet from the	East/West line	County
D	16	15 S	31 E		375	NORTH	330	WEST	CHAVES

Dedicated Acres 160	Joint or Infill	Consolidation Code P	Order No.
------------------------	-----------------	-------------------------	-----------

NO ALLOWABLE WILL BE ASSIGNED TO THIS COMPLETION UNTIL ALL INTERESTS HAVE BEEN CONSOLIDATED  
OR A NON-STANDARD UNIT HAS BEEN APPROVED BY THE DIVISION

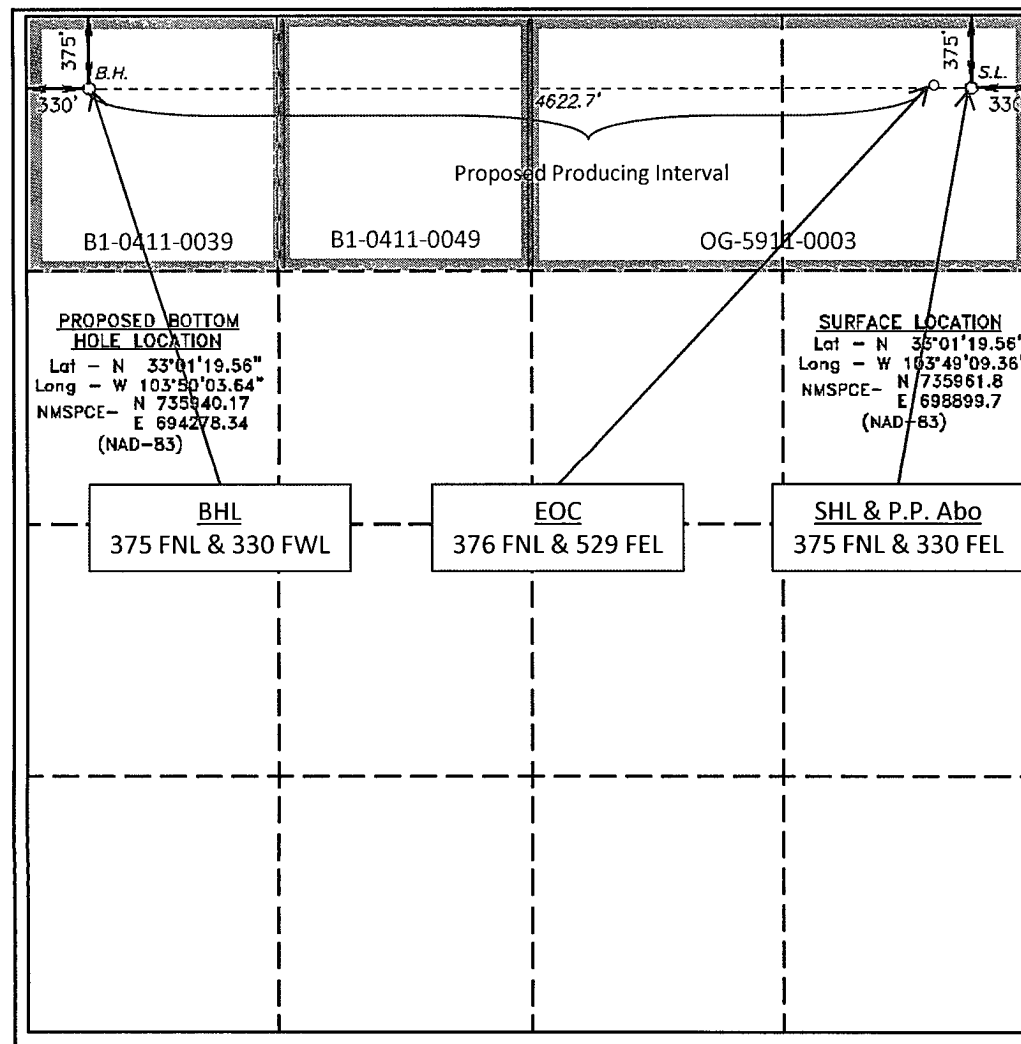

**OPERATOR CERTIFICATION**

I hereby certify that the information contained herein is true and complete to the best of my knowledge and belief, and that this organization either owns a working interest or unleased mineral interest in the land including the proposed bottom hole location or has a right to drill this well at this location pursuant to a contract with an owner of such a mineral or working interest, or to a voluntary pooling agreement or a compulsory pooling order heretofore entered by the division.

Zeno Farris 1/8/2010  
Signature Date

Zeno Farris

Printed Name

**SURVEYOR CERTIFICATION**

I hereby certify that the well location shown on this plat was plotted from field notes of actual surveys made by me or under my supervision and that the same is true and correct to the best of my belief.

NOVEMBER 18 2009

Date Surveyed  
Signature & Seal of  
Professional Surveyor

Certificate No. Gary L. Jones 7977

**Basin Surveys**