

APPLICATION FOR PERMIT TO DRILL, RE-ENTER, DEEPEN, PLUGBACK, OR ADD A ZONE

¹ Operator Name and Address		² OGRID Number
ConocoPhillips Company 3300 N. "A" St., Bldg. 6 Midland, TX 79705		217817
³ Property Code	⁵ Property Name	⁴ API Number
31172	East Vacuum GB-SA Unit, Tract 3315	30 025- 39641
⁹ Proposed Pool 1		⁶ Well No
Vacuum Grayburg-San Andres		5018
¹⁰ Proposed Pool 2		

⁷ Surface Location

UL or lot no	Section	Township	Range	Lot Idn	Feet from the	North/South line	Feet from the	East/Westline	County
O	33	17S	35E		635'	SOUTH	2555'	EAST	LEA

⁸ Proposed Bottom Hole Location If Different From Surface

UL or lot no.	Section	Township	Range	Lot Idn	Feet from the	North/South line	Feet from the	East/Westline	County

Additional Well Information

¹¹ Work Type Code	¹² Well Type Code	¹³ Cable/Rotary	¹⁴ Lease Type Code	¹⁵ Ground Level Elevation
N	O	R	S	3941'
¹⁶ Multiple	¹⁷ Proposed Depth	¹⁸ Formation	¹⁹ Contractor	²⁰ Spud Date
	4900'	GB-SA	Precision #194	05/06/2010
Depth to Groundwater		Distance from nearest fresh water well		Distance from nearest surface water
Pit: Liner Synthetic <input type="checkbox"/> milst thick Clay <input type="checkbox"/>		Pit Volume: _____ bbls		Drilling Method:
Closed-Loop System <input type="checkbox"/>		Fresh Water <input type="checkbox"/> Brine <input type="checkbox"/> Diesel/Oil-based <input type="checkbox"/> Gas/Air <input type="checkbox"/>		

²¹ Proposed Casing and Cement Program

Hole Size	Casing Size	Casing weight/foot	Setting Depth	Sacks of Cement	Estimated TOC
12.25"	8.625"	24#	1560'	650	Surface
7.875"	5.5"	17#	4890'	700	Surface

²² Describe the proposed program. If this application is to DEEPEN or PLUG BACK, give the data on the present productive zone and proposed new productive zone Describe the blowout prevention program, if any. Use additional sheets if necessary.

See attached drilling program for Drilling Mud and BOP program

**Permit Expires 2 Years From Approval
Date Unless Drilling Underway**

²³ I hereby certify that the information given above is true and complete to the best of my knowledge and belief. I further certify that the drilling pit will be constructed according to NMOCD guidelines <input type="checkbox"/> , a general permit <input type="checkbox"/> , or an (attached) alternative OCD-approved plan <input type="checkbox"/> .		OIL CONSERVATION DIVISION	
Printed name: Jalyn N. Fiske		Approved by:	
Title: Regulatory Specialist		Title: PETROLEUM ENGINEER	
E-mail Address: Jalyn.Fiske@conocophillips.com		Approval Date: JAN 21 2010 Expiration Date:	
Date: 12/31/09	Phone: (432)688-6813	Conditions of Approval Attached <input type="checkbox"/>	

DISTRICT II 
P.O. Drawer DD, Artesia, NM 88211-0719

DISTRICT III
1000 Rio Brazos Rd., Aztec, NM 87410 JAN 11 2010

DISTRICT IV HC
2040 South Pacheco, Santa Fe, NM 87505

0719 RECEIVED

10 JAN 11 2010

HOBBSOC

OIL CONSERVATION DIVISION
2040 South Pacheco
Santa Fe, NM 87505

☐ AMENDED REPORT

WELL LOCATION AND ACREAGE DEDICATION PLAT

API Number 30-025-39641	Pool Code 62180 ✓	Pool Name VACUUM, GRAYBURG-SAN ANDRES ✓
Property Code 31172 ✓	Property Name EAST VACUUM GBSA UNIT	Well Number 3315 -5012
OGRID No. 21817 217817	Operator Name CONOCOPHILLIPS	Elevation 3941'

Surface Location

UL or lot No.	Section	Township	Range	Lot Idn	Feet from the	North/South line	Feet from the	East/West line	County
0	33	17-S	35-E		635	SOUTH	2555	EAST	LEA

Bottom Hole Location If Different From Surface

UL or lot No.	Section	Township	Range	Lot Idn	Feet from the	North/South line	Feet from the	East/West line	County
Dedicated Acres 410	Joint or Infill	Consolidation Code		Order No.					

NO ALLOWABLE WILL BE ASSIGNED TO THIS COMPLETION UNTIL ALL INTERESTS HAVE BEEN CONSOLIDATED OR A NON-STANDARD UNIT HAS BEEN APPROVED BY THE DIVISION

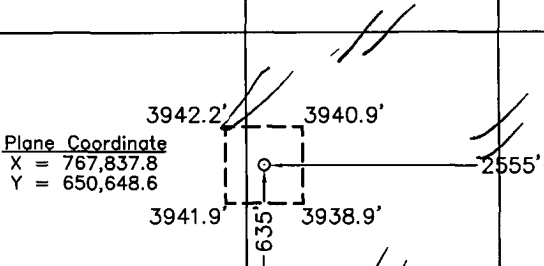
<p>NOTE:</p> <p>1) Plane Coordinates shown hereon are Transverse Mercator Grid and Conform to the "New Mexico Coordinate System", New Mexico East Zone, North American Datum of 1927. Distances shown hereon are mean horizontal surface values.</p>	 <p style="text-align: center;"> <u>Plane Coordinate</u> X = 767,837.8 Y = 650,648.6 </p> <p style="text-align: center;"> 3942.2' 3940.9' 3941.9' 3938.9' 635' 2555' </p>
--	---

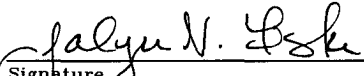
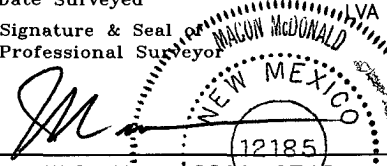
<p style="text-align: center;">OPERATOR CERTIFICATION</p> <p style="text-align: center;"><i>I hereby certify the the information contained herein is true and complete to the best of my knowledge and belief</i></p> <div style="text-align: right; margin-top: 20px;">  Signature JALYN N. FISKE Printed Name REG. SPECIALIST Title 12/31/09 Date </div>	<p style="text-align: center;">SURVEYOR CERTIFICATION</p> <p style="text-align: center;"><i>I hereby certify that the well location shown on this plat was plotted from field notes of actual surveys made by me or under my supervision and that the same is true and correct to the best of my belief</i></p> <p style="text-align: center; margin-top: 20px;">November 3, 2009</p> <p style="text-align: center;">Date Surveyed</p> <div style="text-align: center;">  Signature & Seal of Professional Surveyor </div> <p style="text-align: center; margin-top: 10px;"> W.O. Num. 2009-0746 12185 </p> <p style="text-align: center;">Certificate No. MAISON McDONALD 12185</p>
--	---

East Vac Unit 3315-501Z

15. Proposed Depth = 4,900' MD RKB

19. Proposed Casing and Cement Program						
Type	Hole Size (inches)	Casing OD (inches)	Casing Wt (lb/ft)	Setting Depth (feet)	Sacks of Cement	Estimated TOC (feet)
Surface	12.25	8.625	24	1560	650	0
Prod	7.875	5.5	17	4890	700	0

Casing and Cement Program: Additional Comments
Fresh Water and Fresh Water Mud will be used for drilling the surface hole.
Brine and Brine Based Mud will be used for drilling the production hole.

Proposed Blowout Prevention Program			
Type	Working Pressure	Test Pressure	Manufacturer
Annular	2000	1000	
Blind Ram	2000	2000	
Pipe Ram	2000	2000	

SECTION 33, TOWNSHIP 17 SOUTH, RANGE 35 EAST, N.M.P.M.

LEA COUNTY

NEW MEXICO

L-2009-0746-A

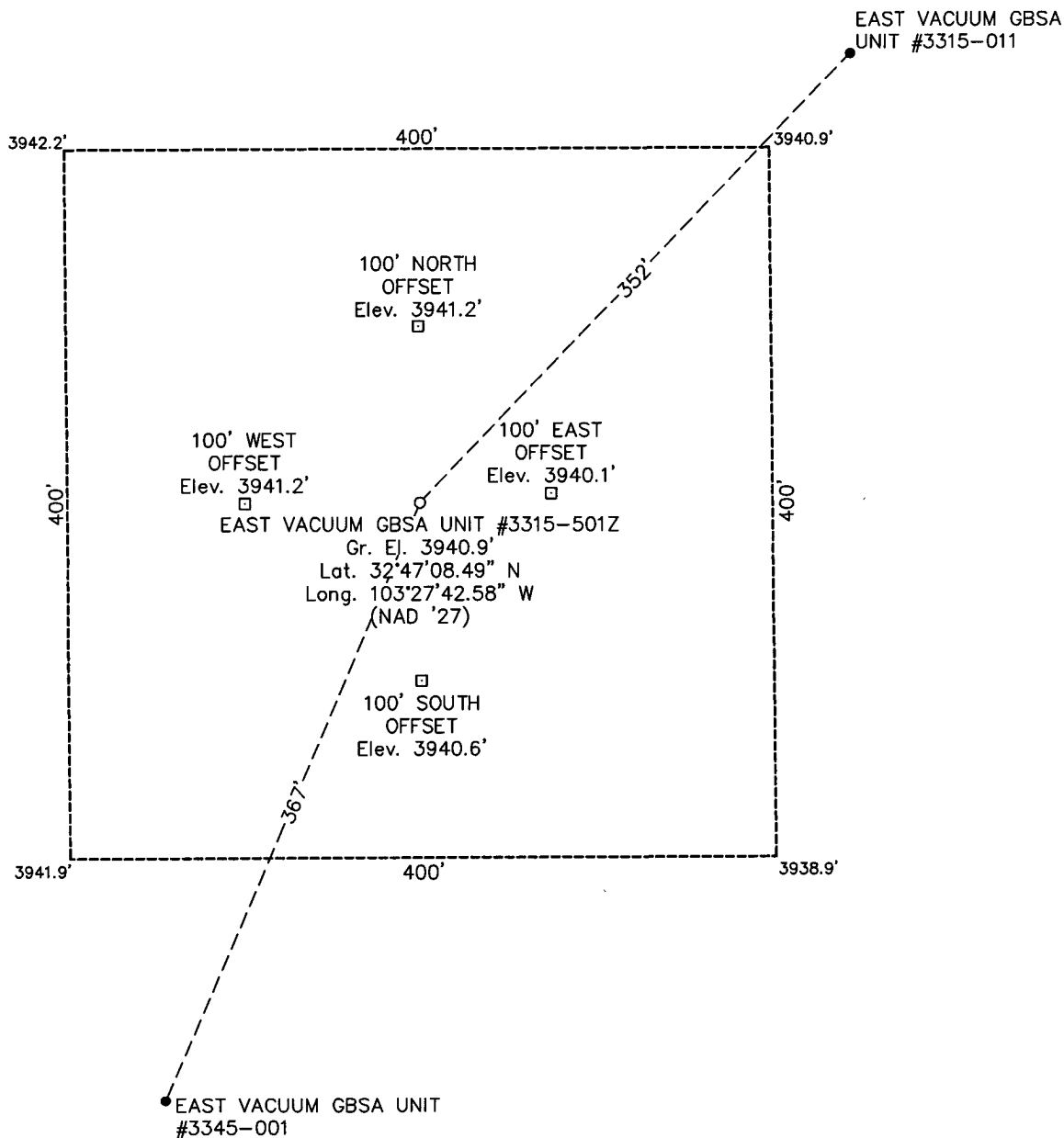

DRIVING DIRECTIONS

FROM THE INTERSECTION OF STATE HIGHWAY 8 AND COUNTY ROAD 50 IN BUCKEYE, NEW MEXICO GO EAST ON SAID COUNTY ROAD 50 1.2 MILES TO A LEASE ROAD ON SOUTH (RIGHT) SIDE OF ROAD, THEN GO SOUTH 0.4 MILE THEN TURN SOUTHEAST (LEFT) FOR 1.0 MILE TO ANOTHER LEASE ROAD ON EAST (LEFT) SIDE OF ROAD, THEN GO EAST 0.5 MILE, THEN GO NORTH (LEFT) 0.2 MILE THEN GO EAST (RIGHT) 0.2 MILE TO A POINT BEING APPROXIMATELY 150 FEET NORTH OF THE PROPOSED LOCATION.

CONOCOPHILLIPS

EAST VACUUM GBSA UNIT #3315-501Z

Located 635' FSL & 2555' FEL, Section 33
Township 17 South, Range 35 East, N.M.P.M.
Lea County, New Mexico

Drawn By: LVA	Date: November 11, 2009
Scale: 1" = 100'	Field Book: 376 / 48-55
Revision Date:	Quadrangle: Lovington SW
W.O. No: 2009-0746	Dwg. No.: L-2009-0746-A



110 W. LOUISIANA, STE. 110
MIDLAND TEXAS, 79701
(432) 687-0865 - (432) 687-0868 FAX

LOCATION VERIFICATION MAP

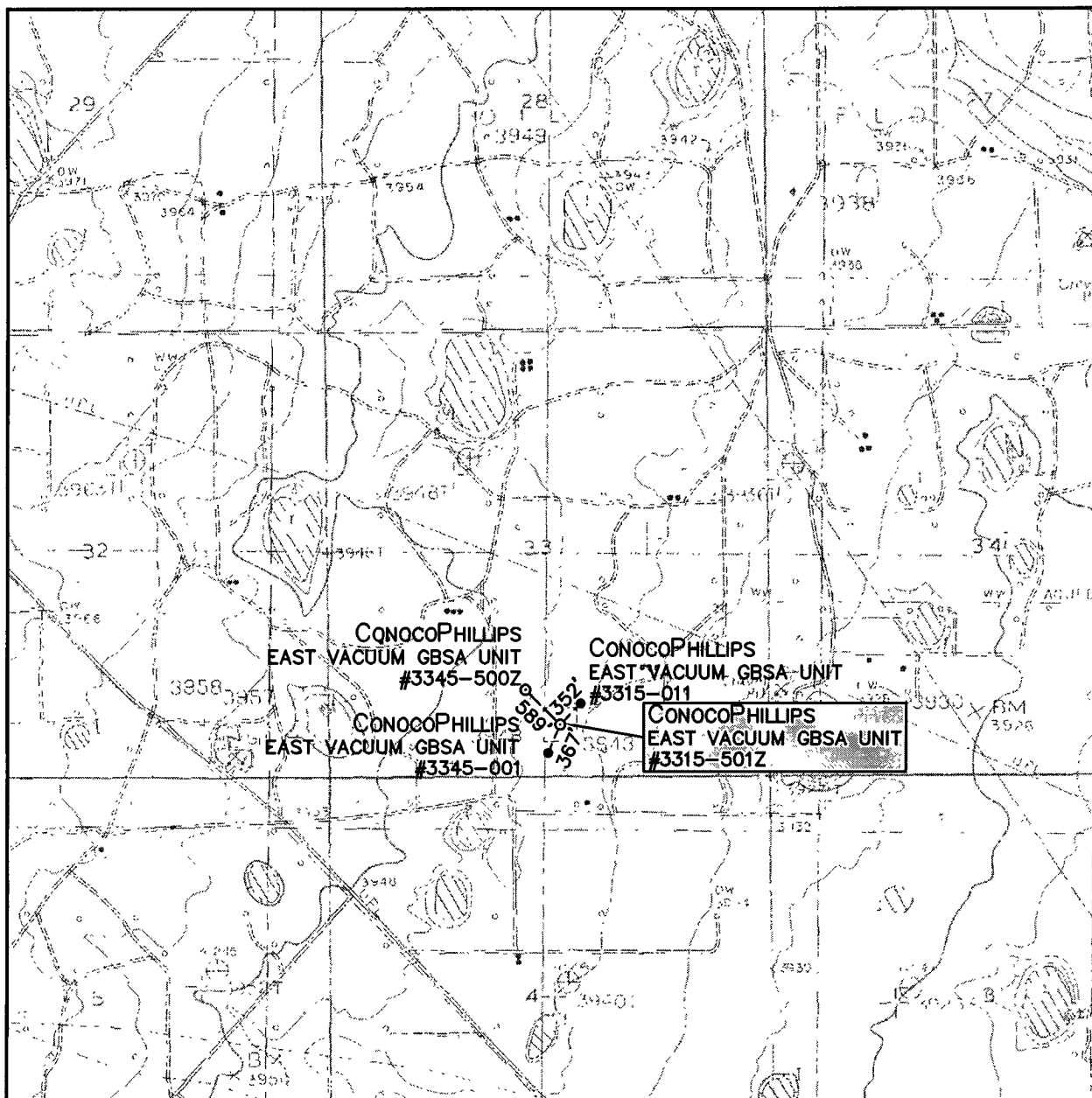

SCALE: 1" = 2000'

CONTOUR INTERVAL:
LOVINGTON SW - 5'

SEC. 33 TWP. 17-S RGE. 35-E

SURVEY _____ N.M.P.M.

COUNTY _____ LEA

DESCRIPTION 635' FSL & 2555' FEL

ELEVATION 3941'

OPERATOR CONOCOPHILLIPS

LEASE EAST VACUUM GBSA UNIT

U.S.G.S. TOPOGRAPHIC MAP
LOVINGTON SW, N.M.



110 W. LOUISIANA, STE. 110
MIDLAND TEXAS, 79701
(432) 687-0865 - (432) 687-0868 FAX

VICINITY MAP

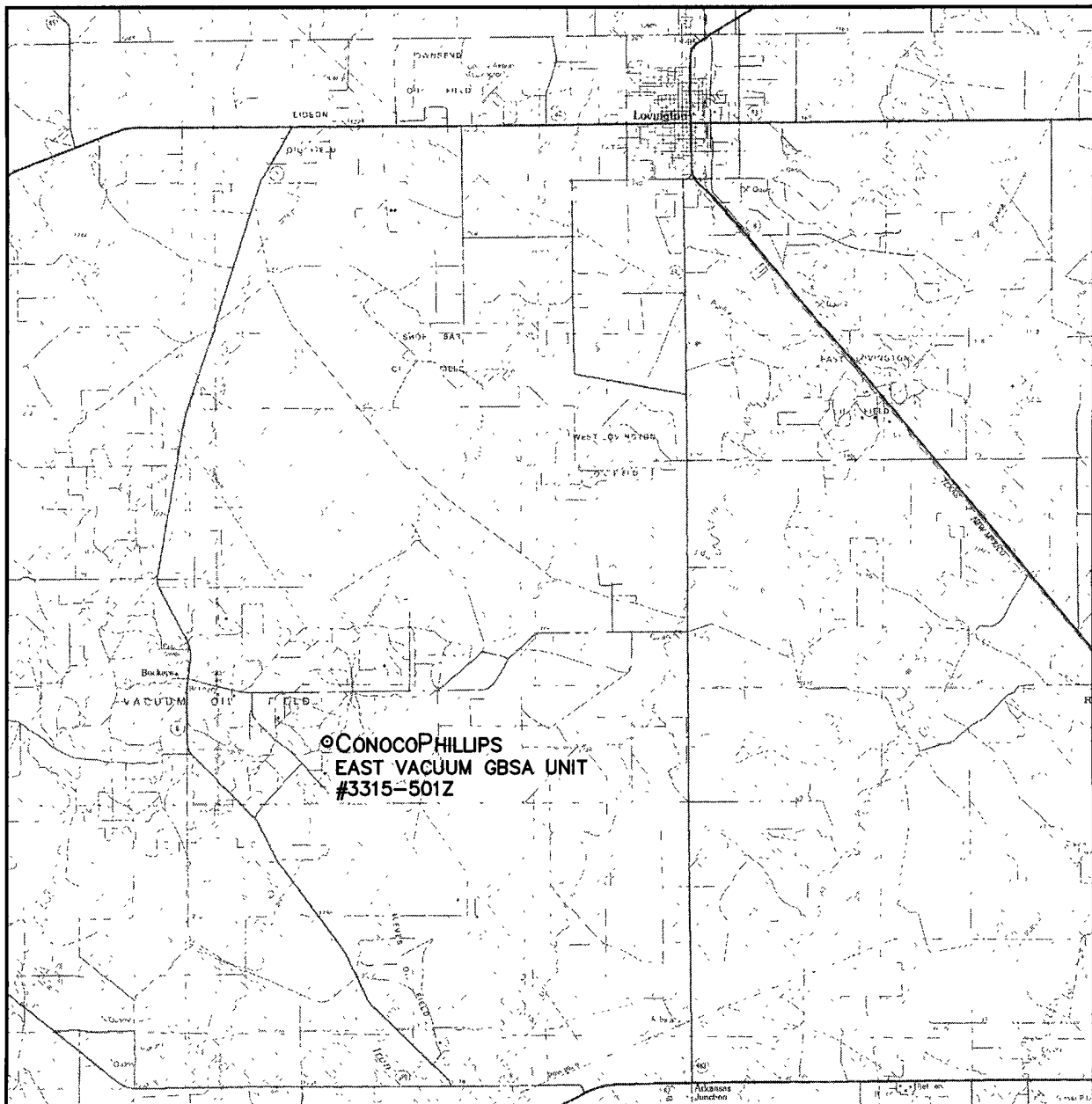

SCALE: 1" = 3 MILES

SEC. 33 TWP. 17-S RGE. 35-E

SURVEY N.M.P.M.

COUNTY LEA

DESCRIPTION 635' FSL & 2555' FEL

ELEVATION 3941'

OPERATOR CONOCOPhillips

LEASE EAST VACUUM GBSA UNIT



110 W. LOUISIANA, STE. 110
MIDLAND TEXAS, 79701
(432) 687-0865 - (432) 687-0868 FAX