

District I
1625 N. French Dr., Hobbs, NM 88240

District II
1301 W. Grand Avenue, Artesia, NM 88211

District III
1000 Rio Brazos Road, Aztec, NM 87410

District IV
1220 S. St. Francis Dr., Santa Fe, NM 87505

State of New Mexico
Energy Minerals and Natural Resources

Form C-101
May 27, 2004

Oil Conservation Division
1220 South St. Francis Dr.
Santa Fe, NM 87505

Submit to appropriate District Office

☐ AMENDED REPORT

APPLICATION FOR PERMIT TO DRILL, RE-ENTER, DEEPEN, PLUGBACK, OR ADD A ZONE

¹ Operator Name and Address ConocoPhillips Company 3300 N. "A" St., Bldg. 6 Midland, TX 79705		² OGRID Number 217817
³ Property Code 31172	⁵ Property Name East Vacuum GB-SA Unit, Tract 3333W	⁴ API Number 30-025-39642
⁹ Proposed Pool 1 Vacuum Grayburg; San Andres		⁶ Well No. 5007 504
		¹⁰ Proposed Pool 2 Per JL

⁷ Surface Location									
UL or lot no F	Section 33	Township 17S	Range 35E	Lot Idn	Feet from the 2218'	North/South line NORTH	Feet from the 1580'	East/Westline WEST	County LEA

⁸ Proposed Bottom Hole Location If Different From Surface									
UL or lot no	Section	Township	Range	Lot Idn	Feet from the	North/South line	Feet from the	East/Westline	County

⁹ Additional Well Information				
¹¹ Work Type Code N	¹² Well Type Code I	¹³ Cable/Rotary R	¹⁴ Lease Type Code S	¹⁵ Ground Level Elevation 3947'
¹⁶ Multiple	¹⁷ Proposed Depth 4900'	¹⁸ Formation GB-SA	¹⁹ Contractor Precision #194	²⁰ Spud Date 04/12/2010
Depth to Groundwater		Distance from nearest fresh water well		Distance from nearest surface water
Pit: Liner: Synthetic <input type="checkbox"/> milstuck Clay <input type="checkbox"/> Pit Volume: _____ bbls Drilling Method: _____				
Closed-Loop System <input type="checkbox"/> Fresh Water <input type="checkbox"/> Brine <input type="checkbox"/> Diesel/Oil-based <input type="checkbox"/> Gas/Air <input type="checkbox"/>				

²¹ Proposed Casing and Cement Program					
Hole Size	Casing Size	Casing weight/foot	Setting Depth	Sacks of Cement	Estimated TOC
12.25"	8.625"	24#	1560'	650	Surface
7.875"	5.5"	17#	4890'	700	Surface

²² Describe the proposed program. If this application is to DEEPEN or PLUG BACK, give the data on the present productive zone and proposed new productive zone. Describe the blowout prevention program, if any. Use additional sheets if necessary.

See attached drilling program for Drilling Mud and BOP program

**Permit Expires 2 Years From Approval
Date Unless Drilling Underway**

²³ I hereby certify that the information given above is true and complete to the best of my knowledge and belief. I further certify that the drilling pit will be constructed according to NMOCD guidelines <input type="checkbox"/> , a general permit <input type="checkbox"/> , or an (attached) alternative OCD-approved plan <input type="checkbox"/> .		OIL CONSERVATION DIVISION	
Printed name. Jalyn N. Fiske		Approved by:	
Title. Regulatory Specialist		Title. PETROLEUM ENGINEER	
E-mail Address. Jalyn.Fiske@conocophillips.com		Approval Date: JAN 21 2010 Expiration Date.	
Date 12/31/09	Phone: (432)688-6813	OCD Condition of Approval: Approval for evaluating well bore for injection. Need injection application approval from OCD Santa Fe office. CANNOT inject until OCD Santa Fe approves injection order.	

DISTRICT I
1625 N. French Dr., Hobbs, NM 88240

DISTRICT II
P.O. Drawer DD, Artesia, NM 88211-0719

DISTRICT III
1000 Rio Brazos Rd., Aztec, NM 87410

DISTRICT IV
2040 South Pacheco, Santa Fe, NM 87505

RECEIVED

JAN 11 2010

HOBBSON

State of New Mexico

Energy Minerals & Natural Resources Department

Form C-102

Revised August 15, 2000

Submit to Appropriate District Office

State Lease - 4 Copies

Fee Lease - 3 Copies

OIL CONSERVATION DIVISION
2040 South Pacheco
Santa Fe, NM 87505

☐ AMENDED REPORT

WELL LOCATION AND ACREAGE DEDICATION PLAT

API Number 30-025-39642	Pool Code 62180	Pool Name VACUUM; GRAYBURG - SAN ANDRES
Property Code 31172	Property Name EAST VACUUM GBSA UNIT	Well Number 504 3333W 500Z
OGRID No. 21817	Operator Name CONOCOPHILLIPS	Elevation 3947'

Surface Location

UL or lot No.	Section	Township	Range	Lot Idn	Feet from the	North/South line	Feet from the	East/West line	County
F	33	17-S	35-E		2218	NORTH	1580	WEST	LEA

Bottom Hole Location If Different From Surface

UL or lot No.	Section	Township	Range	Lot Idn	Feet from the	North/South line	Feet from the	East/West line	County
Dedicated Acres 40	Joint or Infill	Consolidation Code	Order No.						

NO ALLOWABLE WILL BE ASSIGNED TO THIS COMPLETION UNTIL ALL INTERESTS HAVE BEEN CONSOLIDATED OR A NON-STANDARD UNIT HAS BEEN APPROVED BY THE DIVISION

	<p>OPERATOR CERTIFICATION</p> <p>I hereby certify the the information contained herein is true and complete to the best of my knowledge and belief.</p> <p><i>Jalyn N. Fiske</i> Signature JALYN N. FISKE Printed Name REG. SPECIALIST Title 12/31/09 Date</p> <p>SURVEYOR CERTIFICATION</p> <p>I hereby certify that the well location shown on this plat was plotted from field notes of actual surveys made by me or under my supervision and that the same is true and correct to the best of my belief</p> <p>November 3, 2009 Date Surveyed Signature & Seal of Professional Surveyor <i>[Signature]</i> W.O. Num. 2009-0748 Certificate No. MACON McDONALD 12185</p>
NOTE: 1) Plane Coordinates shown hereon are Transverse Mercator Grid and Conform to the "New Mexico Coordinate System", New Mexico East Zone, North American Datum of 1927. Distances shown hereon are mean horizontal surface values.	

East Vac Unit 3333W500Z

15. Proposed Depth = 4,900' MD RKB

19. Proposed Casing and Cement Program						
Type	Hole Size (inches)	Casing OD (inches)	Casing Wt (lb/ft)	Setting Depth (feet)	Sacks of Cement	Estimated TOC (feet)
Surface	12.25	8.625	24	1560	650	0
Prod	7.875	5.5	17	4890	700	0

Casing and Cement Program: Additional Comments
Fresh Water and Fresh Water Mud will be used for drilling the surface hole.
Brine and Brine Based Mud will be used for drilling the production hole.

Proposed Blowout Prevention Program			
Type	Working Pressure	Test Pressure	Manufacturer
Annular	2000	1000	
Blind Ram	2000	2000	
Pipe Ram	2000	2000	

SECTION 33, TOWNSHIP 17 SOUTH, RANGE 35 EAST, N.M.P.M.

LEA COUNTY

NEW MEXICO

L-2009-0748-A

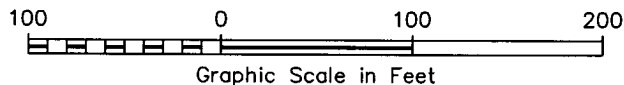
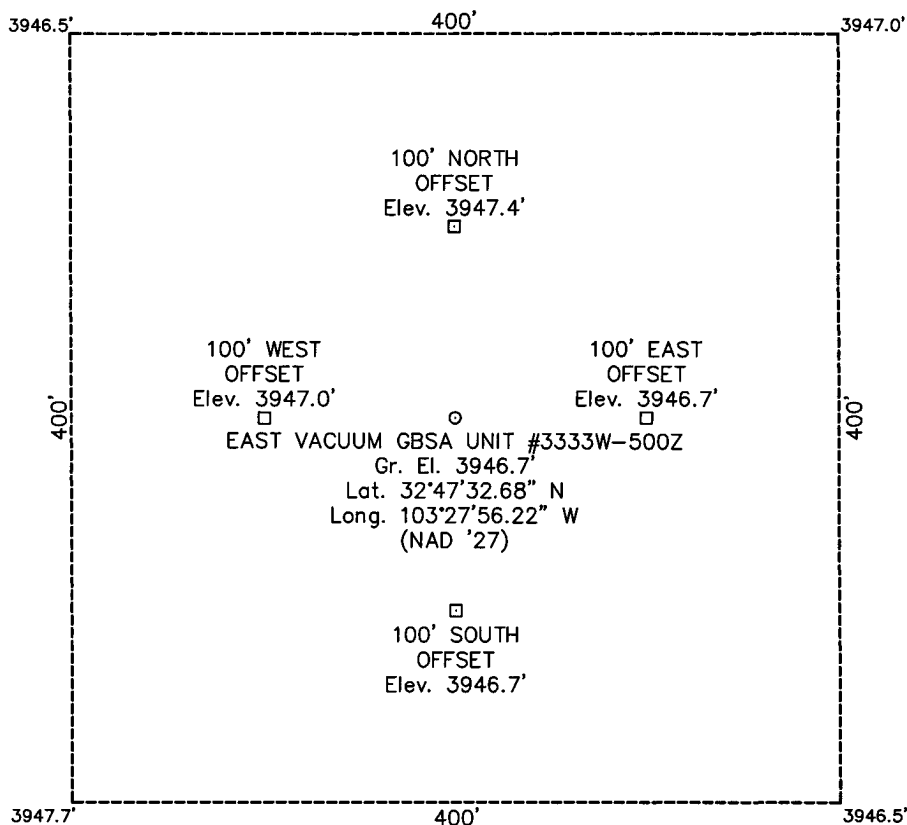
DRIVING DIRECTIONS

FROM THE INTERSECTION OF STATE HIGHWAY 8 AND COUNTY ROAD 50 IN BUCKEYE, NEW MEXICO GO EAST ON SAID COUNTY ROAD 50 1.2 MILES TO A LEASE ROAD ON SOUTH (RIGHT) SIDE OF ROAD, THEN GO SOUTH 0.4 MILE THEN TURN SOUTHEAST (LEFT) FOR 1.0 MILE TO ANOTHER LEASE ROAD ON EAST (LEFT) SIDE OF ROAD, THEN GO EAST 0.5 MILE, THE GO NORTH (LEFT) 0.7 MILE TO A POINT BEING APPROXIMATELY 300 FEET EAST OF THE PROPOSED LOCATION.

CONOCOPHILLIPS**EAST VACUUM GBSA UNIT #3333W-500Z**

Located 2218' FNL & 1580' FWL, Section 33
Township 17 South, Range 35 East, N.M.P.M.
Lea County, New Mexico



110 W. LOUISIANA, STE. 110
MIDLAND TEXAS, 79701
(432) 687-0865 - (432) 687-0868 FAX

Drawn By: LVA	Date: November 11, 2009
Scale: 1" = 100'	Field Book: 376 / 48-55
Revision Date:	Quadrangle: Lovington SW
W.O. No: 2009-0748	Dwg. No.: L-2009-0748-A

LOCATION VERIFICATION MAP

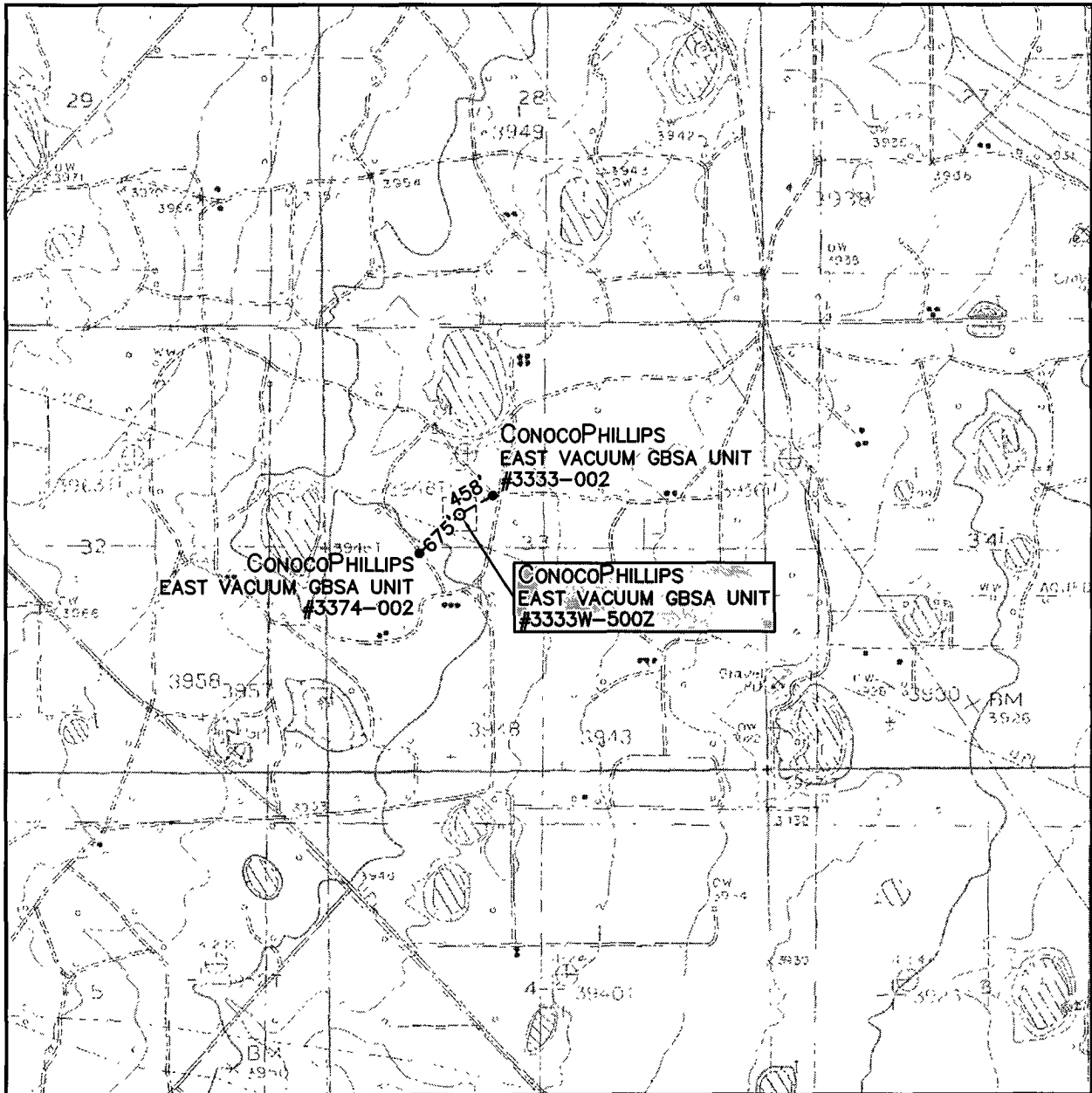

SCALE: 1" = 2000'

CONTOUR INTERVAL:
LOVINGTON SW - 5'

SEC. 33 TWP. 17-S RGE. 35-E

SURVEY N.M.P.M.

COUNTY LEA

DESCRIPTION 2218' FNL & 1580' FWL

ELEVATION 3947'

OPERATOR CONOCOPHILLIPS

LEASE EAST VACUUM GBSA UNIT

U.S.G.S. TOPOGRAPHIC MAP
LOVINGTON SW, N.M.



110 W. LOUISIANA, STE. 110
MIDLAND TEXAS, 79701
(432) 687-0865 - (432) 687-0868 FAX

VICINITY MAP

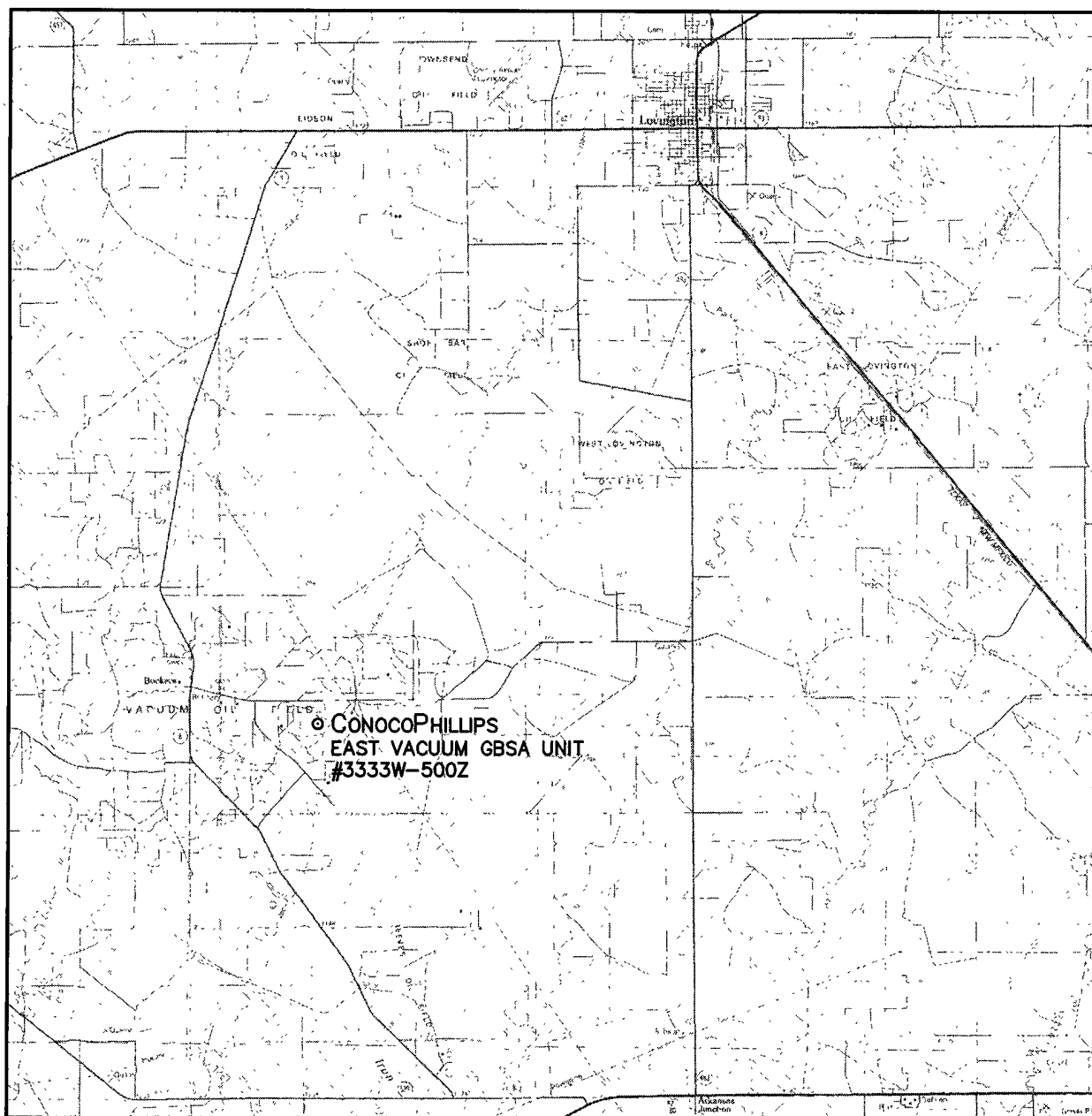

SCALE: 1" = 3 MILES

SEC. 33 TWP. 17-S RGE. 35-E

SURVEY N.M.P.M.

COUNTY LEA

DESCRIPTION 2218' FNL & 1580' FWL

ELEVATION 3947'

OPERATOR CONOCOPHILLIPS

LEASE EAST VACUUM GBSA UNIT



110 W. LOUISIANA, STE. 110
MIDLAND TEXAS, 79701
(432) 687-0865 - (432) 687-0868 FAX