

District I  
1625 N. French Dr., Hobbs, NM 88240  
District II  
1301 W. Grand Avenue, Artesia, NM 88210  
District III  
1000 Rio Brazos Road, Aztec, NM 87410  
District IV  
1220 S. St. Francis Dr., Santa Fe, NM 87505

RECEIVED

JAN 11 2010

HOBBSOCD

State of New Mexico  
Energy Minerals and Natural Resources

Form C-101  
May 27, 2004

Oil Conservation Division  
1220 South St. Francis Dr.  
Santa Fe, NM 87505

Submit to appropriate District Office

☐ AMENDED REPORT

APPLICATION FOR PERMIT TO DRILL, RE-ENTER, DEEPEN, PLUGBACK, OR ADD A ZONE

<sup>1</sup> Operator Name and Address ConocoPhillips Company 3300 N. "A" St., Bldg. 6 Midland, TX 79705		<sup>2</sup> OGRID Number 217817
<sup>3</sup> Property Code 31172	<sup>5</sup> Property Name East Vacuum GB-SA, Tract 3345W	<sup>4</sup> API Number 30 025- 39643
<sup>9</sup> Proposed Pool 1 Vacuum Grayburg, San Andres		<sup>6</sup> Well No. 5002-505 Per JK

<sup>7</sup> Surface Location

UL or lot no N	Section 33	Township 17S	Range 35E	Lot Idn	Feet from the 1050'	North/South line SOUTH	Feet from the 2325'	East/Westline WEST	County LEA
-------------------	---------------	-----------------	--------------	---------	------------------------	---------------------------	------------------------	-----------------------	---------------

<sup>8</sup> Proposed Bottom Hole Location If Different From Surface

UL or lot no	Section	Township	Range	Lot Idn	Feet from the	North/South line	Feet from the	East/Westline	County
--------------	---------	----------	-------	---------	---------------	------------------	---------------	---------------	--------

Per JK

Additional Well Information

<sup>11</sup> Work Type Code N	<sup>12</sup> Well Type Code I	<sup>13</sup> Cable/Rotary R	<sup>14</sup> Lease Type Code S	<sup>15</sup> Ground Level Elevation 3944'
<sup>16</sup> Multiple	<sup>17</sup> Proposed Depth 4900'	<sup>18</sup> Formation GB-SA	<sup>19</sup> Contractor Precision #194	<sup>20</sup> Spud Date 05/20/2010
Depth to Groundwater		Distance from nearest fresh water well		Distance from nearest surface water
Pit. Liner Synthetic <input type="checkbox"/> milsthick Clay <input type="checkbox"/> Pit Volume _____ bbls Drilling Method: _____ Closed-Loop System <input type="checkbox"/> Fresh Water <input type="checkbox"/> Brine <input type="checkbox"/> Diesel/Oil-based <input type="checkbox"/> Gas/Air <input type="checkbox"/>				

<sup>21</sup> Proposed Casing and Cement Program

Hole Size	Casing Size	Casing weight/foot	Setting Depth	Sacks of Cement	Estimated TOC
12.25"	8.625"	24#	1560'	650	Surface
8.5"	5.5"	17#	4890'	825	Surface

<sup>22</sup> Describe the proposed program. If this application is to DEEPEN or PLUG BACK, give the data on the present productive zone and proposed new productive zone. Describe the blowout prevention program, if any. Use additional sheets if necessary. See attached drilling program for Drilling Mud and BOP program

Permit Expires 2 Years From Approval  
Date Unless Drilling Underway

<sup>23</sup> I hereby certify that the information given above is true and complete to the best of my knowledge and belief. I further certify that the drilling pit will be constructed according to NMOCD guidelines ☐, a general permit ☐, or an (attached) alternative OCD-approved plan ☐.

Printed name: Jaly N. Fiske  
Title: Regulatory Specialist

E-mail Address: JalyN.Fiske@conocophillips.com

Date: 12/31/09 Phone: (432)688-6813

OIL CONSERVATION DIVISION

Approved by:

Title: PETROLEUM ENGINEER

Approval Date: JAN 21 2010 Expiration Date

OCD Condition of Approval: Approval for evaluating well bore for injection. Need injection application approval from OCD Santa Fe office. CANNOT inject until OCD Santa Fe approves injection order.

**DISTRICT II**  
P.O. Drawer DD, Artesia, NM 88211-0719

RECEIVED

**DISTRICT III**  
1000 Rio Brazos Rd., Aztec, NM 87410

JAN 11 2010

OIL CONSERVATION DIVISION

DISTRICT IV  
2040 South Pacheco, Santa Fe, NM 87505

HOBBSOC

2040 South Pacheco

Santa Fe, NM 87505

☐ AMENDED REPORT

# WELL LOCATION AND ACREAGE DEDICATION PLAT

API Number 30-025-39643	Pool Code 62180	Pool Name VACCU; GRAYBURG-SAN ANDRES
Property Code 21172	Property Name EAST VACUUM GBSA UNIT	Well Number <del>3345W-500Z</del> 505
OGRID No. <del>21177</del> 217817	Operator Name CONOCOPHILLIPS	Elevation 3944'

### Surface Location

UL or lot No.	Section	Township	Range	Lot Idn	Feet from the	North/South line	Feet from the	East/West line	County
N	33	17-S	35-E		1050	SOUTH	2325	WEST	LEA

## Bottom Hole Location If Different From Surface

UL or lot No.	Section	Township	Range	Lot Idn	Feet from the	North/South line	Feet from the	East/West line	County
Dedicated Acres 40	Joint or Infill	Consolidation Code		Order No.					

NO ALLOWABLE WILL BE ASSIGNED TO THIS COMPLETION UNTIL ALL INTERESTS HAVE BEEN CONSOLIDATED OR A NON-STANDARD UNIT HAS BEEN APPROVED BY THE DIVISION

<p>NOTE:</p> <p>1) Plane Coordinates shown hereon are Transverse Mercator Grid and Conform to the "New Mexico Coordinate System", New Mexico East Zone, North American Datum of 1927. Distances shown hereon are mean horizontal surface values.</p>	
<p>2325'</p>	<p>Diagram showing a well location with the following data:</p> <ul style="list-style-type: none"><li>Plane Coordinate:<ul style="list-style-type: none"><li>X = 767,418.4</li><li>Y = 651,062.5</li></ul></li><li>Distances:<ul style="list-style-type: none"><li>3945.9'</li><li>3944.4'</li><li>3945.6'</li><li>3942.5'</li><li>1050'</li></ul></li></ul>

OPERATOR CERTIFICATION

I hereby certify the the information contained herein is true and complete to the best of my knowledge and belief.

Jalyn N. Fiske  
Signature

JALYN N. FISKE  
Printed Name

REG. SPECIALIST  
Title

12/31/09  
Date

SURVEYOR CERTIFICATION

I hereby certify that the well location shown on this plat was plotted from field notes of actual surveys made by me or under my upervison and that the same is true and orrect to the best of my belief.

November 2, 2009

Date Surveyed

Signature & Seal of Professional Surveyor

W.O. Num 2009-0749

Certificate No. MACON McDONALD 12185

East Vac Unit 3345W500Z
-------------------------

15. Proposed Depth = 4,900' MD RKB
------------------------------------

19. Proposed Casing and Cement Program						
Type	Hole Size (inches)	Casing OD (inches)	Casing Wt (lb/ft)	Setting Depth (feet)	Sacks of Cement	Estimated TOC (feet)
Surface	12.25	8.625	24	1560	650	0
Prod	8.5	5.5	17	4890	825	0

Casing and Cement Program: Additional Comments	
Fresh Water and Fresh Water Mud will be used for drilling the surface hole.	
Brine and Brine Based Mud will be used for drilling the production hole.	

Proposed Blowout Prevention Program			
Type	Working Pressure	Test Pressure	Manufacturer
Annular	2000	1000	
Blind Ram	2000	2000	
Pipe Ram	2000	2000	

## SECTION 33, TOWNSHIP 17 SOUTH, RANGE 35 EAST, N.M.P.M.

LEA COUNTY

NEW MEXICO

L-2009-0749-A

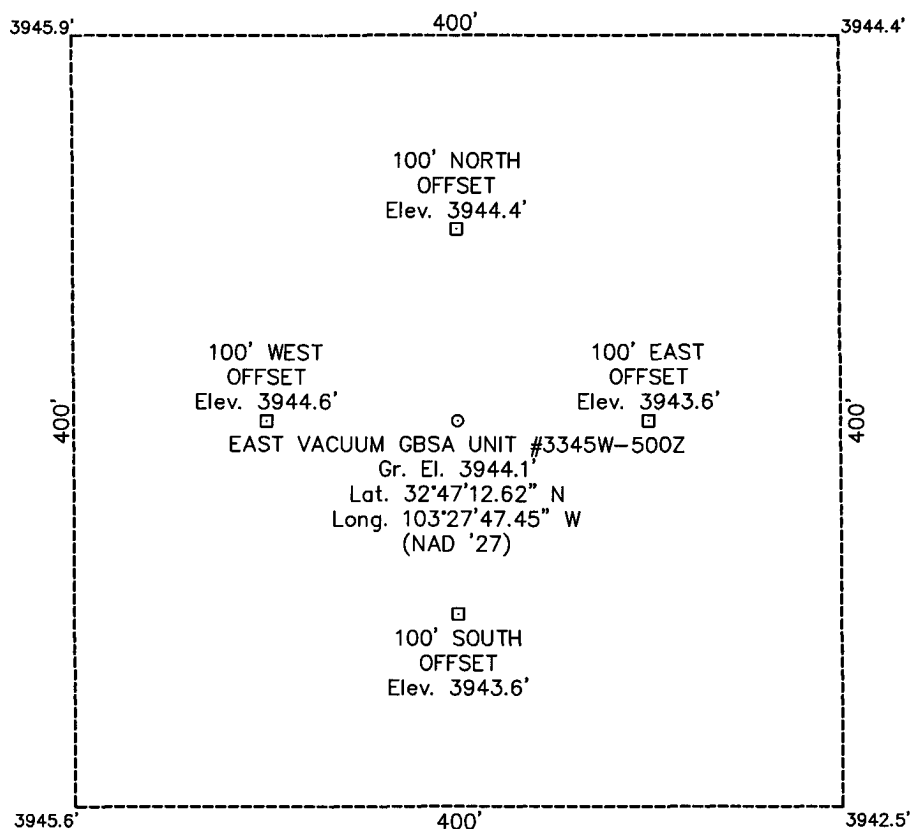
DRIVING DIRECTIONS

FROM THE INTERSECTION OF STATE HIGHWAY 8 AND COUNTY ROAD 50 IN BUCKEYE, NEW MEXICO GO EAST ON SAID COUNTY ROAD 50 1.2 MILES TO A LEASE ROAD ON SOUTH (RIGHT) SIDE OF ROAD, THEN GO SOUTH 0.4 MILE THEN TURN SOUTHEAST (LEFT) FOR 1.0 MILE TO ANOTHER LEASE ROAD ON EAST (LEFT) SIDE OF ROAD, THEN GO EAST 0.5 MILE, THEN GO NORTH (LEFT) 0.2 MILE, THEN GO EAST (RIGHT) 0.2 MILE TO A POINT BEING APPROXIMATELY 200 FEET NORTH OF THE PROPOSED LOCATION.

**CONOCOPHILLIPS****EAST VACUUM GBSA UNIT #3345W-500Z**

Located 1050' FSL & 2325' FWL, Section 33  
Township 17 South, Range 35 East, N.M.P.M.  
Lea County, New Mexico

Drawn By: LVA

Date: November 11, 2009

Scale: 1" = 100'

Field Book: 376 / 48-55

Revision Date:

Quadrangle: Lovington SW

W.O. No: 2009-0749

Dwg. No.: L-2009-0749-A



110 W. LOUISIANA, STE. 110  
MIDLAND TEXAS, 79701  
(432) 687-0865 - (432) 687-0868 FAX

# LOCATION VERIFICATION MAP

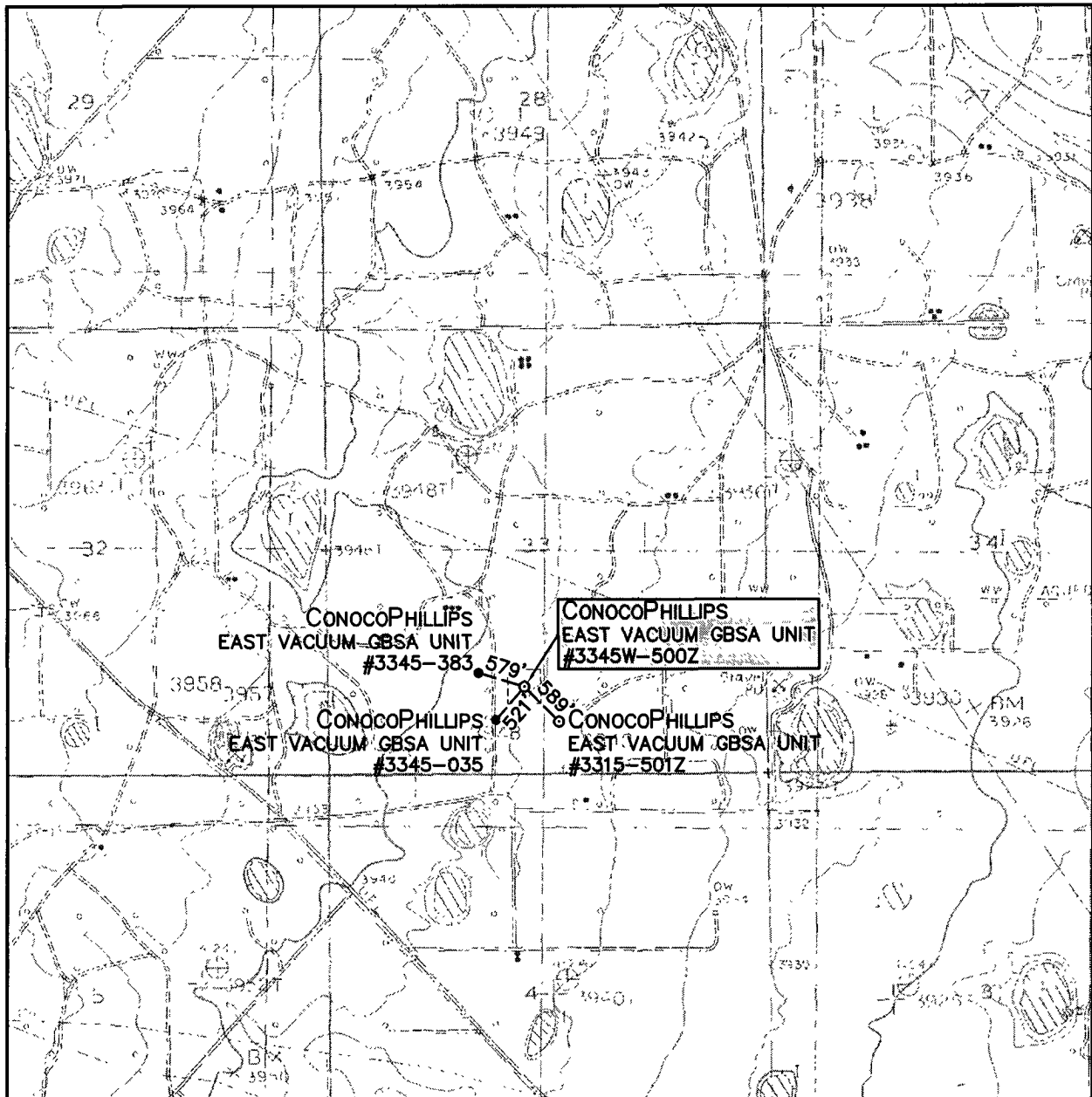

SCALE: 1" = 2000'

CONTOUR INTERVAL:  
LOVINGTON SW - 5'

SEC. 33 TWP. 17-S RGE. 35-E

SURVEY N.M.P.M.

COUNTY LEA

DESCRIPTION 1050' FSL & 2325' FWL

ELEVATION 3944'

OPERATOR CONOCOPHILLIPS

LEASE EAST VACUUM GBSA UNIT

U.S.G.S. TOPOGRAPHIC MAP  
LOVINGTON SW, N.M.



110 W. LOUISIANA, STE. 110  
MIDLAND TEXAS, 79701  
(432) 687-0865 - (432) 687-0868 FAX

# VICINITY MAP

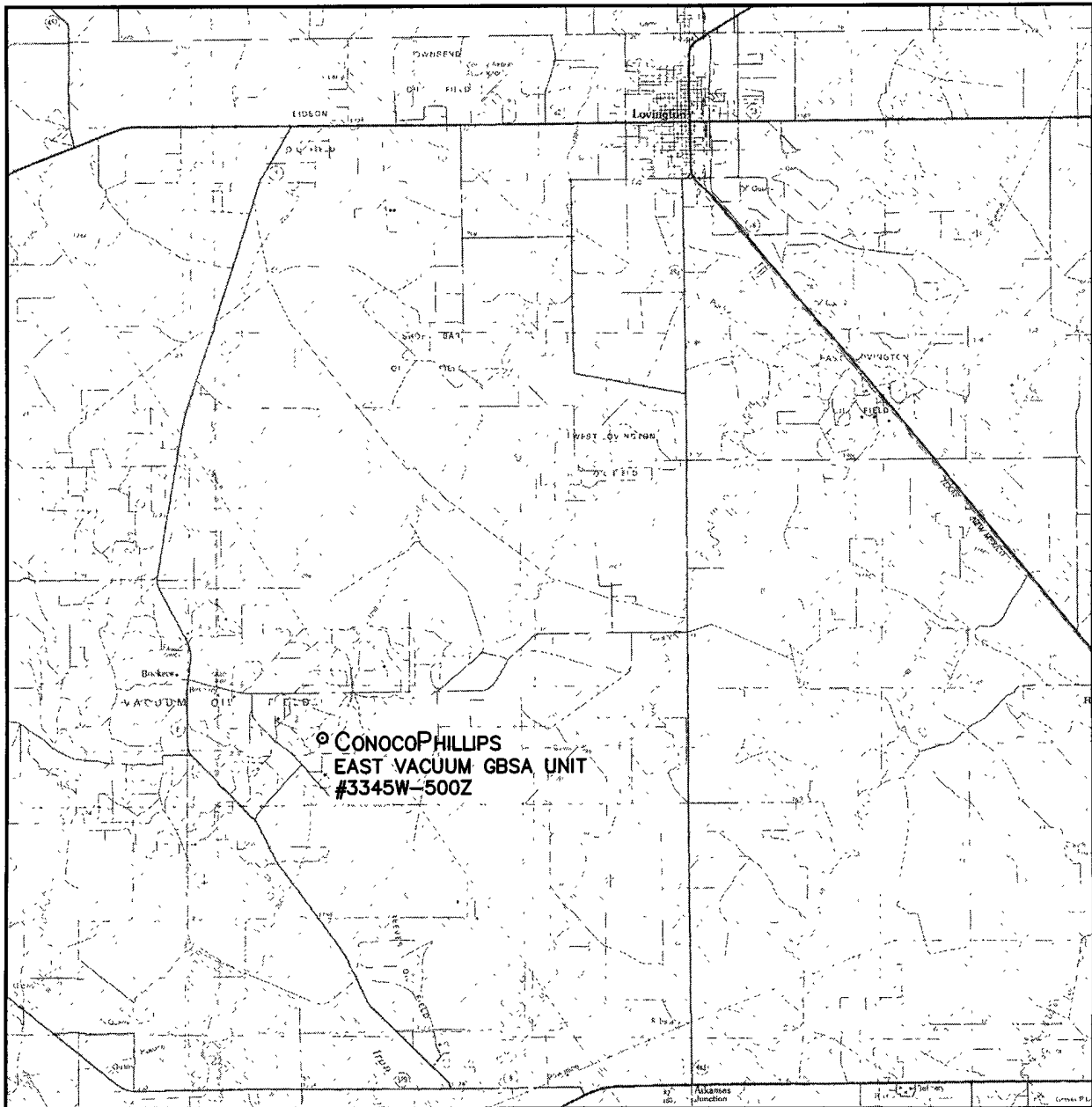

SCALE: 1" = 3 MILES

SEC. 33 TWP. 17-S RGE. 35-E

SURVEY \_\_\_\_\_ N.M.P.M.

COUNTY \_\_\_\_\_ LEA

DESCRIPTION 1050' FSL & 2325' FWL

ELEVATION \_\_\_\_\_ 3944'

OPERATOR \_\_\_\_\_ CONOCOPHILLIPS

LEASE \_\_\_\_\_ EAST VACUUM GBSA UNIT



110 W. LOUISIANA, STE. 110  
MIDLAND TEXAS, 79701  
(432) 687-0865 - (432) 687-0868 FAX