

DISTRICT I
1625 N. French Dr., Hobbs, NM 88240

DISTRICT II
1801 W. Grand Avenue, Artesia, NM 88210

DISTRICT III
1000 Rio Brazos Rd., Aztec, NM 87410

DISTRICT IV
1229 S. St. Francis Dr., Santa Fe, NM 87505

RECEIVED

JAN 11 2010

HOBBBS

State of New Mexico
Energy, Minerals and Natural Resources Department

CONSERVATION DIVISION
1220 South St. Francis Dr.
Santa Fe, New Mexico 87505

Form C-102
Revised October 15, 2009

Submit one copy to appropriate
District Office

WELL LOCATION AND ACREAGE DEDICATION PLAT

☐ AMENDED REPORT

API Number 30-005-29077	Pool Code 97722	Pool Name Wildcat Abo Wolfcamp
Property Code 37276	Property Name TICONDEROGA "16" STATE COM	Well Number 2
GRID No. 162683	Operator Name CIMAREX ENERGY CO. OF COLORADO	Elevation 4414'

Surface Location

UL or lot No.	Section	Township	Range	Lot Idn	Feet from the	North/South line	Feet from the	East/West line	County
A	16	15 S	31 E		375	NORTH	330	EAST	CHAVES

Bottom Hole Location If Different From Surface

UL or lot No.	Section	Township	Range	Lot Idn	Feet from the	North/South line	Feet from the	East/West line	County
D	16	15 S	31 E		375	NORTH	330	WEST	CHAVES
Dedicated Acres 160	Joint or Infill	Consolidation Code P	Order No.						

NO ALLOWABLE WILL BE ASSIGNED TO THIS COMPLETION UNTIL ALL INTERESTS HAVE BEEN CONSOLIDATED
OR A NON-STANDARD UNIT HAS BEEN APPROVED BY THE DIVISION

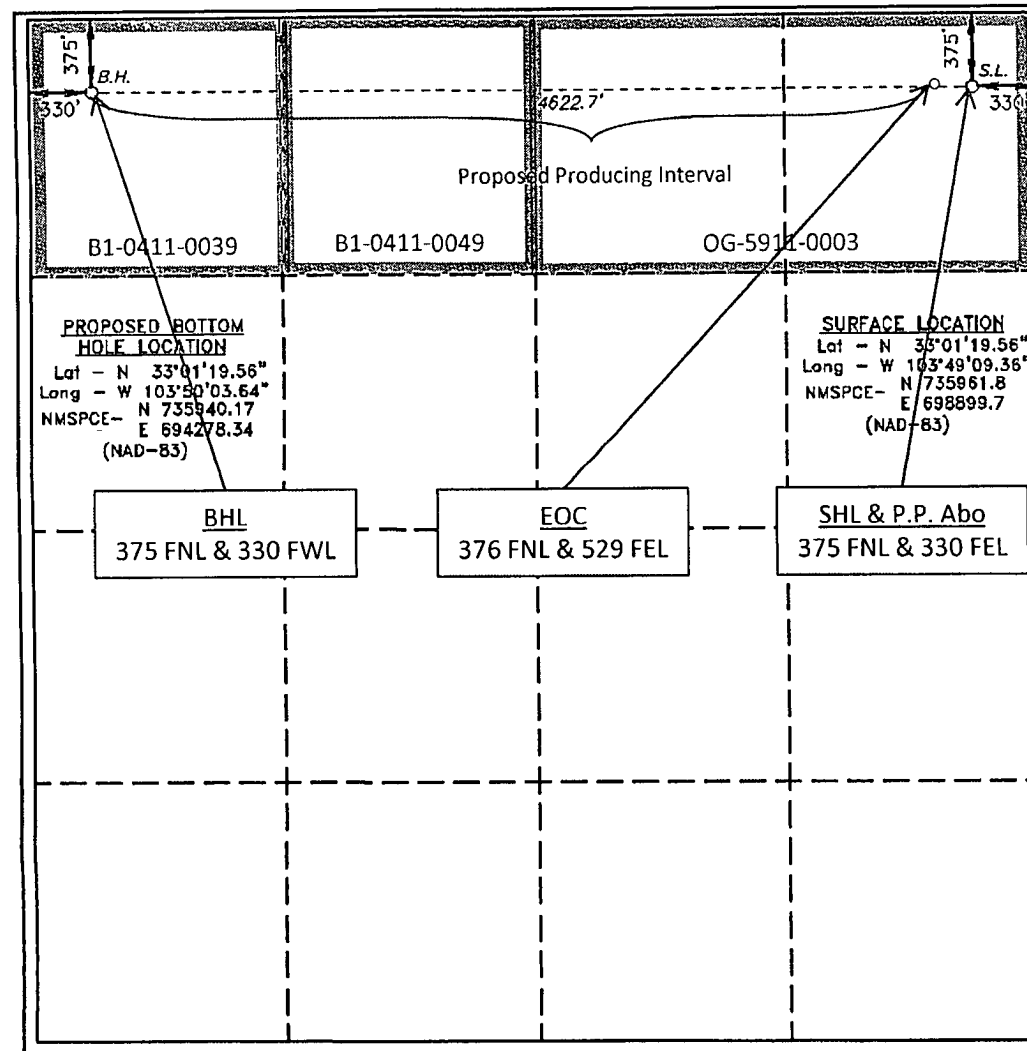

OPERATOR CERTIFICATION

I hereby certify that the information contained herein is true and complete to the best of my knowledge and belief, and that this organization either owns a working interest or unleased mineral interest in the land including the proposed bottom hole location or has a right to drill this well at this location pursuant to a contract with an owner of such a mineral or working interest or to a voluntary pooling agreement or a compulsory pooling order heretofore entered by the division

Zeno Farris 1/8/2010
Signature Date

Zeno Farris

Printed Name

SURVEYOR CERTIFICATION

I hereby certify that the well location shown on this plat was plotted from field notes of actual surveys made by me or under my supervision, and that the same is true and correct to the best of my belief.

NOV 11 2009
Date Surveyed
Signature of Professional Surveyor
Certificate No. Gary L. Jones 7977
BASIN SURVEYS