

DISTRICT I
1625 N. French Dr., Hobbs, NM 88240
DISTRICT II
1301 W. Grand Ave., Artesia, NM 88210
DISTRICT III
1000 Rio Brazos Rd., Aztec, NM 87410
DISTRICT IV
1220 St. Francis Dr., Santa Fe, NM 87505

State of New Mexico
Energy, Minerals and Natural Resources Department
OIL CONSERVATION DIVISION
1220 South St. Francis Drive
Santa Fe, NM 87505

Form C-102
Revised October 12, 2005
Submit to Appropriate District Office
State Lease-4 copies
Fee Lease-3 copies

AMENDED REPORT

WELL LOCATION AND ACREAGE DEDICATION PLAT

| | | | | | | | | | |
|---|---------------|--|---------------|-------------------------|------------------------|---------------------------|------------------------|------------------------|---------------|
| 1 API Number 30-025-39806 | | 2 Pool Code 19190 | | 3 Pool Name Arunkard | | | | | |
| 4 Property Code 2606 | | 5 Property Name CENTRAL DRINKARD UNIT | | | | 6 Well Number 442 | | | |
| 7 OGRID No 4323 | | 8 Operator Name CHEVRON MID-CONTINENT, LP | | | | 9 Elevation 3484' | | | |
| 10 Surface Location | | | | | | | | | |
| UL or lot no F | Section 29 | Township 21-S | Range 37-E | Lot Idn | Feet from the 1930' | North/South line North | Feet from the 2195' | East/West line West | County Lea |
| 11 Bottom Hole Location If Different From Surface | | | | | | | | | |
| UL or lot no | Section | Township | Range | Lot Idn | Feet from the | North/South line | Feet from the | East/West line | County |
| 12 Dedicated Acres 40 | | 13 Joint or Infill | | 14 Consolidation Code | | 15 Order No R-4256 | | | |

NO ALLOWABLE WILL BE ASSIGNED TO THIS COMPLETION UNTIL ALL INTERESTS HAVE BEEN CONSOLIDATED
OR A NON-STANDARD UNIT HAS BEEN APPROVED BY THE DIVISION.

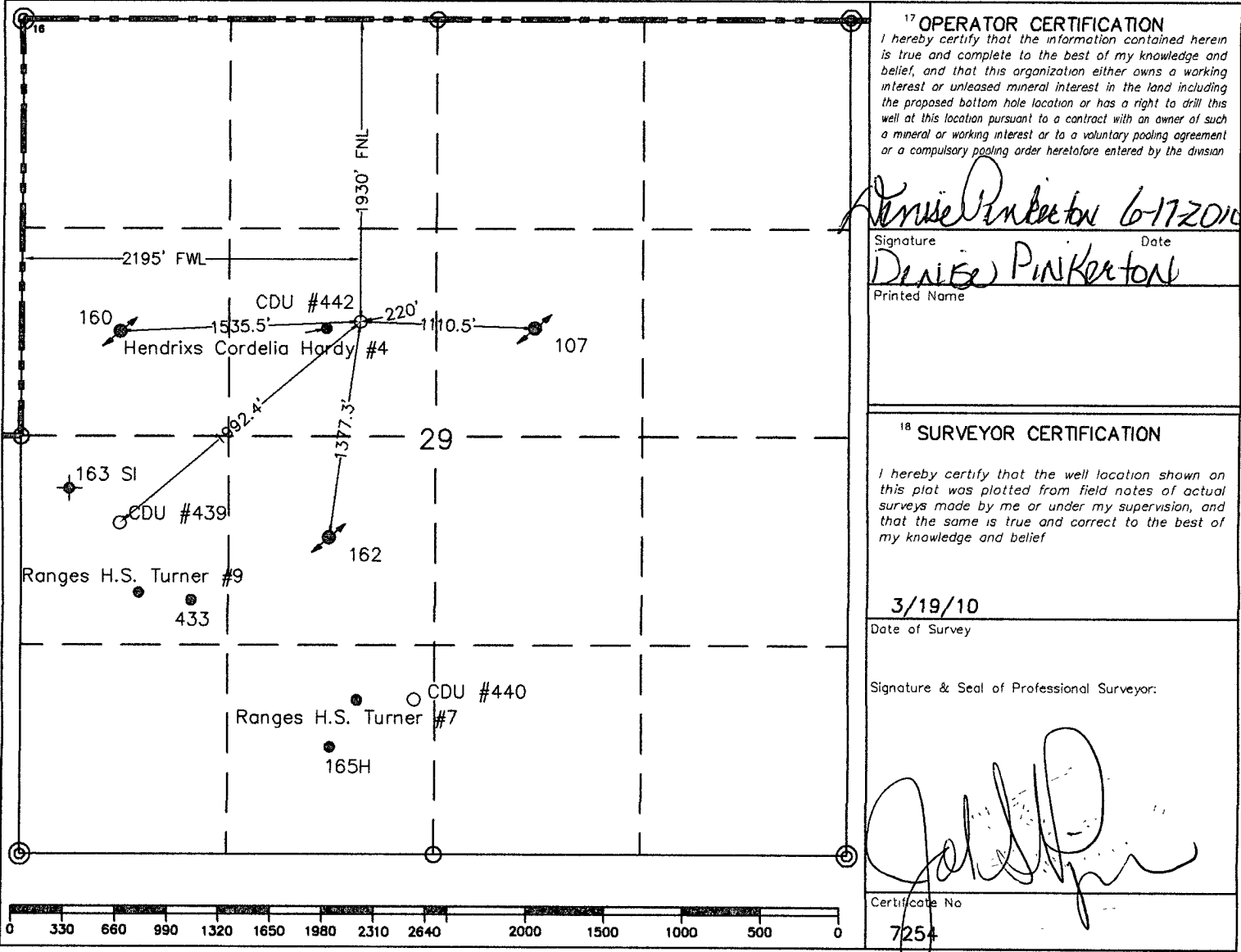

○ = Staked Location • = Producing Well ● = Injection Well ◇ = Water Supply Well ◆ = Plugged & Abandon Well
⊙ = Found Section Corner, 2 or 3" Iron Pipe & GLO B.C. ○ = Found 1/4 Section Corner, 1" Iron Pipe & GLO B.C.

ADDITIONAL INFORMATION ON THE LOCATION

| | | | |
|-------------------------|---------------------------------|------------------------|---------------------------------|
| State Plane Coordinates | | | |
| Northing | 530015.83 (1927 NAD= 529956.25) | Easting | 895079.55 (1927 NAD= 853895.17) |
| Latitude | 32°27'06.681" | Longitude | 103°11'11.612" |
| Zone | North American Datum | Combined Grid Factor | Coordinate File |
| East | 1983/HARN | 0.999889274 | Weatherly83E.crd |
| Drawing File | | | |
| Weatherly83E.Dwg | Field Book | See 11x17" Calc. Sheet | |