

RECEIVED

AUG 12 2010

## DISTRICT I

1225 N. FRENCH DR., HOBBES, NM 88240

HOBBES

State of New Mexico  
Energy, Minerals and Natural Resources Department

## DISTRICT II

1301 W. GRAND AVENUE, ARTESIA, NM 88210

## OIL CONSERVATION DIVISION

1220 SOUTH ST. FRANCIS DR.  
Santa Fe, New Mexico 87505

## DISTRICT III

1000 Rio Brazos Rd., Aztec, NM 87410

## DISTRICT IV

1220 S. ST. FRANCIS DR., SANTA FE, NM 87505

## WELL LOCATION AND ACREAGE DEDICATION PLAT

AMENDED REPORT

API Number 30-005-27994	Pool Code 87715	Pool Name Wildcat; Wolfcamp A90-WOLFCAMP
Property Code 37489	Property Name WRINKLE 13 FEDERAL COM	Well Number 1H
OGRID No. 147179	Operator Name CHESAPEAKE OPERATING, INC.	Elevation 4359'

## Surface Location

UL or lot No.	Section	Township	Range	Lot Idn	Feet from the	North/South line	Feet from the	East/West line	County
I	13	15-S	31-E		1980	SOUTH	330	EAST	CHAVES

## Bottom Hole Location If Different From Surface

UL or lot No.	Section	Township	Range	Lot Idn	Feet from the	North/South line	Feet from the	East/West line	County
L	13	15-S	31-E		2010	SOUTH	535	WEST	CHAVES
Dedicated Acres 160	Joint or Infill	Consolidation Code	Order No. 1952						

NO ALLOWABLE WILL BE ASSIGNED TO THIS COMPLETION UNTIL ALL INTERESTS HAVE BEEN CONSOLIDATED  
OR A NON-STANDARD UNIT HAS BEEN APPROVED BY THE DIVISION

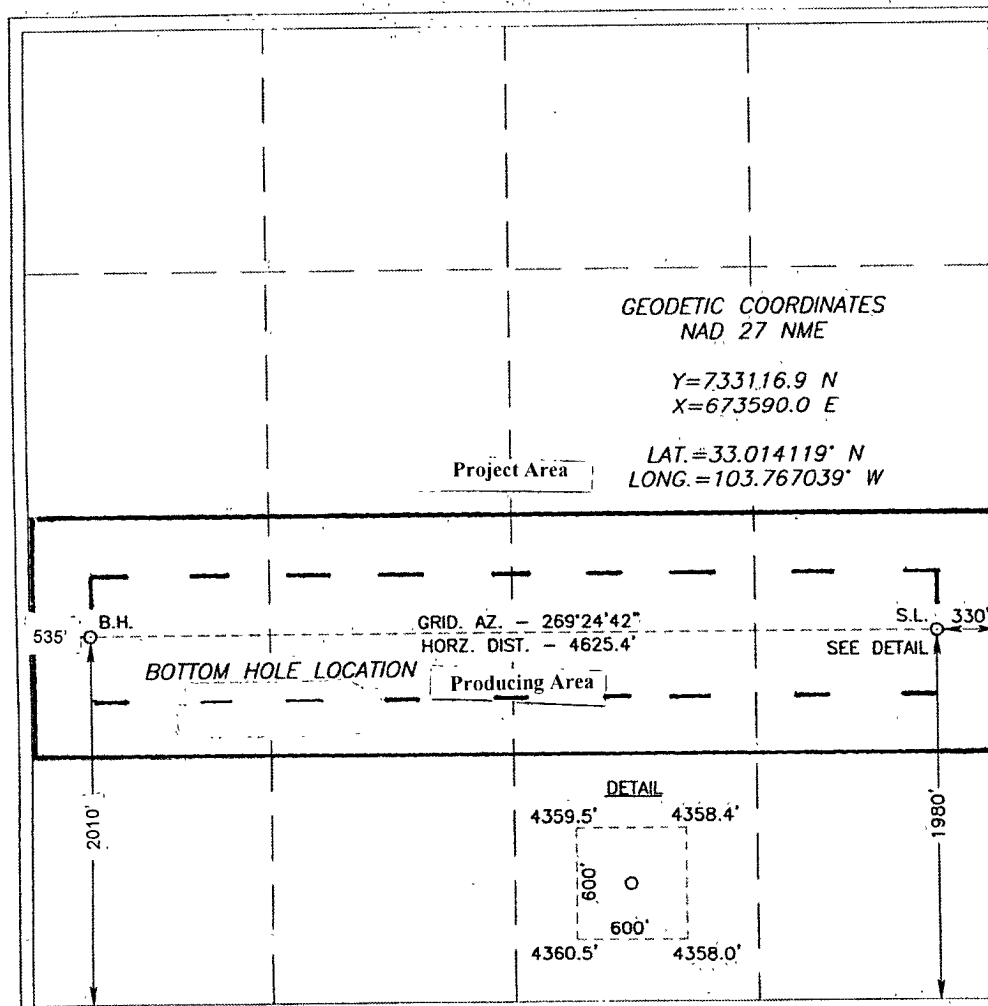

## OPERATOR CERTIFICATION

I hereby certify that the information herein is true and complete to the best of my knowledge and belief, and that this organization either owns a working interest or unleased mineral interest in the land including the proposed bottom hole location or has a right to drill this well at this location pursuant to a contract with an owner of such mineral or working interest, or to a voluntary pooling agreement or a compulsory pooling order heretofore entered by the division.

Signature: *Bryan Arrant* Date: 07/19/2010  
Printed Name: Bryan Arrant

## SURVEYOR CERTIFICATION

I hereby certify that the well location shown on this plat was plotted from field notes of actual surveys made by me or under my supervision, and that the same is true and correct to the best of my belief.

Date Surveyed: NOVEMBER 20, 2007  
Signature & Seal of Professional Surveyor: *Ronald J. Eidson*  
Certificate No. GARY G. EIDSON 12641  
RONALD J. EIDSON 3239