

DISTRICT I
1625 N. FRENCH DR., HOODS, NM 88210

DISTRICT II
1301 W. GRAND AVENUE, ARTESIA, NM 88210

DISTRICT III
1000 Rio Brazos Rd., Aztec, NM 87410

DISTRICT IV
1220 S. ST. FRANCIS DR., SANTA FE, NM 87505

State of New Mexico
Energy, Minerals and Natural Resources Department

OIL CONSERVATION DIVISION
1220 SOUTH ST. FRANCIS DR.
Santa Fe, New Mexico 87505

JW
Form C-102
Revised October 12, 2005
Submit to Appropriate District Office
State Lease - 4 Copies
Fee Lease - 3 Copies

WELL LOCATION AND ACREAGE DEDICATION PLAT

☐ AMENDED REPORT

API Number 30 42-025-39906	Pool Code 47080	Pool Name Monument Paddock
Property Code 35591	Property Name APACHE STATE Q	Well Number 9
OGRID No. 873	Operator Name APACHE CORPORATION	Elevation 3530'

Surface Location

UL or lot No.	Section	Township	Range	Lot Idn	Feet from the	North/South line	Feet from the	East/West line	County
1	16	20-S	37-E		1710	SOUTH	660	EAST	LEA

Bottom Hole Location If Different From Surface

UL or lot No.	Section	Township	Range	Lot Idn	Feet from the	North/South line	Feet from the	East/West line	County
Dedicated Acres 40	Joint or Infill	Consolidation Code	Order No.						

NO ALLOWABLE WILL BE ASSIGNED TO THIS COMPLETION UNTIL ALL INTERESTS HAVE BEEN CONSOLIDATED
OR A NON-STANDARD UNIT HAS BEEN APPROVED BY THE DIVISION

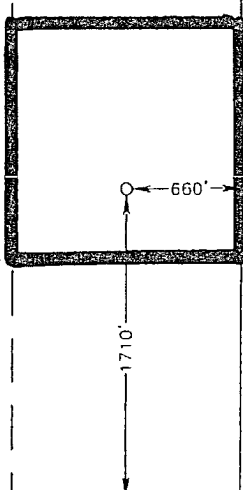
<p>GEODETIC COORDINATES NAD 27 NME</p> <p>Y=572930.3 N X=833879.6 E</p> <p>LAT.=32 570419" N LONG.=103.249548" W LAT.=32°34'14" N LONG.=103°14'58" W</p> 	<p>OPERATOR CERTIFICATION</p> <p>I hereby certify that the information herein is true and complete to the best of my knowledge and belief, and that this organization either owns a working interest or unleased mineral interest in the land including the proposed bottom hole location or has a right to drill this well at this location pursuant to a contract with an owner of such mineral or working interest, or to a voluntary pooling agreement or a compulsory pooling order heretofore entered by the division.</p> <p><i>Sorina L. Flores</i> 9/20/10 Signature Date Sorina L. Flores Printed Name</p> <p>SURVEYOR CERTIFICATION</p> <p>I hereby certify that the well location shown on this plat was plotted from field notes of actual surveys made by me or under my supervision, and that the same is true and correct to the best of my belief.</p> <p>August 27, 2010 Date Surveyed Signature & Seal of Professional Surveyor <i>Ronald E. Eidson</i> 8/26/2010 10.11.1239 Certificate No. RONALD EIDSON 3239</p>
---	--

DISTRICT I
1625 N. FRENCII DR., HOBBS, NM 88240

DISTRICT II
1301 W. GRAND AVENUE, ARTESIA, NM 88210

DISTRICT III
1000 Rio Drazos Rd., Aztec, NM 87410

DISTRICT IV
1220 S. ST. FRANCIS DR., SANTA FE, NM 87505

State of New Mexico
Energy, Minerals and Natural Resources Department

OIL CONSERVATION DIVISION
1220 SOUTH ST. FRANCIS DR.
Santa Fe, New Mexico 87505

Form C-102
Revised October 12, 2005
Submit to Appropriate District Office
State Lease - 4 Copies
Fee Lease - 3 Copies

WELL LOCATION AND ACREAGE DEDICATION PLAT

☐ AMENDED REPORT

API Number 30 42-025-39906	Pool Code 63280	Pool Name Weir, Blueberry
Property Code 35591	Property Name APACHE STATE Q	Well Number 9
OGRID No. 873	Operator Name APACHE CORPORATION	Elevation 3530'

Surface Location

UL or lot No.	Section	Township	Range	Lot Idn	Feet from the	North/South line	Feet from the	East/West line	County
1	16	20-S	37-E		1710	SOUTH	660	EAST	LEA

Bottom Hole Location If Different From Surface

UL or lot No.	Section	Township	Range	Lot Idn	Feet from the	North/South line	Feet from the	East/West line	County
Dedicated Acres		Joint or Infill		Consolidation Code		Order No.			

NO ALLOWABLE WILL BE ASSIGNED TO THIS COMPLETION UNTIL ALL INTERESTS HAVE BEEN CONSOLIDATED
OR A NON-STANDARD UNIT HAS BEEN APPROVED BY THE DIVISION

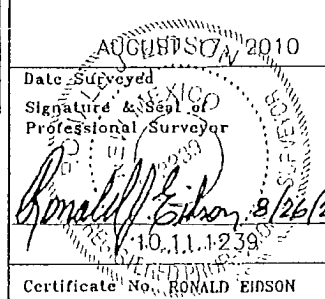
<p>GEODETIC COORDINATES NAD 27 NME</p> <p>Y=572930.3 N X=833879.6 E</p> <p>LAT.=32.570419' N LONG.=103.249548' W LAT.=32°34'14" N LONG.=103°14'58" W</p>				<p>OPERATOR CERTIFICATION</p> <p>I hereby certify that the information herein is true and complete to the best of my knowledge and belief, and that this organization either owns a working interest or unleased mineral interest in the land including the proposed bottom hole location or has a right to drill this well at this location pursuant to a contract with an owner of such mineral or working interest, or to a voluntary pooling agreement or a compulsory pooling order heretofore entered by the division.</p> <p><u>Sorina L. Flores</u> 9/20/10 Signature Date Sorina L. Flores Printed Name</p>	
				<p>SURVEYOR CERTIFICATION</p> <p>I hereby certify that the well location shown on this plat was plotted from field notes of actual surveys made by me or under my supervision, and that the same is true and correct to the best of my belief.</p> <p></p> <p>Date Surveyed Signature & Seal of Professional Surveyor Certificate No. RONALD EISON 3239</p>	

DISTRICT I
1625 N. FRENCH DR., HOBBS, NM 88240

DISTRICT II
1301 W. GRAND AVENUE, ARTESIA, NM 88210

DISTRICT III
1000 Rio Brazos Rd., Aztec, NM 87410

DISTRICT IV
1220 S. ST. FRANCIS DR., SANTA FE, NM 87505

State of New Mexico
Energy, Minerals and Natural Resources Department

OIL CONSERVATION DIVISION
1220 SOUTH ST. FRANCIS DR.
Santa Fe, New Mexico 87505

Form C-102
Revised October 12, 2005
Submit to Appropriate District Office
State Lease - 4 Copies
Fee Lease - 3 Copies

WELL LOCATION AND ACREAGE DEDICATION PLAT

☐ AMENDED REPORT

API Number 42-025-39906	Pool Code 42090	Pool Name Monument Tubb
Property Code 35591	Property Name APACHE STATE Q	Well Number 9
OGRID No. 873	Operator Name APACHE CORPORATION	Elevation 3530'

Surface Location

UL or lot No.	Section	Township	Range	Lot Idn	Feet from the	North/South line	Feet from the	East/West line	County
1	16	20-S	37-E		1710	SOUTH	660	EAST	LEA

Bottom Hole Location If Different From Surface

UL or lot No.	Section	Township	Range	Lot Idn	Feet from the	North/South line	Feet from the	East/West line	County
Dedicated Acres 80	Joint or Infill	Consolidation Code	Order No.						

NO ALLOWABLE WILL BE ASSIGNED TO THIS COMPLETION UNTIL ALL INTERESTS HAVE BEEN CONSOLIDATED
OR A NON-STANDARD UNIT HAS BEEN APPROVED BY THE DIVISION

<p>GEODETIC COORDINATES NAD 27 NME</p> <p>Y=572930.3 N X=833879.6 E</p> <p>LAT.=32.570419° N LONG.=103.249548° W LAT.=32°34'14" N LONG.=103°14'58" W</p> <p>660'</p> <p>1710'</p>	<p>OPERATOR CERTIFICATION</p> <p>I hereby certify that the information herein is true and complete to the best of my knowledge and belief, and that this organization either owns a working interest or unleased mineral interest in the land including the proposed bottom hole location or has a right to drill this well at this location pursuant to a contract with an owner of such mineral or working interest, or to a voluntary pooling agreement or a compulsory pooling order heretofore entered by the division.</p> <p><i>Sorina L. Flores</i> 9/20/10 Signature Date</p> <p>Sorina L. Flores Printed Name</p> <p>SURVEYOR CERTIFICATION</p> <p>I hereby certify that the well location shown on this plat was plotted from field notes of actual surveys made by me or under my supervision, and that the same is true and correct to the best of my belief.</p> <p>ADOPTED 2010</p> <p>Date Surveyed Signature & Seal of Professional Surveyor <i>Ronald E. Eison</i> 8/26/2010 10.1.1.1239</p> <p>Certificate No. RONALD EISON 3239</p>
---	---

DISTRICT I
1625 N FRENCH DR., HOBBS, NM 88240

DISTRICT II
1301 W. GRAND AVENUE, ARTESIA, NM 88210

DISTRICT III
1000 Rio Drazos Rd., Aztec, NM 87410

DISTRICT IV
1220 S. ST. FRANCIS DR., SANTA FE, NM 87505

State of New Mexico
Energy, Minerals and Natural Resources Department

OIL CONSERVATION DIVISION
1220 SOUTH ST. FRANCIS DR.
Santa Fe, New Mexico 87505

Form C-102
Revised October 12, 2005
Submit to Appropriate District Office
State Lease - 4 Copies
Fee Lease - 3 Copies

WELL LOCATION AND ACREAGE DEDICATION PLAT

☐ AMENDED REPORT

API Number 30 42-025-39906	Pool Code 6.3840	Pool Name Weir, Drinker
Property Code 3559.1	Property Name APACHE STATE Q	Well Number 9
OGRID No. 873	Operator Name APACHE CORPORATION	Elevation 3530'

Surface Location

UL or lot No.	Section	Township	Range	Lot Idn	Feet from the	North/South line	Feet from the	East/West line	County
1	16	20-S	37-E		1710	SOUTH	660	EAST	LEA

Bottom Hole Location If Different From Surface

UL or lot No.	Section	Township	Range	Lot Idn	Feet from the	North/South line	Feet from the	East/West line	County
Dedicated Acres 40	Joint or Infill	Consolidation Code	Order No.						

NO ALLOWABLE WILL BE ASSIGNED TO THIS COMPLETION UNTIL ALL INTERESTS HAVE BEEN CONSOLIDATED
OR A NON-STANDARD UNIT HAS BEEN APPROVED BY THE DIVISION

<p>GEODETIC COORDINATES NAD 27 NME</p> <p>Y=572930.3 N X=833879.6 E</p> <p>LAT.=32.570419° N LONG.=103.249548° W LAT.=32°34'14" N LONG.=103°14'58" W</p>	<p>660'</p> <p>1710'</p>	<p>OPERATOR CERTIFICATION</p> <p>I hereby certify that the information herein is true and complete to the best of my knowledge and belief, and that this organization either owns a working interest or unleased mineral interest in the land including the proposed bottom hole location or has a right to drill this well at this location pursuant to a contract with an owner of such mineral or working interest, or to a voluntary pooling agreement or a compulsory pooling order heretofore entered by the division.</p> <p>Sorina L. Flores 9/20/10 Signature Date</p> <p>Sorina L. Flores Printed Name</p> <p>SURVEYOR CERTIFICATION</p> <p>I hereby certify that the well location shown on this plat was plotted from field notes of actual surveys made by me or under my supervision, and that the same is true and correct to the best of my belief.</p> <p>ACCEPSED 2010 Date Surveyed Signature & Seal of Professional Surveyor Ronald E. Eidson 8/26/2010 10.11.1239 Certificate No. RONALD EIDSON 3239</p>
--	--------------------------	---

DISTRICT I
1626 N. FRENCI DR., HOBBS, NM 88240

DISTRICT II
1301 W. GRAND AVENUE, ARTESIA, NM 88210

DISTRICT III
1000 Rio Drazos Rd., Aztec, NM 87410

DISTRICT IV
1220 S. ST. FRANCIS DR., SANTA FE, NM 87505

State of New Mexico
Energy, Minerals and Natural Resources Department

OIL CONSERVATION DIVISION
1220 SOUTH ST. FRANCIS DR.
Santa Fe, New Mexico 87505

Form C-102
Revised October 12, 2005
Submit to Appropriate District Office
State Lease - 4 Copies
Fee Lease - 3 Copies

WELL LOCATION AND ACREAGE DEDICATION PLAT

☐ AMENDED REPORT

API Number 30 42-025-39906	Pool Code 96764	Pool Name Monument Abo Southeast
Property Code 35591	Property Name APACHE STATE Q	Well Number 9
OGRID No. 893	Operator Name APACHE CORPORATION	Elevation 3530'

Surface Location

UL or lot No.	Section	Township	Range	Lot Idn	Feet from the	North/South line	Feet from the	East/West line	County
1	16	20-S	37-E		1710	SOUTH	660	EAST	LEA

Bottom Hole Location If Different From Surface

UL or lot No.	Section	Township	Range	Lot Idn	Feet from the	North/South line	Feet from the	East/West line	County
Dedicated Acres		Joint or Infill	Consolidation Code		Order No.				

NO ALLOWABLE WILL BE ASSIGNED TO THIS COMPLETION UNTIL ALL INTERESTS HAVE BEEN CONSOLIDATED
OR A NON-STANDARD UNIT HAS BEEN APPROVED BY THE DIVISION

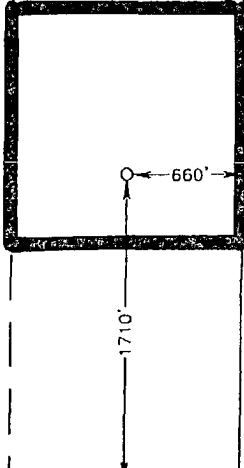
<p>GEODETIC COORDINATES NAD 27 NME</p> <p>Y=572930.3 N X=833879.6 E</p> <p>LAT.=32.570419' N LONG.=103.249548' W LAT.=32°34'14" N LONG.=103°14'58" W</p>		<p>OPERATOR CERTIFICATION</p> <p>I hereby certify that the information herein is true and complete to the best of my knowledge and belief, and that this organization either owns a working interest or unleased mineral interest in the land including the proposed bottom hole location or has a right to drill this well at this location pursuant to a contract with an owner of such mineral or working interest, or to a voluntary pooling agreement or a compulsory pooling order heretofore entered by the division.</p> <p><u>Sorina L. Flores</u> 9/20/10 Signature Date</p> <p><u>Sorina L. Flores</u> Printed Name</p>
		<p>SURVEYOR CERTIFICATION</p> <p>I hereby certify that the well location shown on this plat was plotted from field notes of actual surveys made by me or under my supervision, and that the same is true and correct to the best of my belief.</p> <p>DATE SURVEYED <u>AUGUST 27, 2010</u> LA</p> <p>Signature & Seal of Professional Surveyor <u>Ronald E. Eison</u> 8/26/2010 10.11.1239</p> <p>Certificate No. <u>RONALD EISON</u> 3239</p>

SECTION 16, TOWNSHIP 20 SOUTH, RANGE 37 EAST, N.M.P.M.,
LEA COUNTY, NEW MEXICO

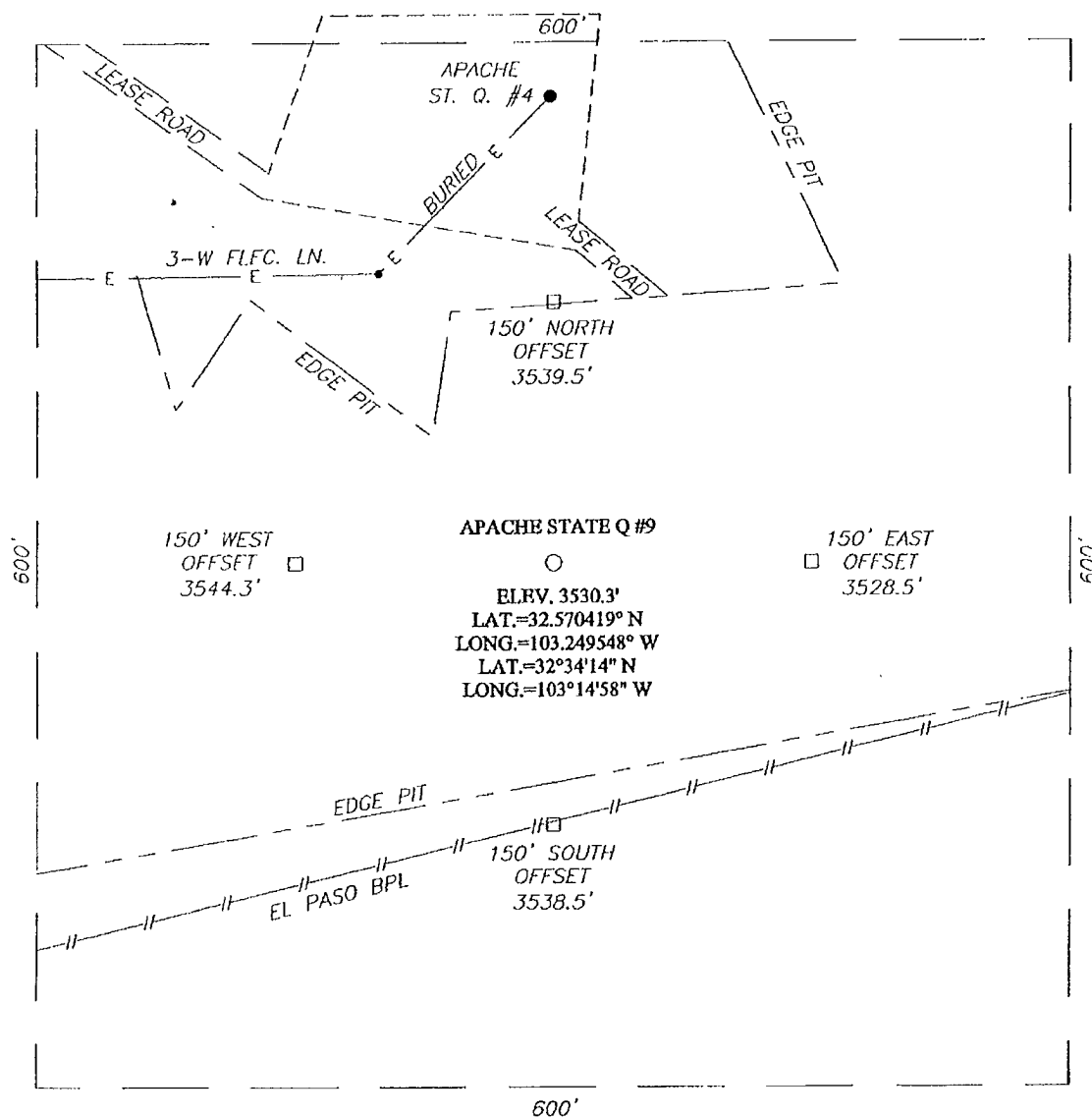

DIRECTIONS TO LOCATION

FROM THE INTERSECTION OF HWY. 8 AND CO. RD. #322 (MONUMENT) GO SOUTH ON HWY. #8 APPROX. 3.6 MILES. TURN LEFT AND GO EAST APPROX. 0.9 MILES. THE LOCATION STAKE IS APPROX. 200 FEET SOUTH.

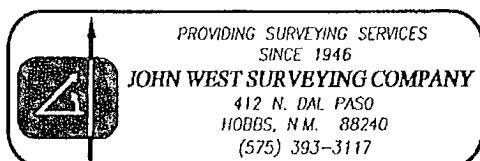
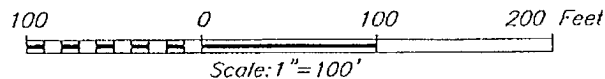

APACHE CORPORATION

APACHE STATE Q #9
LOCATED 1710 FEET FROM THE SOUTH LINE
AND 660 FEET FROM THE EAST LINE OF SECTION 16,
TOWNSHIP 20 SOUTH, RANGE 37 EAST, N.M.P.M.,
LEA COUNTY, NEW MEXICO.

Survey Date: 8/17/10	Sheet 1 of 1 Sheets
W.O. Number: 10.11.1239	Dr By: LA
Date: 8/25/10	12111239
	Scale: 1"=100'

VICINITY MAP

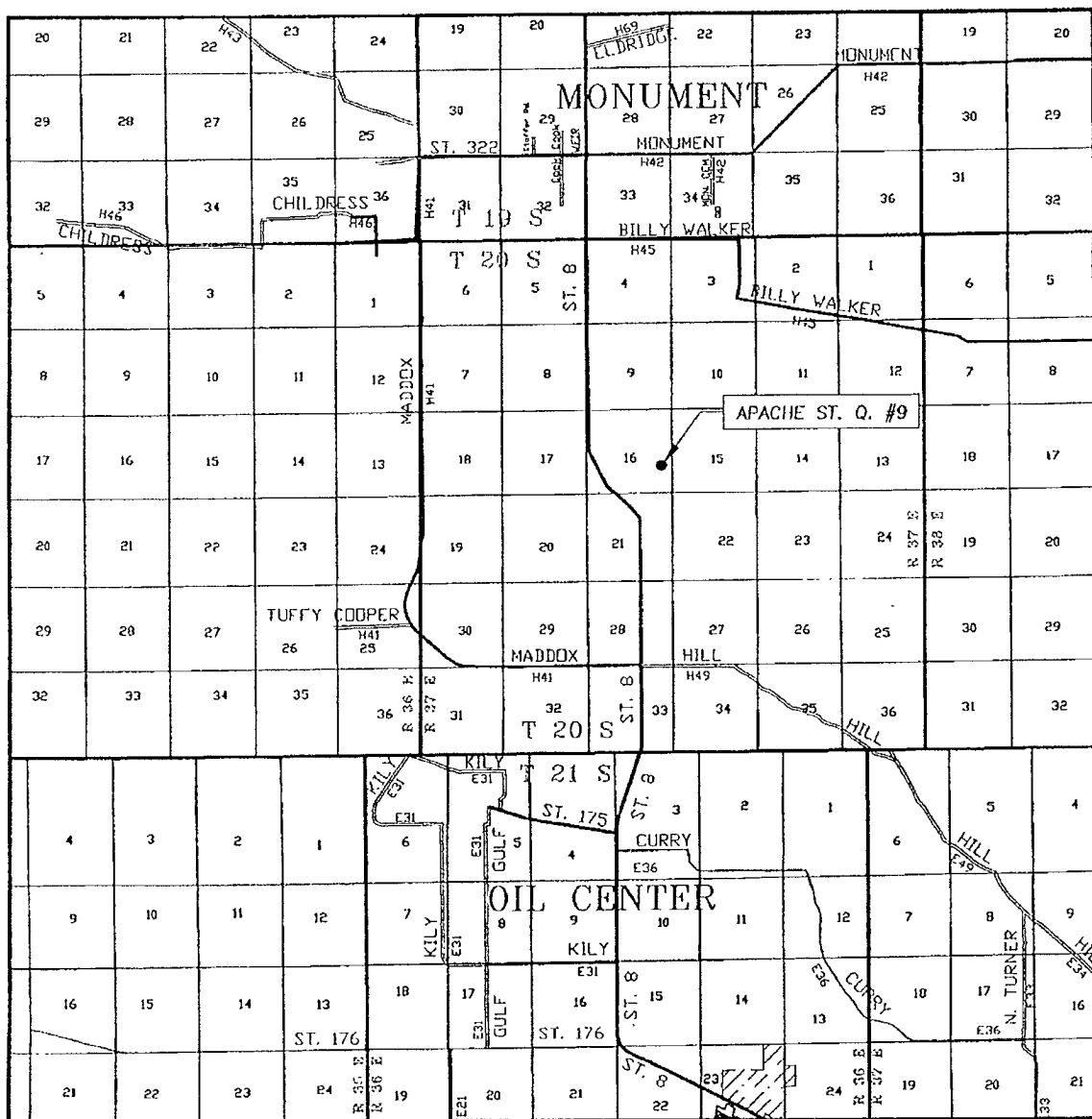

SCALE: 1" = 2 MILES

SEC. 16 TWP. 20-S RGE. 37-E

SURVEY N.M.P.M.

COUNTY LEA STATE NEW MEXICO

DESCRIPTION 1710' FSL & 660' FEL

ELEVATION 3530'

OPERATOR APACHE CORPORATION

LEASE APACHE ST. Q.

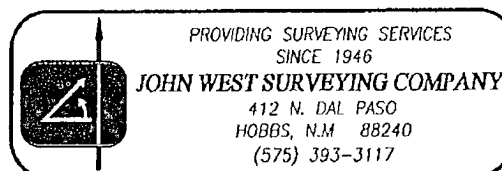

LOCATION VERIFICATION MAP

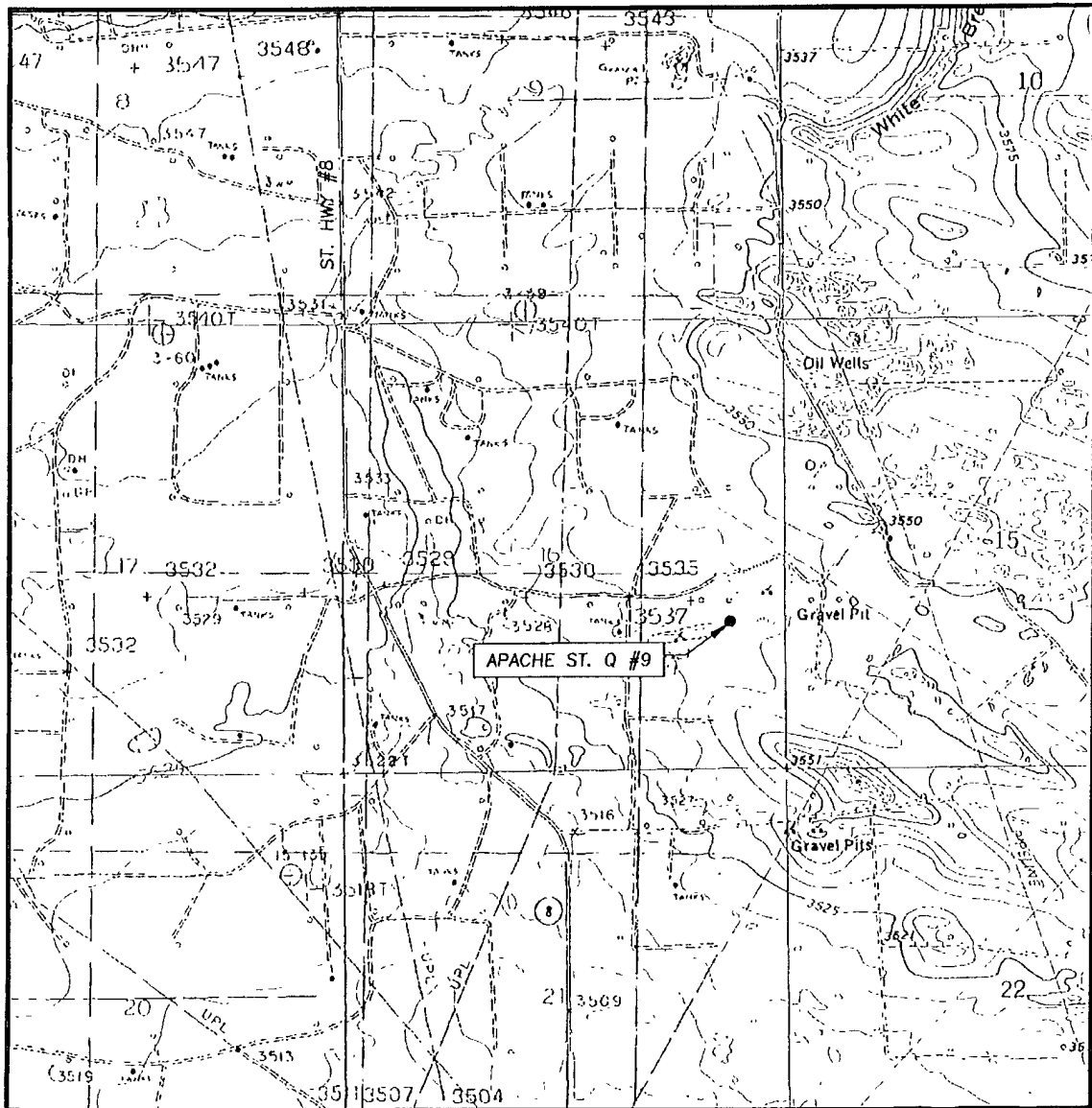

SCALE: 1" = 2000'

CONTOUR INTERVAL:

HOBBS SW, N.M. - 5'

MONUMENT SOUTH, N.M. - 5'

SEC. 16 TWP. 20-S RGE. 37-E

SURVEY N.M.P.M.

COUNTY LEA STATE NEW MEXICO

DESCRIPTION 1710' FSL & 660' FEL

ELEVATION 3530'

OPERATOR APACHE CORPORATION

LEASE APACHE STATE Q

U.S.G.S. TOPOGRAPHIC MAP
HOBBS SW, N.M.

