

District I
1625 N. French Dr., Hobbs, NM 88240
District II
1301 W. Grand Avenue, Artesia, NM 88210
District III
1000 Rio Brazos Road, Aztec, NM 87410
District IV
1220 S. St. Francis Dr., Santa Fe, NM 87505

RECEIVED
DEC 15 2010
HOBBSDUCD

State of New Mexico
Energy Minerals and Natural Resources
Oil Conservation Division
1220 South St. Francis Dr.
Santa Fe, NM 87505

Form C-101
May 27, 2004

Submit to appropriate District Office

☐ AMENDED REPORT

APPLICATION FOR PERMIT TO DRILL, RE-ENTER, DEEPEN, PLUGBACK, OR ADD A ZONE

¹ Operator Name and Address ConocoPhillips Company 3300 N "A" St. Bldg. 6, Midland, TX 79705		² OGRID Number 217817
³ Property Code 31172		⁴ API Number 30-025-39996
⁵ Property Name East Vacuum GBSA Unit 3335W		⁶ Well No. 506
⁹ Proposed Pool 1 Vacuum; Grayburg-San Andres (62180) /		¹⁰ Proposed Pool 2

7 Surface Location

UL or lot no. F	Section 33	Township 17-S	Range 35-E	Lot Idn	Feet from the 1700	North/South line North	Feet from the 2294	East/Westline West	County Lea
--------------------	---------------	------------------	---------------	---------	-----------------------	---------------------------	-----------------------	-----------------------	---------------

8 Proposed Bottom Hole Location If Different From Surface

UL or lot no.	Section	Township	Range	Lot Idn	Feet from the	North/South line	Feet from the	East/Westline	County
---------------	---------	----------	-------	---------	---------------	------------------	---------------	---------------	--------

Additional Well Information

¹¹ Work Type Code New Well	¹² Well Type Code Oil	¹³ Cable/Rotary	¹⁴ Lease Type Code State	¹⁵ Ground Level Elevation 3944'
¹⁶ Multiple No	¹⁷ Proposed Depth 4900'	¹⁸ Formation Grayburg-San Andres	¹⁹ Contractor	²⁰ Spud Date 01/01/2011
Depth to Groundwater 230'		Distance from nearest fresh water well		Distance from nearest surface water
Pit: Liner: Synthetic <input type="checkbox"/> milst thick Clay <input type="checkbox"/> Pit Volume: _____ bbls Drilling Method: _____ Closed-Loop System <input checked="" type="checkbox"/> Fresh Water <input checked="" type="checkbox"/> Brine <input checked="" type="checkbox"/> Diesel/Oil-based <input type="checkbox"/> Gas/Air <input type="checkbox"/>				

21 Proposed Casing and Cement Program

Hole Size	Casing Size	Casing weight/foot	Setting Depth	Sacks of Cement	Estimated TOC
12.25"	8.625"	24	1560'	650	Surface
7.875"	5.5"	17	4900"	700	Surface

²² Describe the proposed program. If this application is to DEEPEN or PLUG BACK, give the data on the present productive zone and proposed new productive zone. Describe the blowout prevention program, if any. Use additional sheets if necessary.

Permit Expires 2 Years From Approval
Date Unless Drilling Underway

²³ I hereby certify that the information given above is true and complete to the best of my knowledge and belief. I further certify that the drilling pit will be constructed according to NMOCD guidelines <input type="checkbox"/> , a general permit <input checked="" type="checkbox"/> , or an (attached) alternative OCD-approved plan <input type="checkbox"/> .		OIL CONSERVATION DIVISION	
Printed name: Brian D Maiorino		Approved by: 	
Title: Regulatory Specialist		Title: PETROLEUM ENGINEER	
E-mail Address: brian.d.maiorino@conocophillips.com		Approval Date: JAN 03 2011 Expiration Date: _____	
Date: 11/30/2010	Phone: (432)688-6913	Conditions of Approval Attached <input type="checkbox"/>	

East Vac GBSA Unit 3333 w # 506

15. Proposed Depth = 4,900' MD RKB

19. Proposed Casing and Cement Program						
Type	Hole Size (inches)	Casing OD (inches)	Casing Wt (lb/ft)	Setting Depth (feet)	Sacks of Cement	Estimated TOC (feet)
Surface	12.25	8.625	24	1560	650	0
Prod	7.875	5.5	17	4890	700	0

Casing and Cement Program: Additional Comments	
Fresh Water and Fresh Water Mud will be used for drilling the surface hole.	
Brine and Brine Based Mud will be used for drilling the production hole.	

Proposed Blowout Prevention Program			
Type	Working Pressure	Test Pressure	Manufacturer
Annular	2000	1000	
Blind Ram	2000	2000	
Pipe Ram	2000	2000	

DISTRICT I
1625 N. French Dr., Hobbs, NM 88240

DISTRICT II
1301 W. Grand Avenue, Artesia, NM 88210

DISTRICT III
1000 Rio Brazos Rd., Aztec, NM 87410

DISTRICT IV
1220 S. St. Francis Dr., Santa Fe, NM 87505

State of New Mexico
Energy, Minerals & Natural Resources Department

OIL CONSERVATION DIVISION

1220 South St. Frances Dr.
Santa Fe, NM 87505

RECEIVED

DEC 15 2010

HOBBSUCD

Form C-102
Revised October 12, 2005
Appropriate District Office
State Lease - 4 Copies
Fee Lease - 3 Copies

☐ AMENDED REPORT

WELL LOCATION AND ACREAGE DEDICATION PLAT

API Number 30-025-39996	Pool Code 62180	Pool Name Vacuum; Grayburg-San Andres
Property Code 31172	Property Name EAST VACUUM GBSA UNIT	Well Number 3333W-506
OGRID No. 21271	Operator Name CONOCOPHILLIPS	Elevation 3944'

Surface Location

UL or lot No.	Section	Township	Range	Lot Idn	Feet from the	North/South line	Feet from the	East/West line	County
F	33	17-S	35-E		1700	NORTH	2294	WEST	LEA

Bottom Hole Location If Different From Surface

UL or lot No.	Section	Township	Range	Lot Idn	Feet from the	North/South line	Feet from the	East/West line	County
Dedicated Acres	Joint or Infill	Consolidation Code	Order No.						

NO ALLOWABLE WILL BE ASSIGNED TO THIS COMPLETION UNTIL ALL INTERESTS HAVE BEEN CONSOLIDATED OR A NON-STANDARD UNIT HAS BEEN APPROVED BY THE DIVISION

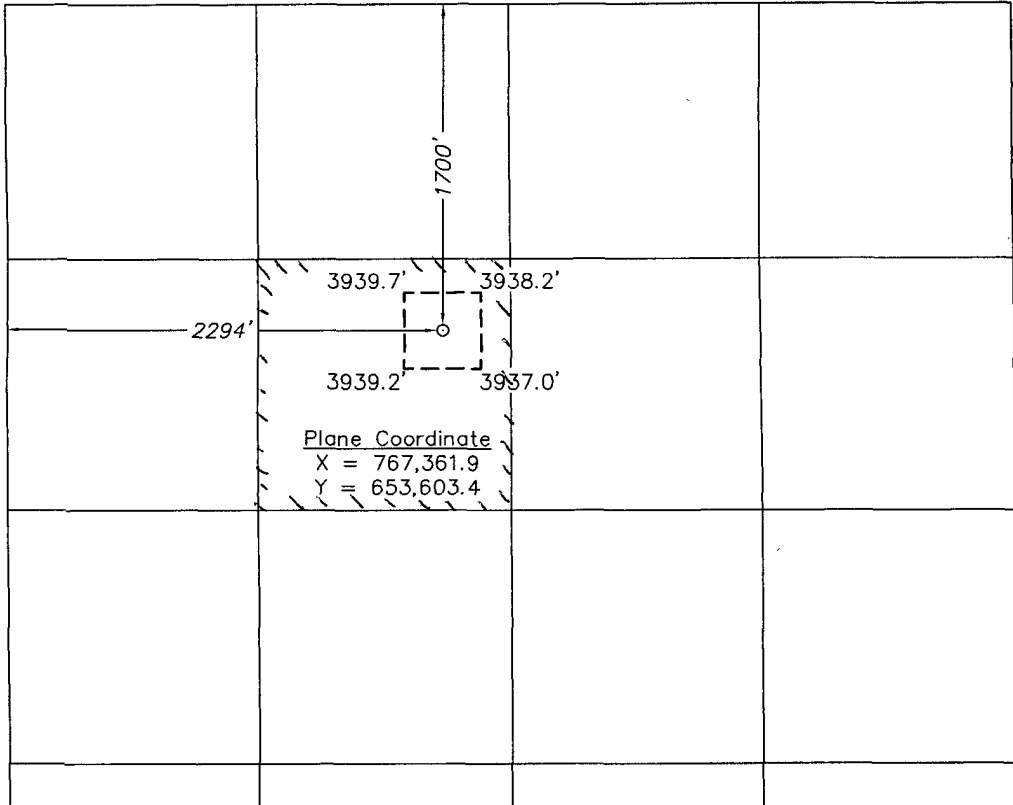
	<p>OPERATOR CERTIFICATION</p> <p>I hereby certify the information contained herein is true and complete to the best of my knowledge and belief, and that this organization either owns a working interest or unleased mineral interest in the land including the proposed bottom hole location or has a right to drill this well at this location pursuant to a contract with an owner of such a mineral or working interest, or to a voluntary pooling agreement or a compulsory pooling order heretofore entered by the division.</p> <p>B-D-M 11/30/10 Signature Date Brian Mahan Printed Name</p> <p>SURVEYOR CERTIFICATION</p> <p>I hereby certify that the well location shown on this plat was plotted from field notes of actual surveys made by me or under my supervision and that the same is true and correct to the best of my belief.</p> <p>October 28, 2010 Date of Survey Signature & Seal of Professional Surveyor W.O. Num: 2010-1315 Certificate No. MACON MCDONALD 12185</p>
---	---

NOTE:

- 1) Plane Coordinates shown hereon are Transverse Mercator Grid and Conform to the "New Mexico Coordinate System", New Mexico East Zone, North American Datum of 1927. Distances shown hereon are mean horizontal surface values.

SECTION 33, TOWNSHIP 17 SOUTH, RANGE 35 EAST, N.M.P.M.

LEA COUNTY

NEW MEXICO

L-2010-1315-A

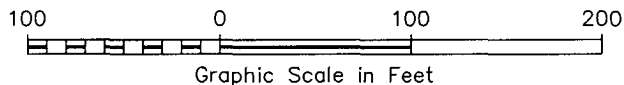
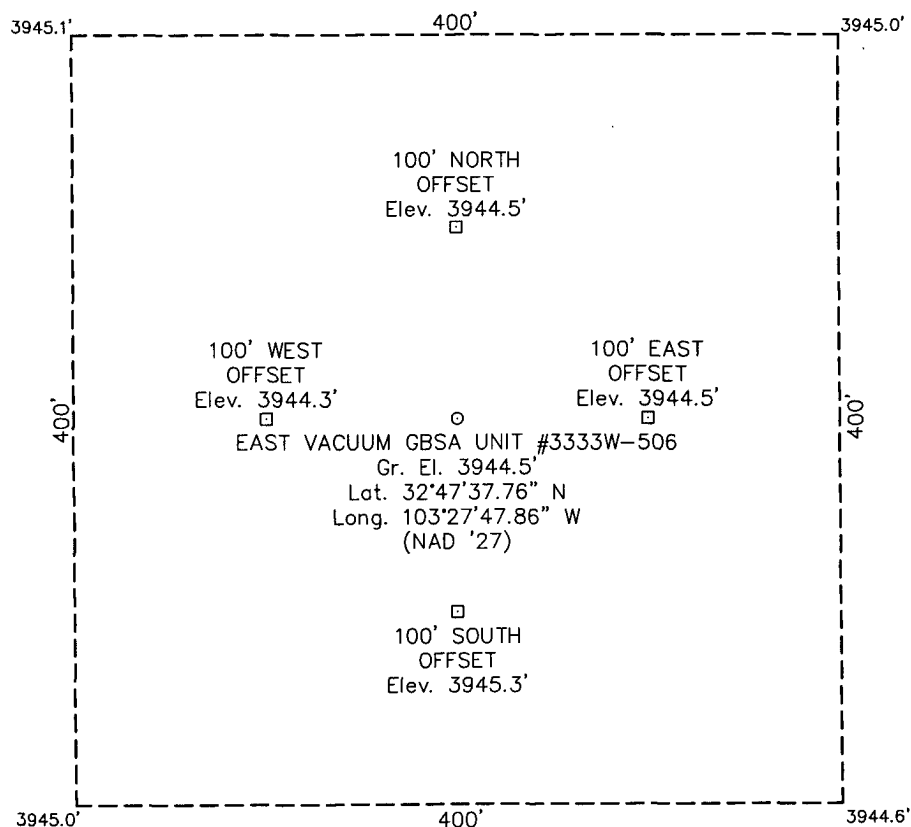
DRIVING DIRECTIONS

FROM THE INTERSECTION OF STATE HIGHWAY 8 AND COUNTY ROAD 50 IN BUCKEYE, NEW MEXICO GO EAST ON SAID COUNTY ROAD 50 1.7 MILES TO A LEASE ROAD ON SOUTH (RIGHT) SIDE OF ROAD, THEN GO SOUTH 150 FEET THEN TURN SOUTHEAST (LEFT) FOR 0.6 MILE TO A FORK IN THE ROAD. TAKE SOUTHEAST (RIGHT) FORK AND GO SOUTHEAST 0.2 MILE TO THE CONOCOPHILLIPS, EAST VACUUM GBSA UNIT #3333W-002 WELL PAD. THEN GO NORTH (LEFT) 0.1 MILE TO A POINT BEGIN APPROXIMATELY 200 FEET WEST OF THE PROPOSED LOCATION.

EAST VACUUM GBSA UNIT #3333W-506

Located 1700' FNL & 2294' FWL, Section 33
Township 17 South, Range 35 East, N.M.P.M.
Lea County, New Mexico

Drawn By: KHY	Date: November 4, 2010
Scale: 1" = 100'	Field Book: 376 / 65 - 68
Revision Date:	Quadrangle: Lovington SW
W.O. No: 2010-1315	Dwg. No.: L-2010-1315-A

WEST
COMPANY
of Midland, Inc.

110 W. LOUISIANA, STE. 110
MIDLAND TEXAS, 79701
(432) 687-0865 - (432) 687-0868 FAX

LOCATION VERIFICATION MAP

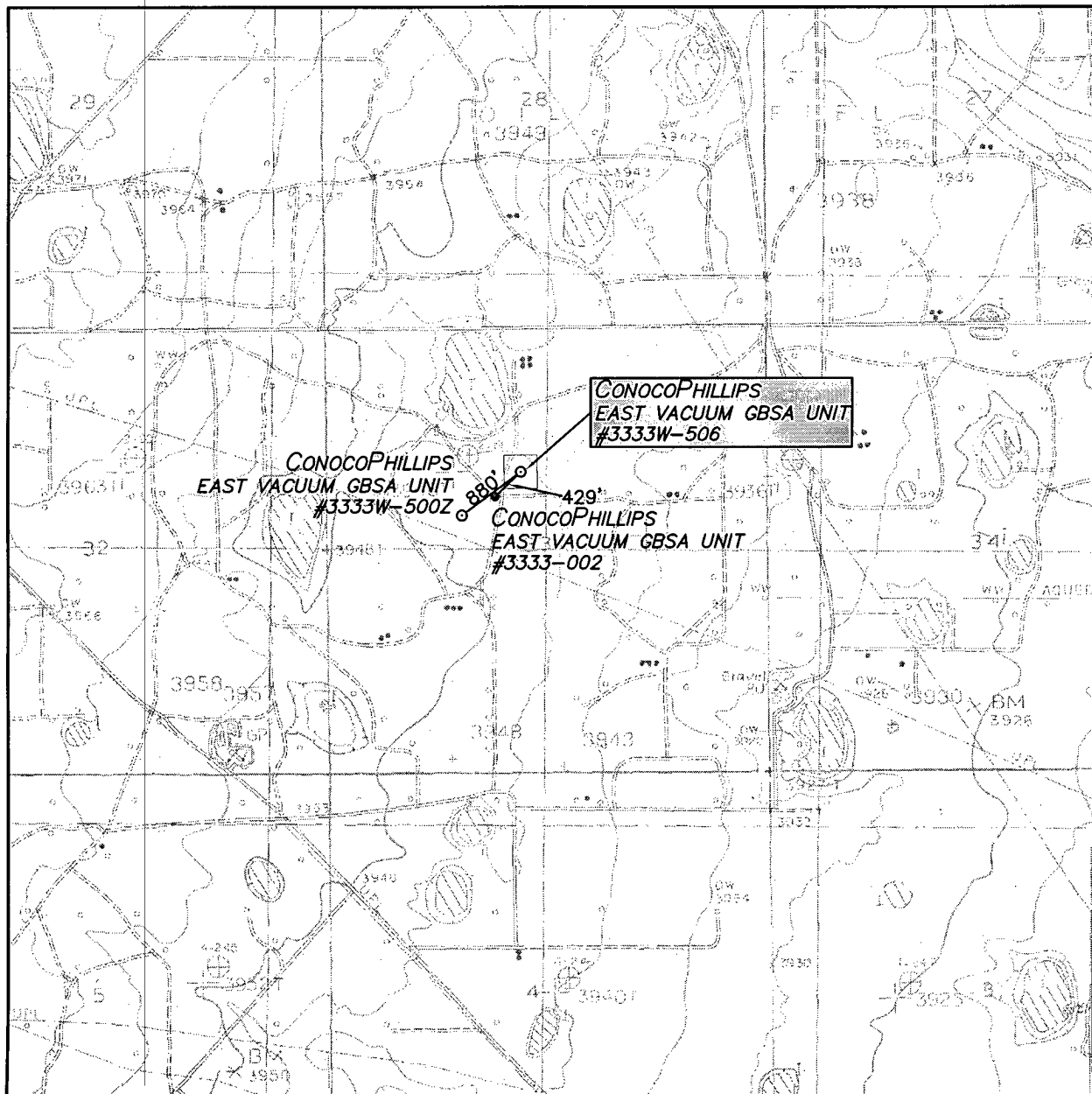

SCALE: 1" = 2000'

CONTOUR INTERVAL:
LOVINGTON SW - 5'

SEC. 33 TWP. 17-S RGE. 35-E

SURVEY _____ N.M.P.M.

COUNTY _____ LEA

DESCRIPTION 1700' FNL & 2294' FWL

ELEVATION _____ 3944'

OPERATOR _____ CONOCOPhillips

LEASE _____ EAST VACUUM GBSA UNIT

U.S.G.S. TOPOGRAPHIC MAP
LOVINGTON SW, N.M.



**WEST
COMPANY**
of Midland, Inc.

110 W. LOUISIANA, STE. 110
MIDLAND TEXAS, 79701
(432) 687-0865 - (432) 687-0868 FAX

VICINITY MAP

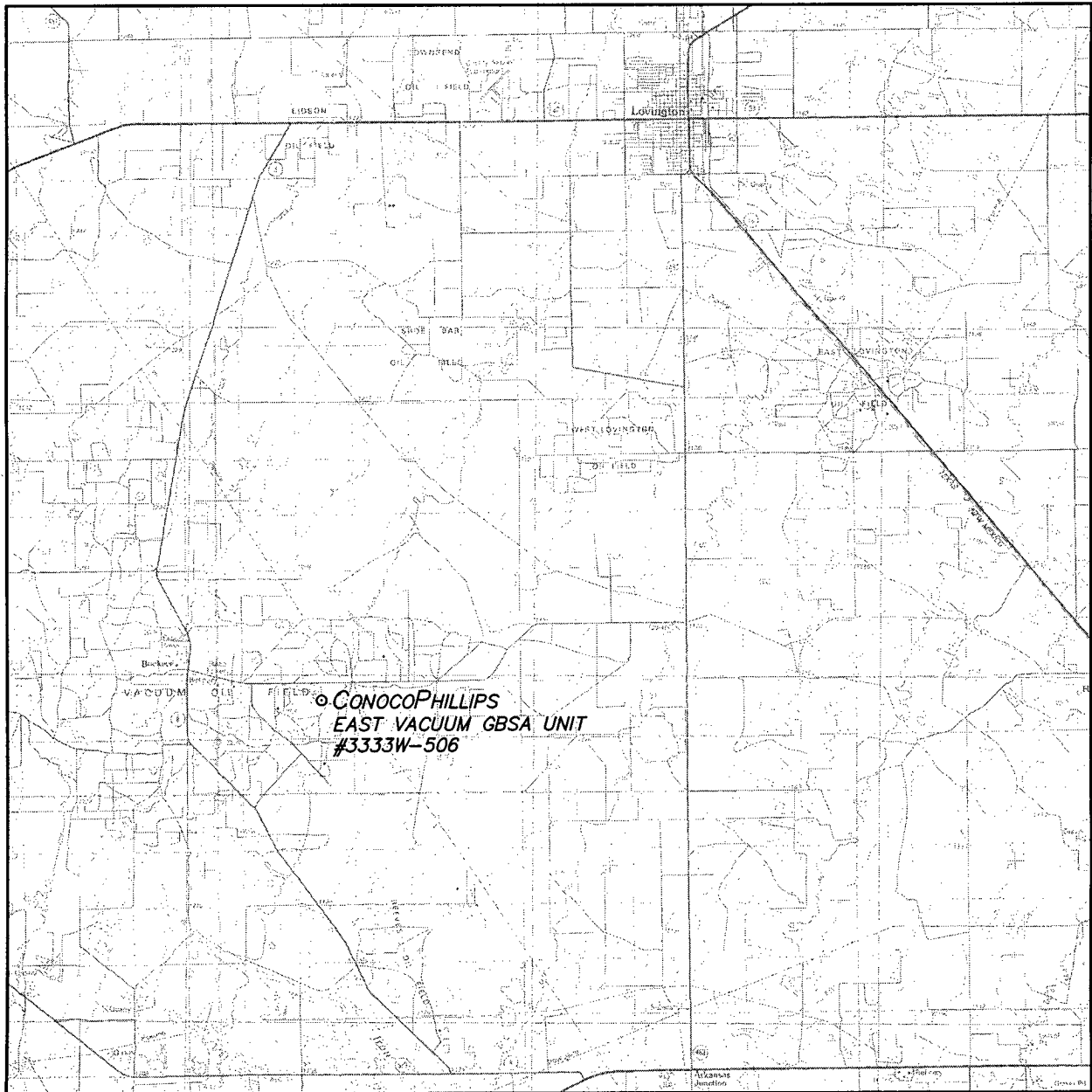

SCALE: 1" = 3 MILES

SEC. 33 TWP. 17-S RGE. 35-E

SURVEY _____ N.M.P.M.

COUNTY _____ LEA

DESCRIPTION 1700' FNL & 2294' FWL

ELEVATION _____ 3944'

OPERATOR _____ CONOCOPHILLIPS

LEASE _____ EAST VACUUM GBSA UNIT



WEST
COMPANY
of Midland, Inc.

110 W. LOUISIANA, STE. 110
MIDLAND TEXAS, 79701
(432) 687-0865 - (432) 687-0868 FAX