

District I
1625 N. French Dr., Hobbs, NM 88240
District II
1301 W. Grand Avenue, Artesia, NM 88210
District III
1000 Rio Brazos Road, Aztec, NM 87410
District IV
1220 S. St. Francis Dr., Santa Fe, NM 87505

State of New Mexico
HOBBS OCD Energy Minerals and Natural Resources
Oil Conservation Division
1220 South St. Francis Dr.
Santa Fe, NM 87505

Form C-101
June 16, 2008

Submit to appropriate District Office

☐ AMENDED REPORT

APPLICATION FOR PERMIT TO DRILL, RE-ENTER, DEEPEN, PLUGBACK, OR ADD A ZONE

¹ Operator Name and Address ConocoPhillips Company 3300 N "A" St, Bldg 6 Midland, TX 79705		² OGRID Number 217817
³ Property Code 38228 38251	⁴ Property Name Aquamarine State	⁵ API Number 30 - 025-40149
⁹ Proposed Pool 1 Maljamar; Yeso, West (44500)		¹⁰ Proposed Pool 2 3

7 Surface Location

UL or lot no. P	Section 16	Township 17S	Range 32 E	Lot Idn	Feet from the 318 330	North/South line South	Feet from the 820	East/West line East	County Lea
--------------------	---------------	-----------------	---------------	---------	--------------------------	---------------------------	----------------------	------------------------	---------------

8 Proposed Bottom Hole Location If Different From Surface

UL or lot no.	Section	Township	Range	Lot Idn	Feet from the	North/South line	Feet from the	East/West line	County
---------------	---------	----------	-------	---------	---------------	------------------	---------------	----------------	--------

Additional Well Information

¹¹ Work Type Code N	¹² Well Type Code O	¹³ Cable/Rotary R	¹⁴ Lease Type Code S	¹⁵ Ground Level Elevation 4015.6'
¹⁶ Multiple	¹⁷ Proposed Depth 7200'	¹⁸ Formation Yeso, West	¹⁹ Contractor Precision 194	²⁰ Spud Date 06/28/2011

21 Proposed Casing and Cement Program

Hole Size	Casing Size	Casing weight/foot	Setting Depth	Sacks of Cement	Estimated TOC
12.25"	8.625"	24#	850'	400 sx C	surface
7.875"	5.5"	17#	7190'	1000 sx C	surface

²² Describe the proposed program. If this application is to DEEPEN or PLUG BACK, give the data on the present productive zone and proposed new productive zone. Describe the blowout prevention program, if any. Use additional sheets if necessary.

See attached program for drilling mud and BOP information

**Permit Expires 2 Years From Approval
Date Unless Drilling Underway**

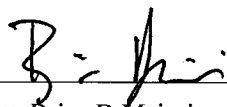
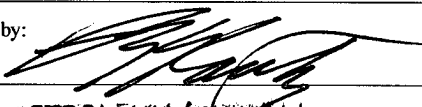
²³ I hereby certify that the information given above is true and complete to the best of my knowledge and belief.	OIL CONSERVATION DIVISION	
Signature: 	Approved by: 	
Printed name: Brian D Maiorino	Title: PETROLEUM ENGINEER	
Title: Regulatory Specialist	Approval Date: MAY 26 2011	Expiration Date:
E-mail Address: brian.d.maiorino@conocophilips.com		
Date: 05/18/2011	Phone: (432)688-6913	Conditions of Approval Attached <input type="checkbox"/>

DISTRICT I
1025 N. French Dr., Hobbs, NM 88240

DISTRICT II
1301 W. Grand Avenue, Artesia, NM 88210

DISTRICT III
1000 Rio Brazos Rd., Artesia, NM 87410

DISTRICT IV
1220 S. St. Francis Dr., Santa Fe, NM 87505

State of New Mexico
Energy, Minerals & Natural Resources Department

OIL CONSERVATION DIVISION
1220 South St. Frances Dr.
Santa Fe, NM 87505

Form C-102
Revised October 12, 2005
Submit to Appropriate District Office
State Lease - 4 Copies
Fee Lease - 3 Copies

☐ AMENDED REPORT

WELL LOCATION AND ACREAGE DEDICATION PLAT

API Number 30-025-40149	Pool Code 44500	Pool Name Maljman, Yeso, West
Property Code 38238 38251	Property Name AQUAMARINE STATE	Well Number 3
OGRID No. 217817	Operator Name CONOCOPHILLIPS	Elevation 4016'

Surface Location

UL or lot No.	Section	Township	Range	Lot Idn	Feet from the	North/South line	Feet from the	East/West line	County
P	16	17 S	32 E		330	SOUTH	820	EAST	LEA

Bottom Hole Location If Different From Surface

UL or lot No.	Section	Township	Range	Lot Idn	Feet from the	North/South line	Feet from the	East/West line	County

Dedicated Acres	Joint or Infill	Consolidation Code	Order No.

NO ALLOWABLE WILL BE ASSIGNED TO THIS COMPLETION UNTIL ALL INTERESTS HAVE BEEN CONSOLIDATED OR A NON-STANDARD UNIT HAS BEEN APPROVED BY THE DIVISION

<p>NOTE:</p> <p>1) Plane Coordinates shown hereon are Transverse Mercator Grid and Conform to the "New Mexico Coordinate System", New Mexico East Zone, North American Datum of 1927. Distances shown hereon are mean horizontal surface values.</p>				
				<p>Plane Coordinate X = 674,572.2 Y = 665,465.2</p> <p>4016.3' 4017.6' 330' 820' 4016.8' 4009.2'</p>
				<p>OPERATOR CERTIFICATION</p> <p>I hereby certify the information contained herein to be true and complete to the best of my knowledge and belief, and that this organization either owns a working interest or undivided mineral interest in the land including the proposed bottom hole location or has a right to drill this well at this location pursuant to a contract with an owner of such a mineral or working interest, or to a voluntary pooling agreement or a compulsory pooling order heretofore entered by the division.</p> <p><u>B. J. ...</u> 5/25/11 Signature Date <u>Brian D. Malone</u> Printed Name</p>
				<p>SURVEYOR CERTIFICATION</p> <p>I hereby certify that the well location shown on this plat was plotted from field notes of actual surveys made by me or under my supervision and that the same is true and correct to the best of my belief.</p> <p>April 15, 2011 Date of Survey Signature & Seal of Professional Surveyor <u>[Signature]</u> W.O. Num. 2011-0527 Certificate No. MACON McDONALD 12185</p>

Aquamarine # 3

15. Proposed Depth = 7200' MD RKB

19. Proposed Casing and Cement Program						
Type	Hole Size (inches)	Casing OD (inches)	Casing Wt (lb/ft)	Setting Depth (feet)	Sacks of Cement	Estimated TOC (feet)
Surface	12.25	8.625	24	850	400	0
Prod	7.875	5.5	17	7190	1000	0

Casing and Cement Program: Additional Comments	
Fresh Water and Fresh Water Mud will be used for drilling the surface hole.	
Brine and Brine Based Mud will be used for drilling the production hole.	

Proposed Blowout Prevention Program			
Type	Working Pressure	Test Pressure	Manufacturer
Annular	2000	1000	
Blind Ram	2000	2000	
Pipe Ram	2000	2000	



NORTHERLY VIEW TO LOCATION STAKE

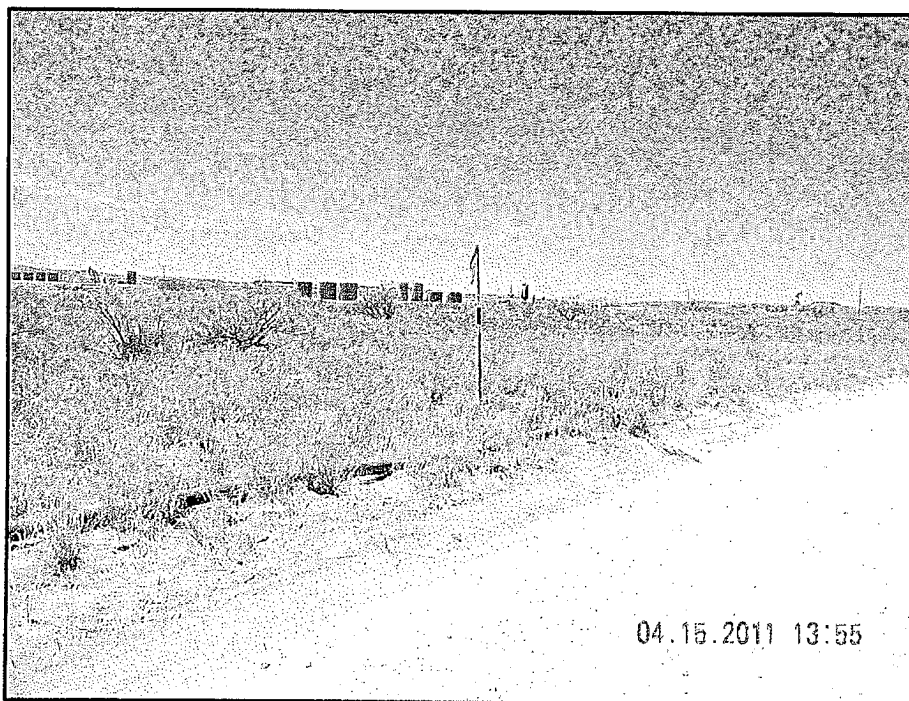

WESTERLY VIEW TO LOCATION STAKE

ConocoPhillips

AQUAMARINE STATE #3

Located 330' FSL & 820' FEL, Section 16
Township 17 South, Range 32 East, N.M.P.M.
Lea County, New Mexico

Drawn By: KHY

Date: May 24, 2011

**WEST
COMPANY**
of Midland, Inc.

110 W. LOUISIANA, STE. 110
MIDLAND TEXAS, 79701
(432) 687-0865 - (432) 687-0868 FAX

SECTION 16, TOWNSHIP 17 SOUTH, RANGE 32 EAST, N.M.P.M.

LEA COUNTY

NEW MEXICO

THIS IS NOT A BOUNDARY SURVEY
Apparent property corners and property lines, if shown,
are for information only.

L-2011-0527-A

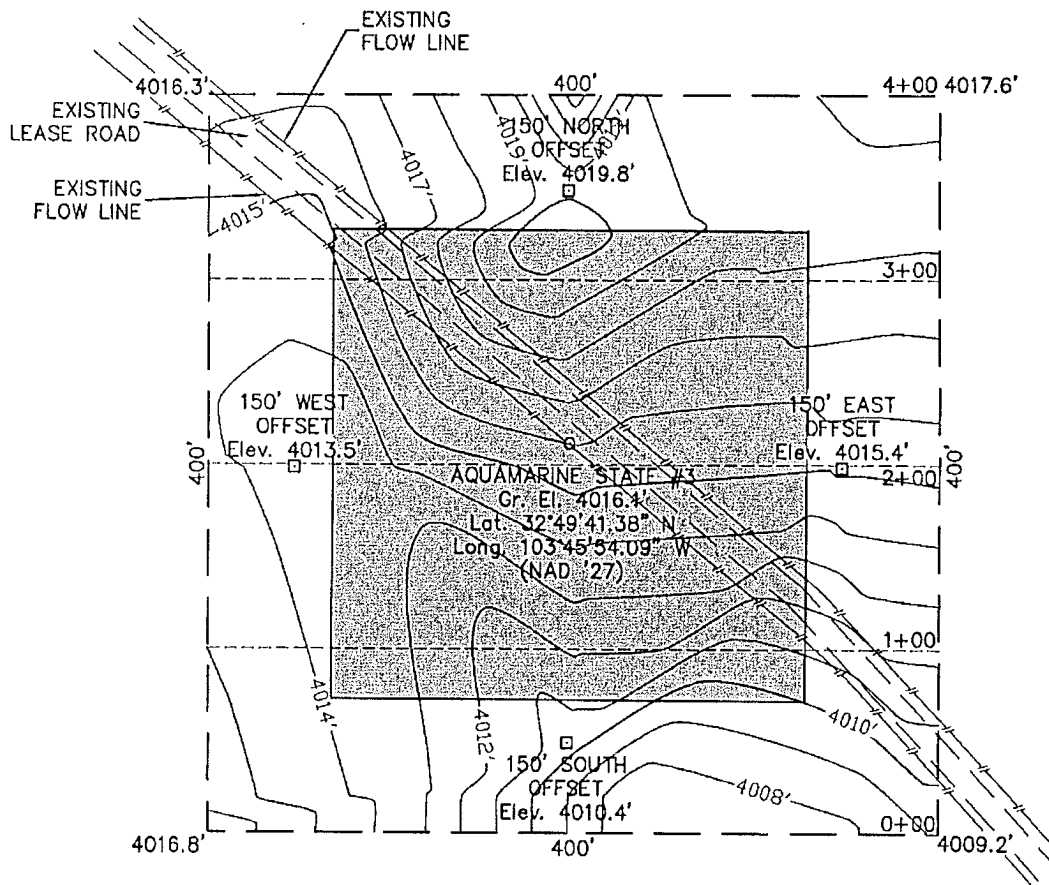

DRIVING DIRECTIONS

FROM THE INTERSECTION OF STATE HIGHWAY 82 AND COUNTY ROAD IN MALJAMAR, NM. GO SOUTH ON SAID COUNTY ROAD 126 2.0 MILES TO A LEASE ROAD ON WEST (RIGHT) SIDE OF ROAD, THEN GO WEST 0.1 MILE, THEN GO NORTHWEST (RIGHT) 0.1 MILE TO THE PROPOSED LOCATION.

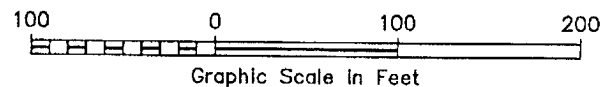

I HEREBY CERTIFY THAT THIS PLAT WAS MADE FROM AN ACTUAL SURVEY MADE BY ME OR UNDER MY DIRECT SUPERVISION AND THAT THE SAME IS TRUE AND CORRECT TO THE BEST OF MY KNOWLEDGE AND BELIEF.

MACON McDONALD

PLS. NO. 12185

ConocoPhillips

Topographic Map

AQUAMARINE STATE #3

Located 330' FSL & 820' FEL, Section 16
Township 17 South, Range 32 East, N.M.P.M.
Lea County, New Mexico

Drawn By: KHY	Date: May 24, 2011
Scale: 1" = 100'	Field Book: 518 / 8-10
Sheet 1 of 3	Quadrangle: Maljamar
W.O. No: 2011-0527	Dwg. No.: L-2011-0527-A



110 W. LOUISIANA, STE. 110
MIDLAND TEXAS, 79701
(432) 687-0865 - (432) 687-0868 FAX

SECTION 16, TOWNSHIP 17 SOUTH, RANGE 32 EAST, N.M.P.M.

LEA COUNTY

NEW MEXICO

THIS IS NOT A BOUNDARY SURVEY
Apparent property corners and property lines, if shown,
are for information only.

L-2011-0527-B

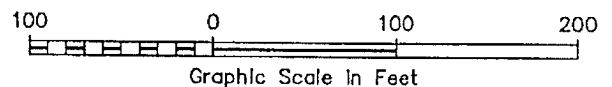
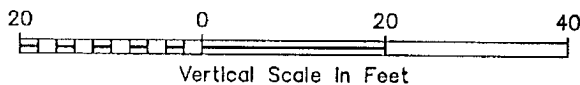
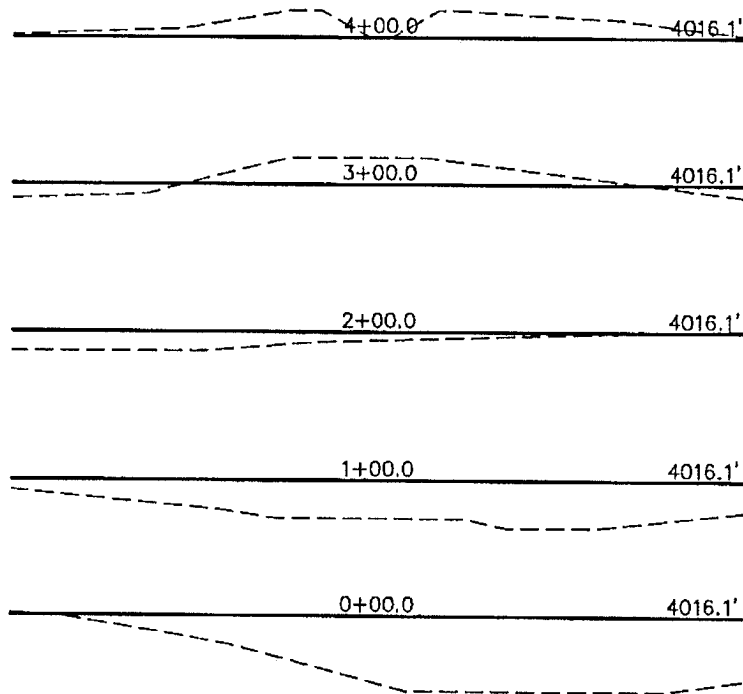

I HEREBY CERTIFY THAT THIS PLAT WAS MADE FROM
AN ACTUAL SURVEY MADE BY ME OR UNDER MY DIRECT
SUPERVISION AND THAT THE SAME IS TRUE AND CORRECT
TO THE BEST OF MY KNOWLEDGE AND BELIEF.

[Signature]

MACON McDONALD

PLS NO. 12185

ConocoPhillips

Topographic Map

AQUAMARINE STATE #3

Located 330' FSL & 820' FEL, Section 16
Township 17 South, Range 32 East, N.M.P.M.
Lea County, New Mexico

Drawn By: KHY	Date: May 24, 2011
Scale: 1" = 100'	Field Book: 518 / 8-10
Sheet 2 of 3	Quadrangle: Maljamar
W.O. No: 2011-0527	Dwg. No.: L-2011-0527-B

**WEST
COMPANY**
of Midland, Inc.

110 W. LOUISIANA, STE. 110
MIDLAND TEXAS, 79701
(432) 687-0865 - (432) 687-0868 FAX

SECTION 16, TOWNSHIP 17 SOUTH, RANGE 32 EAST, N.M.P.M.

LEA COUNTY

THIS IS NOT A BOUNDARY SURVEY
Apparent property corners and property lines, if shown,
are for information only.

NEW MEXICO

L-2011-0527-C

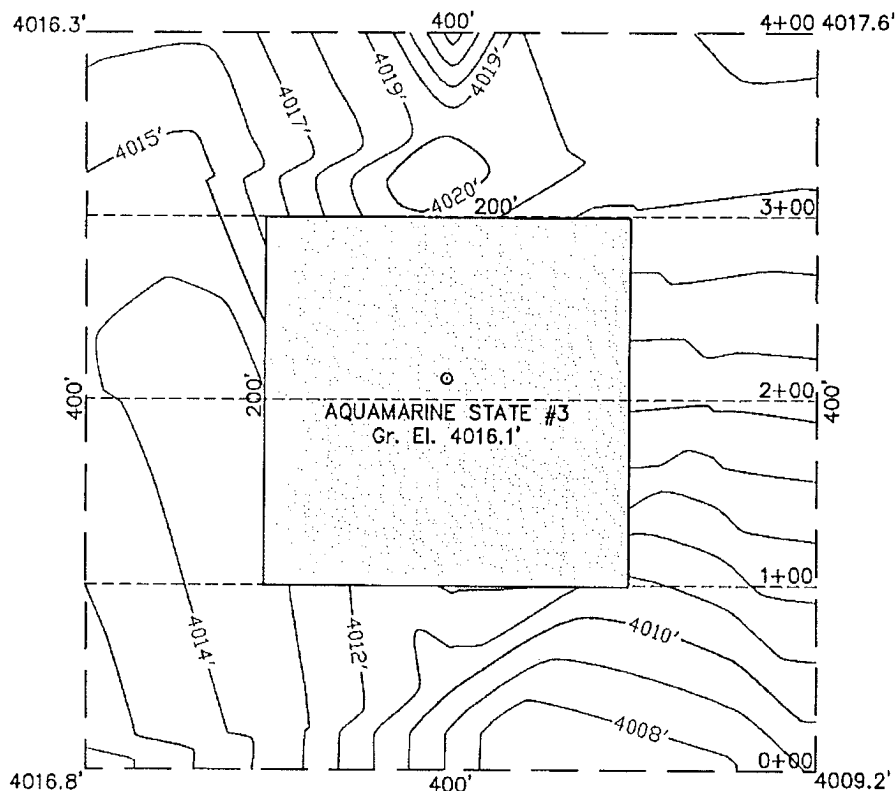

INTERIM RECLAMATION

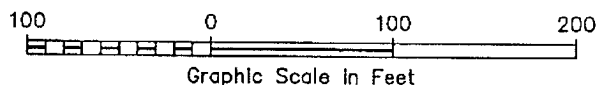

I HEREBY CERTIFY THAT THIS PLAT WAS MADE FROM
AN ACTUAL SURVEY MADE BY ME OR UNDER MY DIRECT
SUPERVISION AND THAT THE SAME IS TRUE AND CORRECT
TO THE BEST OF MY KNOWLEDGE AND BELIEF.

MACON McDONALD
MACON McDONALD
PLS NO. 12185

ConocoPhillips

Topographic Map

AQUAMARINE STATE #3

Located 330' FSL & 820' FEL, Section 16
Township 17 South, Range 32 East, N.M.P.M.
Lea County, New Mexico

Drawn By: KHY	Date: May 24, 2011
Scale: 1" = 100'	Field Book: 518 / 8-10
Sheet 3 of 3	Quadrangle: Maljamar
W.O. No: 2011-0527	Dwg. No.: L-2011-0527-C

WEST
COMPANY
of Midland, Inc.

110 W. LOUISIANA, STE. 110
MIDLAND TEXAS, 79701
(432) 687-0865 - (432) 687-0868 FAX

LOCATION VERIFICATION MAP



SCALE: 1" = 2000'

CONTOUR INTERVAL:
MALJAMAR - 10'

SEC. 16 TWP. 17-S RGE. 32-E

SURVEY N.M.P.M.

COUNTY LEA

DESCRIPTION 330' FSL & 820' FEL

ELEVATION 4016'

OPERATOR CONOCOPHILLIPS

LEASE AQUAMARINE STATE

U.S.G.S. TOPOGRAPHIC MAP
MALJAMAR



**WEST
COMPANY**
of Midland, Inc.

110 W. LOUISIANA, STE. 110
MIDLAND TEXAS, 79701
(432) 687-0865 ~ (432) 687-0868 FAX

VICINITY MAP

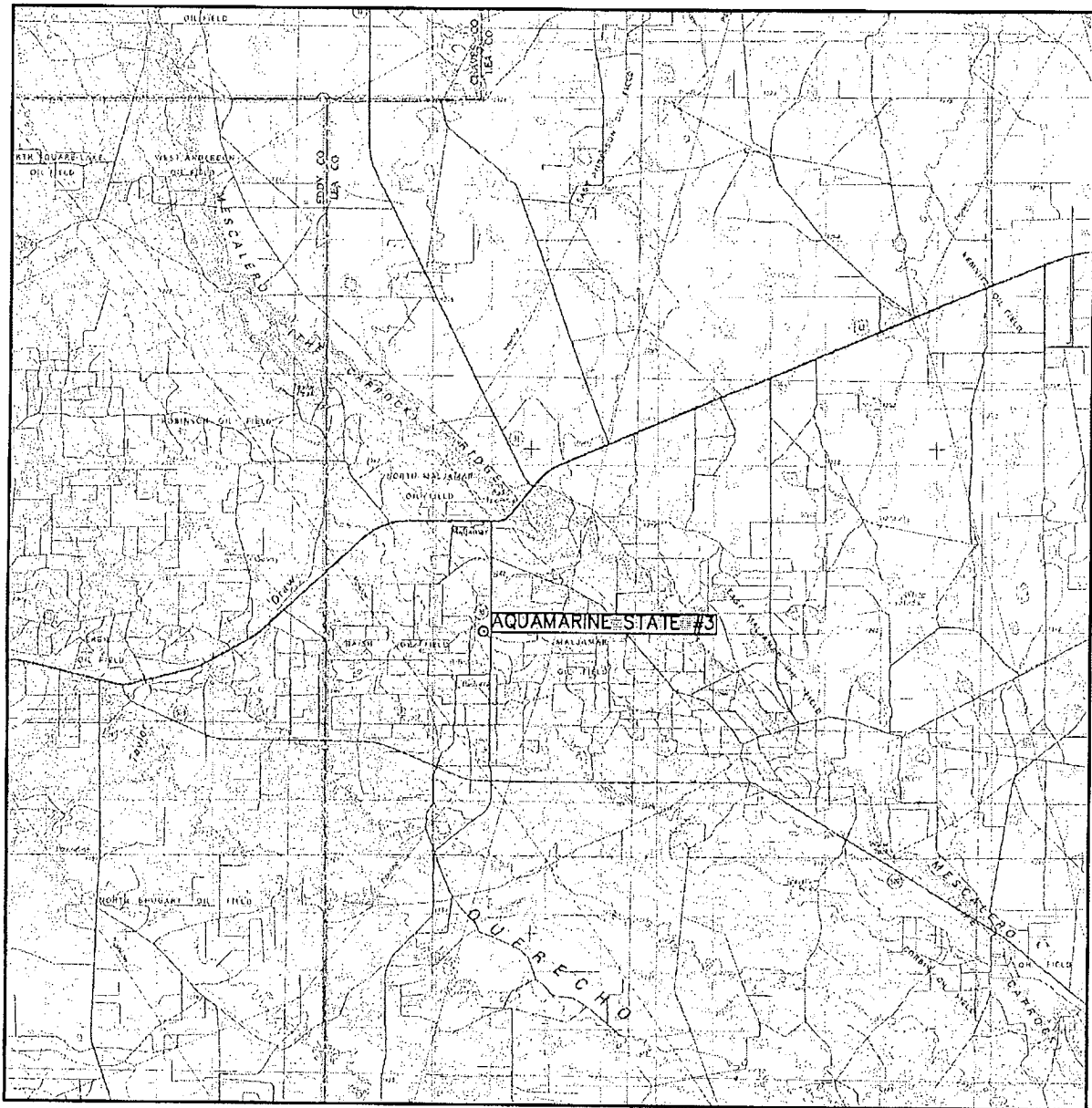

SCALE: 1" = 3 MILES

SEC. 16 TWP. 17-S RGE. 32-E

SURVEY N.M.P.M.

COUNTY LEA

DESCRIPTION 330' FSL & 820' FEL

ELEVATION 4016'

OPERATOR CONOCOPHILLIPS

LEASE AQUAMARINE STATE



110 W. LOUISIANA, STE. 110
MIDLAND TEXAS, 79701
(432) 687-0865 - (432) 687-0868 FAX