

Submit 1 Copy To Appropriate District
Office
District I
1625 N. French Dr., Hobbs, NM 88240
District II
1301 W. Grand Ave., Artesia, NM 88210
District III
1000 Rio Brazos Rd., Aztec, NM 87410
District IV
1220 S. St. Francis Dr., Santa Fe, NM
87505

State of New Mexico
Energy, Minerals and Natural Resources

Form C-103
October 13, 2009

OIL CONSERVATION DIVISION
1220 South St. Francis Dr.
Santa Fe, NM 87505

WELL API NO. 30-025-40149	
5. Indicate Type of Lease STATE <input checked="" type="checkbox"/> FEE <input type="checkbox"/>	
6. State Oil & Gas Lease No.	
7. Lease Name or Unit Agreement Name Aquamarine State	
8. Well Number 3	
9. OGRID Number 217817	
10. Pool name or Wildcat Maljamar; Yeso, West	
11. Elevation (Show whether DR, RKB, RT, GR, etc.) 4016' Gr	

RECEIVED
SUNDRY NOTICES AND REPORTS ON WELLS
(DO NOT USE THIS FORM FOR PROPOSALS TO DRILL OR TO DEEPEN OR PLUG BACK TO A
DIFFERENT RESERVOIR. USE "APPLICATION FOR PERMIT" (FORM C-101) FOR SUCH
PROPOSALS.)

1. Type of Well: Oil Well ☒ Gas Well ☐ Other

2. Name of Operator
ConocoPhillips Company

3. Address of Operator 3300 N "A" St, Bldg 6
Midland, TX 79705

4. Well Location
Unit Letter **P** : **330** feet from the **South** line and **820** feet from the **East** line
Section **16** Township **17S** Range **32E** NMPM County **Lea**

12. Check Appropriate Box to Indicate Nature of Notice, Report or Other Data

NOTICE OF INTENTION TO:

PERFORM REMEDIAL WORK ☐ PLUG AND ABANDON ☐
TEMPORARILY ABANDON ☐ CHANGE PLANS ☐
PULL OR ALTER CASING ☐ MULTIPLE COMPL ☐
DOWNHOLE COMMINGLE ☐

OTHER: ☐

SUBSEQUENT REPORT OF:

REMEDIAL WORK ☐ ALTERING CASING ☐
COMMENCE DRILLING OPNS. ☐ P AND A ☐
CASING/CEMENT JOB ☐

OTHER: New Survey and Plat ☒

13. Describe proposed or completed operations. (Clearly state all pertinent details, and give pertinent dates, including estimated date of starting any proposed work). SEE RULE 19.15.7.14 NMAC. For Multiple Completions: Attach wellbore diagram of proposed completion or recompletion.

*Attached new plat and survey to replace former plat and survey with incorrect footages.

Spud Date:

Rig Release Date:

I hereby certify that the information above is true and complete to the best of my knowledge and belief.

SIGNATURE

TITLE Regulatory Specialist

DATE 05/25/2011

Type or print name Brian D Maiorino

E-mail address: brian.d.maiorino@conocophillips.com PHONE: (432)688-6913

For State Use Only

APPROVED BY:

TITLE

PETROLEUM ENGINEER

DATE

MAY 27 2011

Conditions of Approval (if any):

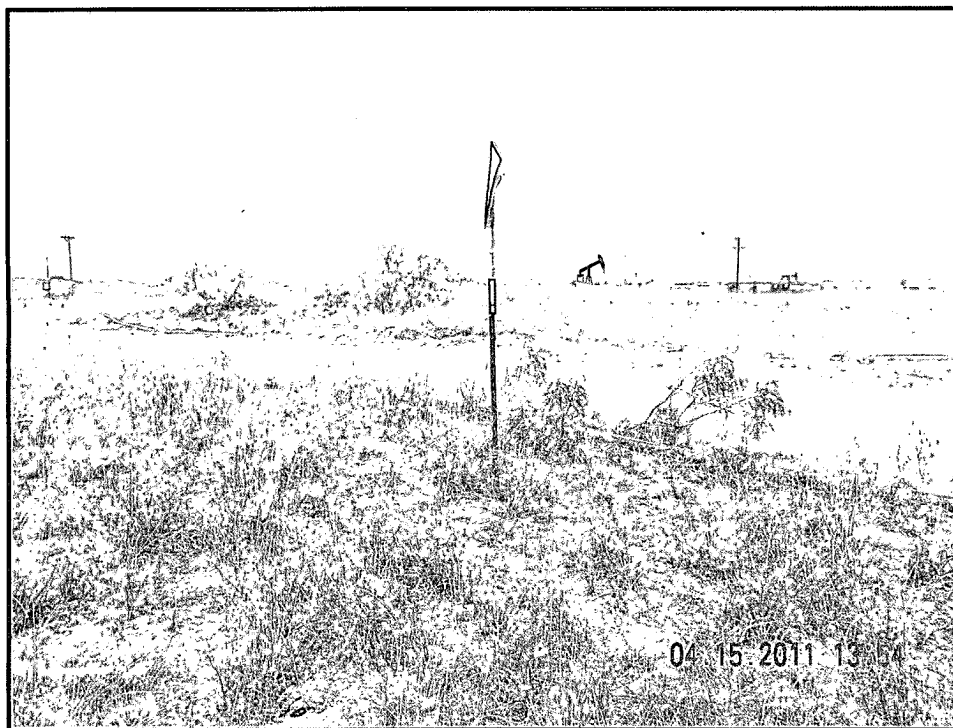

NORTHERLY VIEW TO LOCATION STAKE

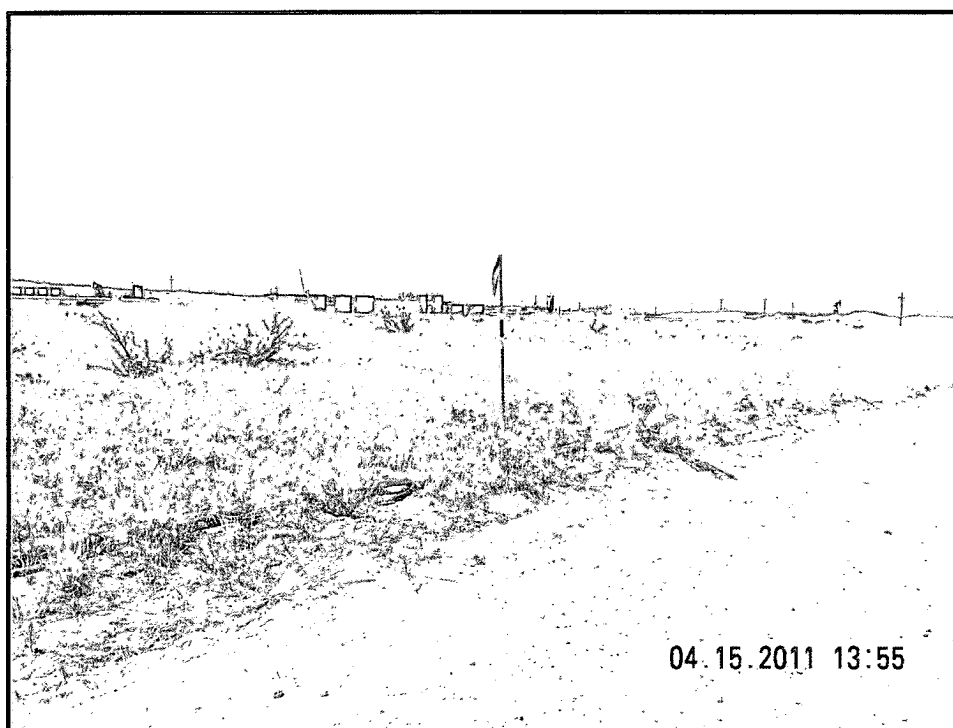

WESTERLY VIEW TO LOCATION STAKE

ConocoPhillips

AQUAMARINE STATE #3

Located 330' FSL & 820' FEL, Section 16
Township 17 South, Range 32 East, N.M.P.M.
Lea County, New Mexico

**WEST
COMPANY**
of Midland, Inc.

110 W. LOUISIANA, STE. 110
MIDLAND TEXAS, 79701
(432) 687-0865 - (432) 687-0868 FAX

Drawn By: KHY

Date: May 24, 2011

[illegible]

SECTION 16, TOWNSHIP 17 SOUTH, RANGE 32 EAST, N.M.P.M.

LEA COUNTY

NEW MEXICO

THIS IS NOT A BOUNDARY SURVEY
Apparent property corners and property lines, if shown,
are for information only.

L-2011-0527-A

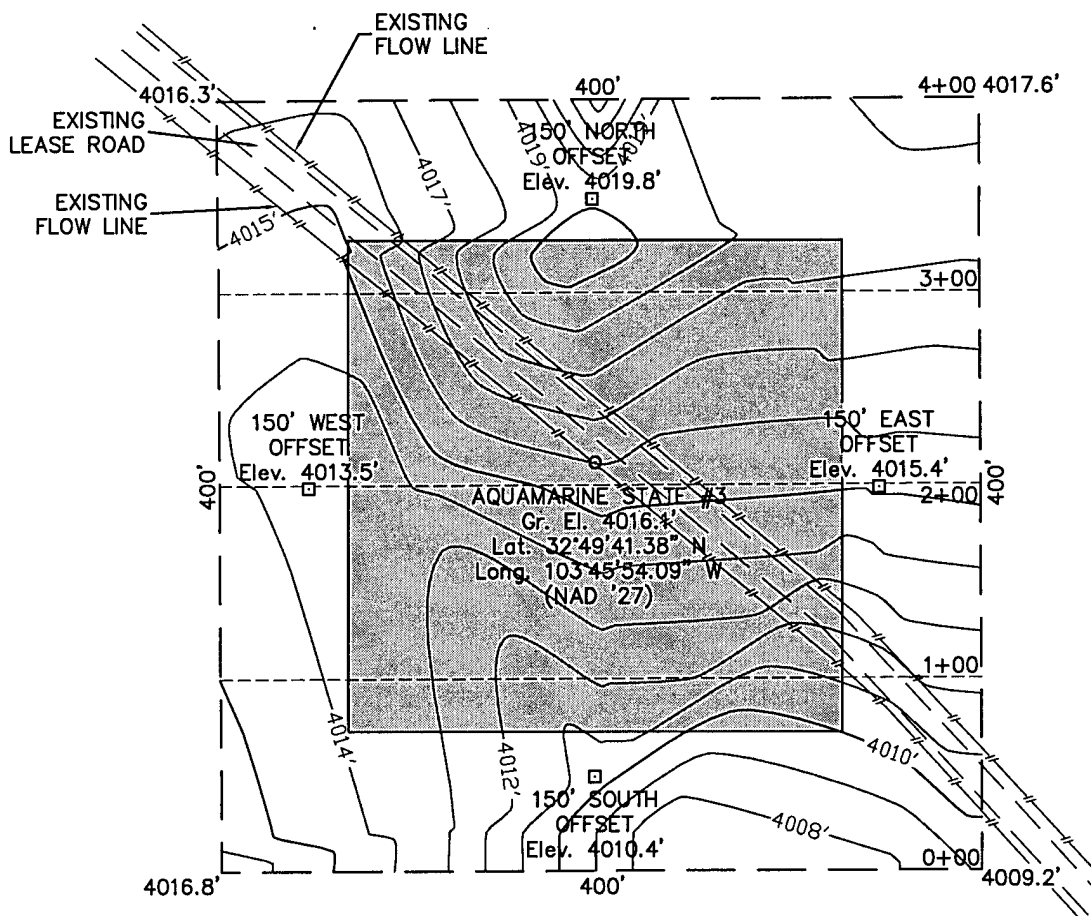

DRIVING DIRECTIONS

FROM THE INTERSECTION OF STATE HIGHWAY 82 AND COUNTY ROAD IN MALJAMAR, NM. GO SOUTH ON SAID COUNTY ROAD 126 2.0 MILES TO A LEASE ROAD ON WEST (RIGHT) SIDE OF ROAD, THEN GO WEST 0.1 MILE, THEN GO NORTHWEST (RIGHT) 0.1 MILE TO THE PROPOSED LOCATION.



I HEREBY CERTIFY THAT THIS PLAT WAS MADE FROM AN ACTUAL SURVEY MADE BY ME OR UNDER MY DIRECT SUPERVISION AND THAT THE SAME IS TRUE AND CORRECT TO THE BEST OF MY KNOWLEDGE AND BELIEF.

MACON McDONALD

RLS NO. 12185

ConocoPhillips

Topographic Map

AQUAMARINE STATE #3

Located 330' FSL & 820' FEL, Section 16
Township 17 South, Range 32 East, N.M.P.M.
Lea County, New Mexico

Drawn By: KHY

Date: May 24, 2011

Scale: 1" = 100'

Field Book: 518 / 8-10

Sheet 1 of 3

Quadrangle: Maljamar

W.O. No: 2011-0527

Dwg. No.: L-2011-0527-A

WEST
COMPANY
of Midland, Inc.

110 W. LOUISIANA, STE. 110
MIDLAND TEXAS, 79701
(432) 687-0865 - (432) 687-0868 FAX

SECTION 16, TOWNSHIP 17 SOUTH, RANGE 32 EAST, N.M.P.M.

LEA COUNTY

NEW MEXICO

THIS IS NOT A BOUNDARY SURVEY
Apparent property corners and property lines, if shown,
are for information only.

L-2011-0527-B

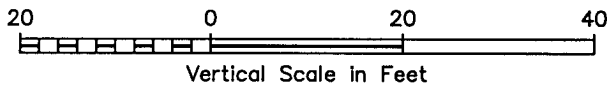
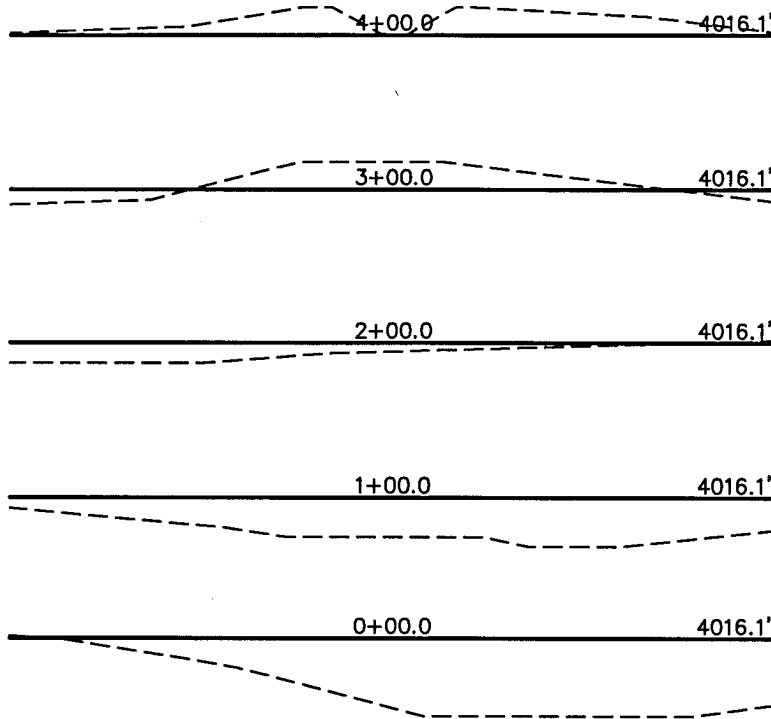

I HEREBY CERTIFY THAT THIS PLAT WAS MADE FROM AN ACTUAL SURVEY MADE BY ME OR UNDER MY DIRECT SUPERVISION AND THAT THE SAME IS TRUE AND CORRECT TO THE BEST OF MY KNOWLEDGE AND BELIEF.

[Signature]

MACON McDONALD

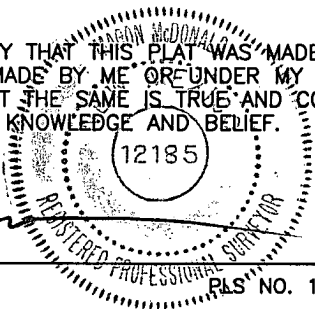

PLS NO. 12185

ConocoPhillips

Topographic Map

AQUAMARINE STATE #3

Located 330' FSL & 820' FEL, Section 16
Township 17 South, Range 32 East, N.M.P.M.
Lea County, New Mexico

Drawn By: KHY	Date: May 24, 2011
Scale: 1" = 100'	Field Book: 518 / 8-10
Sheet 2 of 3	Quadrangle: Maljamar
W.O. No: 2011-0527	Dwg. No.: L-2011-0527-B

WEST
COMPANY
of Midland, Inc.

110 W. LOUISIANA, STE. 110
MIDLAND TEXAS, 79701
(432) 687-0865 - (432) 687-0868 FAX

SECTION 16, TOWNSHIP 17 SOUTH, RANGE 32 EAST, N.M.P.M.

LEA COUNTY

THIS IS NOT A BOUNDARY SURVEY
Apparent property corners and property lines, if shown,
are for information only.

NEW MEXICO

L-2011-0527-C

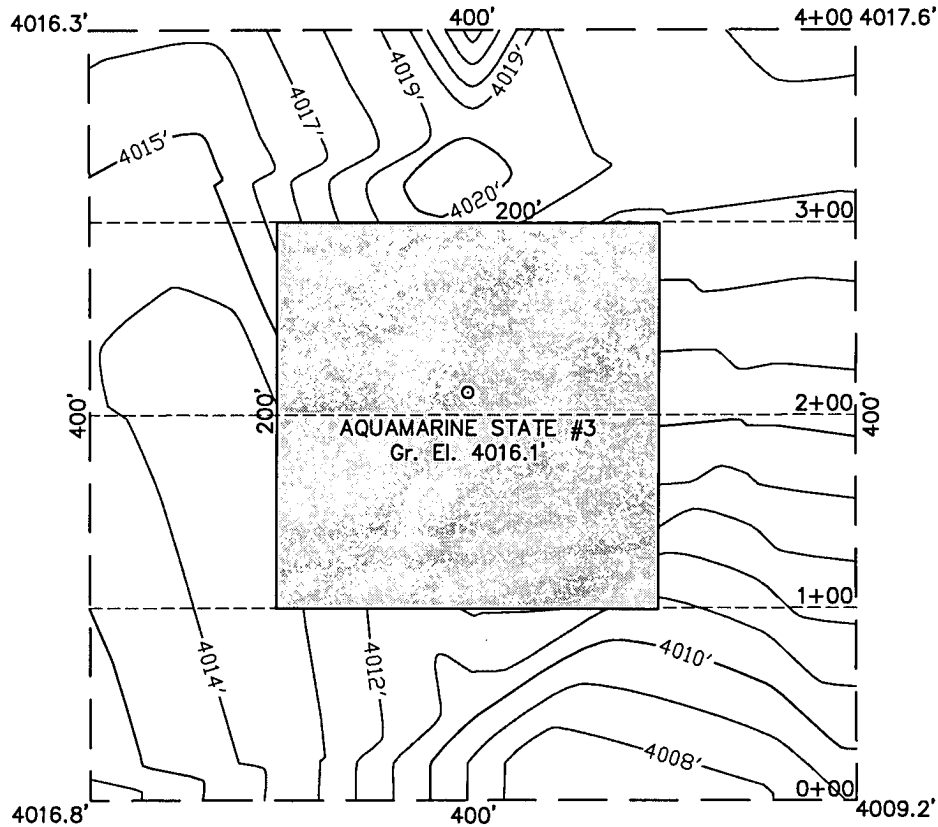

INTERIM RECLAMATION

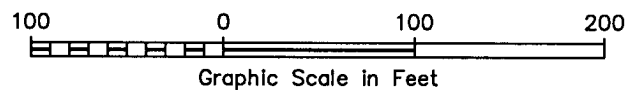

I HEREBY CERTIFY THAT THIS PLAT WAS MADE FROM
AN ACTUAL SURVEY MADE BY ME OR UNDER MY DIRECT
SUPERVISION AND THAT THE SAME IS TRUE AND CORRECT
TO THE BEST OF MY KNOWLEDGE AND BELIEF.

[Signature]

MACON McDONALD

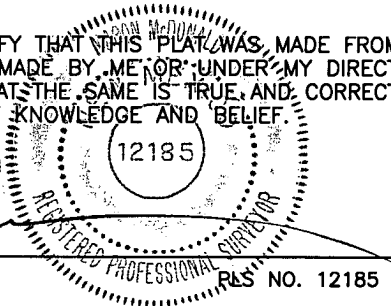

R/S NO. 12185

ConocoPhillips

Topographic Map

AQUAMARINE STATE #3

Located 330' FSL & 820' FEL, Section 16
Township 17 South, Range 32 East, N.M.P.M.
Lea County, New Mexico

Drawn By: KHY

Date: May 24, 2011

Scale: 1" = 100'

Field Book: 518 / 8-10

Sheet 3 of 3

Quadrangle: Maljamar

W.O. No: 2011-0527

Dwg. No.: L-2011-0527-C

WEST
COMPANY
of Midland, Inc.

110 W. LOUISIANA, STE. 110
MIDLAND TEXAS, 79701
(432) 687-0865 - (432) 687-0868 FAX

LOCATION VERIFICATION MAP

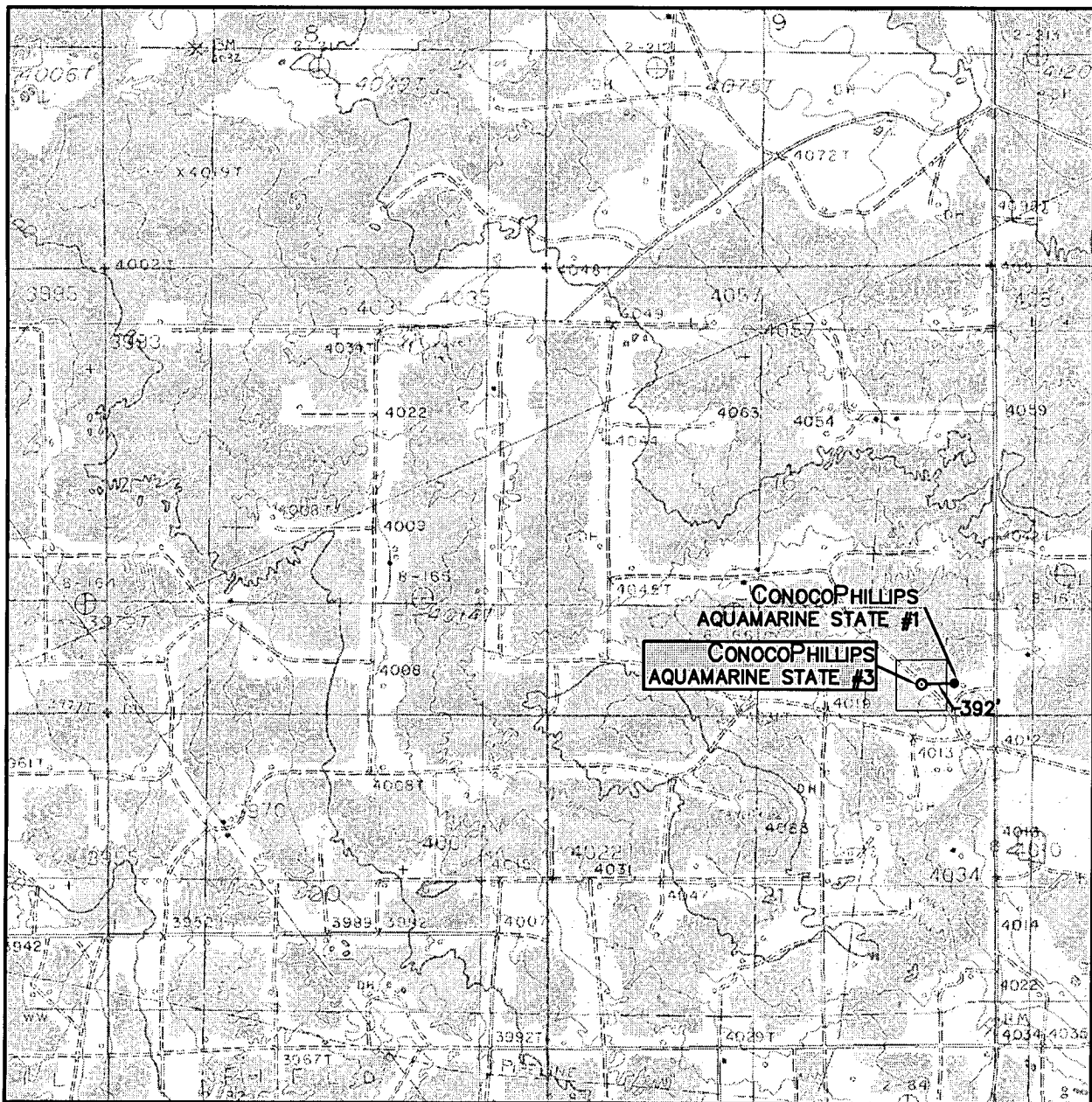

SCALE: 1" = 2000'

CONTOUR INTERVAL:
MALJAMAR - 10'

SEC. 16 TWP. 17-S RGE. 32-E

SURVEY N.M.P.M.

COUNTY LEA

DESCRIPTION 330' FSL & 820' FEL

ELEVATION 4016'

OPERATOR CONOCOPHILLIPS

LEASE AQUAMARINE STATE

U.S.G.S. TOPOGRAPHIC MAP
MALJAMAR



**WEST
COMPANY**
of Midland, Inc.

110 W. LOUISIANA, STE. 110
MIDLAND TEXAS, 79701
(432) 687-0865 - (432) 687-0868 FAX

VICINITY MAP

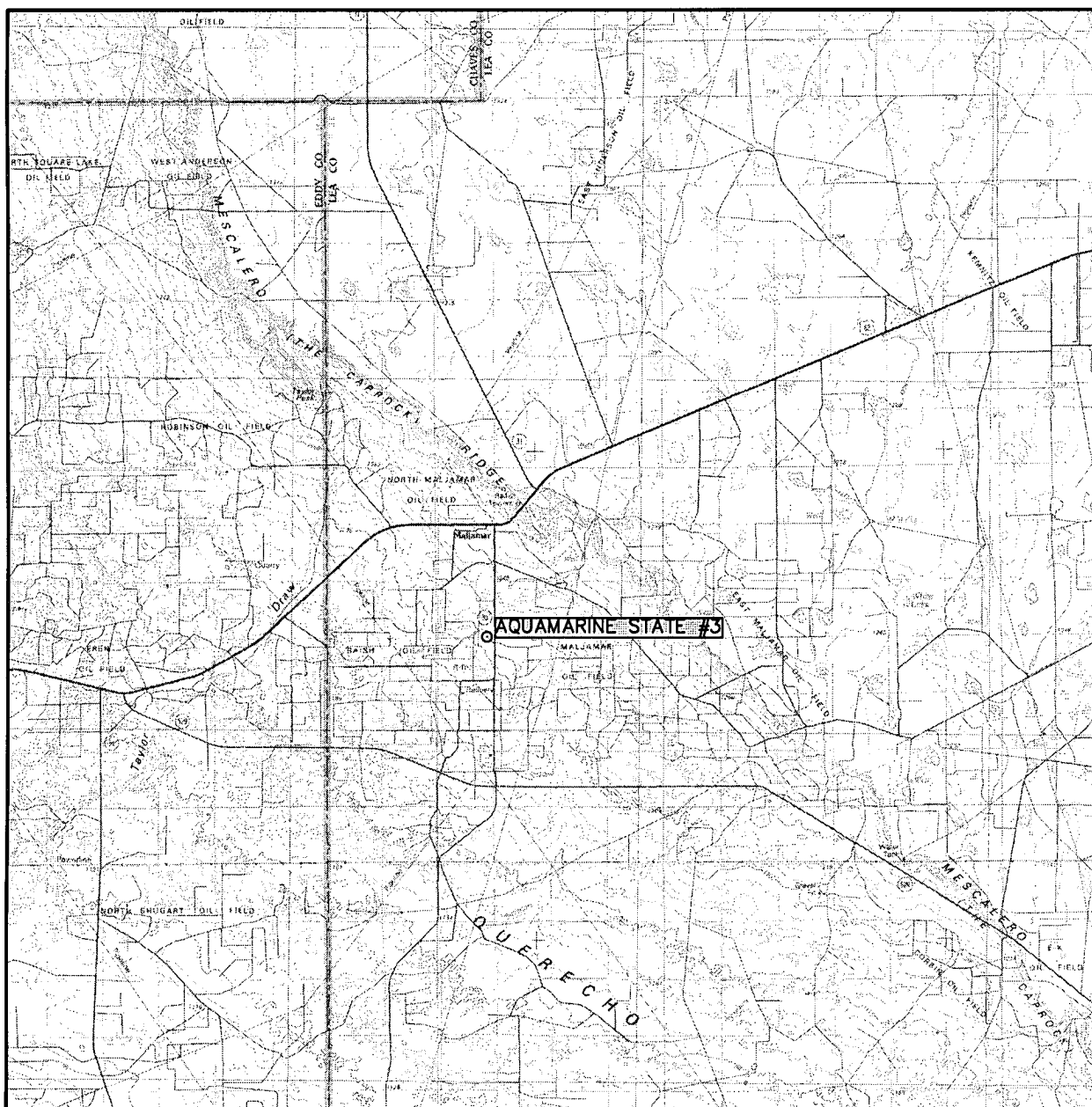

SCALE: 1" = 3 MILES

SEC. 16 TWP. 17-S RGE. 32-E

SURVEY N.M.P.M.

COUNTY LEA

DESCRIPTION 330' FSL & 820' FEL

ELEVATION 4016'

OPERATOR CONOCOPHILLIPS

LEASE AQUAMARINE STATE



**WEST
COMPANY**
of Midland, Inc.

110 W. LOUISIANA, STE. 110
MIDLAND TEXAS, 79701
(432) 687-0865 - (432) 687-0868 FAX