

District I  
1625 N. French Dr., Hobbs, NM 88240  
District II  
1301 W. Grand Avenue, Artesia, NM 88210  
District III  
1000 Rio Brazos Road, Aztec, NM 87410  
District IV  
1220 S. St. Francis Dr., Santa Fe, NM 87505

State of New Mexico  
Energy Minerals and Natural Resources

Oil Conservation Division  
1220 South St. Francis Dr.  
Santa Fe, NM 87505

Form C-101  
Revised March 17, 1999

Submit to appropriate District Office  
State Lease - 6 Copies  
Fee Lease - 5 Copies

☐ AMENDED REPORT

**APPLICATION FOR PERMIT TO DRILL, RE-ENTER, DEEPEN, PLUGBACK, OR ADD A ZONE**

<sup>1</sup> Operator Name and Address <b>Devon Energy Production Company, LP 20 North Broadway Oklahoma City, OK 73102-8260</b>		<sup>2</sup> OGRID Number <b>6137</b>
		<sup>3</sup> API Number <b>30-005-36644</b>
<sup>3</sup> Property Code <b>29408</b>	<sup>5</sup> Property Name <b>Keller 4 State</b>	<sup>6</sup> Well No. <b>2</b>

<sup>7</sup> Surface Location

UL or lot no.	Section	Township	Range	Lot Idn	Feet from the	North/South line	Feet from the	East/West line	County
<b>1E</b>	<b>4</b>	<b>23S</b>	<b>35E</b>		<b>1420</b>	<b>North</b>	<b>660</b>	<b>West</b>	<b>Lea</b>

<sup>8</sup> Proposed Bottom Hole Location If Different From Surface

UL or lot no.	Section	Township	Range	Lot Idn	Feet from the	North/South line	Feet from the	East/West line	County

<sup>9</sup> Proposed Pool 1

**Wildcat**

<sup>10</sup> Proposed Pool 2

<sup>11</sup> Work Type Code <b>N</b>	<sup>12</sup> Well Type Code <b>G</b>	<sup>13</sup> Cable/Rotary <b>R</b>	<sup>14</sup> Lease Type Code <b>S</b>	<sup>15</sup> Ground Level Elevation <b>5536'</b>
<sup>16</sup> Multiple <b>No</b>	<sup>17</sup> Proposed Depth <b>14,200</b>	<sup>18</sup> Formation <b>Morrow</b>	<sup>19</sup> Contractor	<sup>20</sup> Spud Date <b>04/15/04</b>

<sup>21</sup> Proposed Casing and Cement Program

Hole Size	Casing Size	Casing weight/foot	Setting Depth	Sacks of Cement	Estimated TOC
<b>17 1/2"</b>	<b>13 3/8"</b>	<b>54.5</b>	<b>1,100'</b>	<b>650</b>	<b>Surface</b>
<b>12 1/4"</b>	<b>9 5/8"</b>	<b>40</b>	<b>5,400</b>	<b>1000</b>	<b>1000'</b>
<b>8 3/4"</b>	<b>7</b>	<b>26</b>	<b>12,000'</b>	<b>500</b>	<b>9000'</b>
<b>6 1/8"</b>	<b>4 1/2" Liner</b>	<b>13.5</b>	<b>14,200'</b>	<b>250</b>	<b>11,700</b>

<sup>22</sup> Describe the proposed program. If this application is to DEEPEN or PLUG BACK, give the data on the present productive zone and proposed new productive zone. Describe the blowout prevention program, if any. Use additional sheets if necessary.

Devon Energy Production Company, LP plans to drill this well to a total depth of 14,200' and complete as a Morrow gas well. Should the well be deemed noncommercial, then it will be plugged and abandoned in accordance with the rules established by the New Mexico Oil Conservation Division. An APD for this well was approved on February 11, 2002, extended on Feb 01, 2003 and expired on February 01, 2004. Due to scheduling conflicts we were unable to drill this well, but currently have plans to do so.

<sup>23</sup> I hereby certify that the information given above is true and complete to the best of my knowledge and belief.		<b>OIL CONSERVATION DIVISION</b>	
Signature: <i>Linda Guthrie</i>		Approved by: <i>Paul J. [Signature]</i>	
Printed name: <b>Linda Guthrie</b>		Title: <b>PETROLEUM ENGINEER</b>	
Title: <b>Operations Associate</b>		Approval Date: <b>MAR 24 2004</b>	Expiration Date:
Date: <b>03/10/04</b>	Phone: <b>405 228-8209</b>	Conditions of Approval: <input type="checkbox"/> Attached <input type="checkbox"/>	

DISTRICT I  
1625 N. French Dr., Hobbs, NM 88240

DISTRICT II  
811 South First, Artesia, NM 88210

DISTRICT III  
1000 Rio Brazos Rd., Aztec, NM 87410

DISTRICT IV  
2040 South Pacheco, Santa Fe, NM 87506

State of New Mexico  
Energy, Minerals and Natural Resources Department

Form C-102  
Revised March 17, 1999

Submit to Appropriate District Office  
State Lease - 4 Copies  
Fee Lease - 3 Copies

OIL CONSERVATION DIVISION

2040 South Pacheco  
Santa Fe, New Mexico 87504-2088

☐ AMENDED REPORT

WELL LOCATION AND ACREAGE DEDICATION PLAT

API Number <b>30-025-36644</b>	Pool Code <b>✓</b>	Pool Name <b>Wildcat</b>
Property Code <b>29408</b>	Property Name <b>KELLER "4" STATE</b>	Well Number <b>2</b>
OGRID No. <b>6137</b>	Operator Name <b>DEVON ENERGY PRODUCTION CO., L.P.</b>	Elevation <b>3536'</b>

Surface Location

UL or lot No.	Section	Township	Range	Lot Idn	Feet from the	North/South line	Feet from the	East/West line	County
<b>E</b>	<b>4</b>	<b>23 S</b>	<b>35 E</b>		<b>1420</b>	<b>NORTH</b>	<b>660</b>	<b>WEST</b>	<b>LEA</b>

Bottom Hole Location If Different From Surface

UL or lot No.	Section	Township	Range	Lot Idn	Feet from the	North/South line	Feet from the	East/West line	County
Dedicated Acres <b>320</b>	Joint or Infill	Consolidation Code	Order No.						

NO ALLOWABLE WILL BE ASSIGNED TO THIS COMPLETION UNTIL ALL INTERESTS HAVE BEEN CONSOLIDATED  
OR A NON-STANDARD UNIT HAS BEEN APPROVED BY THE DIVISION

	<p><b>OPERATOR CERTIFICATION</b></p> <p>I hereby certify the the information contained herein is true and complete to the best of my knowledge and belief.</p> <p><i>Karen Cottom</i> Signature</p> <p><b>Karen Cottom</b> Printed Name</p> <p><b>Engineering Technician</b> Title</p> <p><b>February 4, 2002</b> Date</p>
	<p><b>SURVEYOR CERTIFICATION</b></p> <p>I hereby certify that the well location shown on this plat was plotted from field notes of actual surveys made by me or under my supervision, and that the same is true and correct to the best of my belief.</p> <p><b>January 22, 2002</b> Date Surveyed</p> <p><i>GARY L JONES</i> Signature</p> <p><b>GARY L JONES</b> Printed Name</p> <p><b>Professional Surveyor</b> Title</p> <p><b>No. 2208</b> New Mexico State Surveyor License Number</p> <p><b>7977</b> Certificate Number</p> <p><b>BASIN SURVEYS</b> Professional Surveyor</p>

**MINIMUM CHOKE MANIFOLD**  
3,000, 5,000 and 10,000 PSI Working Pressure

**3 MWP - 5 MWP - 10 MWP**

EXHIBIT # 1

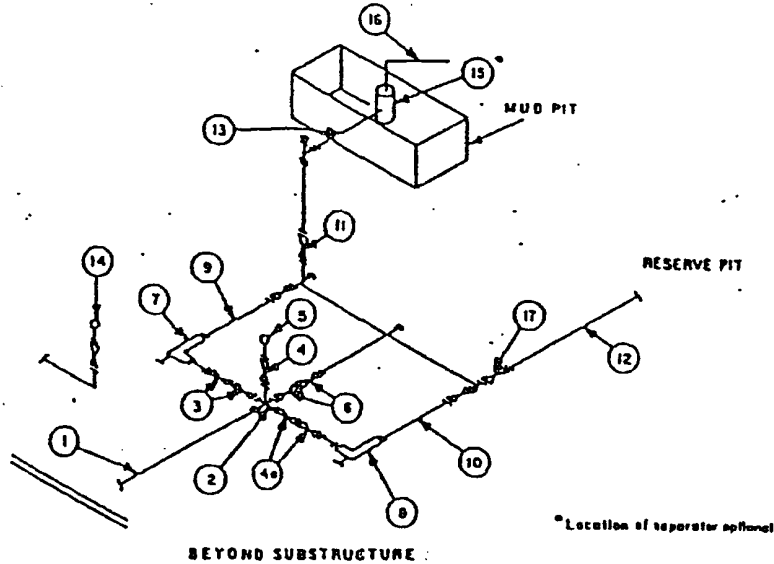

MINIMUM REQUIREMENTS										
No.		3,000 MWP			5,000 MWP			10,000 MWP		
		I.D.	NOMINAL	RATING	I.D.	NOMINAL	RATING	I.D.	NOMINAL	RATING
1	Line from drilling spool		3"	3,000		3"	5,000		3"	10,000
2	Cross 3"x3"x3"x2"			3,000			5,000			
	Cross 3"x3"x3"x3"									10,000
3	Valves (1) Gate <input type="checkbox"/> Plug <input type="checkbox"/> (2)	3-1/8"		3,000	3-1/8"		5,000	3-1/8"		10,000
4	Valve Gate <input type="checkbox"/> Plug <input type="checkbox"/> (2)	1-13/16"		3,000	1-13/16"		5,000	1-13/16"		10,000
4a	Valves (1)	2-1/16"		3,000	2-1/16"		5,000	3-1/8"		10,000
5	Pressure Gauge			3,000			5,000			10,000
6	Valves Gate <input type="checkbox"/> Plug <input type="checkbox"/> (2)	3-1/8"		3,000	3-1/8"		5,000	3-1/8"		10,000
7	Adjustable Choke (3)	2"		3,000	2"		5,000	2"		10,000
8	Adjustable Choke	1"		3,000	1"		5,000	2"		10,000
9	Line		3"	3,000		3"	5,000		3"	10,000
10	Line		2"	3,000		2"	5,000		3"	10,000
11	Valves Gate <input type="checkbox"/> Plug <input type="checkbox"/> (2)	3-1/8"		3,000	3-1/8"		5,000	3-1/8"		10,000
12	Lines		3"	1,000		3"	1,000		3"	2,000
13	Lines		3"	1,000		3"	1,000		3"	2,000
14	Remote reading compound standpipe pressure gauge			3,000			5,000			10,000
15	Gas Separator		2'x5'			2'x5'			2'x5'	
16	Line		4"	1,000		4"	1,000		4"	2,000
17	Valves Gate <input type="checkbox"/> Plug <input type="checkbox"/> (2)	3-1/8"		3,000	3-1/8"		5,000	3-1/8"		10,000

(1) Only one required in Class 3M.

(2) Gate valves only shall be used for Class 10M.

(3) Remote operated hydraulic choke required on 5,000 psi and 10,000 psi for drilling.

**EQUIPMENT SPECIFICATIONS AND INSTALLATION INSTRUCTIONS**

1. All connections in choke manifold shall be welded, studded, flanged or Cameron clamp of comparable rating.
2. All flanges shall be API 6B or 6BX and ring gaskets shall be API RX or BX. Use only BX for 10 MWP.
3. All lines shall be securely anchored.
4. Chokes shall be equipped with tungsten carbide seats and needles, and replacements shall be available.
5. Choke manifold pressure and standpipe pressure gauges shall be available at the choke manifold to assist in regulating chokes. As an alternate with automatic chokes, a choke manifold pressure gauge shall be located on the rig floor in conjunction with the standpipe pressure gauge.
6. Line from drilling spool to choke manifold should be as straight as possible. Lines downstream from chokes shall make turns by large bends or 90° bends using bull plugged tees.
7. Discharge lines from chokes, choke bypass and from top of gas separator should vent as far as practical from the well.

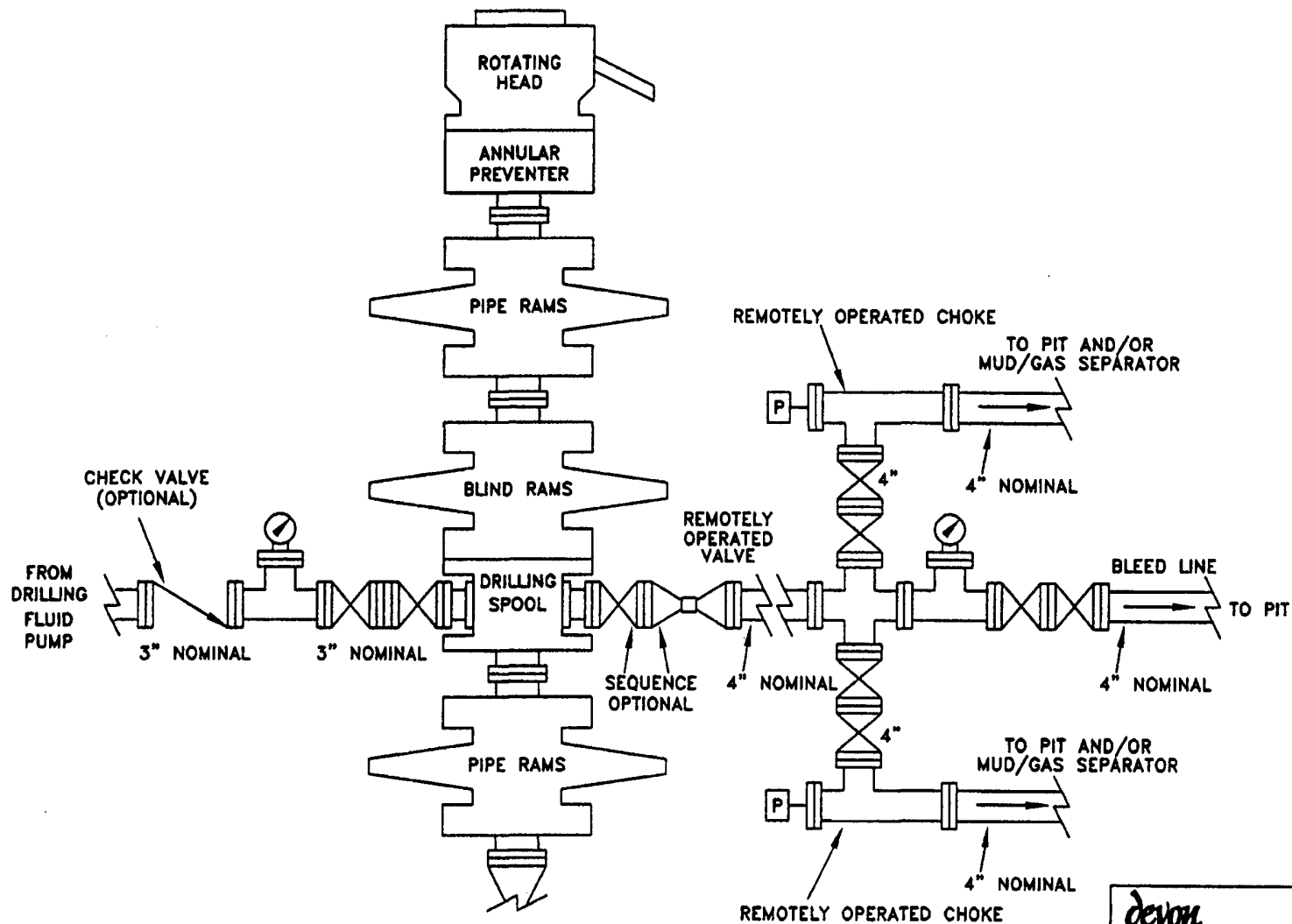

**devon**

**AREA NAME**

COUNTY, STATE

SCHEMATIC

**PROPOSED 10-M BOPE  
AND CHOKE ARRANGEMENT**

s:\...nm\plats  
10mbope.dwg

SC

10/00

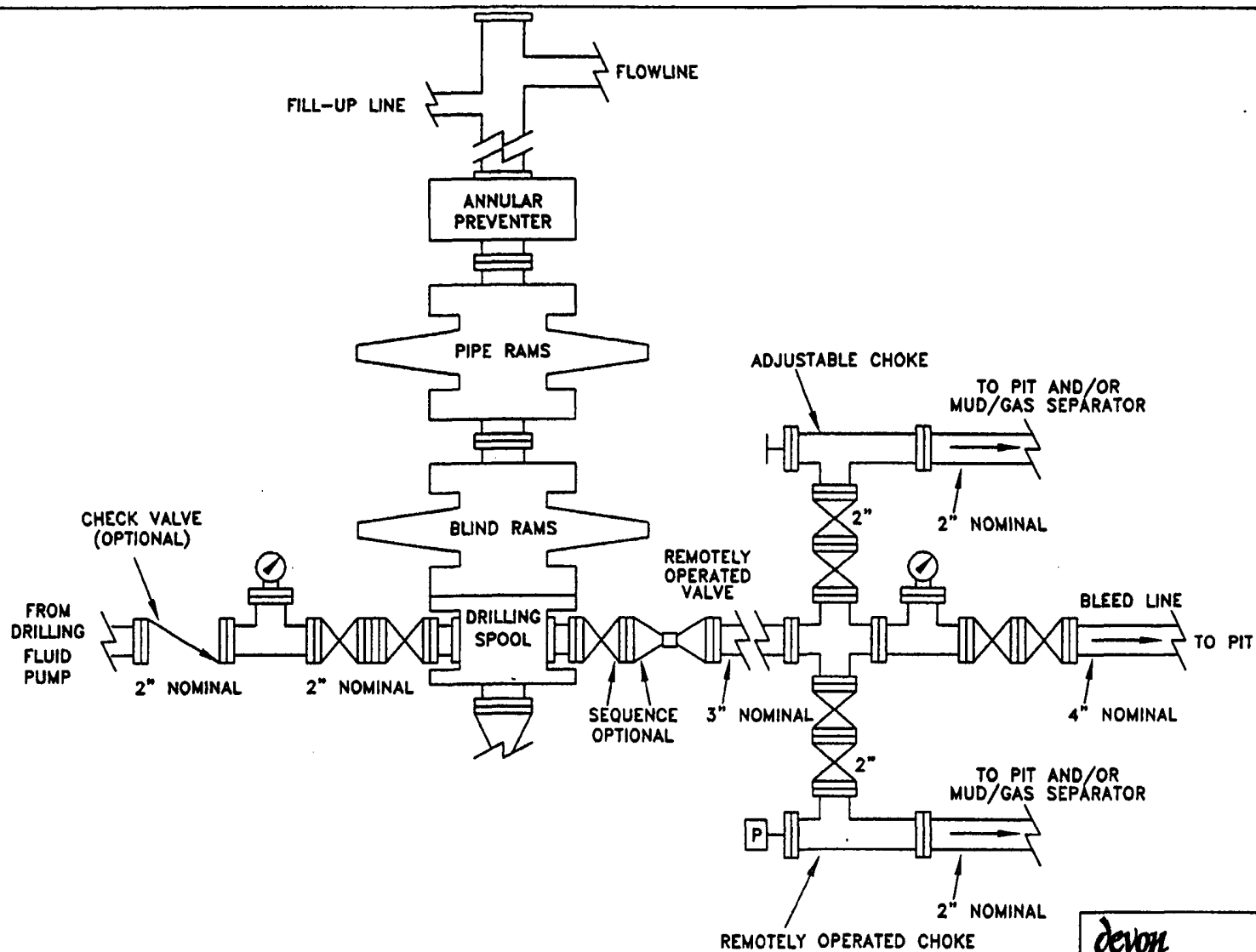

**devon**  
BEST OFFERING

AREA NAME

COUNTY, STATE

SCHEMATIC

**PROPOSED 5-M BOPE  
AND CHOKE ARRANGEMENT**

s:\...nm\plots

5mbope.dwg

SC

10/00

SECTION 4, TOWNSHIP 23 SOUTH, RANGE 35 EAST, N.M.P.M.,  
LEA COUNTY, NEW MEXICO.

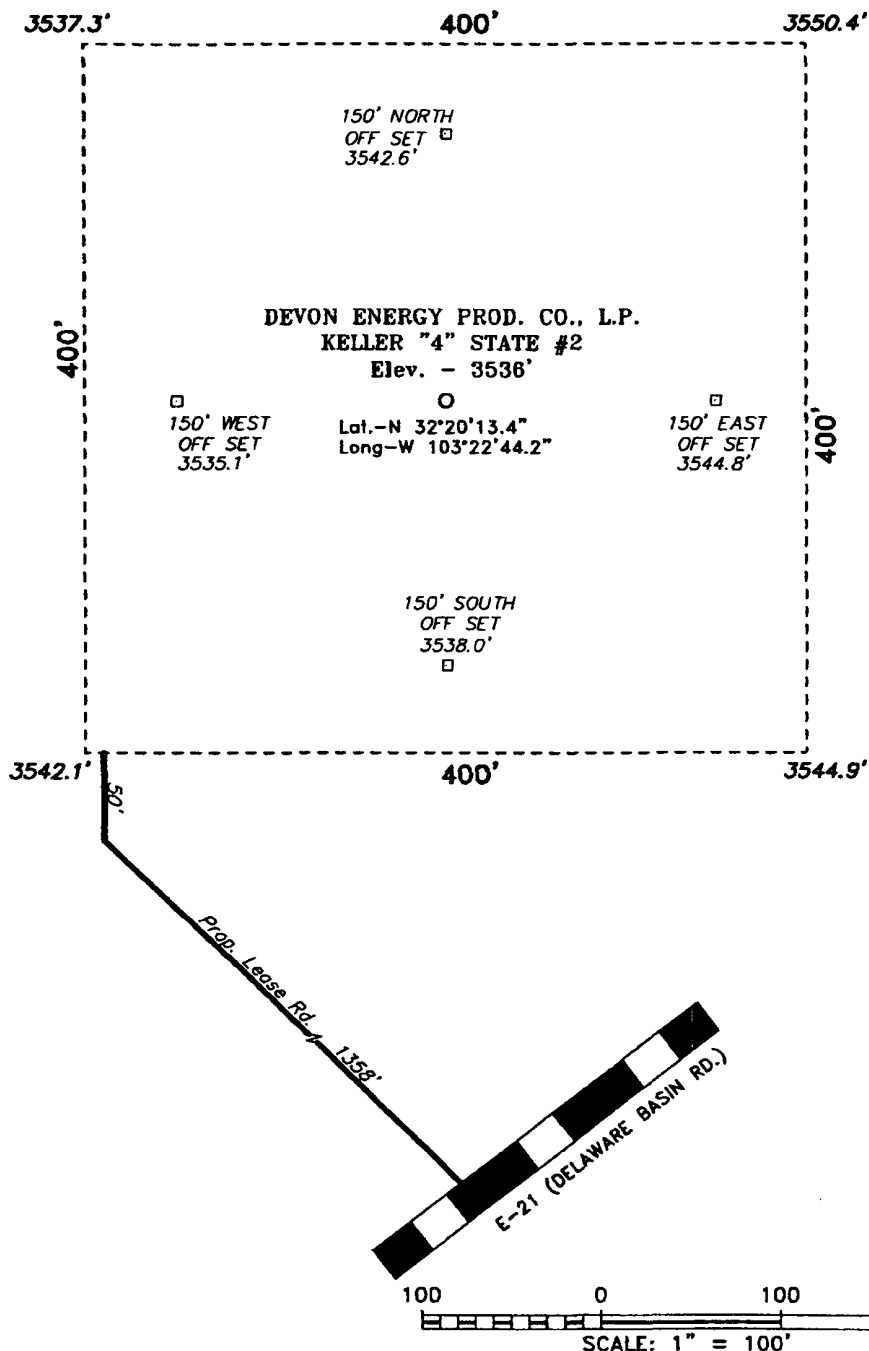

Directions to Location:

FROM THE JUNCTION OF CO. RD. E-11 AND CO. RD. 21 (DELAWARE BASIN ROAD), WEST ON E-21 FOR APPROX. 3.5 MILES TO THE PROPOSED LEASE ROAD.

**DEVON ENERGY PROD. CO., L.P.**

REF: KELLER "4" STATE No. 2 / Well Pad Topo

THE KELLER "4" STATE No. 2 LOCATED 1420' FROM THE NORTH LINE AND 660' FROM THE WEST LINE OF SECTION 4, TOWNSHIP 23 SOUTH, RANGE 35 EAST, N.M.P.M., LEA COUNTY, NEW MEXICO.

**BASIN SURVEYS** P.O. BOX 1786 - HOBBS, NEW MEXICO

W.O. Number: 2208 Drawn By: K. GOAD

Date: 01-23-2002 Disk: KJG CD#4 - 2208A.DWG

Survey Date: 01-22-2002 Sheet 1 of 1 Sheets

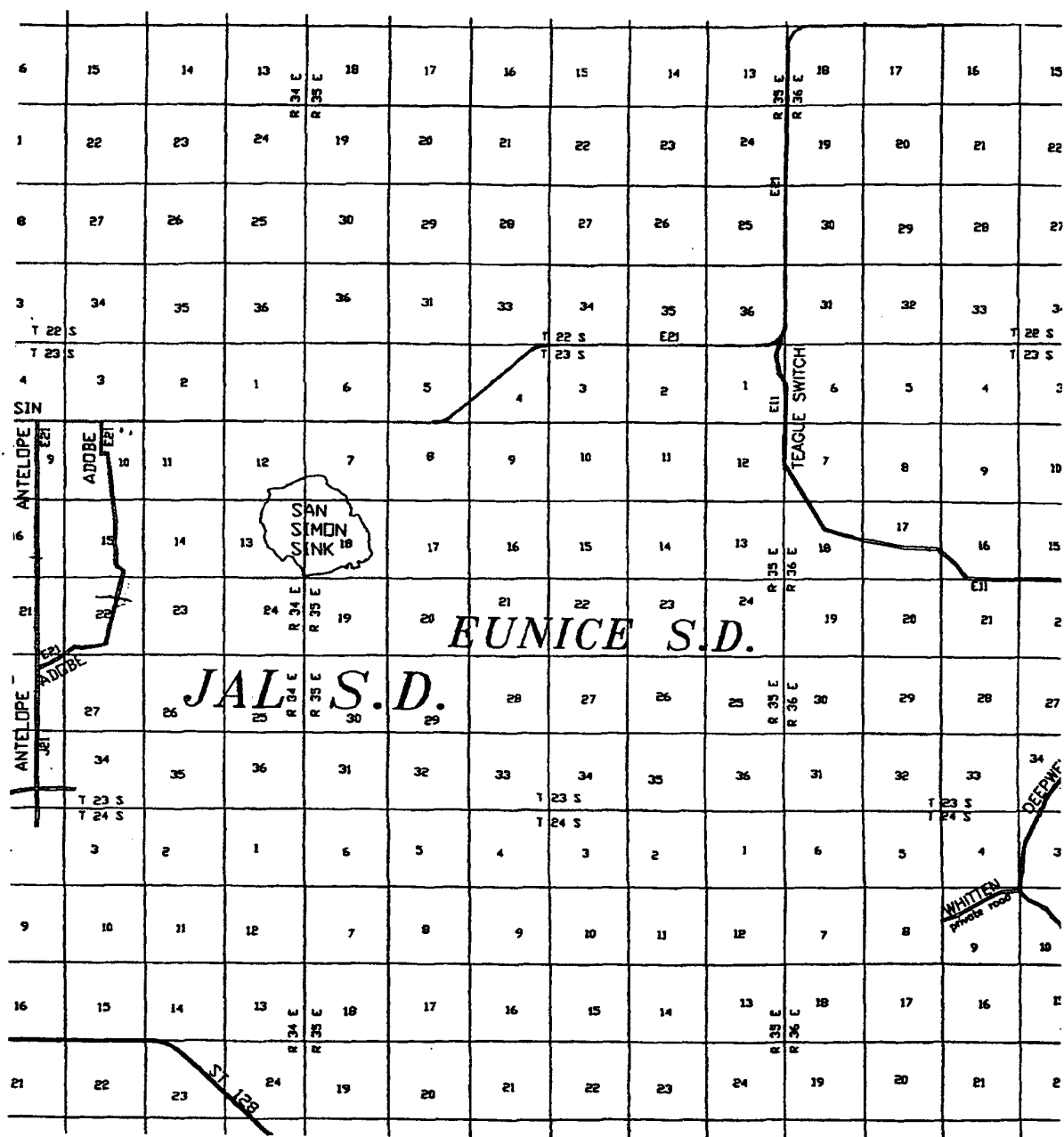

KELLER "4" STATE #2

Located at 1420' FNL and 660' FWL

Section 4, Township 23 South, Range 35 East,  
N.M.P.M., Lea County, New Mexico.

**basin**  
**surveys**  
focused on excellence  
in the oilfield

P.O. Box 1786  
1120 N. West County Rd.  
Hobbs, New Mexico 88241  
(505) 393-7316 - Office  
(505) 392-3074 - Fax  
basinsurveys.com

W.O. Number: 2208AA - KJG CD#4

Survey Date: 01-22-2002

Scale: 1" = 2 MILES

Date: 01-23-2002

DEVON  
ENERGY PROD.  
CO., L.P.

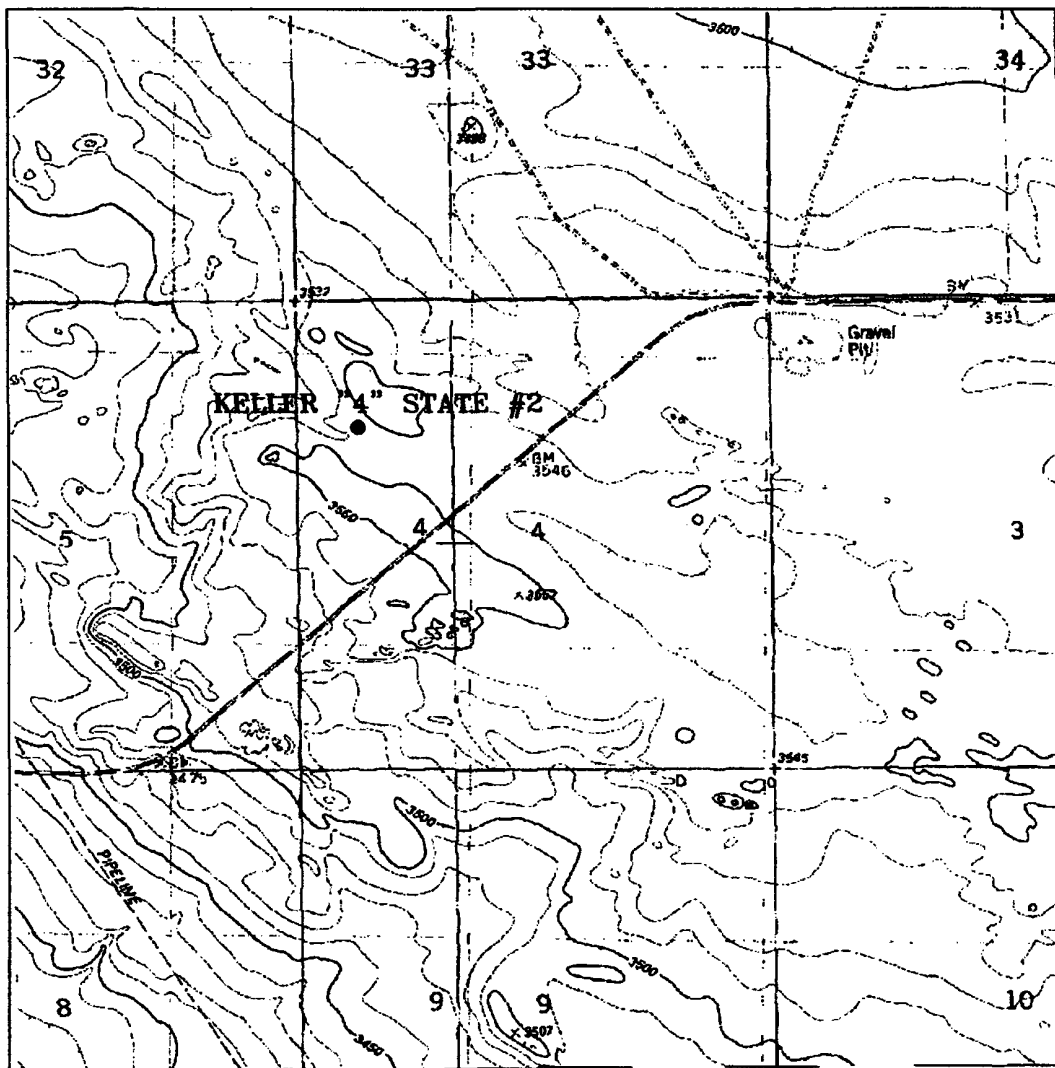

# **KELLER "4" STATE #2**

Located at 1420' FNL and 660' FWL

Section 4, Township 23 South, Range 35 East,  
N.M.P.M., Lea County, New Mexico.

**basin**  
**surveys**  
focused on excellence  
in the oilfield

P.O. Box 1786  
1120 N. West County Rd.  
Hobbs, New Mexico 88241  
(505) 393-7316 - Office  
(505) 392-3074 - Fax  
basinsurveys.com

W.O. Number: 2208AA - KJG CD#4

Survey Date: 01-22-2002

Scale: 1" = 2000'

Date: 01-23-2002

**DEVON**  
**ENERGY PROD.**  
**CO., L.P.**



UNIT :  
 LEASE : NORTHERN NATURAL STATE  
 WELL : 1  
 S/T/R : 28-22S-35E  
 COUNTY: LEA  
 STATE : NEW MEXICO

TYPE TEST: 1 POINT  
 : INITIAL  
 TEST DATE: 6/ 2/77

NEW MEXICO OIL CONSERVATION COMMISSION  
 MULTIPOINT AND ONE POINT BACK PRESSURE TEST FOR GAS WELLS  
 -----

COMPANY: UNION OIL OF CAL,	CONNECTION:
FIELD: ABRA PROSPECT	RESERVOIR: MORROW
COMPLETED 5-31-77 TD = 15399	PED = 14430 ELEV = 3548
CSG SIZE = 7.6250 WT = 39.00	SET AT 14601 PERF: 13557-13555
TBG SIZE = 2.8750 WT = 6.50	SET AT 12696 PERF: 0-
TYPE COMPLETION: NATURAL	PACKER SET AT: 12655
PRODUCING THROUGH: TUBING	BARO. PRESS = 13.20 PSIA
RESERVOIR TEMP., F = 176 @ 13560 FT.	SEAN GROUND TEMP., F = 78

L	H	G	% CO2	% N2	% H2S	PROVER	H-RUN	TAPS
-----	-----	---	-----	-----	-----	-----	-----	-----
13560	13560	.640	.13	.60	0.	0.	4.0	FLANGE

NO.	LINE SIZE	ORI. SIZE	FLOW PSIG	HP IN.	FLOW TEMP	TSG. PSIG	TSG. TEMP	CSG. PSIG	CSG. TEMP	FLOW G.P.
---	-----	-----	-----	-----	-----	-----	-----	-----	-----	-----
SI						5100				18.0
1	4.03 X 2.000		220	39.0	75	320	78	0	0	1.0
2										
3										
4										

NO.	COEFFICIENT (24 - HOUR)	SQRT. (1/HR)	PRESS. PSI	T-FACTR F(T)	G-FACTR F(G)	SC-FACTR F(PV)	FLOW HOUR
---	-----	-----	-----	-----	-----	-----	-----
1	19.61	95.37	233.2	.9850	1.2500	1.0211	2375
2							
3							
4							

NO.	P(1)	TEMP. F	T(F)	Z		
---	-----	-----	-----	---	-----	-----
1	.35	536	1.45	.950	GAS LIQ. RATIO, MCF/BBL	70.526
2					API G OF HYDROCARBONS	50.8
3					SP G GENERATOR GAS	640
4					SP G FLOWING FLUID	XXXXX
5					CRITICAL PRESS., PSIA	670
					CRITICAL TEMP., F	305

NO.	PR	PR*PR	PC*PC-PC*PR		
---	-----	-----	-----	-----	-----
1	426	181	25719	PC =	5009.2
2				PC*PC =	25000
3				PR*PC/(PC*PC-PC*PR) =	1.007