

NEW MEXICO
OIL CONSERVATION COMMISSION

Form C-128

Well Location and/or Gas Proration Plat

Date November 3, 1956

Operator George P. Livermore

Lease Cash Ramey

Well No. 1 Section 12 Township 3 N Range 32E NMPM

Located 1980 Feet From South Line, 660 Feet From East Line,

Curry County, New Mexico. G. L. Elevation 4552.04

Name of Producing Formation San Andres Pool Wildcat Dedicated Acreage 40

(Note: All distances must be from outer boundaries of Section)

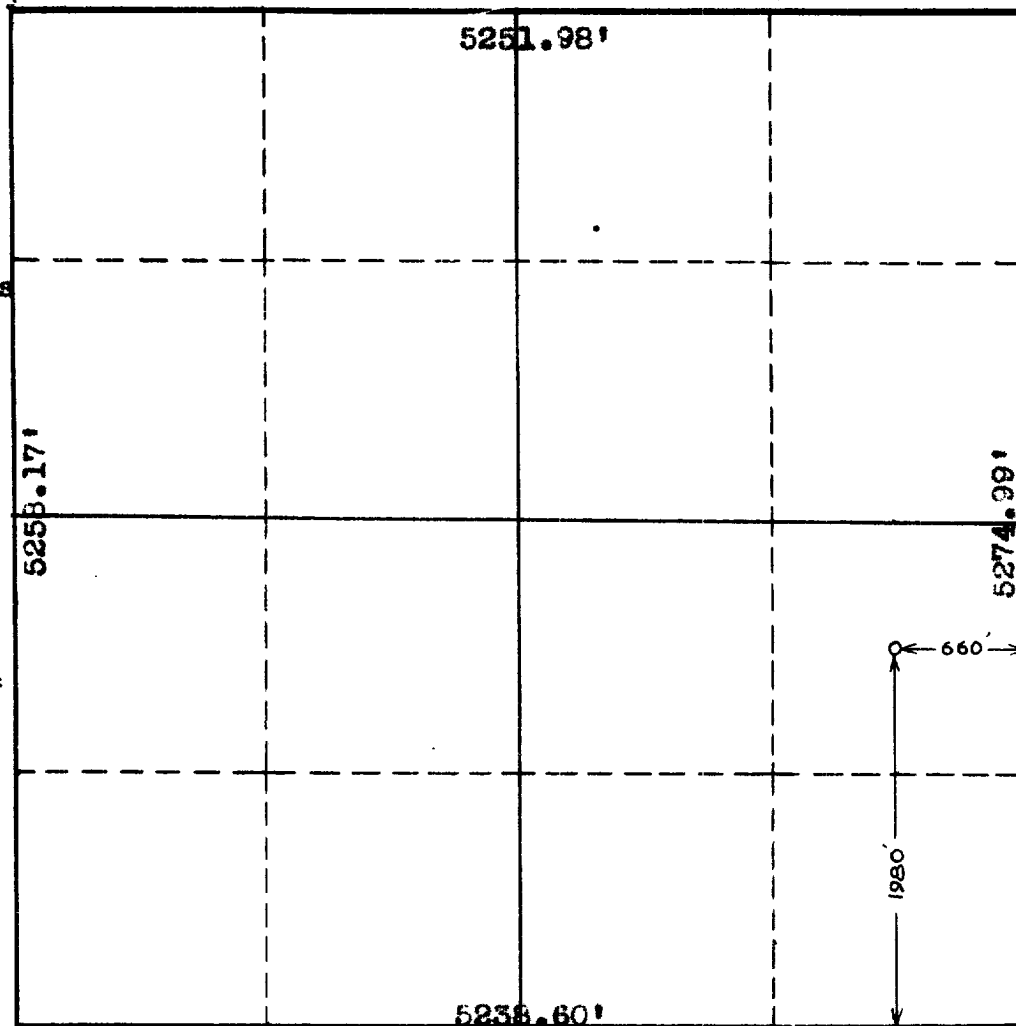

Note: Distances shown are as held on the ground.

NOTE

This section of form is to be used for gas wells only.

1. Is this Well a Dual Comp. ? Yes ☐ No ☐.
2. If the answer to Question 1 is yes, are there any other dually completed wells within the dedicated acreage ? Yes ☐ No ☐.

Name _____
Position _____
Representing _____
Address _____

This is to certify that the above plat was prepared from field notes of actual surveys made by me or under my supervision and that the same are true and correct to the best of my knowledge and belief.

Date Surveyed November 2, 1956

W. H. Jones
Registered Professional Engineer and/or Land Surveyor