

NO. OF COPIES RECEIVED	
DISTRIBUTION	
SANTA FE	
FILE	
U.S.G.S.	
LAND OFFICE	
OPERATOR	

NEW MEXICO OIL CONSERVATION COMMISSION

Form C-101
Revised 1-1-65

5A. Indicate Type of Lease	
STATE <input type="checkbox"/>	FEE <input checked="" type="checkbox"/>
5. State Oil & Gas Lease No.	

APPLICATION FOR PERMIT TO DRILL, DEEPEN, OR PLUG BACK

1a. Type of Work		7. Unit Agreement Name	
b. Type of Well DRILL <input checked="" type="checkbox"/> DEEPEN <input type="checkbox"/> PLUG BACK <input type="checkbox"/>		8. Farm or Lease Name W. Crenshaw	
OIL WELL <input checked="" type="checkbox"/> GAS WELL <input type="checkbox"/> OTHER <input type="checkbox"/>		9. Well No. 1	
2. Name of Operator Sunray DX Oil Company		10. Field and Pool, or Wildcat Wildcat	
3. Address of Operator P. O. Box 1416 - Roswell, New Mexico		12. County Curry	
4. Location of Well UNIT LETTER A LOCATED 660 FEET FROM THE North LINE AND 660 FEET FROM THE East LINE OF SEC. 14 TWP. 1N RGE. 31E NMPM		19. Proposed Depth 3500'	
		19A. Formation San Andres	
		20. Rotary or C.T. Rotary	
21. Elevations (Show whether DF, RT, etc.) 4350' DF (Est.)		21A. Kind & Status Plug. Bond Approved	
		21B. Drilling Contractor Cactus Drlg. Company	
		22. Approx. Date Work will start As soon as possible	

23.

PROPOSED CASING AND CEMENT PROGRAM

SIZE OF HOLE	SIZE OF CASING	WEIGHT PER FOOT	SETTING DEPTH	SACKS OF CEMENT	EST. TOP
12-1/4"	8-5/8	20	300	150 sx	Surface
7-7/8"	4-1/2	9.5	3500	200 sx	2700' (Est.)

1. Move in and rig up rotary rig.
2. Drill 12-1/4" hole to approx. 300'. Run 8-5/8", 20#, J-55 csg to CP 300' and cmt w/150 sx's. reg. w/2% CaCl₂. Circ cmt to surface. WOC 18 hrs. Test csg to 1000# for 30 min.
3. Drill 7-7/8" hole to TD of 3500'. Run Correlation Log at 2800'. Anticipate two 50' cores at approx. 3060' and 3160'.
4. Run Sonic, Density, Sidewall Neutron, Laterolog & Microlaterolog, Open hole logs.
5. Run 4-1/2", 9.5#, J-55 csg. to TD and cmt w/200 sx's 50-50 Incore Pos w/2% Gel. WOC 24 hrs. Test csg to 1000# for 30 min. Run temp. survey 8 hrs after cementing.
6. Run PFC Log and perf selected intervals w/E-gun - 1 - 1/2" hole per interval.
7. Acidize w/250 gals XFW acid per interval.
8. If necessary, frac down casing w/30,000 gal ref. oil and 40,000# sand. Limit surface pressure to 4000 psig.
9. Test and place well on production.

IN ABOVE SPACE DESCRIBE PROPOSED PROGRAM: IF PROPOSAL IS TO DEEPEN OR PLUG BACK, GIVE DATA ON PRESENT PRODUCTION ZONE AND PROPOSED NEW PRODUCTION ZONE. GIVE BLOWOUT PREVENTER PROGRAM, IF ANY.

I hereby certify that the information above is true and complete to the best of my knowledge and belief.

Signed John Hastings Title District Engineer Date 12-22-67

(This space for State Use)

APPROVED BY _____ TITLE _____ DATE _____

CONDITIONS OF APPROVAL, IF ANY:

NEW MEXICO OIL CONSERVATION COMMISSION
WELL LOCATION AND ACREAGE DEDICATION PLAT

Form C-161
Supersedes C-124
Effective 1-1-65

All distances must be from the outer boundaries of the Section

Operator SUNRAY DX OIL Co.			Lessee W. CRENSHAW		Well No. 1
Tract Letter A	Section 14	Township 1 NORTH	Range 31 EAST	County CURRY	
Actual Footage Location of Well: 660 feet from the NORTH line and 660 feet from the EAST line					
Ground Level Elev.	Producing Formation San Andres		Pool Wildcat	Predicted Acreage 40	

1. Outline the acreage dedicated to the subject well by colored pencil or hatchure marks on the plat below.
2. If more than one lease is dedicated to the well, outline each and identify the ownership thereof (both as to working interest and royalty).
3. If more than one lease of different ownership is dedicated to the well, have the interests of all owners been consolidated by communitization, unitization, force-pooling, etc?

☐ Yes ☐ No If answer is "yes," type of consolidation _____

If answer is "no," list the owners and tract descriptions which have actually been consolidated. (Use reverse side of this form if necessary.) _____

No allowable will be assigned to the well until all interests have been consolidated (by communitization, unitization, forced-pooling, or otherwise) or until a non-standard unit, eliminating such interests, has been approved by the Commission.

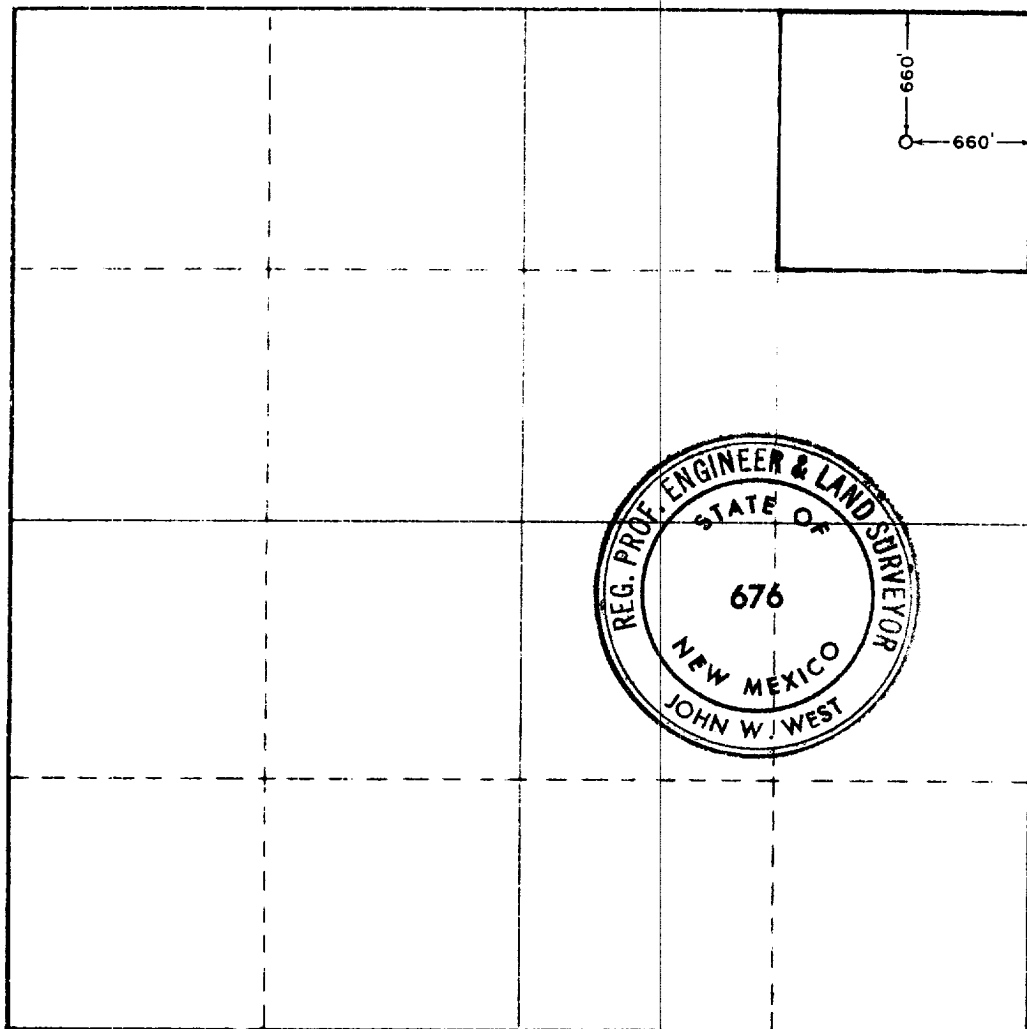

CERTIFICATION

I hereby certify that the information contained herein is true and complete to the best of my knowledge and belief.

John Hastings
John Hastings
District Engineer

Sunray DX Oil Company

December 27, 1967

I hereby certify that the well location shown on this plat was plotted from field notes of actual surveys made by me or under my supervision, and that the same is true and correct to the best of my knowledge and belief.

Date Surveyed

12-23-67

Registered Professional Engineer and/or Land Surveyor

John W. West
Certificate No.

676

0 330 660 990 1320 1650 1980 2310 2640 2000 1500 1000 500 0