

NORTH

EXHIBIT "E"

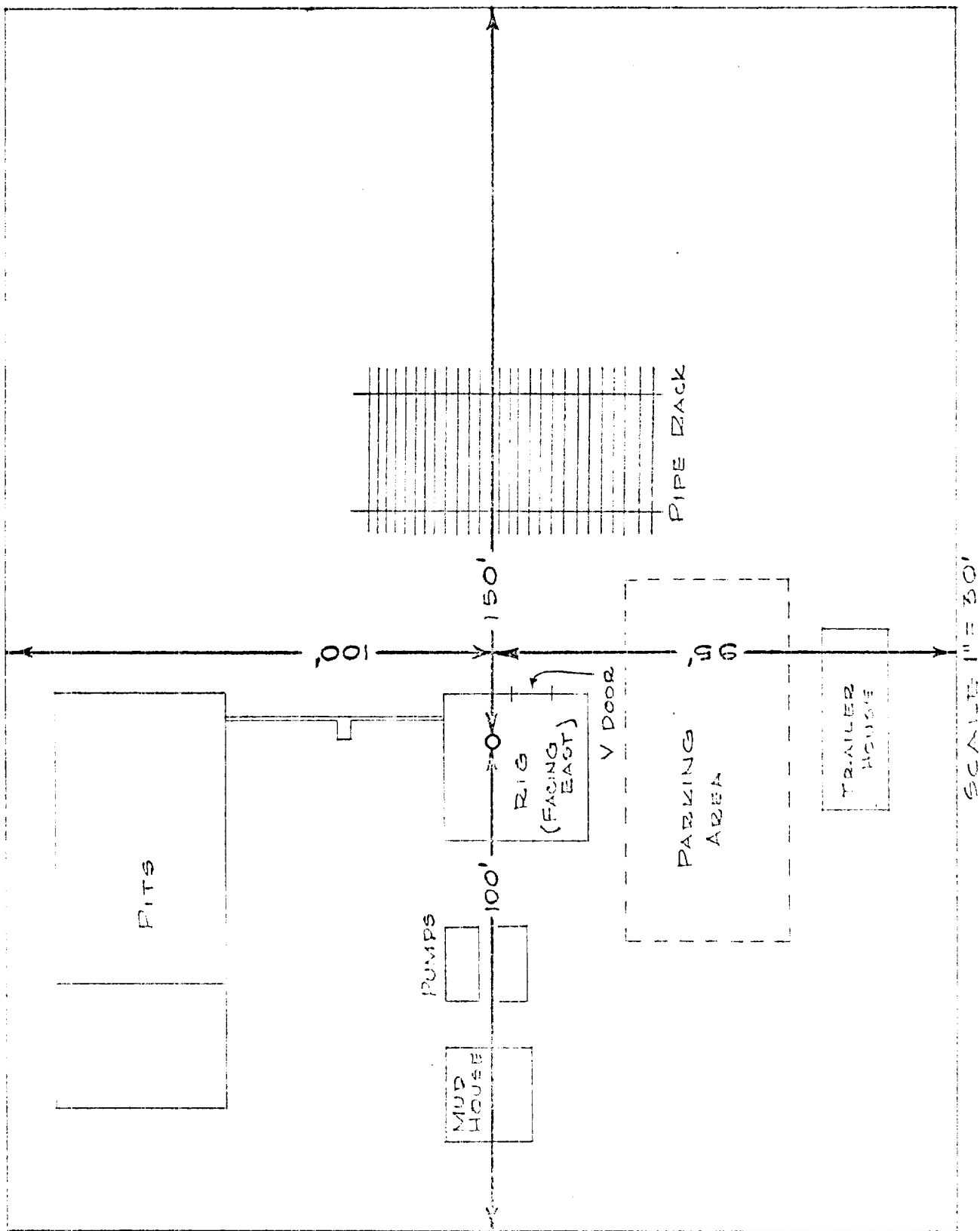

30' D.O.W.

#### MUD PROGRAM

0 - 350' Spud Mud  
350' - 2600' Fresh Water, starch and gel 10#/gal  
to 11.5#/gal  
2600' - TD Fresh Water gel and low solids 8.5-9.0#/gal

#### BLOW OUT PREVENTER PROGRAM

350' - 2600' - 2 MRd (Exhibit "A")  
2600' - 7000' - 3 MSRdA (Exhibit "C")  
TEST FREQUENCY-Yellow jacket test blowout preventer  
3000# in addition there will be a blowout preventer  
drill each tower, each day. If drilling time goes  
beyond 45 days, yellow jacket test will be run again.

#### CEMENT PROGRAM

- \* Set 350' with 350 sacks Class "C" cement with  
2% calcium chloride 250% to circulate (cement  
must circulate)
- \*\* Set 2600' with 600 sacks Trinidad light weight  
& 200 sacks Class "C" cement 200% to circulate
- \*\*\*Set 7000' or TD with 500 sacks Class "C"  
150% to bring cement to 4000'

#### FORMATION TOPS EXPECTED

San Andres	1910'	Cisco	5635'
Glorieta	2785'	Strawn	6130'
Tubb	4084'	P. Cambrian	6860'
Wolfcamp	5220'	TD	7000'

EXHIBIT "F"