

DISTRICT I  
1625 N. French Dr., Hobbs, NM 88240

State of New Mexico  
Energy, Minerals and Natural Resources Department

Form C-101  
Revised March 17, 1999  
Instructions on back  
Submit to appropriate District Office  
State Lease - 6 Copies  
Fee Lease - 5 Copies

DISTRICT II  
811 South First, Artesia, NM 88210

OIL CONSERVATION DIVISION

DISTRICT III  
1000 Rio Brazos Rd., Aztec, NM 87410

PO BOX 2088  
Santa Fe, NM 87504-2088

DISTRICT IV  
2040 South Pacheco, Santa Fe, NM 87501

☐ AMENDED REPORT

APPLICATION FOR PERMIT TO DRILL, RE-ENTER, DEEPEN, PLUGBACK, OR ADD A ZONE

<sup>1</sup> Operator Name and Address Yates Petroleum Corporation 105 South Fourth Street Artesia, New Mexico 88210		<sup>2</sup> OGRID Number 025575
		<sup>3</sup> API Number 30-025-00012
<sup>4</sup> Property Code 26160	<sup>5</sup> Property Name Sohio "AVR" State	<sup>6</sup> Well No. 1

<sup>7</sup> Surface Location

UL or lot no.	Section	Township	Range	Lot Idn	Feet from the	North/South Line	Feet from the	East/West Line	County
K	9	10S	32E		1980'	South	1980	West	Lea

<sup>8</sup> Proposed Bottom Hole Location If Different From Surface

UL or lot no.	Section	Township	Range	Lot Idn	Feet from the	North/South Line	Feet from the	East/West Line	County
<sup>9</sup> Proposed Pool 1 Wildcat Devonian					<sup>10</sup> Proposed Pool 2				

<sup>11</sup> Work Type Code E	<sup>12</sup> Well Type Code O	<sup>13</sup> Cable/Rotary Rotary	<sup>14</sup> Lease Type Code S	<sup>15</sup> Ground Level Elevation 4360'
<sup>16</sup> Multiple No	<sup>17</sup> Proposed Depth 12,147"	<sup>18</sup> Formation Devonian	<sup>19</sup> Contractor Not Determined	<sup>20</sup> Spud Date ASAP

<sup>21</sup> Proposed Casing and Cement Program

Hole Size	Casing Size	Casing weight/feet	Setting Depth	Sacks of Cement	Estimated TOC
17"	13 3/8"	48#	390'	400 sx	In Place
12 1/4"	9 5/8"	36#	3591'	1600 sx	In Place
7 7/8"	5 1/2"	17#	12,147'	950 sx	910' TOC-6700

<sup>22</sup> Describe the proposed program. If this application is to DEEPEN or PLUG BACK give the data on the present productive zone and proposed new productive zone. Describe the blowout prevention program, if any. Use additional sheets if necessary.

See Attached Sheets for additional information.

Permit Expires 1 Year From Approval  
Date Unless Drilling Underway  
Re-Entry

<sup>23</sup> I hereby certify that the information given above is true and complete to the best of my knowledge and belief. Signature: <i>Clifton R. May</i>		OIL CONSERVATION DIVISION	
Printed name: Clifton R. May		Approved by: ORIGINAL SIGNED BY PAUL F. KAUTZ	
Title: Regulatory Agent		Title: PETROLEUM ENGINEER	
Date: 06/07/02	Phone: (505) 748-1471	Approval: JUN 12 2002	Expiration Date:
		Conditions of Approval Attached <input type="checkbox"/>	

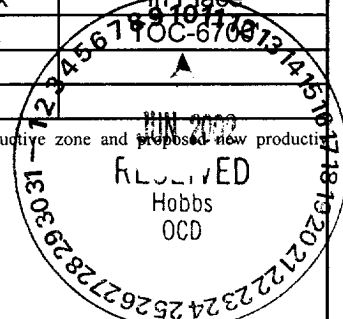

**YATES PETROLEUM CORPORATION  
Sohio "AVR" State #1  
1980' FSL and 1980' FWL  
Section 9-T10S-R32E  
Lea County, New Mexico  
Lease #VA-2155**

Yates Petroleum Corporation's plan is to re-enter the well with a pulling unit and reverse unit to drill out the cement plugs in the 9 5/8" casing to 3,540' then squeeze the San Andres perms w/300+/- sacks of cement. After the cement squeeze has been drilled out, the drillable plug @ 3,540' and cement plug in the bottom of the 9 5/8" casing @ 3,591' will be drilled out, then the rig will drill out the cement plugs in the 7 7/8" open hole to TD of 12,147'. Mud to be used is 9.5 – 9.8 ppg brine water, with a 55-70 viscosity. After reaching TD a new suite of open hole logs will be run, then a string of 5 1/2" casing will be run to bottom and cemented to 6,700'+/-.

The well will be completed with a pulling unit. Possible formations to be completed will be the Morrow sand @ 11,250'+/- or the Woodford sand @ 12,020'+/-.

**BOPE PROGRAM:** A 5,000# BOP will be installed on the 9 5/8" casing and tested daily.

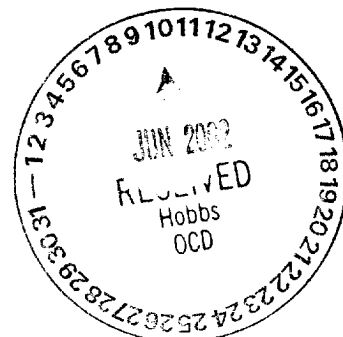

DISTRICT I  
1626 E. French Dr., Hobbs, NM 88340

DISTRICT II  
811 South First, Artesia, NM 88210

DISTRICT III  
1000 Rio Brazos Rd., Aztec, NM 87410

DISTRICT IV  
2040 South Pacheco, Santa Fe, NM 87506

State of New Mexico  
Energy, Minerals and Natural Resources Department

Form C-102  
Revised March 17, 1999  
Instruction on back  
Submit to Appropriate District Office  
State Lease - 4 Copies  
Fee Lease - 3 Copies

OIL CONSERVATION DIVISION

P.O. Box 2088  
Santa Fe, New Mexico 87504-2088

☐ AMENDED REPORT

WELL LOCATION AND ACREAGE DEDICATION PLAT

API Number 30025-00012	Pool Code ✓	Pool Name Wildcat Devonian
Property Code 26160	Property Name Sohio AVR State	Well Number 1
OGED No. 025575	Operator Name Yates Petroleum Corporation	Elevation 4360'

Surface Location

UL or Lot No.	Section	Township	Range	Lot Idn	Feet from the	North/South line	Feet from the	East/West line	County
K	9	10S	32 E		1980'	South	1980'	West	Lea

Bottom Hole Location If Different From Surface

UL or Lot No.	Section	Township	Range	Lot Idn	Feet from the	North/South line	Feet from the	East/West line	County
Dedicated Acres 40		Joint or Infill	Consolidation Code	Order No.					

NO ALLOWABLE WILL BE ASSIGNED TO THIS COMPLETION UNTIL ALL INTERESTS HAVE BEEN CONSOLIDATED  
OR A NON-STANDARD UNIT HAS BEEN APPROVED BY THE DIVISION

				<b>OPERATOR CERTIFICATION</b>  I hereby certify that the information contained herein is true and complete to the best of my knowledge and belief.  Signature: <u>Clifton R. May</u> Printed Name: <u>Clifton R. May</u> Regulatory Agent Title: <u>6-6-02</u> Date: <u>6-6-02</u>	
				<b>SURVEYOR CERTIFICATION</b>  I hereby certify that the well location shown on this plat was plotted from field notes of actual surveys made by me or under my supervision, and that the same is true and correct to the best of my belief.  Refer to Original Plat Date Surveyed: <u>10/11/12</u> Signature & Seal of Professional Surveyor: <u>[Signature]</u> Certificate No. <u>101112</u> L. Jones, RLS 3640 GENERAL SURVEYING COMPANY	

District I  
1625 N. French Dr., Hobbs, NM 88240

District II  
811 South First, Artesia, NM 88210

District III  
1000 Rio Brazos Rd., Aztec, NM 87410

District IV  
2040 South Pacheco, Santa Fe, NM 87505

State of New Mexico  
Energy, Minerals & Natural Resources

OIL CONSERVATION DIVISION  
2040 South Pacheco  
Santa Fe, NM 87505

Form C-102  
Revised March 17, 1999

Submit to Appropriate District Office  
State Lease - 4 Copies  
Fee Lease - 3 Copies

☐ AMENDED REPORT

WELL LOCATION AND ACREAGE DEDICATION PLAT

API Number <b>3D-025-00012</b>		Pool Code	Pool Name <b>Wildcat Devonian</b>
Property Code <b>2616D</b>	Property Name <b>Sohio AVR State</b>		Well Number <b>1</b>
OGRID No. <b>025575</b>	Operator Name <b>Yates Petroleum Corporation</b>		Elevation <b>4360'</b>

<sup>10</sup> Surface Location

UL or lot no.	Section	Township	Range	Lot Idn	Feet from the	North/South line	Feet from the	East/West line	County
K	9	10S	32-E		1980'	South	1980'	West	Lea

<sup>11</sup> Bottom Hole Location If Different From Surface

UL or lot no.	Section	Township	Range	Lot Idn	Feet from the	North/South line	Feet from the	East/West line	County
Dedicated Acres <b>40</b>		Joint or Infill	Consolidation Code		Order No.				

NO ALLOWABLE WILL BE ASSIGNED TO THIS COMPLETION UNTIL ALL INTERESTS HAVE BEEN CONSOLIDATED OR A NON-STANDARD UNIT HAS BEEN APPROVED BY THE DIVISION

	<sup>17</sup> OPERATOR CERTIFICATION I hereby certify that the information contained herein is true and complete to the best of my knowledge and belief.		
	Signature <i>Ken Beardemphl</i>		
	Printed Name <b>Ken Beardemphl</b>		
	Title <b>Landman</b>		
	Date <b>July 6, 2000</b>		
	<sup>18</sup> SURVEYOR CERTIFICATION I hereby certify that the well location shown on this plat was plotted from field notes of actual surveys made by me or under my supervision, and that the same is true and correct to the best of my belief.		
	Date of Survey		
	Signature and Seal of Professional Surveyor:		
	REFER TO ORIGINAL PLAT		
	Certificate Number		

N. MEXICO OIL CONSERVATION COMMISSION

Well Location and Acreage Dedication Plat

Section A.

Operator Shio Petroleum Company Lease 1958 State 5 AM 10:44  
Well No. 1 Unit Letter K Section 9 Township 10-S Range 32-E NMPM  
Located 1980 Feet From West Line, 1980 Feet From South Line  
County Lea G. L. Elevation 4360 Ft. Dedicated Acreage 40 Acres  
Name of Producing Formation Devonian Pool Wildcat

1. Is the Operator the only owner\* in the dedicated acreage outlined on the plat below?  
Yes X No
2. If the answer to question one is "no," have the interests of all the owners been consolidated by communitization agreement or otherwise? Yes        No        If answer is "yes," Type of Consolidation
3. If the answer to question two is "no," list all the owners and their respective interests below:

Owner

Land Description

Section B

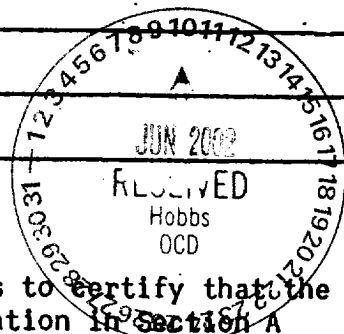
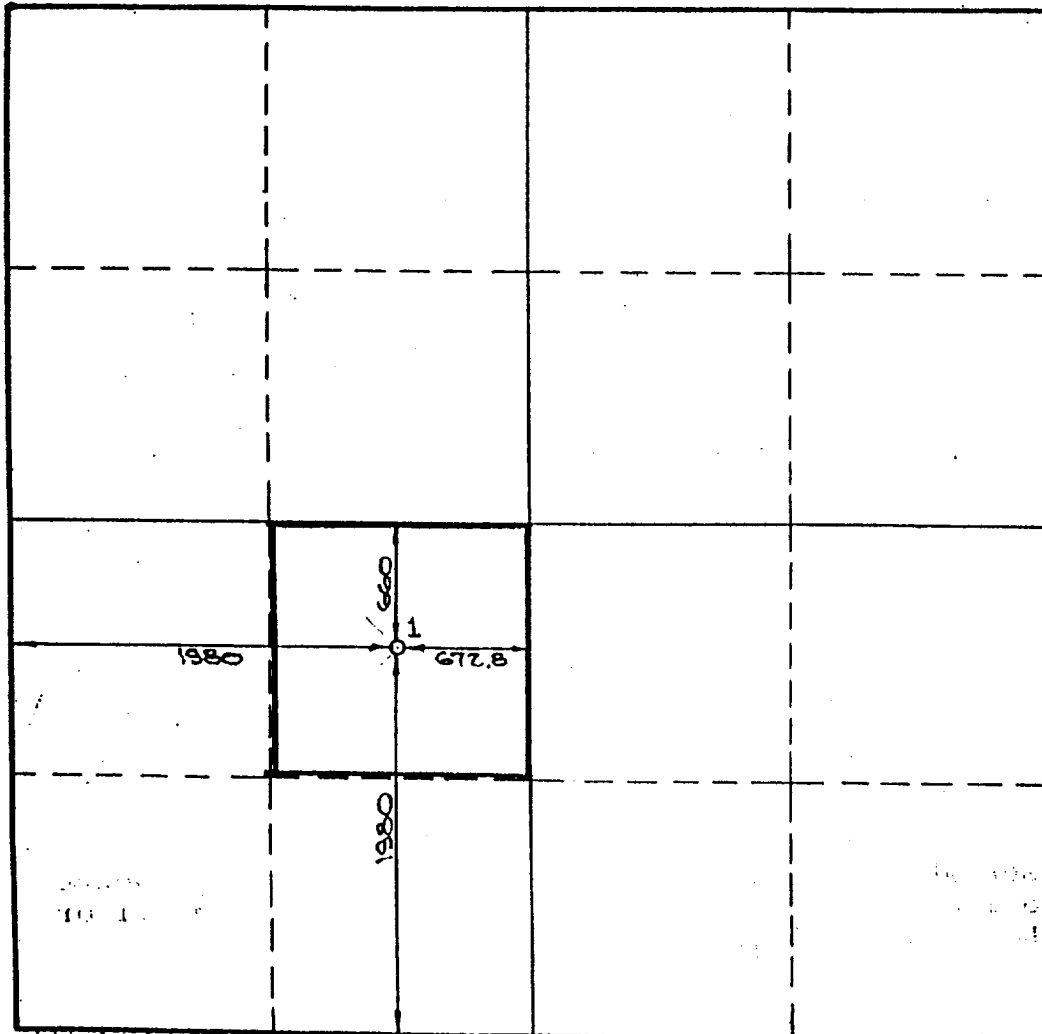

This is to certify that the information in Section A above is true and complete to the best of my knowledge and belief.

Shio Petroleum Company  
(Operator)

A. K. Hood  
(Representative)

Box 3167 - Midland, Texas  
Address

This is to certify that the well location shown on the plat in Section B was plotted from field notes of actual surveys made by me or under my supervision and that the same is true and correct to the best of my knowledge and belief.

Date Surveyed Dec. 1958

Registered Professional Engineer and/or Land Surveyor.

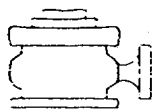

# Yates Petroleum Corporation

BOP-4

## Typical 5,000 psi Pressure System Schematic Annular with Double Ram Preventer Stack

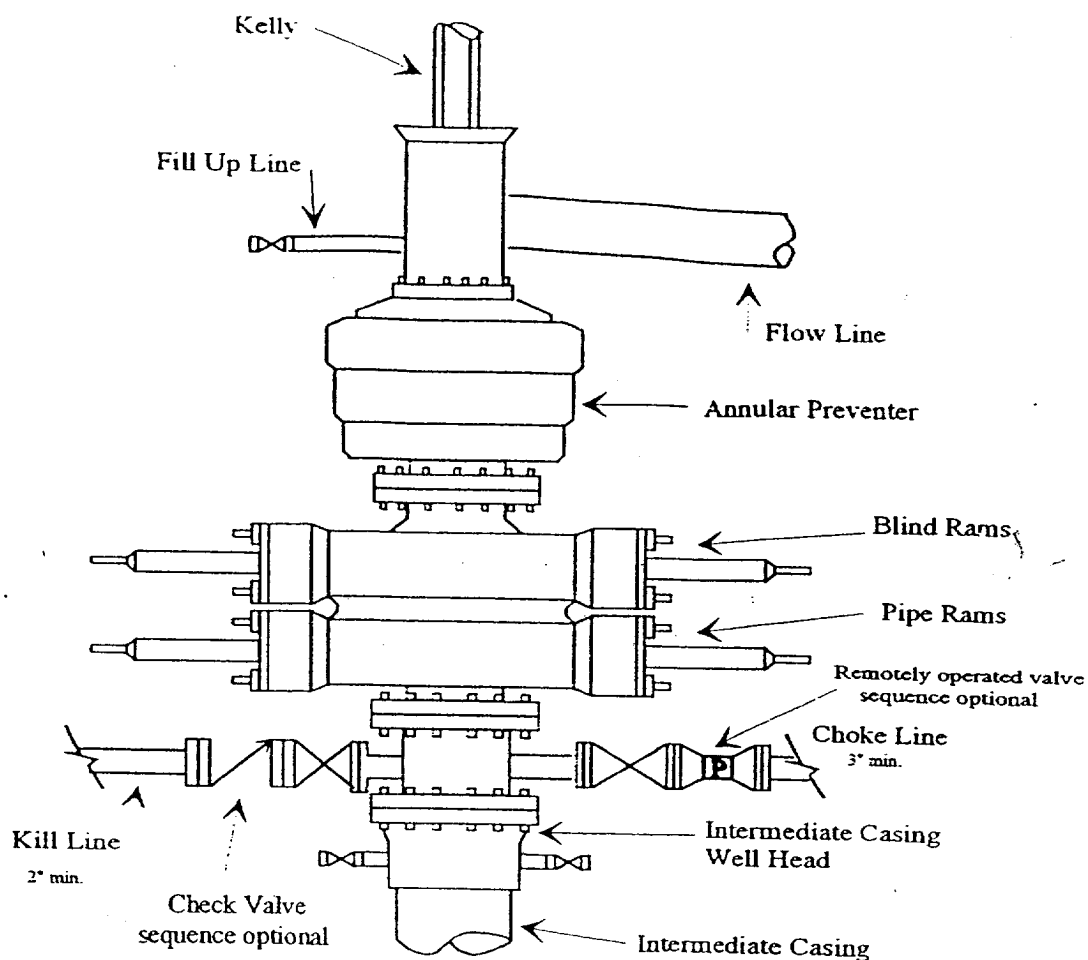

Typical 5,000 psi choke manifold assembly with at least these minimum features

