

LOGS EL GR RA IND HC A TD 10775', PBD 4200'

IP San Andres Perfs 4042-4120' Pmpd 9 BOPD + 22 BW. Pot. Based  
on 24 hr test, gravity 19., GOR 1771.

6-15-64 F.R.C. 6-18-64; OWWO, OTD 10775'  
Re-complete from Wolfcamp 8530-8830 and Temp.  
Abd. 11-5-63  
TD 10775', PBD 4200', COMPLETED  
Spotted 35 sx plug 8740-8430'  
Perf 4397-98' & sq. w/275 sx.  
DO to 4200'  
Perf 4137-38' & sq. w/100 sx.  
Perf 4039-40' & sq. w/100 sx.  
Perf 4042-45', 4060-62', 4067-69', 4080-82',  
4092-94', 4101-03' & 4116-20' W/2 SPF  
Ac. 3500 gals.  
Frac 20,000 gals oil + 20,000# sd.

NEW MEXICO OIL CONSERVATION COMMISSION

Well Location and Acreage Dedication Plat

HOBBS OFFICE O. C. C.  
6-4-64  
JUN 5 10 14 AM '64

Section A.

Operator Sunray Oil Company Lease N.M. State "K"  
Well No. 1 Unit Letter 0 Section 11 Township 10S Range 32E NMPM  
Located 660 Feet From South Line, 1980 Feet From East Line  
County Lea G. L. Elevation \_\_\_\_\_ Dedicated Acreage \_\_\_\_\_ Acres  
Name of Producing Formation San Andres Pool Mescalero San Andres

1. Is the Operator the only owner\* in the dedicated acreage outlined on the plat below?  
Yes X No \_\_\_\_\_.
2. If the answer to question one is "no," have the interests of all the owners been consolidated by communitization agreement or otherwise? Yes \_\_\_\_\_ No \_\_\_\_\_. If answer is "yes," Type of Consolidation \_\_\_\_\_
3. If the answer to question two is "no," list all the owners and their respective interests below:

Owner

Land Description

Section B

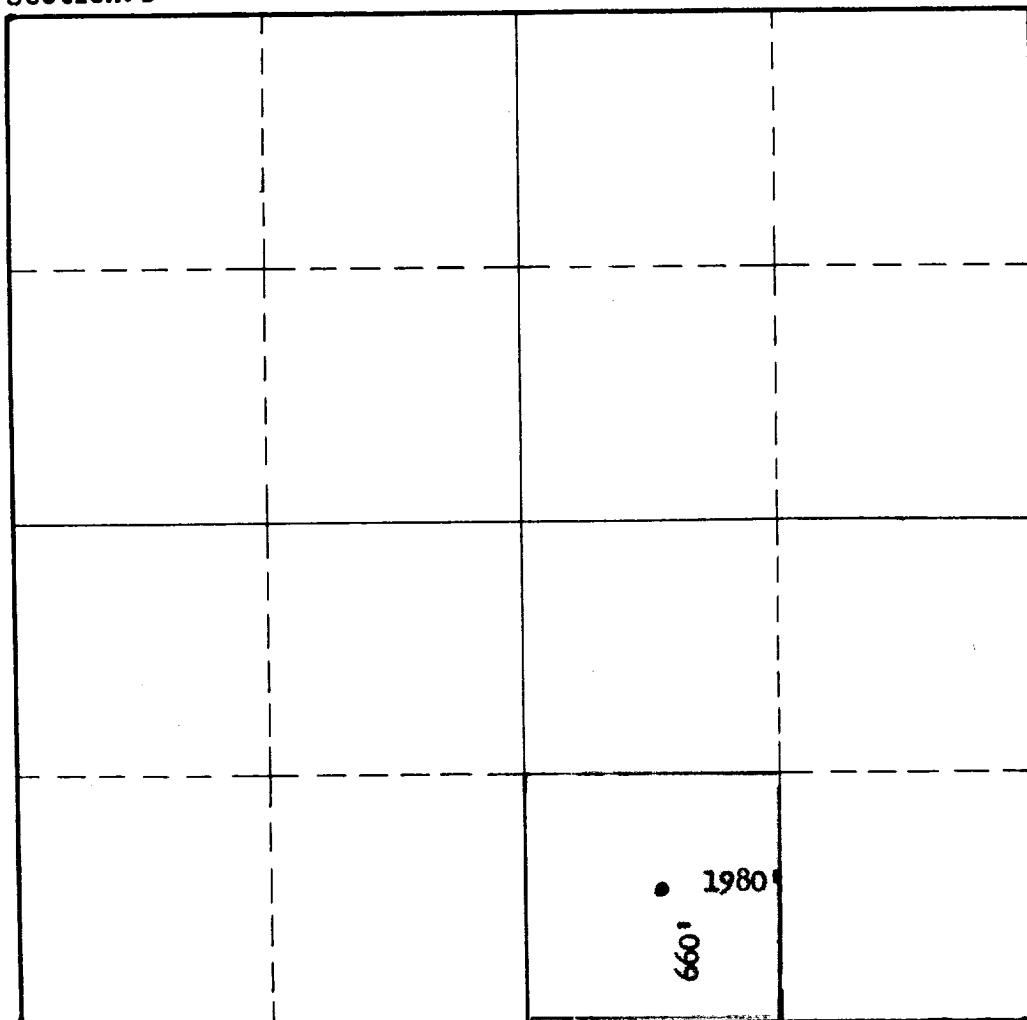

This is to certify that the information in Section A above is true and complete to the best of my knowledge and belief.

Sunray Oil Company  
(Operator)

H.A. Riggs H.A. Riggs  
(Representative) by JRS

P.O. Box 128 Hobbs, New Mex.  
Address

This is to certify that the well location shown on the plat in Section B was plotted from field notes of actual surveys made by me or under my supervision and that the same is true and correct to the best of my knowledge and belief.

Date Surveyed 2-29-56

John W. West  
Registered Professional  
Engineer and/or Land Surveyor.

Certificate No. 676

INSTRUCTIONS FOR COMPLETION:

1. Operator shall furnish and certify to the information called for in Section A.
2. Operator shall outline the dedicated acreage for both oil and gas wells on the plat in Section B.
3. A registered professional engineer or land surveyor registered in the State of New Mexico or approved by the Commission shall show on the plat the location of the well and certify this information in the space provided.
4. All distances shown on the plat must be from the outer boundaries of Section.
5. If additional space is needed for listing owners and their respective interests as required in question 3, Section A, please use space below

\* "Owner" means the person who has the right to drill into and to produce from any pool and to appropriate the production either for himself or for himself and another. (65-3-29 (e) NMSA 1953 Comp.)

NEW MEXICO OIL CONSERVATION COMMISSION

Well Location and Acreage Dedication Plat

Section A

Date August 21, 1959 **HOBBS OFFICE, OCC**

Operator Sunray Mid-Continent Oil Company Lease N. M. State "M"  
Well No. 1 Unit Letter 0 Section 11 Township 10S Range 9E NMPM  
Located 660 Feet From South Line, 1980 Feet From East Line  
County Lea G. L. Elevation 4257 Dedicated Acreage 260 Acres  
Name of Producing Formation Atoka Pool North Mesalero-Pennsylvanian (Gas)

1. Is the Operator the only owner\* in the dedicated acreage outlined on the plat below?  
Yes X No       .
2. If the answer to question one is "no," have the interests of all the owners been consolidated by communitization agreement or otherwise? Yes        No       . If answer is "yes," Type of Consolidation
3. If the answer to question two is "no," list all the owners and their respective interests below:

Owner

Land Description

Section B

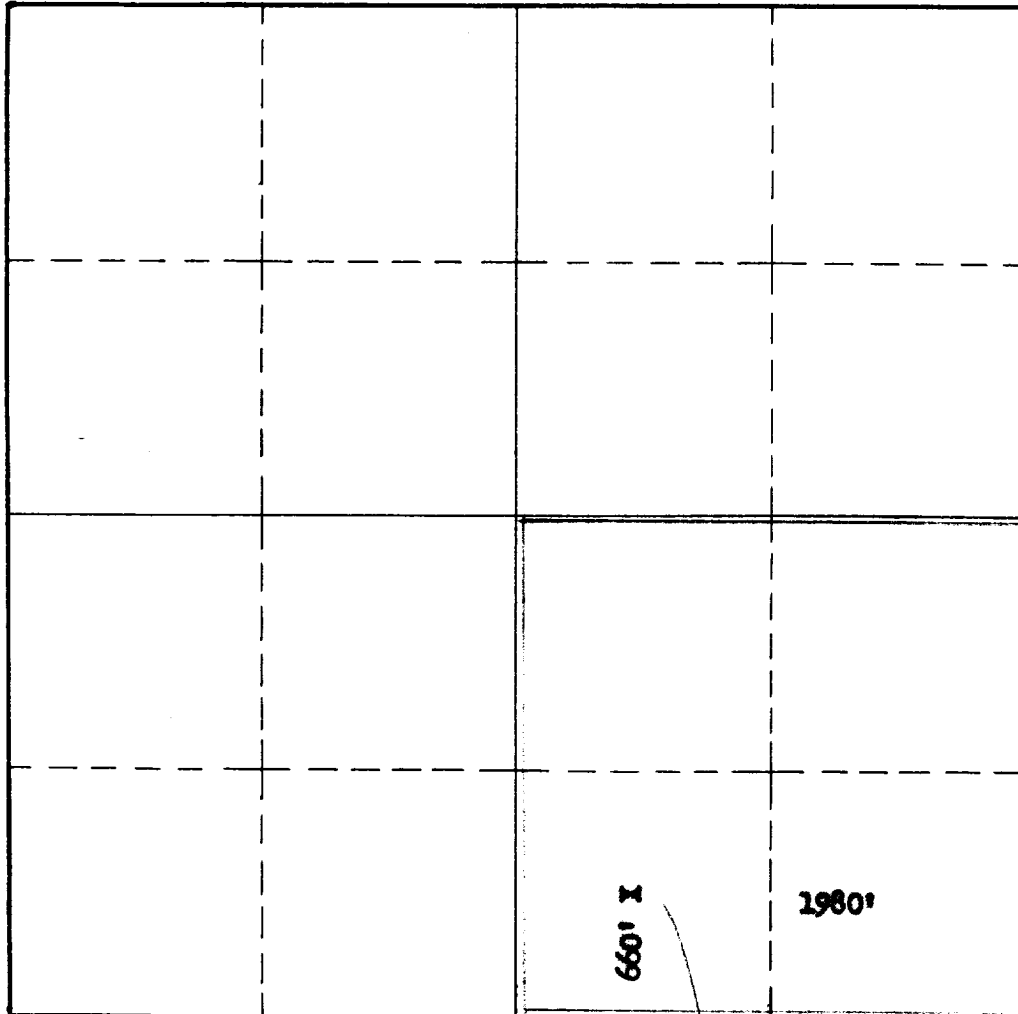

This is to certify that the information in Section A above is true and complete to the best of my knowledge and belief.

Sunray Mid-Continent Oil Co.

(Operator)

[Signature]  
(Representative)

P. O. Box 128 Hobbs, New Mex.

Address

This is to certify that the well location shown on the plat in Section B was plotted from field notes of actual surveys made by me or under my supervision and that the same is true and correct to the best of my knowledge and belief.

Date Surveyed 2-29-56

John W. West

Registered Professional  
Engineer and/or Land Surveyor.

Certificate No. 676

(See instructions for completing this form on the reverse side)

INSTRUCTIONS FOR COMPLETION:

1. Operator shall furnish and certify to the information called for in Section A.
2. Operator shall outline the dedicated acreage for both oil and gas wells on the plat in Section B.
3. A registered professional engineer or land surveyor registered in the State of New Mexico or approved by the Commission shall show on the plat the location of the well and certify this information in the space provided.
4. All distances shown on the plat must be from the outer boundaries of Section.
5. If additional space is needed for listing owners and their respective interests as required in question 3, Section A, please use space below

\* "Owner" means the person who has the right to drill into and to produce from any pool and to appropriate the production either for himself or for himself and another. (65-3-29 (e) NMSA 1953 Comp.)