

WELL LOCATION AND ACREAGE DEDICATION PLAT  
SEE INSTRUCTIONS FOR COMPLETING THIS PLAT ON THE REVERSE SIDEOFFICE O.C.C.  
APR 10 3 07 PM '64

## SECTION A

Operator TEXACO Inc.		Lease State of New Mexico "B0"		Well No. 4
Unit Letter M	Section 13	Township 11 South	Range 32 East	County Lea
Actual Footage Location of Well: 660 feet from the South line and 659 feet from the West line Sec. 13				
Ground Level Elev. 4335	Producing Formation Wolfcamp	Pool Moore (Wolfcamp) Gas	Dedicated Acreage: 160 Acres	

1. Is the Operator the only owner in the dedicated acreage outlined on the plat below? YES X NO \_\_\_\_ . ("Owner" means the person who has the right to drill into and to produce from any pool and to appropriate the production either for himself or for himself and another. (65-3-29 (c) NMSA 1935 Comp.)
2. If the answer to question one is "no," have the interests of all the owners been consolidated by communitization agreement or otherwise? YES \_\_\_\_ NO \_\_\_\_ . If answer is "yes," Type of Consolidation \_\_\_\_
3. If the answer to question two is "no," list all the owners and their respective interests below:

Owner	Land Description

## SECTION B

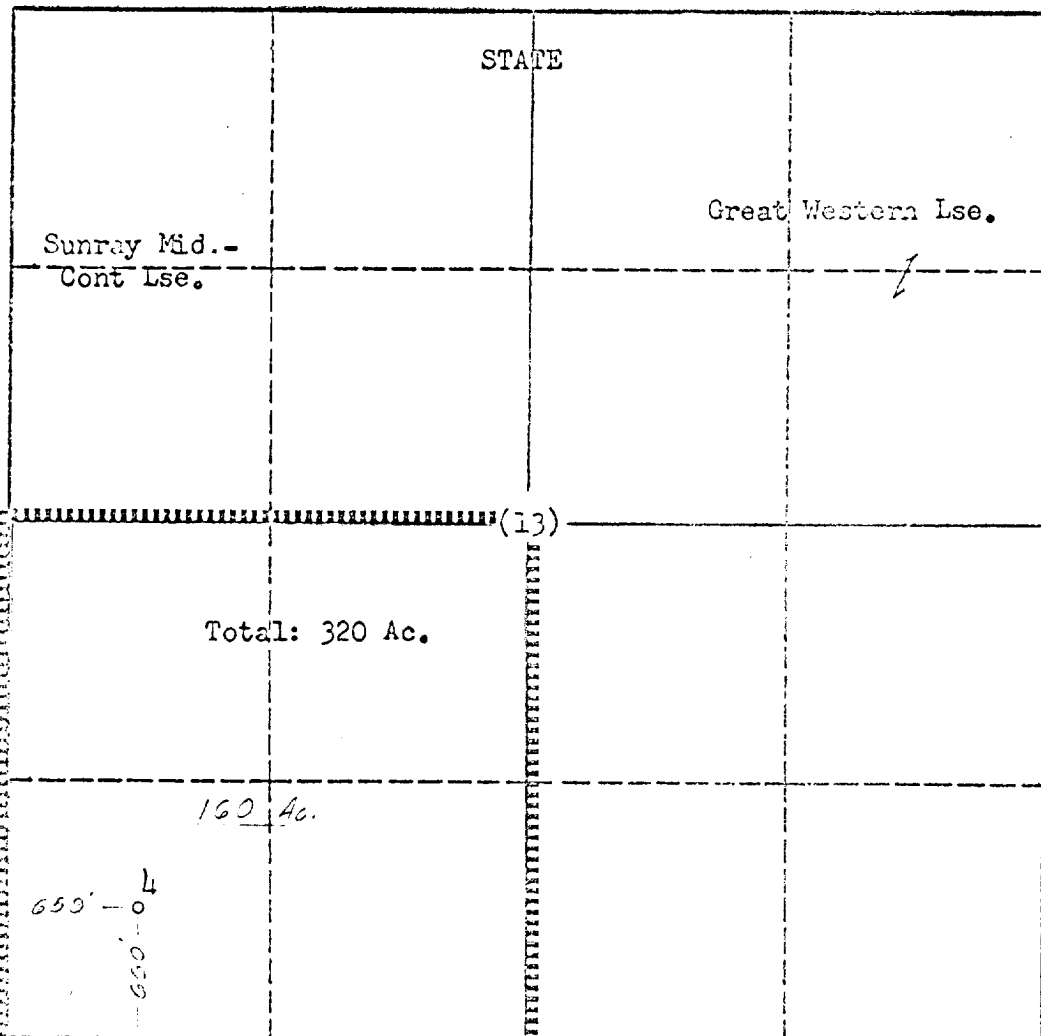

## CERTIFICATION

I hereby certify that the information in SECTION A above is true and complete to the best of my knowledge and belief.

Name J. J. Velten  
Position Division Civil Engineer  
Company TEXACO Inc.  
Date 4/6/64

I hereby certify that the well location shown on the plat in SECTION B was plotted from field notes of actual surveys made by me or under my supervision, and that the same is true and correct to the best of my knowledge and belief.

Date Surveyed 4/15/53  
Registered Professional Engineer and/or Land Surveyor J. J. Velten  
Certificate No. 8174