

NO. OF COPIES RECEIVED		
DISTRIBUTION		
SANTA FE		
FILE		
U.S.G.S.		
LAND OFFICE		
OPERATOR		

NEW MEXICO OIL CONSERVATION COMMISSION

Form C-101
Revised 1-1-65

5A. Indicate Type of Lease STATE <input checked="" type="checkbox"/> FEE <input type="checkbox"/>		
5. State Oil & Gas Lease No.		
7. Unit Agreement Name N.E. CAPROCK (QUEEN) UNIT		
8. Farm or Lease Name		
9. Well No. 6- 11		
10. Field and Pool, or Wildcat Caprock Queen		
12. County Lea		
19. Proposed Depth 3100'	19A. Formation Caprock Queen	20. Rotary or C.T. Rotary
21. Elevations (Show whether DF, RT, etc.) GR - 4373'	21A. Kind & Status Plug. Bond \$10,000 blanket	21B. Drilling Contractor Unknown
22. Approx. Date Work will start At once		

APPLICATION FOR PERMIT TO DRILL, DEEPEN, OR PLUG BACK

1a. Type of Work	
b. Type of Well DRILL <input checked="" type="checkbox"/> DEEPEN <input type="checkbox"/> PLUG BACK <input type="checkbox"/> OIL WELL <input type="checkbox"/> GAS WELL <input type="checkbox"/> OTHER Water Injection <input type="checkbox"/> SINGLE ZONE <input type="checkbox"/> MULTIPLE ZONE <input type="checkbox"/>	
2. Name of Operator Texaco Inc.	
3. Address of Operator P. O. Box 3109, Midland, Texas 79701	
4. Location of Well UNIT LETTER <u>P</u> LOCATED <u>731</u> FEET FROM THE <u>South</u> LINE AND <u>589</u> FEET FROM THE <u>East</u> LINE OF SEC. <u>17</u> TWP. <u>12S</u> RGE. <u>32E</u> NMPM	
19. Proposed Depth 3100'	
19A. Formation Caprock Queen	
20. Rotary or C.T. Rotary	
21. Elevations (Show whether DF, RT, etc.) GR - 4373'	
21A. Kind & Status Plug. Bond \$10,000 blanket	
21B. Drilling Contractor Unknown	
22. Approx. Date Work will start At once	

PROPOSED CASING AND CEMENT PROGRAM

SIZE OF HOLE	SIZE OF CASING	WEIGHT PER FOOT	SETTING DEPTH	SACKS OF CEMENT	EST. TOP
8 3/4"	7"	20#	300'	200*	300% to circulate
6 1/4"	4 1/2"	9.5#	3100'	500**	250% to circulate

*Cement with 200 sx Class "C" neat with 1% calcium chloride (300% to circulate).
**Cement with 300 sx TLW 12.0#/gal with 0.5% FRA followed by 200 sx Incor 4% gel 13.86#/gal. (250% to circulate).

COMPLETION PROGRAM

1. Perforate pay with 1 jspf. 2. Breakdown with 1000 gals. 15% NE acid. 3. Fracture with 20,000 gals. of gelled water with 1# sand per gal.

FORMATION TOPS EXPECTED

Anhydrite	1458'	7 Rivers	2385'
Salt	1550'	Queen	2973'
Yates	2258'	Total Depth	3100'

APPROVAL VALID
FOR 90 DAYS UNLESS
DRILLING COMMENCED.

EXPIRES

IN ABOVE SPACE DESCRIBE PROPOSED PROGRAM; IF PROPOSAL IS TO DEEPEN OR PLUG BACK, GIVE DATA ON PRESENT PRODUCTIVE ZONE AND PROPOSED NEW PRODUCTIVE ZONE. GIVE BLOWOUT PREVENTER PROGRAM, IF ANY.

I hereby certify that the information above is true and complete to the best of my knowledge and belief.

Signed J. J. Velten Title Division Civil Engineer Date 5/9/66
(This space for State Use)

APPROVED BY _____ TITLE _____ DATE _____

CONDITIONS OF APPROVAL, IF ANY:

NEW MEXICO OIL CONSERVATION COMMISSION
WELL LOCATION AND ACREAGE DEDICATION PLAT

Form C-102
Supersedes C-128
Effective 1-1-65

All distances must be from the outer boundaries of the Section.

Operator TEXACO Inc.		Lease Northeast Caprock (Queen) Unit		Well No. 6
Unit Letter P	Section 17	Township 12 South	Range 32 East	County Lea
Actual Footage Location of Well: 731 feet from the South line and 589 feet from the East line Sec. 17				
Ground Level Elev. 4373	Producing Formation Caprock Queen	Pool Caprock Queen	Dedicated Acreage: 40 Acres	

1. Outline the acreage dedicated to the subject well by colored pencil or hachure marks on the plat below.
2. If more than one lease is dedicated to the well, outline each and identify the ownership thereof (both as to working interest and royalty).
3. If more than one lease of different ownership is dedicated to the well, have the interests of all owners been consolidated by communitization, unitization, force-pooling, etc?

☒ Yes ☐ No If answer is "yes," type of consolidation Unitization & Development Agreement

If answer is "no," list the owners and tract descriptions which have actually been consolidated. (Use reverse side of this form if necessary.)

No allowable will be assigned to the well until all interests have been consolidated (by communitization, unitization, forced-pooling, or otherwise) or until a non-standard unit, eliminating such interests, has been approved by the Commission.

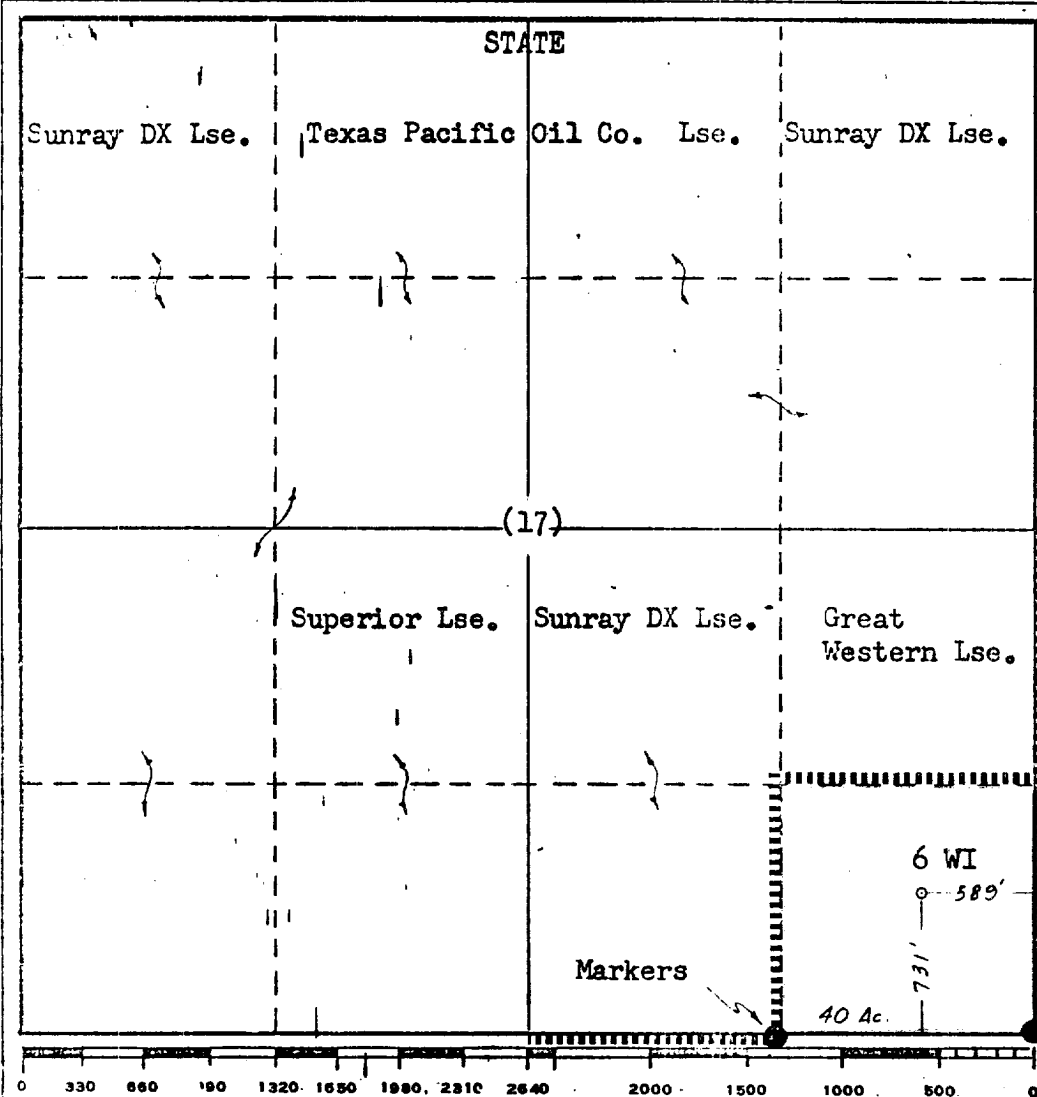

CERTIFICATION

I hereby certify that the information contained herein is true and complete to the best of my knowledge and belief.

Name
J. J. Velten

Position
Division Civil Engineer

Company
TEXACO Inc.

Date
5/9/66

I hereby certify that the well location shown on this plat was plotted from field notes of actual surveys made by me or under my supervision, and that the same is true and correct to the best of my knowledge and belief.

Date Surveyed
5/7/66

Registered Professional Engineer and/or Land Surveyor

J. J. Velten

Certificate No.
8174

HOUSTON OFFICE O. C. C.
MAY 19 10 57 AM '66

OFFSET OPERATORS

Amerada Petroleum Corp.
P. O. Box 312
Midland, Texas

Sunray DX Oil Co.
1101 Wilco Bldg.
Midland, Texas

Mobil Oil Co.
P. O. Box 633
Midland, Texas

Texas Pacific Oil Co.
P. O. Box 4067
Midland, Texas

The Superior Oil Co.
P. O. Box 1900
Midland, Texas

Union Oil Co. of Calif.
619 West Texas
Midland, Texas

Sinclair Oil & Gas Co.
P. O. Box 1470
Midland, Texas

John H. Trigg
P. O. Box 520
Roswell, New Mexico

Skelly Oil Co.
Drawer H
Monahans, Texas