

NEW MEXICO OIL CONSERVATION COMMISSION
Santa Fe, New Mexico

Form O-101
Revised (12/1/55)

NOTICE OF INTENTION TO DRILL

HOODS OFFICE OCC

Notice must be given to the District Office of the Oil Conservation Commission and approval obtained before drilling or recompletion begins. If changes in the proposed plan are considered advisable, a copy of this notice showing such changes will be returned to the sender. Submit this notice in **QUINTUPLICATE**. One copy will be returned following approval. See additional instructions in Rules and Regulations of the Commission. If State Land submit 6 Copies Attach Form O-128 in triplicate to first 3 copies of form O-101

Breckenridge, Texas
(Place)

September 30, 1959
(Date)

OIL CONSERVATION COMMISSION
SANTA FE, NEW MEXICO

Gentlemen:

You are hereby notified that it is our intention to commence the Drilling of a well to be known as

Granridge Corporation

(Company or Operator)

Livermore State "D"
(Lease)

, Well No. 3, in J The well is
(Unit)

located 1980 feet from the South line and 1980 feet from the
East line of Section 30, T. 12S, R. 32E, NMPM.

(GIVE LOCATION FROM SECTION LINE) Caprock Queen Pool, Lea County

If State Land the Oil and Gas Lease is No. B-399-32

If patented land the owner is

Address

We propose to drill well with drilling equipment as follows: 3100' with
rotary equipment

The status of plugging bond is \$10,000 Fidelity & Casualty Company of
New Mexico # 1053517 covering drilling and plugging for
State of New Mexico
Drilling Contractor

(will advise later)

We intend to complete this well in the Queen Sand
formation at an approximate depth of 3050 feet.

CASING PROGRAM

We propose to use the following strings of Casing and to cement them as indicated:

Size of Hole	Size of Casing	Weight per Foot	New or Second Hand	Depth	Sacks Cement
10-3/4"	8-5/8"	28#	Used	300'	200
8-3/4"	5-1/2"	14#	New	3100'	300

If changes in the above plans become advisable we will notify you immediately.

ADDITIONAL INFORMATION (If recompletion give full details of proposed plan of work.)

COPY

Approved _____, 19_____
Except as follows:

CEMENT MUST BE CIRCULATED BEHIND

CASING

OIL CONSERVATION COMMISSION

By _____

Sincerely yours,

Granridge Corporation
(Company or Operator)
By Charles W. Smith

Position Production Clerk
Send Communications regarding well to

Name Granridge Corporation

Address Breckenridge, Texas

NE. MEXICO OIL CONSERVATION COMMISSION

Well Location and Acreage Dedication Plat

Section A.

HOBBS OFFICE OGC
Date September 26, 1959

Operator The Graridge Corporation Lease Livermore State 10 PM 2:58
Well No. 3 Unit Letter J Section 30 Township 12 South Range 32 East NMPM
Located 1980 Feet From South Line, 1980 Feet From East Line
County Lea G. L. Elevation - Dedicated Acreage - 40 Acres
Name of Producing Formation Queen Sand Pool Caprock Queen

1. Is the Operator the only owner* in the dedicated acreage outlined on the plat below?
Yes X No .
2. If the answer to question one is "no," have the interests of all the owners been consolidated by communitization agreement or otherwise? Yes No . If answer is "yes," Type of Consolidation
3. If the answer to question two is "no," list all the owners and their respective interests below:

Owner

Land Description

Section B

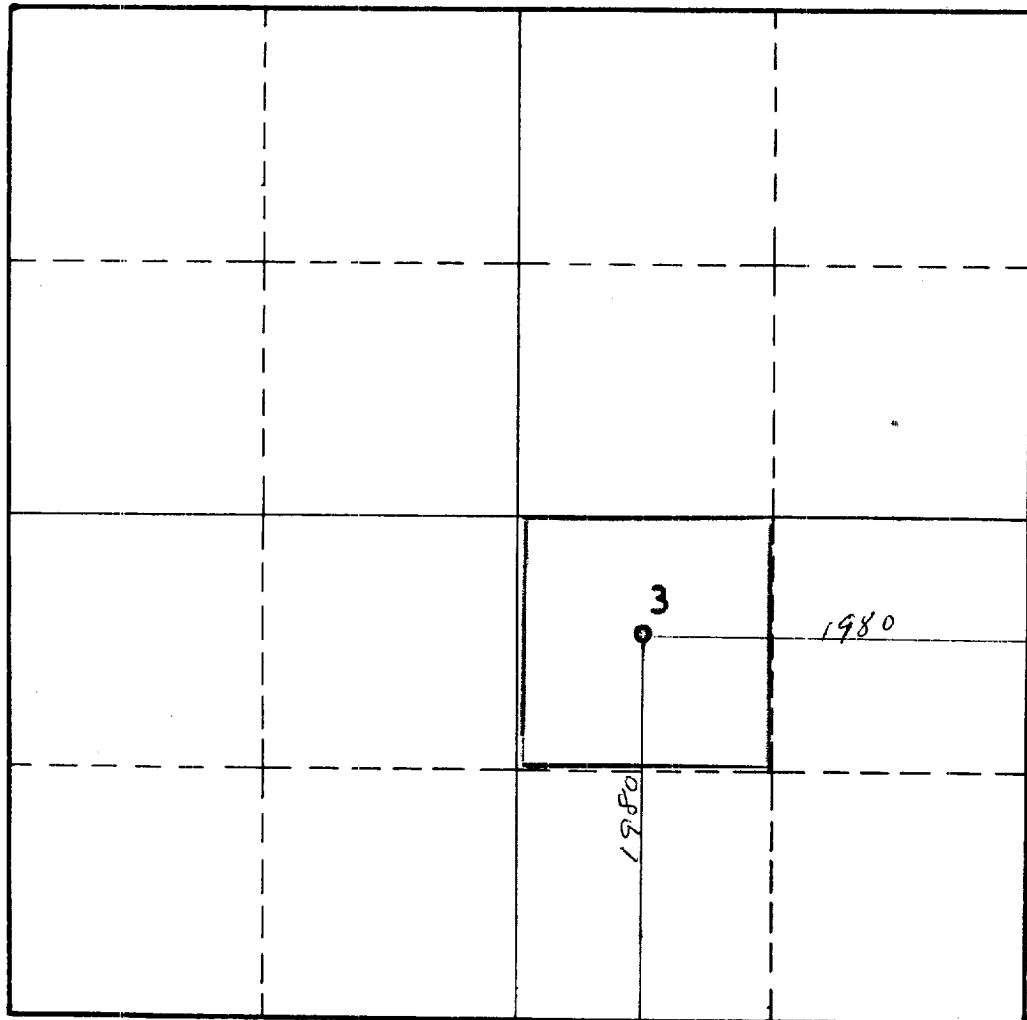

This is to certify that the information in Section A above is true and complete to the best of my knowledge and belief.

Graridge Corporation

(Operator)

Charles A. Mitt
(Representative)

Breckenridge, Texas

Address

This is to certify that the well location shown on the plat in Section B was plotted from field notes of actual surveys made by me or under my supervision and that the same is true and correct to the best of my knowledge and belief.

Date Surveyed 9/26/59

John A. Mathis Jr.
Registered Professional
Engineer and/or Land Surveyor.

Certificate No. 1503

(See instructions for completing this form on the reverse side)

INSTRUCTIONS FOR COMPLETION:

1. Operator shall furnish and certify to the information called for in Section A.
2. Operator shall outline the dedicated acreage for both oil and gas wells on the plat in Section B.
3. A registered professional engineer or land surveyor registered in the State of New Mexico or approved by the Commission shall show on the plat the location of the well and certify this information in the space provided.
4. All distances shown on the plat must be from the outer boundaries of Section.
5. If additional space is needed for listing owners and their respective interests as required in question 3, Section A, please use space below

* "Owner" means the person who has the right to drill into and to produce from any pool and to appropriate the production either for himself or for himself and another. (65-3-29 (e) NMSA 1953 Comp.)