

NEW MEXICO OIL CONSERVATION COMMISSION
WELL LOCATION AND ACREAGE DEDICATION FORM

Form C-102
 Supersedes C-128
 Effective 1-1-65

All distances must be from the outer boundaries of the Section.

| | | | | | |
|---|-----------------------------------|------------------------|-------------------------------|----------------------|---------------------------------------|
| Operator Amoco Production Company | | | Lease Cross Oil Com | | Well No. 1 |
| Unit Letter 0 | Section 35 | Township 9-S | Range 33-E | County Lea | |
| Actual Footage Location of Well: 330 feet from the South line and 1650 feet from the East line | | | | | |
| Ground Level Elev. 4273 | Producing Formation Abo | | Pool Und. Abo | | Dedicated Acreage: 40 Acres |

1. Outline the acreage dedicated to the subject well by colored pencil or hatchure marks on the plat below.
2. If more than one lease is dedicated to the well, outline each and identify the ownership thereof (both as to working interest and royalty).
3. If more than one lease of different ownership is dedicated to the well, have the interests of all owners been consolidated by communitization, unitization, force-pooling, etc?

☐ Yes ☐ No If answer is "yes," type of consolidation _____

If answer is "no," list the owners and tract descriptions which have actually been consolidated. (Use reverse side of this form if necessary.) _____

No allowable will be assigned to the well until all interests have been consolidated (by communitization, unitization, forced-pooling, or otherwise) or until a non-standard unit, eliminating such interests, has been approved by the Commission.

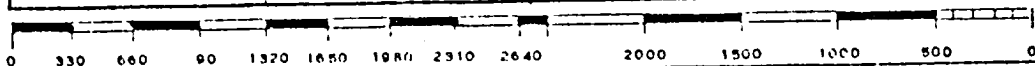
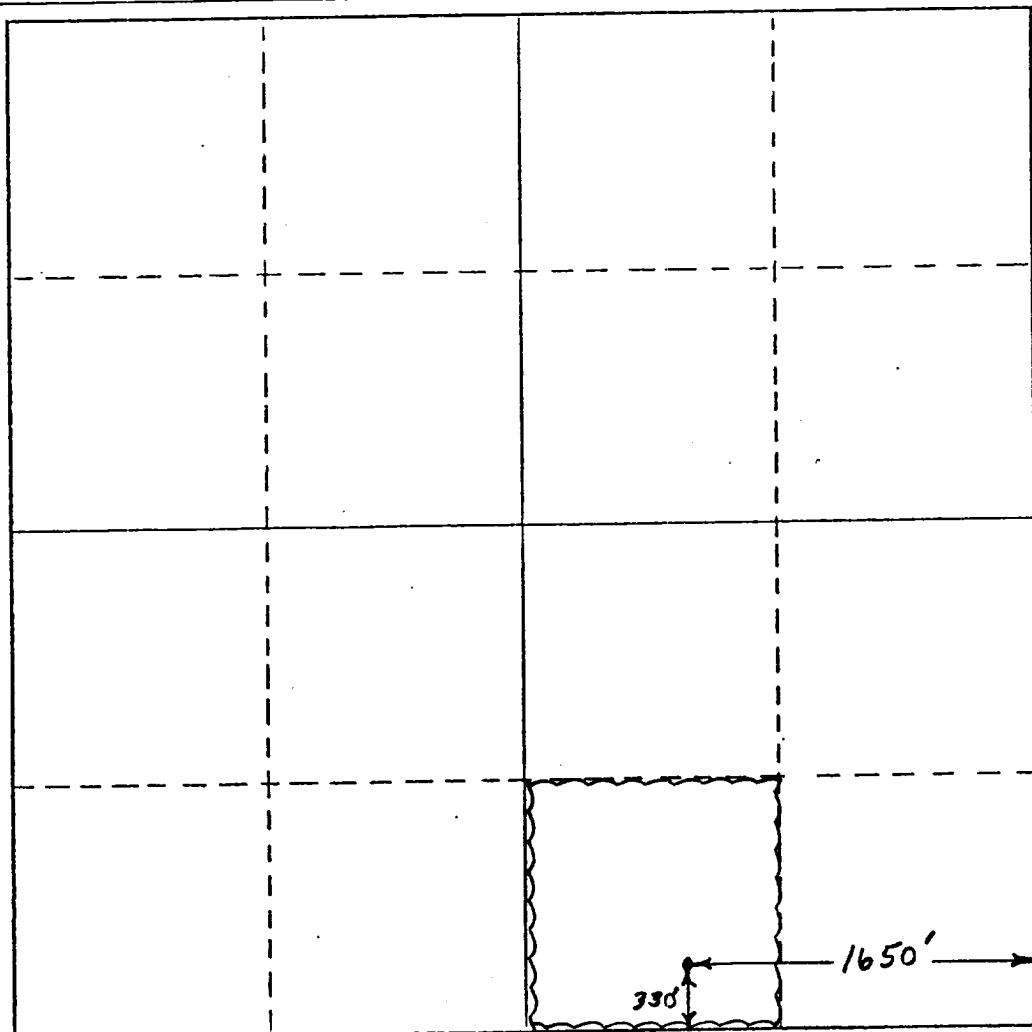

CERTIFICATION

I hereby certify that the information contained herein is true and complete to the best of my knowledge and belief.

Name **Mark Frazman**

Position
Assist. Admin. Analyst

Company
Amoco Production Company

Date
8-17-82

I hereby certify that the well location shown on this plat was plotted from field notes of actual surveys made by me or under my supervision, and that the same is true and correct to the best of my knowledge and belief.

Date Surveyed _____

Registered Professional Engineer and/or Land Surveyor

Certificate No. _____

RECEIVED
AUG 25 1982
C. D.
HOBBS OFFICE