

NEW MEXICO OIL CONSERVATION COMMISSION  
Santa Fe, New Mexico

## NOTICE OF INTENTION TO DRILL OR RECOMPLETE

Notice must be given to the District Office of the Oil Conservation Commission and approval obtained before drilling or recompletion begins. If changes in the proposed plan are considered advisable, a copy of this notice showing such changes will be returned to the sender. Submit this notice in **QUINTUPPLICATE**. One copy will be returned following approval. See additional instructions in Rules and Regulations of the Commission.

If State Land submit 6 Copies

Hobbs, New Mexico

(Place)

May 4, 1957

(Date)

OIL CONSERVATION COMMISSION  
SANTA FE, NEW MEXICO

Gentlemen:

You are hereby notified that it is our intention to commence the (Drilling) (~~Recompletion~~) of a well to be known as

Skelly Oil Company

(Company or Operator)

Hobbs "G"

(Lease)

Well No. 1

in 10<sup>th</sup> E

(Unit)

The well is located 1980 feet from the west north line and 1980 feet from the

line of Section 36, T. 9S, R. 33E, NMPM.

(GIVE LOCATION FROM SECTION LINE)

Lane Wolfcamp

Pool, Lea

County

If State Land the Oil and Gas Lease is No. E-1760

If patented land the owner is

Address

We propose to drill well with drilling equipment as follows: With rotary tools  
from surface to total depth of approx. 9900'.The status of plugging bond is Blanket bond #1253688 for \$10,000 with the  
Federal Insurance Company.

Drilling Contractor Sharp Drilling Company

P.O. Box 1271

Midland, Texas

We intend to complete this well in the Pennsylvanian

formation at an approximate depth of 9900' feet.

## CASING PROGRAM

We propose to use the following strings of Casing and to cement them as indicated:

Size of Hole	Size of Casing	Weight per Foot	New or Second Hand	Depth	Sacks Cement
18"	13-3/8"OD	44.5#	New	350'	350
12-1/4"	8-5/8"OD	32#	New	4000'	1800
7-3/4"	5-1/2"OD	17#	New	9900'	700

If changes in the above plans become advisable we will notify you immediately.

ADDITIONAL INFORMATION (If recompletion give full details of proposed plan of work.)

Halliburton process will be used in cementing all casing and cement will be circulated to surface on the 13-3/8" casing.

Approved \_\_\_\_\_, 19\_\_\_\_  
Except as follows:

OIL CONSERVATION COMMISSION

By E. Fischer

Sincerely yours,

Skelly Oil Company

(Company or Operator)

By J. J. Simlar

Dist. Supt.

Position

Send Communications regarding well to

Name

Skelly Oil Company

Address

Box 38 - Hobbs, New Mexico

NEW MEXICO  
OIL CONSERVATION COMMISSION

Form C-128

Well Location and/or Gas Proration Plat

Date 5-4-1957

Operator Skelly Oil Company

1957 MAY 6

Release

Hobbs "G"

Well No. 1 Section 36 Township 9 South Range 33 East NMPM

Located 1980 Feet From North Line, 1980 Feet From West Line,

Lea

County, New Mexico. G. L. Elevation

Name of Producing Formation Pool Dedicated Acreage

(Note: All distances must be from outer boundaries of Section)

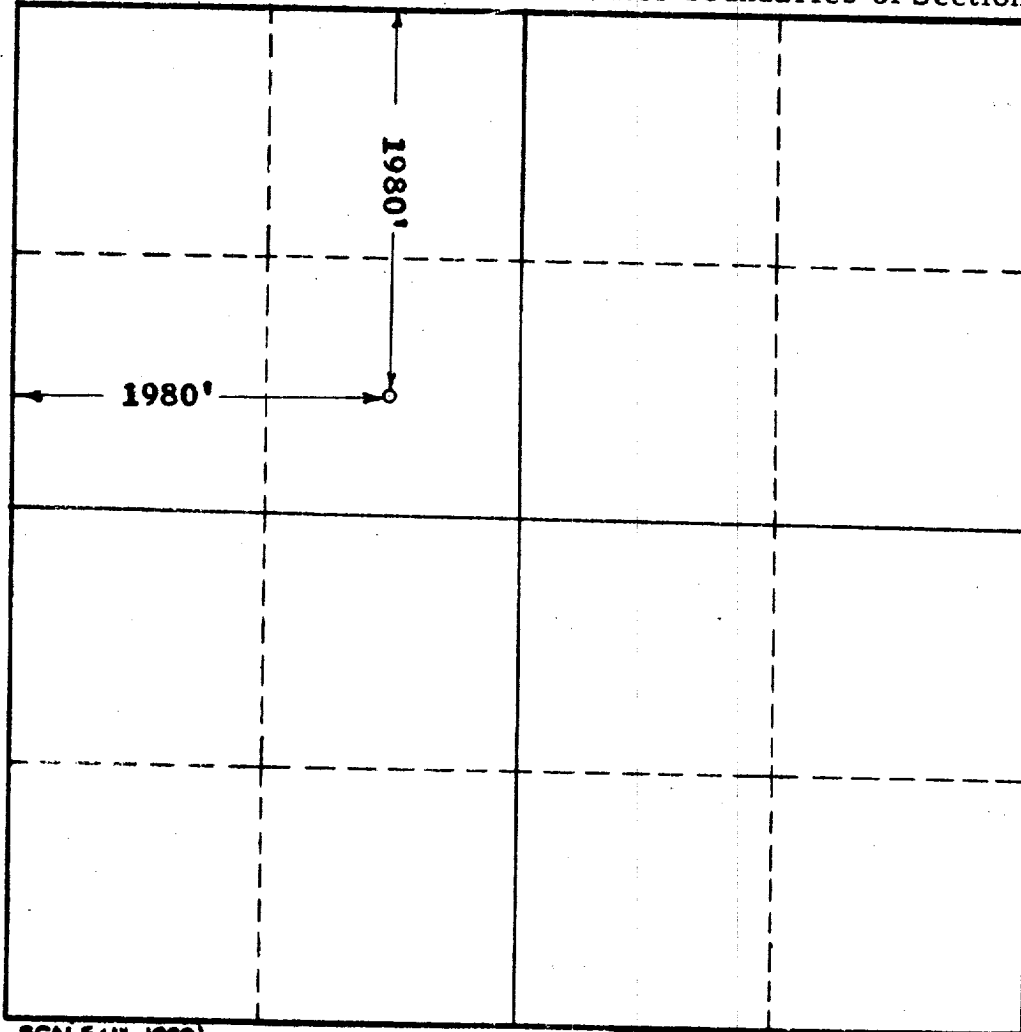

SCALE: 1"=1000'

1. Is this Well a Dual Comp. ? Yes No
2. If the answer to Question 1 is yes, are there any other dually completed wells within the dedicated acreage? Yes No

This is to certify that the above plat was prepared from field notes of actual surveys made by me or under my supervision and that the same are true and correct to the best of my knowledge and belief.

Name John W. West  
Position Surveyor  
Representing Skelly Oil Company  
Address P.O. Box 36 - Hobbs, New Mexico

Date Surveyed 5-3-1957

John W. West  
Registered Professional Engineer and/or  
Land Surveyor

1957 MAY 6 NEW MEXICO  
OIL CONSERVATION COMMISSION

Form C-128

Well Location and ~~Section~~

Date May 6, 1957

Operator Skelly Oil Company Lease Hobbs "N"

Well No. # 1 Section 36 Township 9 - S Range 33 - E NMPM

Located 1980 Feet From North Line, 1980 Feet From West Line,

Lea County, New Mexico. G. L. Elevation \_\_\_\_\_

Name of Producing Formation Wolfcamp Pool Lane-Wolfcamp Dedicated Acreage 80

(Note: All distances must be from outer boundaries of Section)

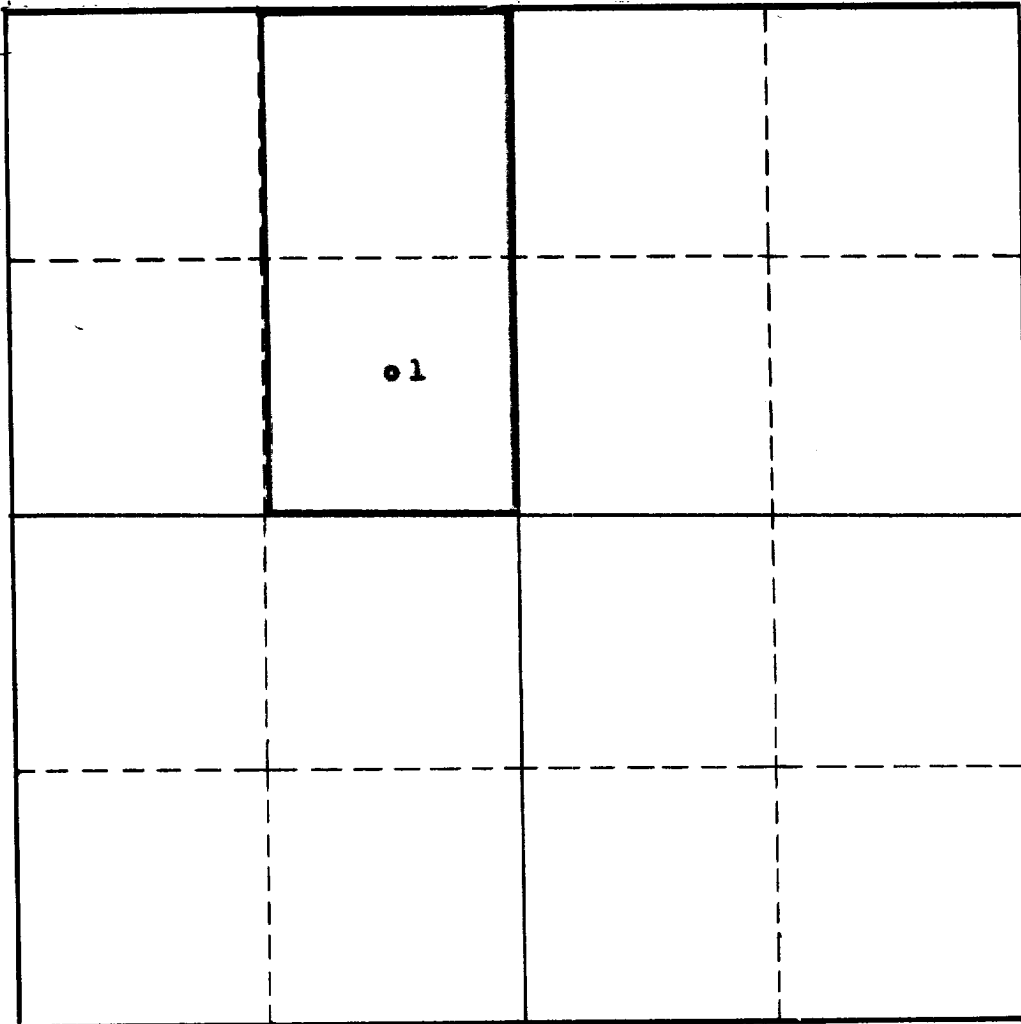

SCALE: 1"=1000'

1. Is this Well a Dual Comp. ? Yes \_\_\_ No X .
2. If the answer to Question 1 is yes, are there any other dually completed wells within the dedicated acreage? Yes \_\_\_ No \_\_\_ .

This is to certify that the above plat was prepared from field notes of actual surveys made by me or under my supervision and that the same are true and correct to the best of my knowledge and belief.

Name J. J. Gindrey  
Position District Superintendent  
Representing Skelly Oil Company  
Address Box 33, Hobbs, New Mexico

Date Surveyed \_\_\_\_\_  
Registered Professional Engineer and/or  
Land Surveyor