

NEW MEXICO OIL CONSERVATION COMMISSION

FORM C-128
Revised 5/1/57

WELL LOCATION AND ACREAGE DEDICATION PLAT

SEE INSTRUCTIONS FOR COMPLETING THIS FORM ON THE REVERSE SIDE

SECTION A

Operator McAlester Fuel Co. & Texas Crude Oil Co.			Lease 1959 FEB 11 PM 2:35		Well No. 1
Unit Letter N	Section 16	Township 11 S	Range 33 E	County Lea	
Actual Footage Location of Well: 1982.5 feet from the West line and 660 feet from the South line					
Ground Level Elev. To be determined later	Producing Formation Wildcat		Pool Undesignated	Dedicated Acreage: 80 40 Acres	

1. Is the Operator the only owner in the dedicated acreage outlined on the plat below? YES _____ NO **X**. ("Owner" means the person who has the right to drill into and to produce from any pool and to appropriate the production either for himself or for himself and another. (65-3-29 (e) NMSA 1935 (comp.))
2. If the answer to question one is "no," have the interests of all the owners been consolidated by communitization agreement or otherwise? YES **X** NO _____. If answer is "yes," Type of Consolidation **Operating Agreement**
3. If the answer to question two is "no," list all the owners and their respective interests below:

Owner	Land Description

SECTION B

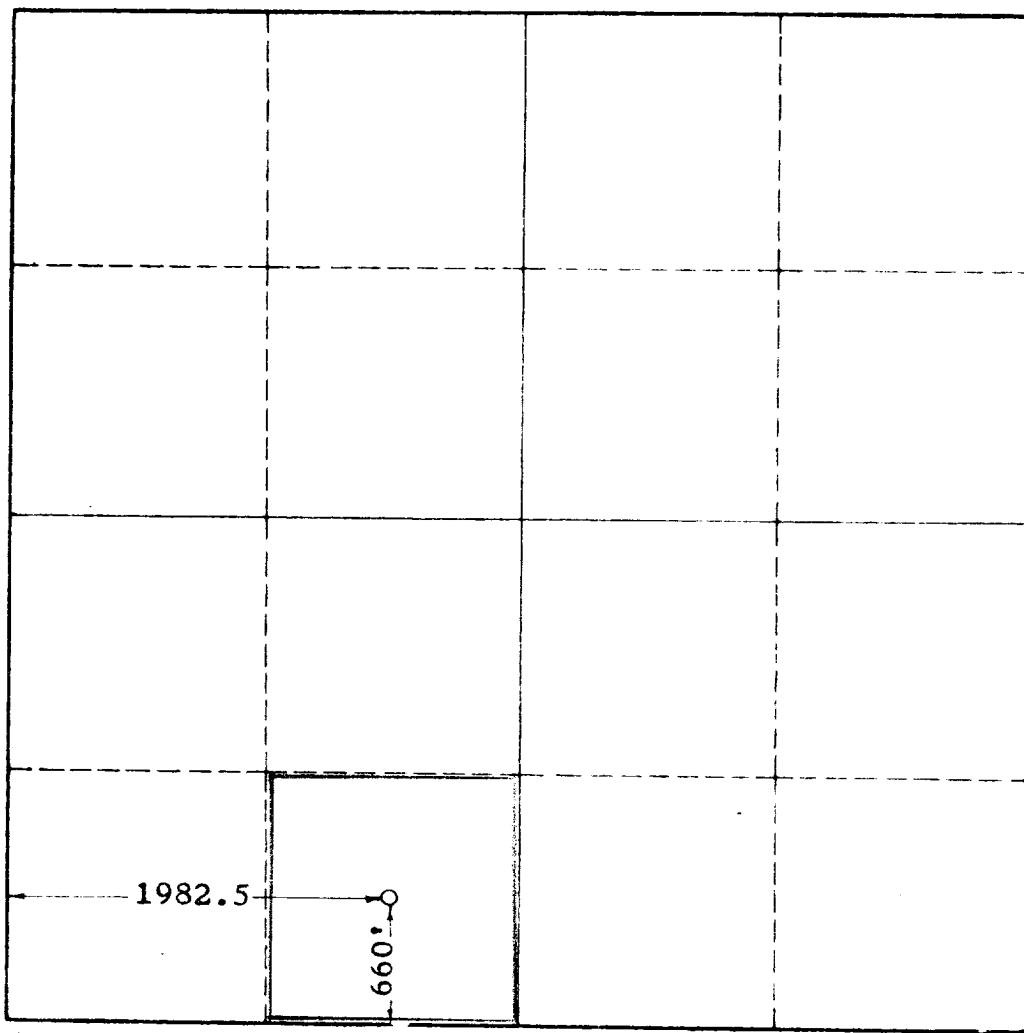

CERTIFICATION

I hereby certify that the information in SECTION A above is true and complete to the best of my knowledge and belief.

Name <i>Vernon Turner</i>
Position Asst. Prod. Supt.
Company McALESTER FUEL COMPANY
Date February 10, 1959

I hereby certify that the well location shown on the plat in SECTION B was plotted from field notes of actual surveys made by me or under my supervision, and that the same is true and correct to the best of my knowledge and belief.

Date Surveyed 2-6-59
Registered Professional Engineer and, or Land Surveyor, JOHN W WEST <i>John W West</i>
Certificate No. N.M. - P.E. & L.S. NO. 676

0 330 660 990 1320 1650 1980 2310 2640 2000 1500 1000 500 0