

SANTA FE	
FILE	
U.S.G.S.	
LAND OFFICE	
TRANSPORTER	OIL
	GAS
PRODUCTION OFFICE	
OPERATOR	

NEW MEXICO OIL CONSERVATION COMMISSION
Santa Fe, New Mexico

Form C-101
Revised (12/1/55)

NOTICE OF INTENTION TO DRILL

Notice must be given to the District Office of the Oil Conservation Commission and approval obtained before drilling or recompletion begins. If changes in the proposed plan are considered advisable, a copy of this notice showing such changes will be returned to the sender. Submit this notice in QUINTUPPLICATE. One copy will be returned following approval. See additional instructions by Rules and Regulations of the Commission. If State Land submit 6 Copies Attach Form C- 128 in triplicate to first 3 copies of form C-101

Odessa, Texas
(Place)

November 8, 1962
(Date)

OIL CONSERVATION COMMISSION
SANTA FE, NEW MEXICO

Gentlemen:

You are hereby notified that it is our intention to commence the Drilling of a well to be known as

L. R. French, Jr.

(Company or Operator)

Gulf State

(Lease)

Well No. 2

C

(Unit)

The well is

located 1834.8 feet from the West line and 660 feet from the North

Line of Section 18, T. 11-S, R. 34-E, NMPM.
(GIVE LOCATION FROM SECTION LINE) Inbe (Penn) Pool, Lea County

If State Land the Oil and Gas Lease is No. E-8447

If patented land the owner is

Address

We propose to drill well with drilling equipment as follows: Rotary Tools to approximately 9900' ±

The status of plugging bond is L. R. French, Jr. - New Mexico
Blanket Plugging Bond for \$10,000 -

Drilling Contractor Forster Drilling Company

We intend to complete this well in the Bough "C"
formation at an approximate depth of 9862' (top) feet.

CASING PROGRAM

We propose to use the following strings of Casing and to cement them as indicated:

Size of Hole	Size of Casing	Weight per Foot	New or Second Hand	Depth	Sacks Cement
16"	13-3/8"	40#	New	375' ±	Circ Cmt.
10-3/4"	8-5/8"	32#	New	9000' ±	450 sks
7-7/8"	4-1/2"	11.6#	New	9900' ±	350 sks

If changes in the above plans become advisable we will notify you immediately.

ADDITIONAL INFORMATION (If recompletion give full details of proposed plan of work.)

Approved _____, 19_____
Except as follows:

OIL CONSERVATION COMMISSION

By John W. Rangan

Sincerely yours,

L. R. French, Jr.

(Company or Operator)

By

L. N. Dunnivant

Position

Production Supt.

Send Communications regarding well to

Name

L. N. Dunnivant

Address

Box 591, Odessa, Texas

NEW MEXICO OIL CONSERVATION COMMISSION
WELL LOCATION AND ACREAGE DEDICATION PLAT

FORM C-128
 Revised 5/1/57

SEE INSTRUCTIONS FOR COMPLETING THIS FORM ON THE REVERSE SIDE

SECTION A

Operator L. R. FRENCH JR.			Lease GULF STATE		Well No. FM 3 30
Unit Letter C	Section 18	Township 11 SOUTH	Range 34 EAST	County LEA	
Actual Footage Location of Well: 1834.8 feet from the WEST line and 660 feet from the NORTH line					
Ground Level Elev. 4198.15	Producing Formation Bough "C"		Pool Inbe (Penn)		Dedicated Acreage: 80 Acres

1. Is the Operator the only owner in the dedicated acreage outlined on the plat below? YES ~~xxx~~ NO _____. ("Owner" means the person who has the right to drill into and to produce from any pool and to appropriate the production either for himself or for himself and another. (65-3-29 (e) NMSA 1935 Comp.)
2. If the answer to question one is "no," have the interests of all the owners been consolidated by communitization agreement or otherwise? YES _____. NO _____. If answer is "yes," Type of Consolidation _____
3. If the answer to question two is "no," list all the owners and their respective interests below:

Owner	Land Description

SECTION B

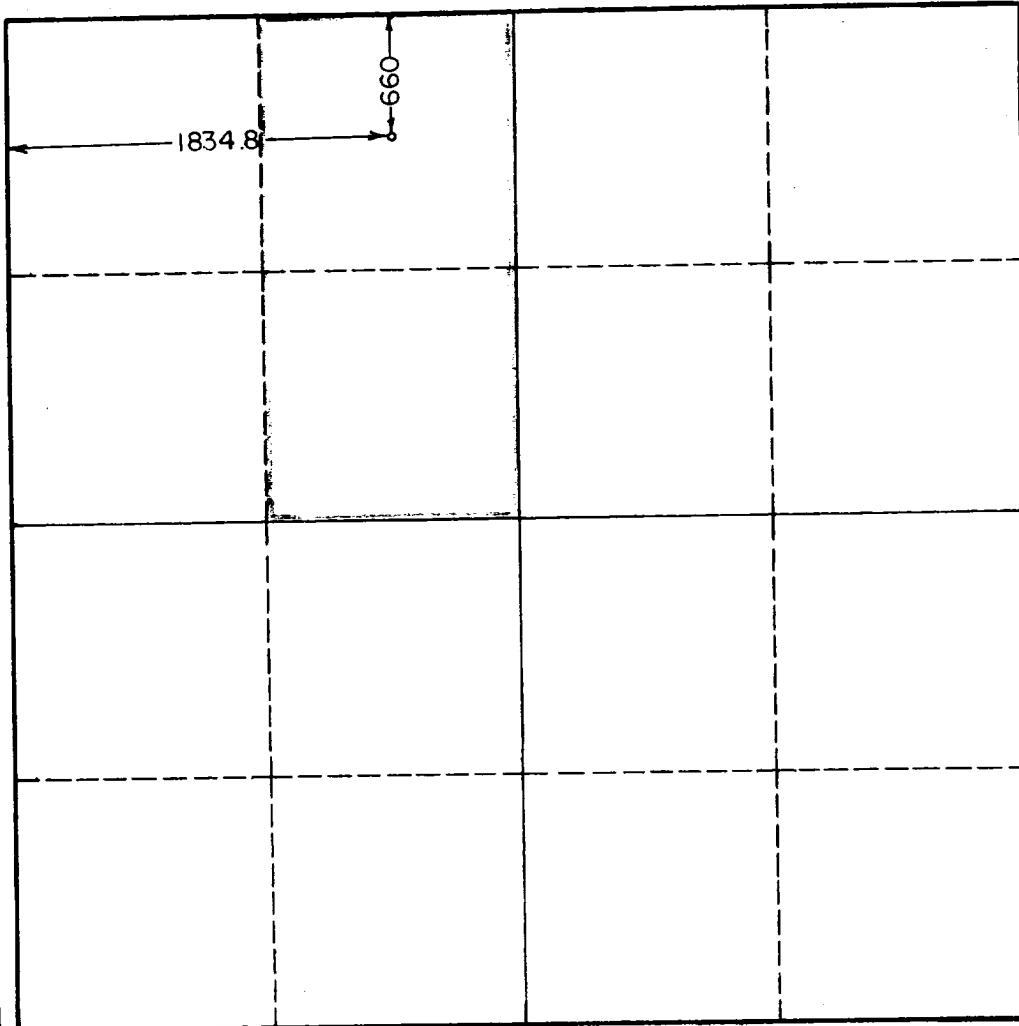

CERTIFICATION

I hereby certify that the information in SECTION A above is true and complete to the best of my knowledge and belief.

L. N. Dunnavant
 Name

L. N. Dunnavant

Position

Production Superintendent

Company

L. R. French, Jr.

Date

November 8, 1962

I hereby certify that the well location shown on the plat in SECTION B was plotted from field notes of actual surveys made by me or under my supervision, and that the same is true and correct to the best of my knowledge and belief.

Date Surveyed

11-7-62

Registered Professional Engineer and/or Land Surveyor

John W. West

Certificate No.

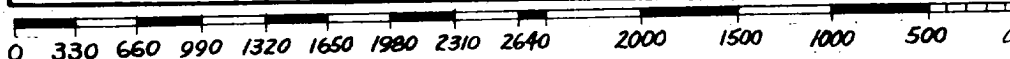

INSTRUCTIONS FOR COMPLETION OF FORM C-128

1. Operator shall furnish and certify to the information called for in Section A.
2. Operator shall outline the dedicated acreage for *both* oil and gas wells on the plat in Section B.
3. A registered professional engineer or land surveyor registered in the State of New Mexico or approved by the Commission shall show on the plat the location of the well and certify this information in the space provided.
4. All distances shown on the plat must be from the outer boundaries of the Section.
5. If additional space is needed for listing owners and their respective interests as required in question 3 of Section A, please use space below.