

API 30-025 01828

HUMBLE LEASE NO. 137670 NEW MEXICO OIL CONSERVATION COMMISSION
STATE LEASE NO. E-2013 Well Location and Acreage Dedication Plat
FEDERAL LEASE NO. _____

Form C-128
Revised 5/1/57

Section A. Date 3-2-61 10-5-62

Operator Humble Oil & Refining Co. Lease South Four Lakes Unit
Well No. 7 Unit Letter J-I Section 35 Township 11-S Range 34-E NMPM
Located 1980 Feet From South Line, 660 Feet From East Line
County Leo G. L. Elevation Later Dedicated Acreage 80 Acres
Name of Producing Formation Pennsylvania Pool South Four Lake Penn

1. Is the Operator the only owner* in the dedicated acreage outlined on the plat below?

Yes _____ No X

2. If the answer to question one is "no", have the interests of all the owners been consolidated by communitization agreement or otherwise? Yes X No _____ If answer is "yes," Type of Consolidation Unitization

3. If the answer to question two is "no," list all the owners and thier respective interests below:

Owner

Land Description

Section B

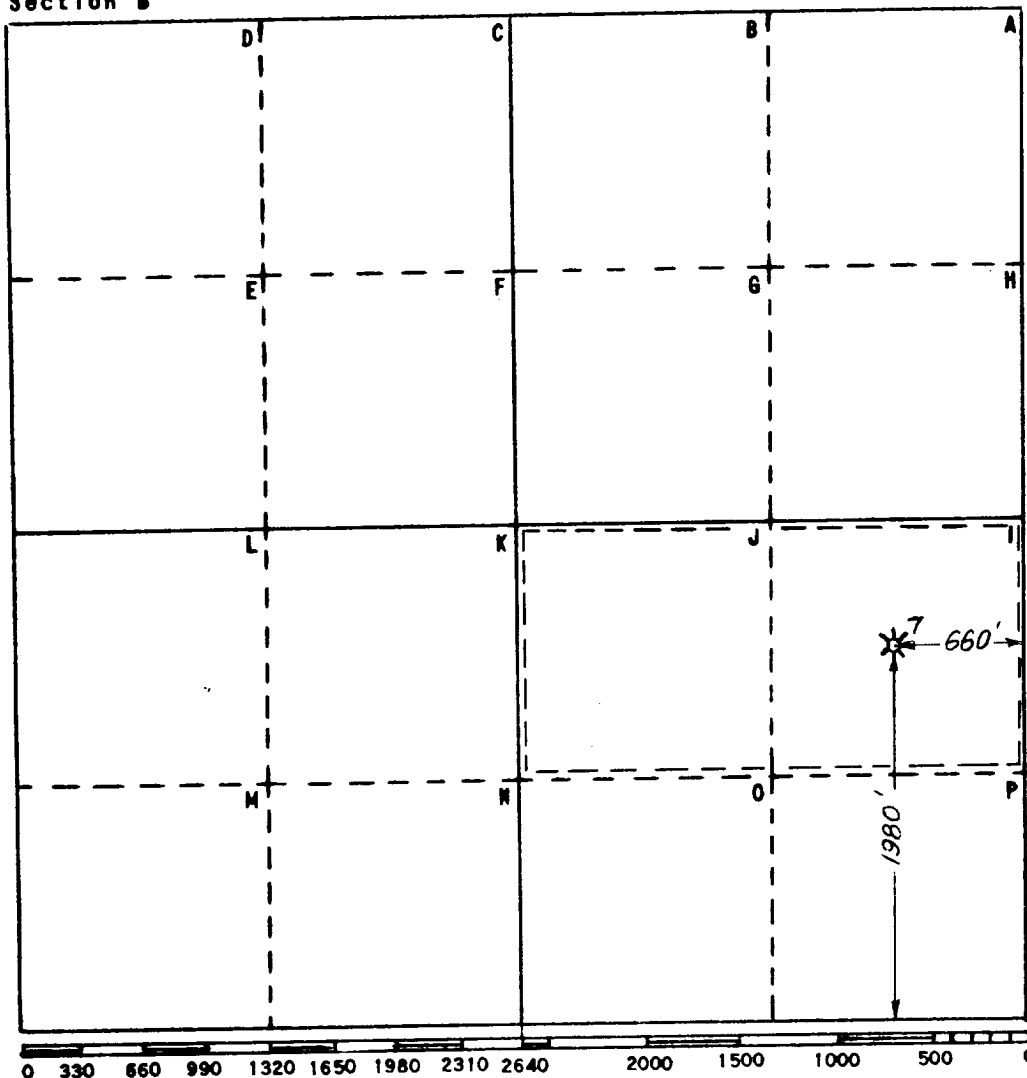

This is to certify that the information in Section A above is true and complete to the best of my knowledge and belief

HUMBLE OIL & REFG. CO.
(Operator)

H. E. Hensley
(Representative)

Box 1600 Midland, Texas
Address

This is to certify that the well location shown on the plat in Section B was plotted from field notes of actual surveys made by me or under my supervision and that the same is true and correct to the best of my knowledge and belief.

Date Surveyed 2-28-61

Herbert S. Westerfeld
Registered Professional
Engineer and/or Land Surveyor

Certificate No. 1382

FILE NO. W-A-2289