

NEW MEXICO OIL CONSERVATION COMMISSION
WELL LOCATION AND ACREAGE DEDICATION PLAT

Form O-102
Supersedes O-128
Effective 1-1-65

All distances must be from the outer boundaries of the Section.

McGRATH & SMITH, INC.		BETENBOUGH		Well No. 1	
Tract Letter " N"	Section 12	Township 9-S	Range 35 - E	County LEA	
Amount of the Location of Well:					
1980		feet from the WEST		feet from the SOUTH	
660		660		660	
Ground Level Elev. 4128 D.F.	Producing Formation PERMO - PENN		Borough PERMO - PENN		Section Acres 40

1. Outline the acreage dedicated to the subject well by colored pencil or hachure marks on the plat below.

2. If more than one lease is dedicated to the well, outline each and identify the ownership thereof (both as to working interest and royalty).

3. If more than one lease of different ownership is dedicated to the well, have the interests of all owners been consolidated by communitization, unitization, force-pooling, etc?

☐ Yes ☐ No If answer is "yes," type of consolidation _____

If answer is "no," list the owners and tract descriptions which have actually been consolidated. (Use reverse side of this form if necessary.) _____

No allowable will be assigned to the well until all interests have been consolidated (by communitization, unitization, forced-pooling, or otherwise) or until a non-standard unit, eliminating such interests, has been approved by the Commission.

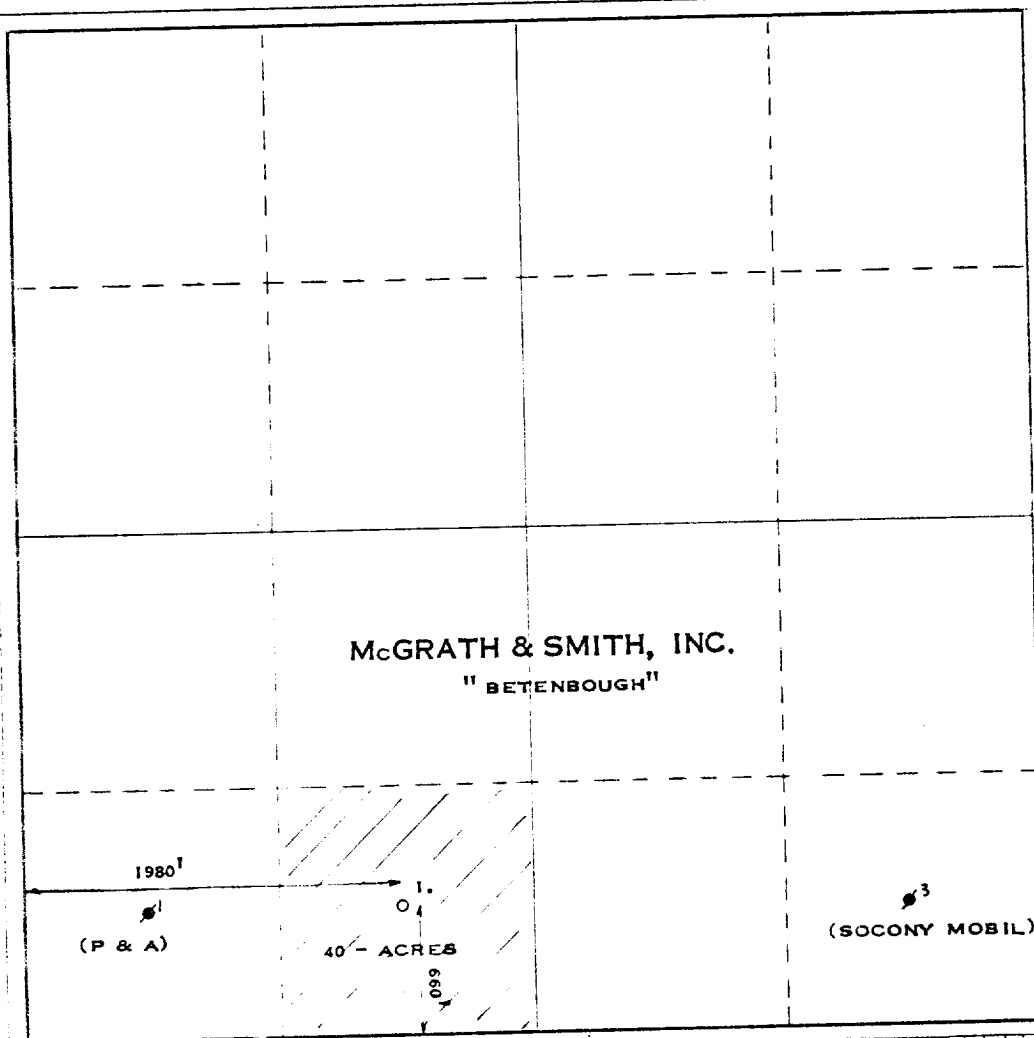

CERTIFICATION

I hereby certify that the information contained herein is true and complete to the best of my knowledge and belief.

Name
J. B. Taylor
Position
Engineer
Company
McGrath & Smith, Inc.
Date
Feb. 25, 1969

I hereby certify that the well location shown on this plat was plotted from field notes of actual surveys made by me or under my supervision, and that the same is true and correct to the best of my knowledge and belief.

Date surveyed
FEBRUARY 25, 1969

Registered Professional Surveyor
Max A. Schumann Jr.
MAX A. SCHUMANN JR.
Certificate No. **1510**