

RECEIVED  
JAN 26 1950  
Form X-31  
NEGATIVE  
HOBBS OFFICE

*Bough Field*  
**Magnolia Petroleum Company**  
PRODUCING DEPARTMENT

Location made Jan. 20 th, 1950

T. Betenbough Well No. 2

Lea District  
Lease NM-1013- acres 320 Sec. 12, T 9 S, R 35 E } District  
Township

Lea County, New Mexico

Scale 1" = 500' N S E W

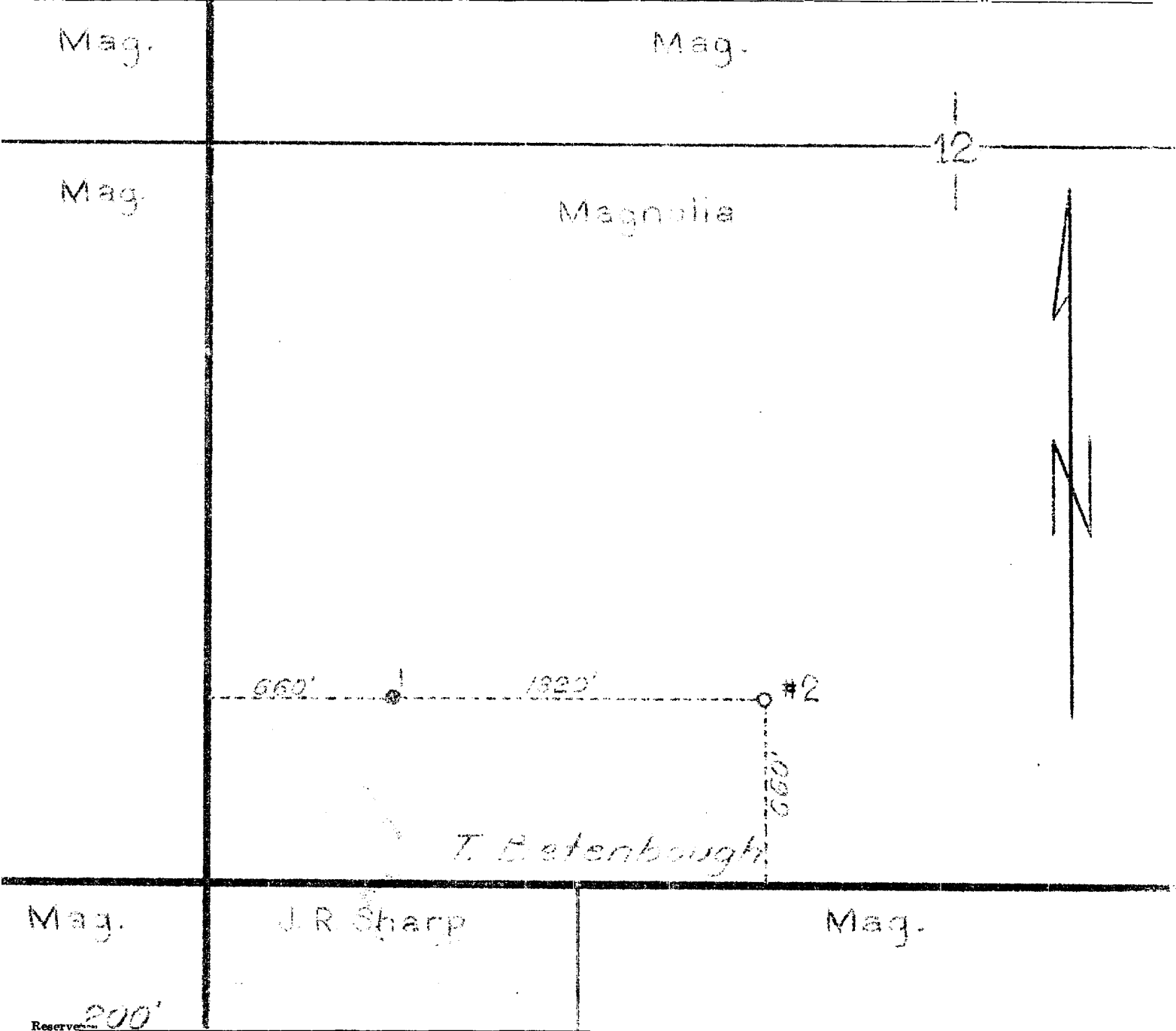

Special instructions \_\_\_\_\_  
\_\_\_\_\_

Location changed on account of \_\_\_\_\_

Date work is commenced \_\_\_\_\_ 194 \_\_\_\_\_ Supt \_\_\_\_\_

Location approved by \_\_\_\_\_ Plat made by K.C. Lawless

JAN 26 1950

**Magnolia Petroleum Company**  
**PRODUCING DEPARTMENT**

Location for Well No. \_\_\_\_\_

\_\_\_\_\_

File No. \_\_\_\_\_

**ELF**

COUNTY	LEA	FIELD	Bough	STATE	NM	D.	02645	OWWO
OPR	MC CRATH & SMITH, INC.						MAP	
	1 Betenbough							
	Sec 12, T-9-S, R-35-E							
	660' FSL, 1980' FWL of Sec.							
	Re-Spd 2-28-69							
	Re-Cmp 4-7-69							
		CLASS				EL		
		FORMATION	DATUM	FORMATION	DATUM			
CSG & SX - TUBING								
13 3/8" at 353' w/350 sx								
9 5/8" at 4438' w/2300 sx								
7" at 9606' w/1950 sx (pulled)								
5" at 9585' w/35 sx.								
LOGS	EL	GR	RA	IND	HC	A		
								TD 9639'

IP (Bough "C") OH 9606-39' F 156 BOPD + 30 BW. Pot based on 24 hr test thru 24/64" chk. COR 1921; Grav 48; CP Pkr; TP 650#.

Distribution limited and publication prohibited by subscribers' agreement.  
 Reproduction rights reserved by Williams & Lee Scouting Service, Inc.

CONT.	PROP DEPTH	9639'	TYPE	WO
DATE				

- F.R. 3-4-69
- PD 9639' WO (Bough "C")
- (Orig. Magnolia Pet. Co. #2 Betenbough A, comp from OH 9606-39', OTD 9639')
- 3-10-69 TD 9639'; CO
- 3-17-69 TD 9639'; SD Weather
- 3-24-69 TD 9639'; Prep run 5" casing
- 3-31-69 TD 9639'; Drlg. cmt
- Ran 5" casing
- 4-7-69 TD 9639'; Tstg
- Acid (9606-39') 1000 gals
- Flwd 109 BF in 4 hrs thru 24/64" chk, TP 600#
- 4-14-69 TD 9639'; COMPLETE
- 4-17-69 COMPLETION REPORTED