

(SUBMIT IN TRIPLICATE)

UNITED STATES  
DEPARTMENT OF THE INTERIOR  
GEOLOGICAL SURVEY

SUNDRY NOTICES AND REPORTS ON WELLS

NOTICE OF INTENTION TO DRILL	<input checked="" type="checkbox"/>	COMPLETION REPORT OF WATER WELL
NOTICE OF INTENTION TO CHANGE PLASS	<input type="checkbox"/>	COMPLETION REPORT OF MINERAL WELL
NOTICE OF INTENTION TO TEST WATER SHUT-OFF	<input type="checkbox"/>	COMPLETION REPORT OF ALTITUDE CORRECTION
NOTICE OF INTENTION TO RE-GRILL OR REPAIR WELL	<input type="checkbox"/>	COMPLETION REPORT OF REMEDIAL OR REPAIR
NOTICE OF INTENTION TO SHOOT OR ACIDIZE	<input type="checkbox"/>	COMPLETION REPORT OF REMEDIAL OR REPAIR
NOTICE OF INTENTION TO PULL OR ALTER CASING	<input type="checkbox"/>	COMPLETION REPORT OF REMEDIAL OR REPAIR
NOTICE OF INTENTION TO ABANDON WELL	<input type="checkbox"/>	COMPLETION REPORT OF REMEDIAL OR REPAIR

(CHECK ONE ABOVE BY CHECKING IN THE BOXES OF INTENTION, REPORT, OR REMEDIAL OR REPAIR)

Well No. 1 is located 660 ft. from the and 660 ft. from the

NEA NEA 9-5 34-5  
(in section 9-5) (top) (bottom) (bottom)  
Wildcat 100 100 100  
(ft.) (ft.) (ft.)

The elevation of the derived floor above sea level is 9725 ft. (Est.)

DETAILS OF WORK

Continuation of last report No. 1 to 100 ft. from the and 100 ft. from the

Observation - Limestone of Wolfcamp age which produces in the lower part of the well to depth 9725 ft.

Casing Program - 13 3/8" O.D. 5' to 20' 200 lbs. casing.  
5 5/8" O.D. 30' to 1500' 1500 lbs. casing.  
5 1/2" O.D. 15' to 1500' 1500 lbs. casing.

Start casing @ approximately 9700 ft. Run electric log to total depth of well. Then test pay zone. Perforate 5 1/2" casing opposite pay zone.

I understand that this plan of work must receive approval of the Geological Survey before execution.

Company Bechtel Oil Corporation  
Address 1329 Milam Building  
San Antonio, Texas

By John A. Bechtel

The undersigned

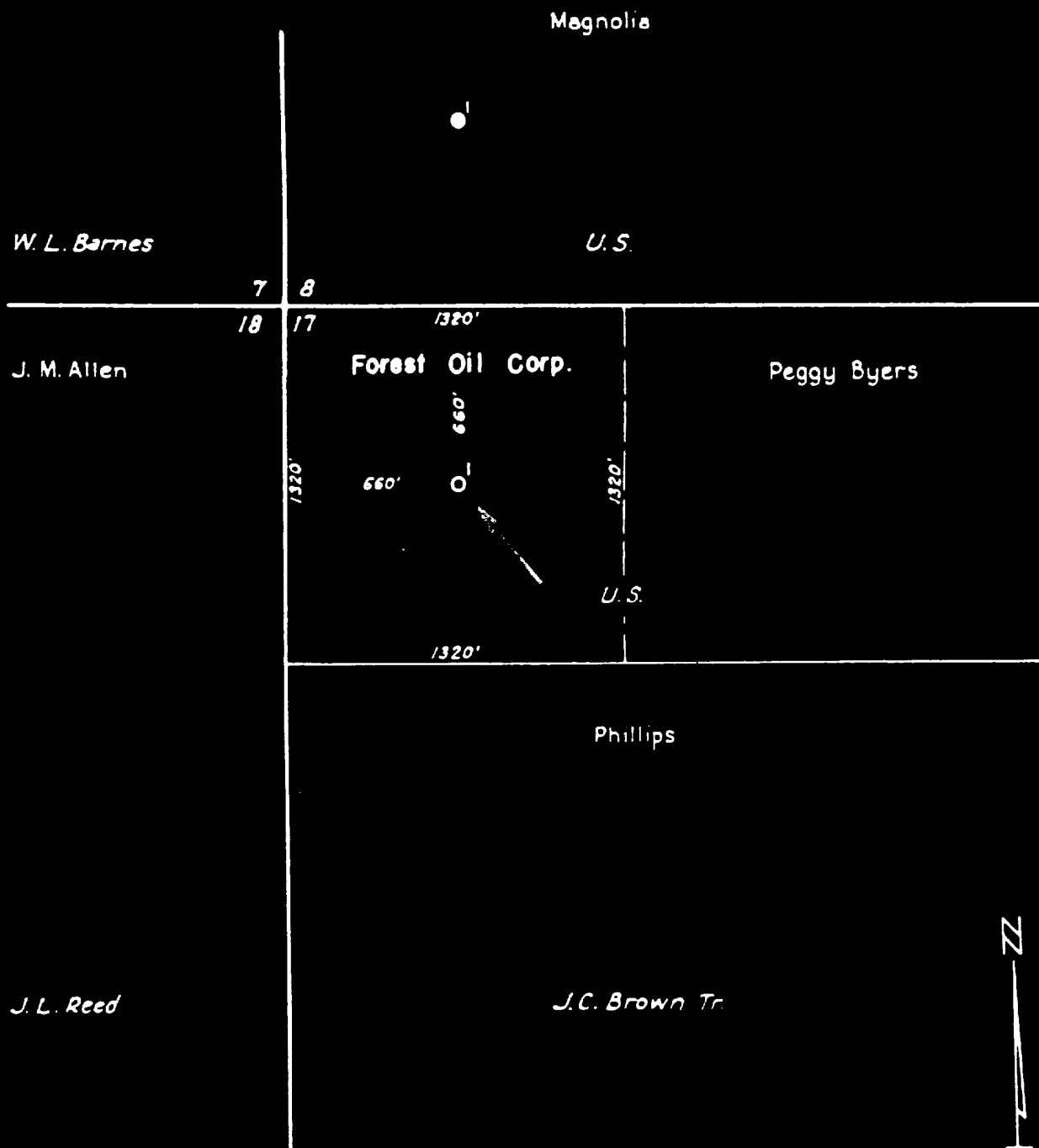

I, J. F. Johnson, hereby certify that this survey was made by me on the ground and that this plat is true and correct.

*J. F. Johnson*

Licensed State Land Surveyor  
Midland County, Texas

**FOREST OIL CORPORATION**  
FEDERAL-WARREN LEASE  
NW/4, NW/4, SURVEY 17, T-9-S, R36E  
LEA COUNTY, NEW MEXICO  
SCALE: 1"=600'