

NO. OF COPIES RECEIVED	
DISTRIBUTION	
SANTA FE	
FILE	
U.S.G.S.	
LAND OFFICE	
OPERATOR	

# NEW MEXICO OIL CONSERVATION COMMISSION

Form C-101  
Revised 1-1-65

5A. Indicate Type of Lease	
STATE <input type="checkbox"/>	FEE <input checked="" type="checkbox"/>
5. State Oil & Gas Lease No.	

## APPLICATION FOR PERMIT TO DRILL, DEEPEN, OR PLUG BACK

1a. Type of Work <b>Re-enter and directionally drill</b>		7. Unit Agreement Name	
b. Type of Well DRILL <input type="checkbox"/> DEEPEN <input type="checkbox"/> PLUG BACK <input type="checkbox"/> OIL WELL <input checked="" type="checkbox"/> GAS WELL <input type="checkbox"/> OTHER <input type="checkbox"/> SINGLE ZONE <input checked="" type="checkbox"/> MULTIPLE ZONE <input type="checkbox"/>		8. Farm or Lease Name <b>H. L. Vinson</b>	
2. Name of Operator <b>Stolts, Wagner &amp; Brown</b>		9. Well No. <b>1 (formerly No. 2)</b>	
3. Address of Operator <b>P. O. Box 1714, Midland, Texas 79701</b>		10. Field and Pool, or Wildcat <b>Crossroads Siluro Dev.</b>	
4. Location of Well UNIT LETTER <b>G</b> LOCATED <b>1980</b> FEET FROM THE <b>North</b> LINE AND <b>1980</b> FEET FROM THE <b>East</b> LINE OF SEC. <b>22</b> TWP. <b>9-S</b> RGE. <b>36-E</b> NMPM		12. County <b>Lea</b>	
21. Elevations (Show whether DF, RT, etc.) <b>4037' OR</b>		21A. Kind & Status Plug. Bond <b>Blanket Bond</b>	21B. Drilling Contractor <b>M G F Drilling Co., Inc.</b>
21C. Proposed Depth <b>12,300'</b>		21D. Formation <b>Devonian</b>	21E. Rotary or C.T. <b>Rotary</b>
22. Approx. Date Work will start <b>9/15/74</b>			

## PROPOSED CASING AND CEMENT PROGRAM

SIZE OF HOLE	SIZE OF CASING	WEIGHT PER FOOT	SETTING DEPTH	SACKS OF CEMENT	EST. TOP
Unknown	13-3/8"	Unknown	372'	400 sacks	Surface
Unknown	9-5/8"	Unknown	4000'	1800 sacks	Circulated
Unknown	5-1/2"	Unknown	12230 (pulled 8500')		
7-7/8"	4-1/2"	11.60 & 13.50#	4000-12300'	200 sacks	11,500'

This well was originally drilled to 12,250' and completed by Warren Petroleum Company as their H. L. Vinson, Well No. 2, and was plugged and abandoned in 1972, by Gulf Oil Corp.

We propose to re-enter and wash down to 8400', sidetrack the hole and directionally drill to a bottom hole location of which the center of the target will be 2310 feet from the North line and 1380 feet from the East line with a 180-foot radius of tolerance. We will run 4000' of 4-1/2", 11.60# N80 and 13.50# N80 casing and cement with 200 sacks.

APPROVAL VALID  
FOR 90 DAYS UNLESS  
DRILLING COMMENCED,

EXPIRES 12-6-74

IN ABOVE SPACE DESCRIBE PROPOSED PROGRAM; IF PROPOSAL IS TO DEEPEN OR PLUG BACK, GIVE DATA ON PRESENT PRODUCTIVE ZONE AND PROPOSED NEW PRODUCTIVE ZONE. GIVE BLOWOUT PREVENTER PROGRAM, IF ANY.

I hereby certify that the information above is true and complete to the best of my knowledge and belief.

Signed R. Bunkley Title Agent Date September 4, 1974

APPROVED BY [Signature] TITLE SUPERVISOR DISTRICT I SEP 6 1974

CONDITIONS OF APPROVAL, IF ANY. No allowable will be assigned this well until the directional drilling is approved after notice and hearing.

**NEW MEXICO OIL CONSERVATION COMMISSION**  
**WELL LOCATION AND ACREAGE DEDICATION PLAT**

Form C-102  
 Supersedes C-128  
 Effective 1-1-65

All distances must be from the outer boundaries of the Section.

Operator <b>Stoltz, Wagner &amp; Brown</b>			Lease <b>H. L. Vinson</b>		Well No. <b>1</b>
Unit Letter <b>G</b>	Section <b>22</b>	Township <b>9-South</b>	Range <b>36-East</b>	County <b>Lea</b>	
Actual Footage Location of Well: <b>Surface location: 1980' FNL &amp; 1980' FEL; bottom hole location:</b>					
<b>2310</b>		feet from the <b>North</b>	line and <b>1320</b>	feet from the <b>East</b>	line w/180' tolerance
Ground Level Elev. <b>4037'</b>	Producing Formation <b>Devonian</b>		Pool <b>Crossroads Siluro Devonian</b>		Dedicated Acreage: <b>80</b> Acres

1. Outline the acreage dedicated to the subject well by colored pencil or hachure marks on the plat below.
2. If more than one lease is dedicated to the well, outline each and identify the ownership thereof (both as to working interest and royalty).
3. If more than one lease of different ownership is dedicated to the well, have the interests of all owners been consolidated by communitization, unitization, force-pooling, etc?

☐ Yes    ☐ No    If answer is "yes," type of consolidation \_\_\_\_\_

If answer is "no," list the owners and tract descriptions which have actually been consolidated. (Use reverse side of this form if necessary.) \_\_\_\_\_

No allowable will be assigned to the well until all interests have been consolidated (by communitization, unitization, forced-pooling, or otherwise) or until a non-standard unit, eliminating such interests, has been approved by the Commission.

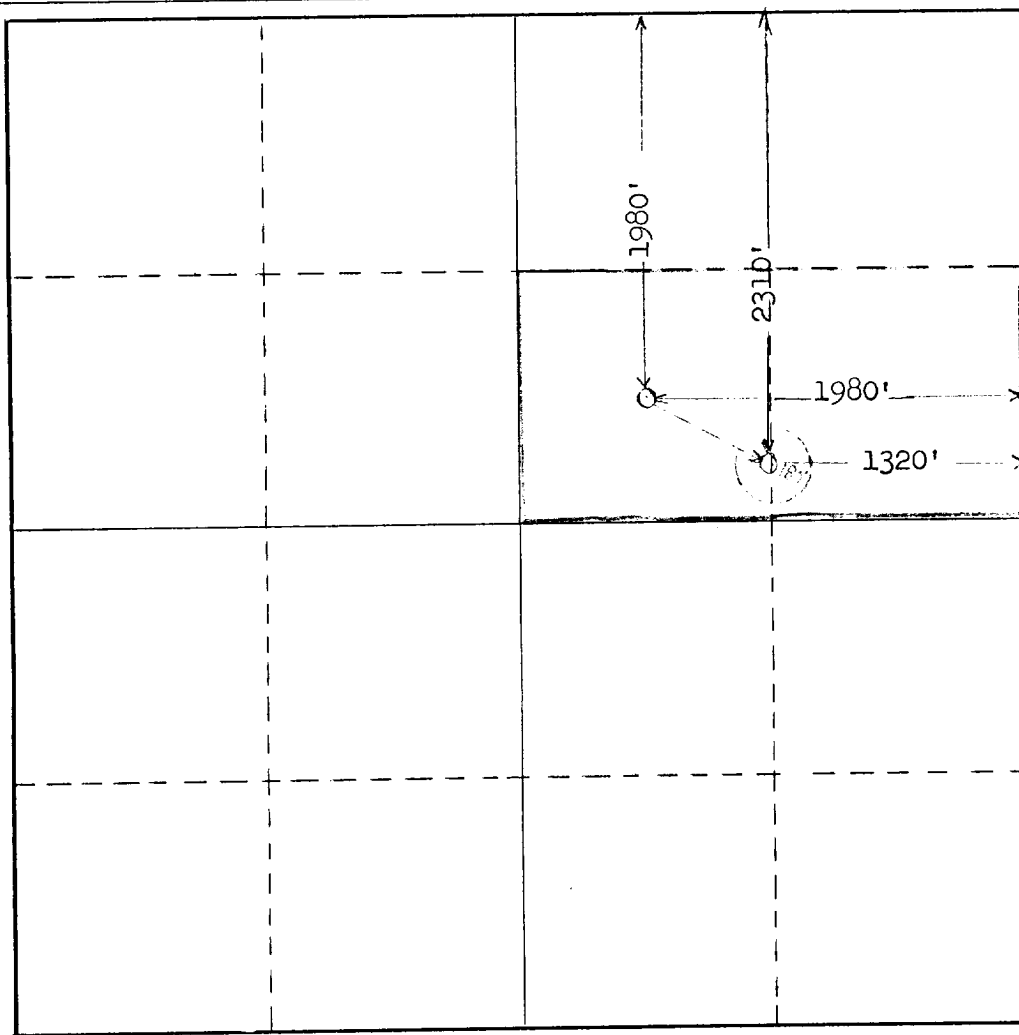

**CERTIFICATION**

*I hereby certify that the information contained herein is true and complete to the best of my knowledge and belief.*

Name *R. Bentley*  
 Position  
**Agent**  
 Company  
**Stoltz, Wagner & Brown**  
 Date  
**September 4, 1974**

*I hereby certify that the well location shown on this plat was plotted from field notes of actual surveys made by me or under my supervision, and that the same is true and correct to the best of my knowledge and belief.*

Date Surveyed \_\_\_\_\_

Registered Professional Engineer  
 and/or Land Surveyor

Certificate No. \_\_\_\_\_

0 330 660 990 1320 1650 1980 2310 2640 2000 1500 1000 500 0