

NEW MEXICO OIL CONSERVATION COMMISSION
Santa Fe, New Mexico

Form C-101
Revised (12/1/55)

NOTICE OF INTENTION TO DRILL

Notice must be given to the District Office of the Oil Conservation Commission and approval obtained before drilling or recompletion begins. If changes in the proposed plan are considered advisable, a copy of this notice showing such changes will be returned to the sender. Submit this notice in **QUINTUPLICATE**. One copy will be returned following approval. See additional instructions in Rules and Regulations of the Commission. If State Land submit 6 Copies Attach Form C-128 in triplicate to first 3 copies of form C-101

Amarillo, Texas
(Place)

February 25, 1957
(Date)

OIL CONSERVATION COMMISSION
SANTA FE, NEW MEXICO

Gentlemen:

You are hereby notified that it is our intention to commence the Drilling of a well to be known as
Oil Development Company of Texas

Santa Fe Pacific Railroad Company
(Lease)

(Company or Operator)

1-23

0

(Unit)

located 330 feet from the South line and 2310 feet from the East line of Section 23, T 9 S, R 36 E, NMPM.

(GIVE LOCATION FROM SECTION LINE)

Crossroads

Pool,

Lee

County

If State Land the Oil and Gas Lease is No.

If patented land the owner is Santa Fe Pacific Railroad Company

Address 900 Polk Street, Amarillo, Texas

We propose to drill well with drilling equipment as follows: Rotary Drilling Rig

The status of plugging bond is Indemnity Insurance Company of North America, Filed and approved 7-8-53, and now in effect.

Drilling Contractor Unknown

We intend to complete this well in the Devonian

formation at an approximate depth of 12,200 feet.

CASING PROGRAM

We propose to use the following strings of Casing and to cement them as indicated:

Size of Hole	Size of Casing	Weight per Foot	New or Second Hand	Depth	Sacks Cement
<u>17-1/2"</u>	<u>13-3/8"</u>	<u>48#</u>	<u>New</u>	<u>350</u>	<u>350</u>
<u>12-1/4"</u>	<u>9-5/8"</u>	<u>36# & 40#</u>	<u>New</u>	<u>4500</u>	<u>1800</u>
<u>7-7/8"</u>	<u>5-1/2"</u>	<u>23#, 20# & 17#</u>	<u>New</u>	<u>12,200</u>	<u>1800 plus</u>

If changes in the above plans become advisable we will notify you immediately.

ADDITIONAL INFORMATION (If recompletion give full details of proposed plan of work.)

Approved....., 19.....
Except as follows:

OIL CONSERVATION COMMISSION

By

E. J. Fischer

Sincerely yours,

Oil Development Company of Texas

(Company or Operator)

By

John C. Majors
Position General Superintendent

Send Communications regarding well to

Name E. A. Paschal

Address 900 Polk Street
Amarillo, Texas

NEW MEXICO
OIL CONSERVATION COMMISSION

Form C-128

Well Location and/or Gas Proration Plat

Date 2-22-1957

Operator Oil Development Co. of Texas Lease Santa Fe Pacific Railroad

Well No. 1-23 Section 23 Township 9 South Range 36 East NMPM

Located 2310 Feet From East Line, 330 Feet From South Line,

Lea County, New Mexico. G. L. Elevation 4021.5

Name of Producing Formation Devonian Pool Crossroads Dedicated Acreage 40 ac

(Note: All distances must be from outer boundaries of Section)

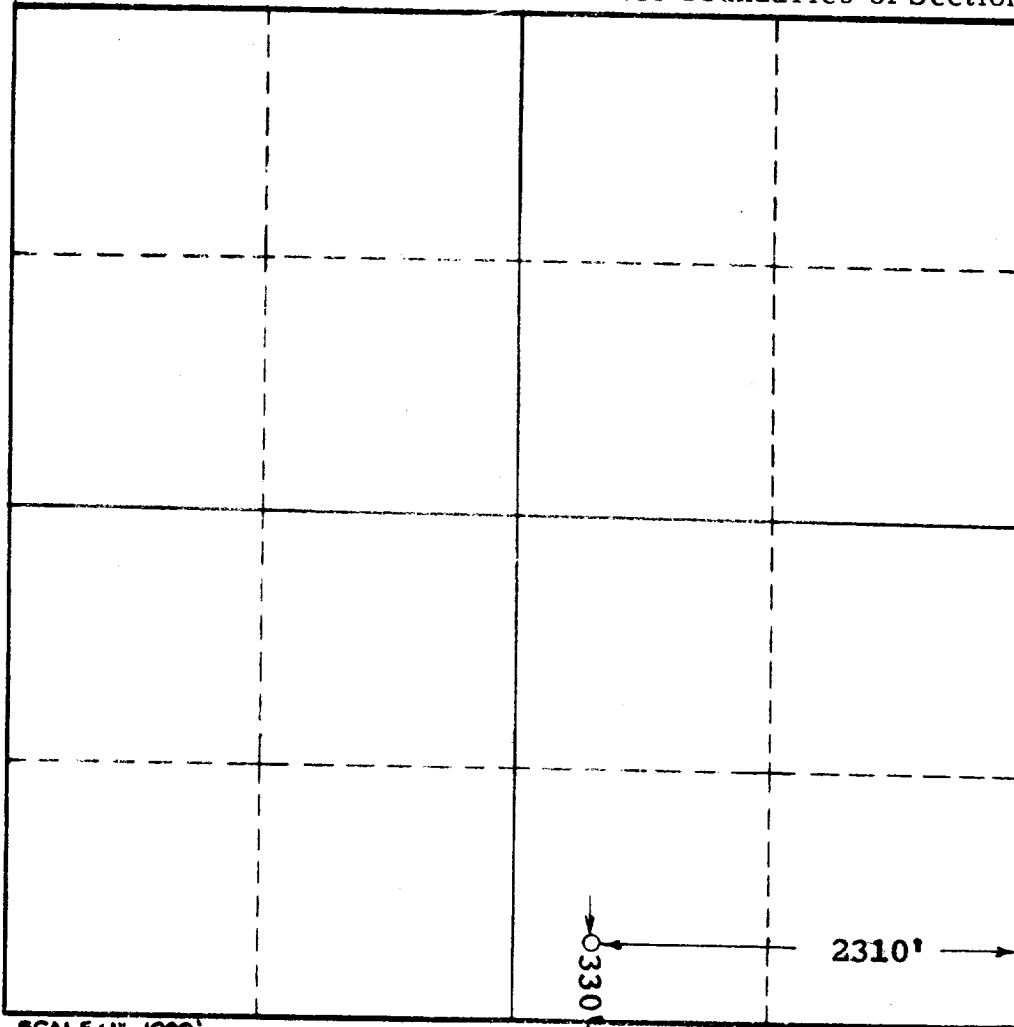

1. Is this Well a Dual Comp. ? Yes No X
2. If the answer to Question 1 is yes, are there any other dually completed wells within the dedicated acreage? Yes No

This is to certify that the above plat was prepared from field notes of actual surveys made by me or under my supervision and that the same are true and correct to the best of my knowledge and belief.

Name
Position
Representing
Address

Date Surveyed 2-22-1957
John W. West
Registered Professional Engineer and/or
Land Surveyor

OIL DEVELOPMENT COMPANY OF TEXAS

900 POLK STREET
AMARILLO, TEXAS

OFFICE OF MANAGER OF PRODUCTION, AM 10 23

February 26, 1957

SFPRR 1-23

New Mexico Oil Conservation Commission
Hobbs, New Mexico

Gentlemen:

Enclosed please find Form C-101 Notice of Intention To Drill in quintuplicate with Form C-128 attached to 3 copies thereof for a well this company proposes to drill 330' from the south line and 2310' from the east line of Section 23, Township 9 South, Range 36 East in the Crossroads Pool of Lea County, New Mexico. This well will be known as Santa Fe Pacific Railroad Company Well No. 1-23 located in Unit 0 of this section.

This Santa Fe Pacific Railroad lease lies across the section line with 160 acres in Section 23-9S-36E and 160 acres in Section 26-9S-36E. At the present time there are 2 wells producing from the Devonian formation of the Crossroads Field on the portion of this lease that lies in Section 26. Inasmuch as the royalty owners and leasehold owners are common under this lease, it is our intention to produce this well, SFPRR 1-23, into the tank battery located in Section 26 and now serving SFPRR Wells No. 1-26 and No. 2-26.

Yours very truly,

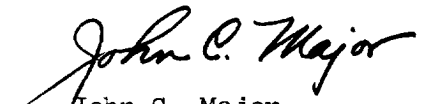
John C. Major,
General Superintendent

JCM/mb
Encl.

cc: Mr. Bill M. Sewell
Whiteface, Texas