

NEW MEXICO OIL CONSERVATION COMMISSION  
WELL LOCATION AND ACREAGE DEDICATION PLAT

SEE INSTRUCTIONS FOR COMPLETING THIS FORM ON THE REVERSE SIDE

SECTION A

|   |  |                             |                             |                                       |                      |
|---|--|-----------------------------|-----------------------------|---------------------------------------|----------------------|
| Operator<br><b>I. W. LOVELADY</b>   |  |                             | Lease<br><b>WHITE</b>       |                                       | Well No.<br><b>2</b> |
| Unit Letter<br><b>1</b>   | Section<br><b>15</b>                     | Township<br><b>10 SOUTH</b> | Range<br><b>32 EAST</b>     | County<br><b>LEA</b>                  |                      |
| Actual Footage Location of Well:<br><b>1650</b> feet from the <b>SOUTH</b> line and <b>330</b> feet from the <b>EAST</b> line |  |                             |                             |                                       |                      |
| Ground Level Elev.  | Producing Formation<br><b>San Andres</b> |                             | Pool<br><b>Indesignated</b> | Dedicated Acreage:<br><b>40</b> Acres |                      |

1. Is the Operator the only owner in the dedicated acreage outlined on the plat below? YES ☒ NO ☐ ("Owner" means the person who has the right to drill into and to produce from any pool and to appropriate the production either for himself or for himself and another. (65-3-29 (a) NMSA 1935 Comp.)
2. If the answer to question one is "no," have the interests of all the owners been consolidated by communitization agreement or otherwise? YES ☐ NO ☐ If answer is "yes," Type of Consolidation \_\_\_\_\_
3. If the answer to question two is "no," list all the owners and their respective interests below:

| Owner | Land Description |
|-------|------------------|
|       |                  |
|       |                  |

SECTION B

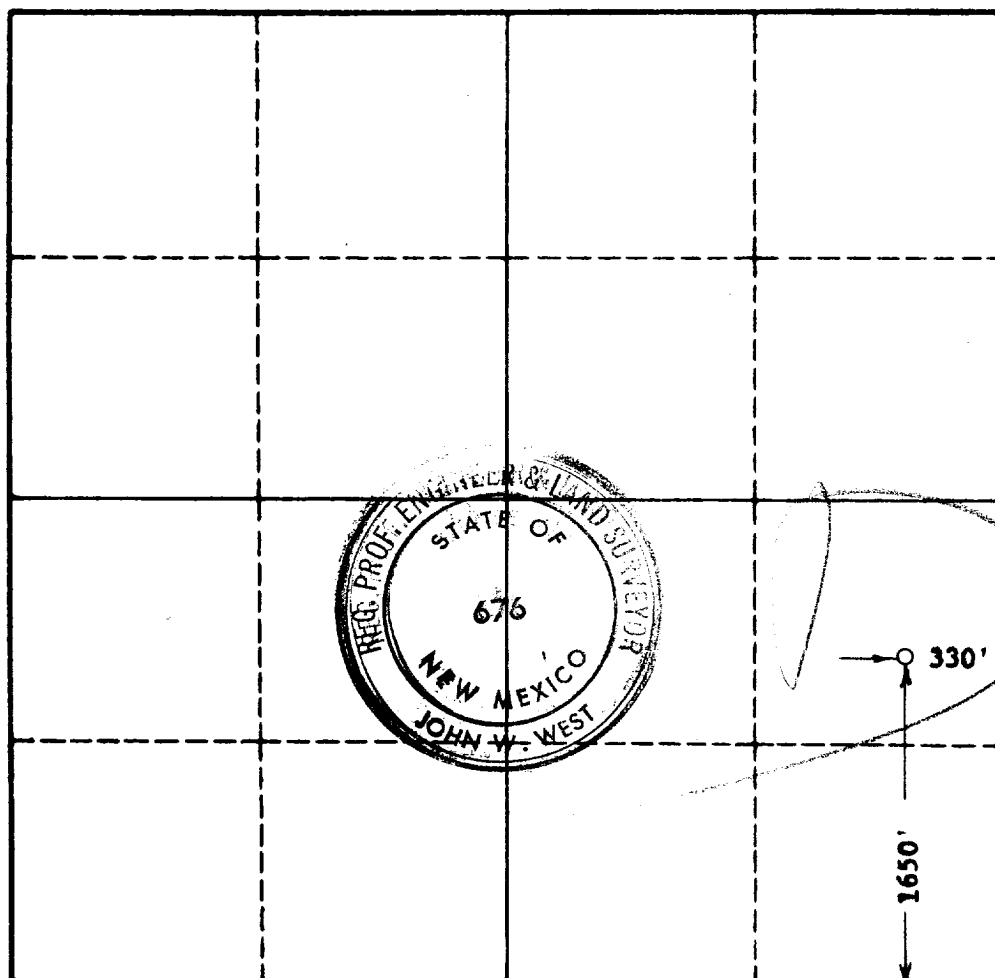

CERTIFICATION

I hereby certify that the information in SECTION A above is true and complete to the best of my knowledge and belief.

Name *Edward J. Smith*  
Position \_\_\_\_\_  
Agent \_\_\_\_\_  
Company \_\_\_\_\_  
**I. W. Lovelady**  
Date **June 24, 1964**

I hereby certify that the well location shown on the plat in SECTION B was plotted from field notes of actual surveys made by me or under my supervision, and that the same is true and correct to the best of my knowledge and belief.

Date Surveyed **JUNE 20, 1964**  
Registered Professional Engineer and/or Land Surveyor, **JOHN W. WEST**  
*John W. West*  
Certificate No. **N.M. - P.E. & L.S. NO. 676**

|                           |         |
|---------------------------|---------|
| NUMBER OF COPIES RECEIVED |         |
| DISTRIBUTION              |         |
| SANTA FE                  |         |
| FILE                      |         |
| U.S.G.S.                  |         |
| LAND OFFICE               |         |
| TRANSPORTER               | OIL GAS |
| PROGRATION OFFICE         |         |
| OPERATOR                  |         |

NEW MEXICO OIL CONSERVATION COMMISSION  
Santa Fe, New Mexico

Form 101  
Revised (2/7/55)  
JUN 19 10 24 AM '64  
O.C.C.

# NOTICE OF INTENTION TO DRILL

Notice must be given to the District Office of the Oil Conservation Commission and approval obtained before drilling or recompletion begins. If changes in the proposed plan are considered advisable, a copy of this notice showing such changes will be returned to the sender. Submit this notice in **QUINTUPLICATE**. One copy will be returned following approval. See additional instructions in Rules and Regulations of the Commission. If State Land submit 6 Copies Attach Form C-128 in triplicate to first 3 copies of form C-101

Midland, Texas

June 18, 1964

(Place)

(Date)

OIL CONSERVATION COMMISSION  
SANTA FE, NEW MEXICO

Gentlemen:

You are hereby notified that it is our intention to commence the Drilling of a well to be known as  
**I. W. Lovelady**

(Company or Operator)

White

(Lease)

Well No. **2**, in **I** (Unit) The well is

located **1650** feet from the **South** line and **660** feet from the **East** line of Section **15**, T. **10S**, R. **32E**, NMPM.

(GIVE LOCATION FROM SECTION LINE) **Wheeler** Pool, **Lea** County

If State Land the Oil and Gas Lease is No. **OG-124**

If patented land the owner is

Address

We propose to drill well with drilling equipment as follows: **Rotary**

The status of plugging bond is **Blanket Bond**

Drilling Contractor **Converlin Drilling Inc.**  
**Box 3468, Odessa, Texas**

We intend to complete this well in the **San Andres** formation at an approximate depth of **4400** feet.

## CASING PROGRAM

We propose to use the following strings of Casing and to cement them as indicated:

| Size of Hole | Size of Casing | Weight per Foot | New or Second Hand | Depth | Sacks Cement    |
|--------------|----------------|-----------------|--------------------|-------|-----------------|
| 11           | 8 5/8          | 24              | new                | 250   | 100 (circulate) |
| 7 7/8        | 4 1/2          | 9.5             | new                | 4400  | 150             |
|              |                |                 |                    |       |                 |
|              |                |                 |                    |       |                 |

If changes in the above plans become advisable we will notify you immediately.

ADDITIONAL INFORMATION (If recompletion give full details of proposed plan of work.)

Approved **JUN 19 1964**, 19.....  
Except as follows:

Sincerely yours,

**I. W. Lovelady**

(Company or Operator)

By **[Signature]**

Position **Agent**

Send Communications regarding well to

Name **I. W. Lovelady**

Address **Agent**

OIL CONSERVATION COMMISSION

By **[Signature]** Engineer District

HOBBS OFFICE O. C.  
Jun 19 1964  
FORM 10-28  
Revised 5/1/64

NEW MEXICO OIL CONSERVATION COMMISSION  
WELL LOCATION AND ACREAGE DEDICATION PLAT

SEE INSTRUCTIONS FOR COMPLETING THIS FORM ON THE REVERSE SIDE

SECTION A

|   |  |                             |                             |                                       |
|---|--|-----------------------------|-----------------------------|---------------------------------------|
| Operator<br><b>I. W. LOVELADY</b>   |  | Lease<br><b>WHITE</b>       |                             | Well No.<br><b>2</b>                  |
| Unit Letter<br><b>I</b>   | Section<br><b>15</b>                     | Township<br><b>10 SOUTH</b> | Range<br><b>32 EAST</b>     | County<br><b>LEA</b>                  |
| Actual Footage Location of Well:<br><b>1650</b> feet from the <b>SOUTH</b> line and <b>660</b> feet from the <b>EAST</b> line |  |                             |                             |                                       |
| Ground Level Elev.  | Producing Formation<br><b>San Andres</b> |                             | Pool<br><b>Undesignated</b> | Dedicated Acreage:<br><b>40</b> Acres |

1. Is the Operator the only owner in the dedicated acreage outlined on the plat below? YES ☒ NO ☐ ("Owner" means the person who has the right to drill into and to produce from any pool and to appropriate the production either for himself or for himself and another. (65-3-29 (e) NMSA 1935 Comp.)
2. If the answer to question one is "no," have the interests of all the owners been consolidated by communitization agreement or otherwise? YES ☐ NO ☐ If answer is "yes," Type of Consolidation \_\_\_\_\_
3. If the answer to question two is "no," list all the owners and their respective interests below:

| Owner | Land Description |
|-------|------------------|
|       |                  |
|       |                  |

SECTION B

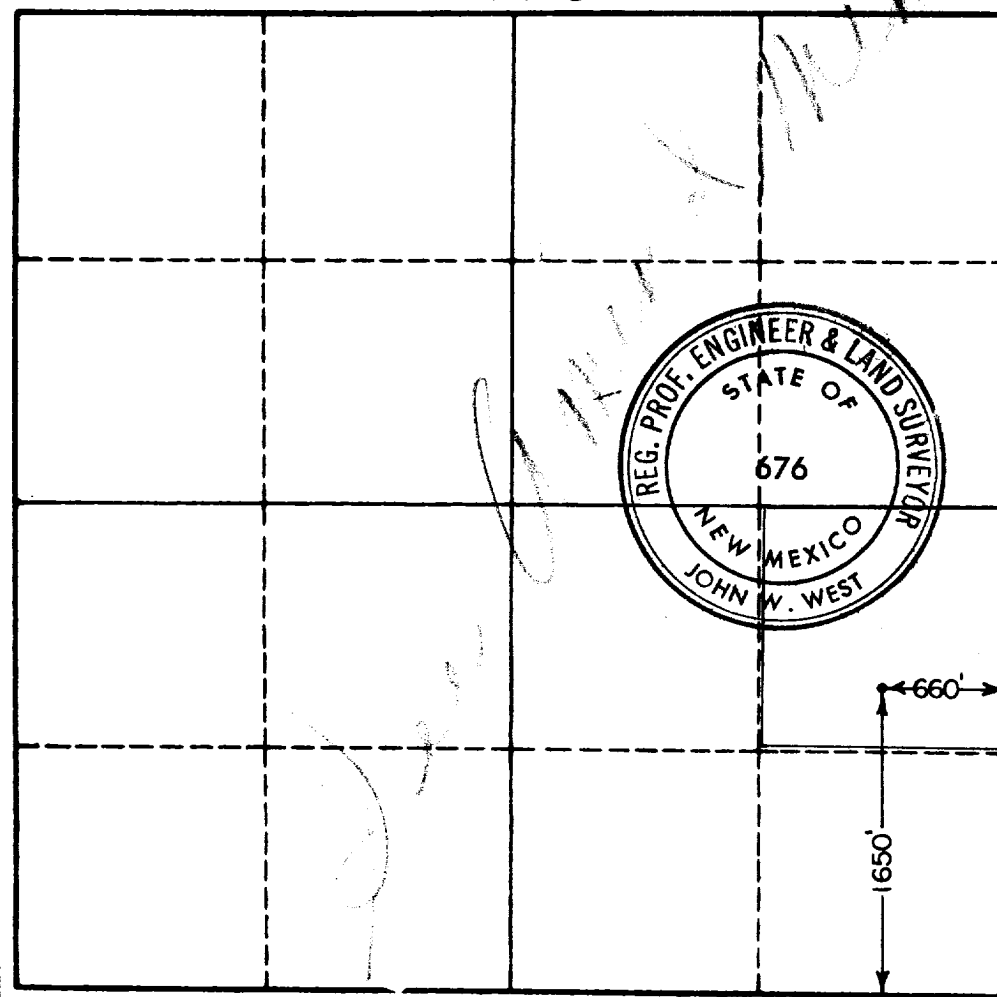

CERTIFICATION

I hereby certify that the information in SECTION A above is true and complete to the best of my knowledge and belief.

|                                  |
|----------------------------------|
| Name<br><i>Edward Smith</i>      |
| Position<br><b>Agent</b>         |
| Company<br><b>I. W. Lovelady</b> |
| Date<br><b>6/17/64</b>           |

I hereby certify that the well location shown on the plat in SECTION B was plotted from field notes of actual surveys made by me or under my supervision, and that the same is true and correct to the best of my knowledge and belief.

|   |
|---|
| Date Surveyed<br><b>JUNE 12, 1964</b>   |
| Registered Professional Engineer and/or Land Surveyor, <b>JOHN W. WEST</b><br><i>John W. West</i> |
| Certificate No.<br><b>N. M. - P. E. &amp; L. S. NO. 676</b>                                       |