

DEC 23 10 23 AM '65

NEW MEXICO OIL CONSERVATION COMMISSION

Form C-101
Revised 1-1-65

NO. OF COPIES RECEIVED	
DISTRIBUTION	
SANTA FE	
FILE	
U.S.G.S.	
LAND OFFICE	
OPERATOR	

5A. Indicate Type of Lease

STATE ☒ FEE ☐

5. State Oil & Gas Lease No.

K-596

APPLICATION FOR PERMIT TO DRILL, DEEPEN, OR PLUG BACK

1a. Type of Work

DRILL ☒DEEPEN ☐PLUG BACK ☐

b. Type of Well

OIL
WELL ☐GAS
WELL ☒

OTHER

SINGLE
ZONE ☒MULTIPLE
ZONE ☐

2. Name of Operator

W. K. Byrom

3. Address of Operator

Box 147 - Hobbs, New Mexico 88240

4. Location of Well

UNIT LETTER P LOCATED 660 FEET FROM THE South LINEAND 660FEET FROM THE East LINE OF SEC. 4 TWP. 10S RGE. 36E NMPM

7. Unit Agreement Name

8. Farm or Lease Name

State A

9. Well No.

1

10. Field and Pool or Well Unit
S. Crossroads San Andres

12. County

Lea

19. Proposed Depth

5000'

19A. Formation

San Andres

20. Rotary or C.T.

Rotary

21. Elevations (Show whether DF, RT, etc.)

4021 Ground Level

21A. Kind & Status Plug. Bond

Bond in force.

21B. Drilling Contractor

Verna Drilling Co.

22. Approx. Date Work will start

December 27, 1965

23.

PROPOSED CASING AND CEMENT PROGRAM

SIZE OF HOLE	SIZE OF CASING	WEIGHT PER FOOT	SETTING DEPTH	SACKS OF CEMENT	EST. TOP
11"	8-5/8"	28#	300'	150	Circulated
6-3/4"	2-7/8"	6.50#	5000'	300	2700'

12-27-65: We will drill 300' of 11" hole and run 8-5/8" 28# casing. This string will be cemented with 150 sacks regular cement + 2% calcium chloride. Cement to be circulated to surface.

The production string will be 2-7/8" 6.50# J-55 tubing in a 6-3/4" hole. We propose to cement the production string with 100 sacks of class C 50-50 posmix, 8# salt, 3/4% CFR-2 and 200 sacks 50-50 regular 10% gel, 10# salt, this is enough cement to tie back to the base of the salt.

RECEIVED
DEC 23 1965
HOBBS OFFICE

EXPIRES

3/24/66

IN ABOVE SPACE DESCRIBE PROPOSED PROGRAM: IF PROPOSAL IS TO DEEPEN OR PLUG BACK, GIVE DATA ON PRESENT PRODUCTIVE ZONE AND PROPOSED NEW PRODUCTIVE ZONE. GIVE BLOWOUT PREVENTER PROGRAM, IF ANY.

I hereby certify that the information above is true and complete to the best of my knowledge and belief.

Signed W. K. Byrom Title Geologist Date 12-23-65

(This space for State Use)

APPROVED BY _____ TITLE _____ DATE _____

CONDITIONS OF APPROVAL, IF ANY:

NEW MEXICO OIL CONSERVATION COMMISSION
WELL LOCATION AND ACREAGE DEDICATION PLAT

Form C-102
Supersedes C-128
Effective 1-1-61

HOBBS OFFICE O. C. C.

All distances must be from the outer boundaries of the Section.

Operator W. K. BYROM			Lease STATE A DEC 23 10 23 AM '65		Well No. 1
Unit Letter P	Section 4	Township 10 SOUTH	Range 36 EAST	County LEA	
Actual Footage Location of Well: 660 feet from the SOUTH line and 660 feet from the EAST line					
Ground Level Elev. 4021.0	Producing Formation		Pool	Dedicated Acreage: Acres	

1. Outline the acreage dedicated to the subject well by colored pencil or hatchure marks on the plat below.
2. If more than one lease is dedicated to the well, outline each and identify the ownership thereof (both as to working interest and royalty).
3. If more than one lease of different ownership is dedicated to the well, have the interests of all owners been consolidated by communitization, unitization, force-pooling, etc?

☐ Yes ☐ No If answer is "yes," type of consolidation _____

If answer is "no," list the owners and tract descriptions which have actually been consolidated. (Use reverse side of this form if necessary.) _____

No allowable will be assigned to the well until all interests have been consolidated (by communitization, unitization, forced-pooling, or otherwise) or until a non-standard unit, eliminating such interests, has been approved by the Commission.

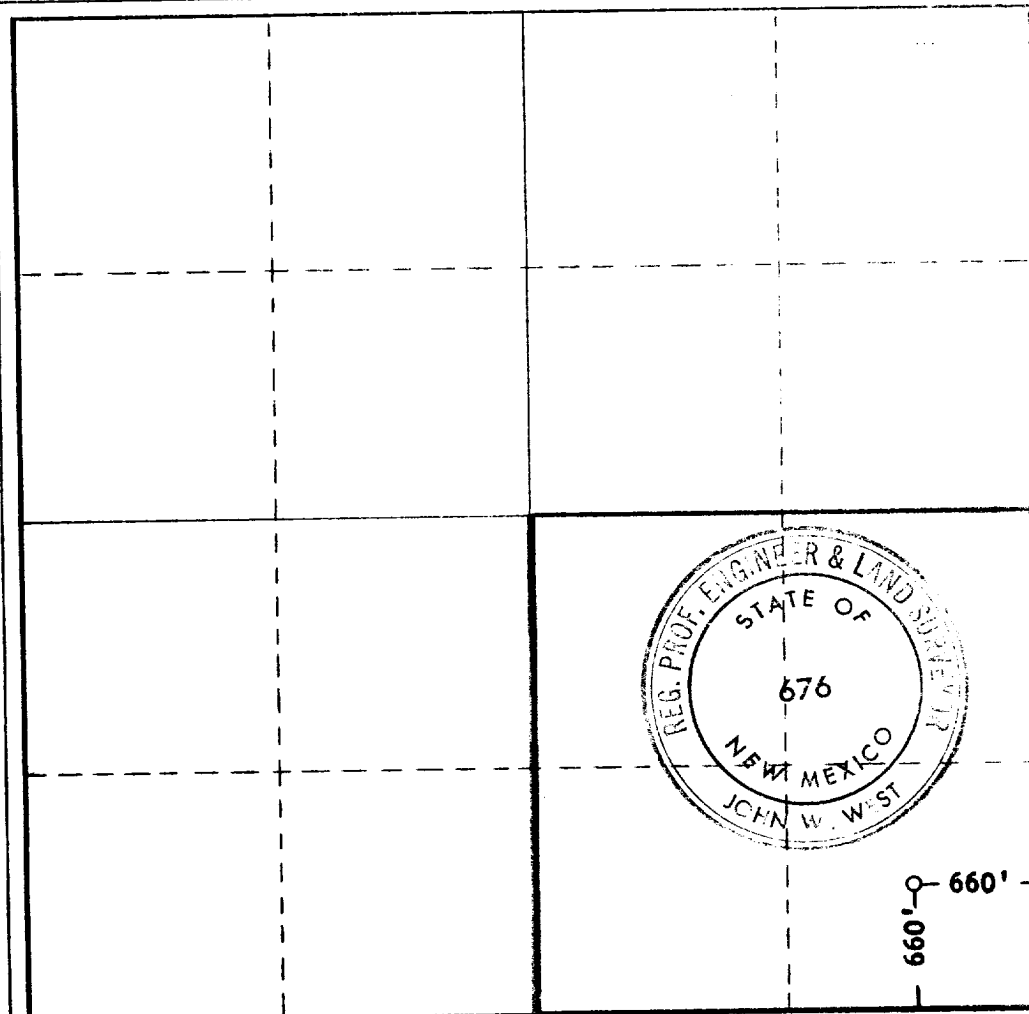

CERTIFICATION

I hereby certify that the information contained herein is true and complete to the best of my knowledge and belief.

Name *W. K. Byrom*
 Title *Geologist*
 Company *W. K. Byrom*
 Date *12-15-65*

I hereby certify that the well location shown on this plat was plotted from field notes of actual surveys made by me or under my supervision, and that the same is true and correct to the best of my knowledge and belief.

Date Surveyed
DEC. 13, 1965

Registered Professional Engineer and/or Land Surveyor

John W. West
 Certificate No. **676**

