

NO. OF COPIES RECEIVED	
DISTRIBUTION	
SANTA FE	
FILE	
U.S.G.S.	
LAND OFFICE	
OPERATOR	

HOBBS OFFICE O.C.C. NEW MEXICO OIL & GAS COMMISSION  
HOBBS OFFICE O.C.C. NEW MEXICO OIL & GAS COMMISSION  
MAR 31 11 00 AM '66 MAR 25 11 09 AM '66

Form C-101  
Revised 1-1-65

5A. Indicate Type of Lease STATE <input checked="" type="checkbox"/> FEE <input type="checkbox"/>
5. State Oil & Gas Lease No. <b>K-956 &amp; K-5471</b>
7. Unit Agreement Name
8. Farm or Lease Name <b>State B</b>
9. Well No. <b>1</b>
10. Field and Pool, or Wildcat <b>S. Crossroad San Andres</b>
12. County <b>Lea</b>
19. Proposed Depth <b>5000</b>
19A. Formation <b>San Andres</b>
20. Rotary or C.T. <b>Rotary</b>
21. Elevations (Show whether DF, RT, etc.) <b>4017.1</b>
21A. Kind & Status Plug. Bond <b>Blanket Drlg. In Force Verna Drilling Co.</b>
21B. Drilling Contractor
22. Approx. Date Work will start <b>March 28, 1966</b>

### APPLICATION FOR PERMIT TO DRILL, DEEPEN, OR PLUG BACK

1a. Type of Work DRILL <input checked="" type="checkbox"/> DEEPEN <input type="checkbox"/> PLUG BACK <input type="checkbox"/>
b. Type of Well OIL WELL <input type="checkbox"/> GAS WELL <input checked="" type="checkbox"/> OTHER <input type="checkbox"/> SINGLE ZONE <input checked="" type="checkbox"/> MULTIPLE ZONE <input type="checkbox"/>
2. Name of Operator <b>W. K. Byrom</b>
3. Address of Operator <b>P. O. Box 147 - Hobbs, New Mexico 88240</b>
4. Location of Well UNIT LETTER <b>I</b> LOCATED <b>1980</b> FEET FROM THE <b>South</b> LINE AND <b>660</b> FEET FROM THE <b>East</b> LINE OF SEC. <b>9</b> TWP. <b>10S</b> RGE. <b>36E</b> NMPM
21. Elevations (Show whether DF, RT, etc.) <b>4017.1</b>
21A. Kind & Status Plug. Bond <b>Blanket Drlg. In Force Verna Drilling Co.</b>
21B. Drilling Contractor
22. Approx. Date Work will start <b>March 28, 1966</b>

23.

### PROPOSED CASING AND CEMENT PROGRAM

SIZE OF HOLE	SIZE OF CASING	WEIGHT PER FOOT	SETTING DEPTH	SACKS OF CEMENT	EST. TOP
11"	8-5/8"	28#	300'	150	Circulated
7-7/8"	4-1/2"	10.5#	5000'	400	2700

3-28-66: We will run 300' of 8-5/8" 28# used casing in a 11" hole and cement it with 150 sacks of regular cement with 2% calcium chloride. The cement will be circulated to surface. From surface pipe to TD we propose to drill a 7-7/8" hole and run 4-1/2" 10.5# casing. We will cement the producing string with 100 sacks of class C 50-50 pozzol, 8# salt, 3/4% CFB-2 and 300 sacks 50-50 regular 10% gel, 10# salt, this is enough cement to tie back to the base of the salt.

APPROVED  
FOR 90 DAYS UNLESS  
DRILLING COMMENCED.

4-1-66

IN ABOVE SPACE DESCRIBE PROPOSED PROGRAM: IF PROPOSAL IS TO DEEPEN OR PLUG BACK, GIVE DATA ON PRESENT PRODUCTIVE ZONE AND PROPOSED NEW PRODUCTIVE ZONE. GIVE BLOWOUT PREVENTER PROGRAM, IF ANY.

I hereby certify that the information above is true and complete to the best of my knowledge and belief.

Signed \_\_\_\_\_ Title **Geologist** Date **3-22-66**

(This space for State Use)

APPROVED BY \_\_\_\_\_ TITLE \_\_\_\_\_ DATE \_\_\_\_\_

CONDITIONS OF APPROVAL, IF ANY:

NEW MEXICO OIL CONSERVATION COMMISSION  
WELL LOCATION AND ACREAGE DEDICATION PLAT  
HOBBS OFFICE O. C. C. HOBBS OFFICE O. C. C.

Form C-102  
Supersedes C-128  
Effective 1-1-65

All distances must be from the outer boundaries of the Section.

Operator <b>W. K. BYROM</b>		Date <b>MAR 31 11 01 AM '66</b>		State <b>MAR 25 11 10 AM '66</b>		Well No. <b>1</b>
Unit Letter <b>I</b>	Section <b>9</b>	Township <b>10 SOUTH</b>	Range <b>36 EAST</b>	County <b>LEA</b>		
Actual Footage Location of Well: <b>1980</b> feet from the <b>SOUTH</b> line and <b>660</b> feet from the <b>EAST</b> line						
Ground Level Elev. <b>4017.1</b>	Producing Formation <b>San Andres</b>		Pool <b>S. Crossroads San Andres</b>		Dedicated Acreage <b>160</b> Acres	

1. Outline the acreage dedicated to the subject well by colored pencil or hatchure marks on the plat below.
2. If more than one lease is dedicated to the well, outline each and identify the ownership thereof (both as to working interest and royalty).
3. If more than one lease of different ownership is dedicated to the well, have the interests of all owners been consolidated by communitization, unitization, force-pooling, etc?

☐ Yes ☐ No If answer is "yes," type of consolidation \_\_\_\_\_

If answer is "no," list the owners and tract descriptions which have actually been consolidated. (Use reverse side of this form if necessary.) \_\_\_\_\_

No allowable will be assigned to the well until all interests have been consolidated (by communitization, unitization, forced-pooling, or otherwise) or until a non-standard unit, eliminating such interests, has been approved by the Commission.

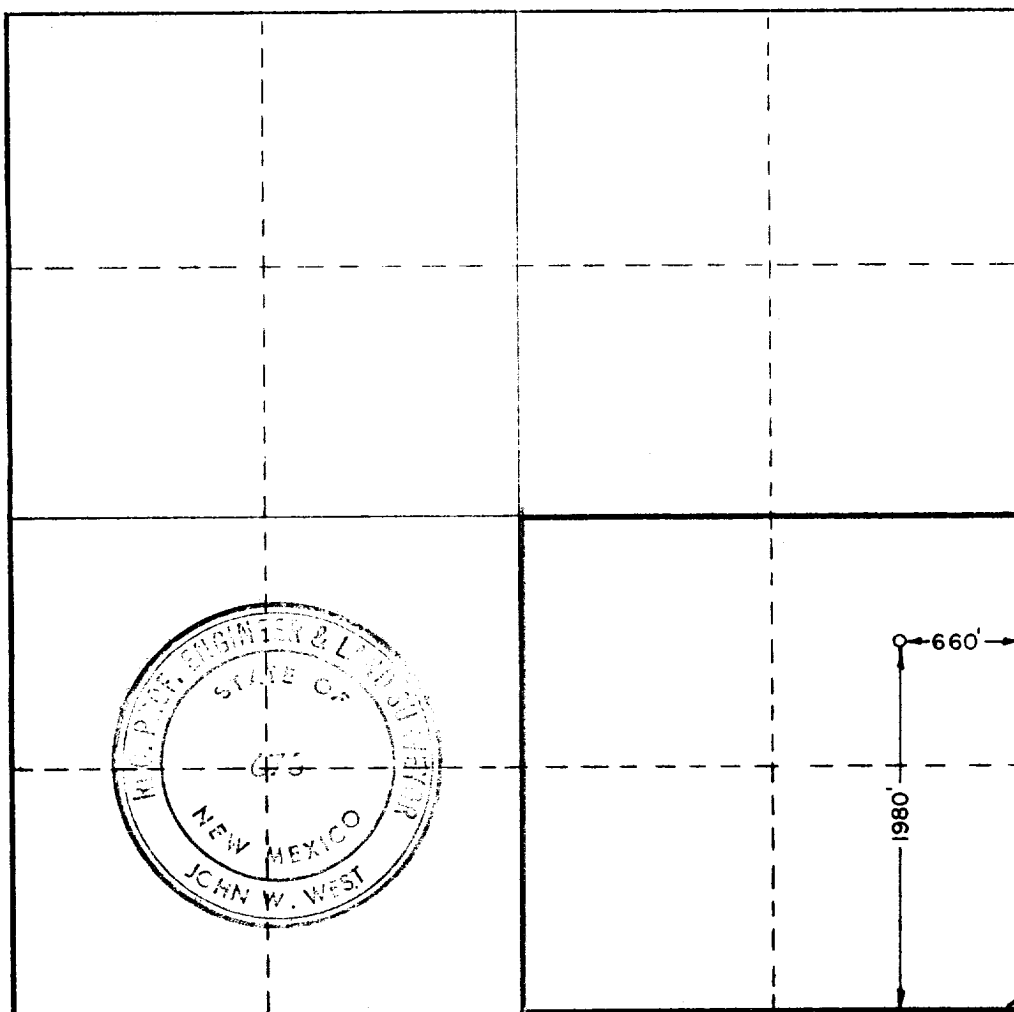

CERTIFICATION

I hereby certify that the information contained herein is true and complete to the best of my knowledge and belief.

Name  
**Geologist**

Position  
**W. K. Byrom**

Company

Date  
**3-30-66**

I hereby certify that the well location shown on this plat was plotted from field notes of actual surveys made by me or under my supervision, and that the same is true and correct to the best of my knowledge and belief.

Date Surveyed  
**3/22/66**

Registered Professional Engineer and/or Land Surveyor

Certificate No.

**NM PE & LS NO. 676**