

COUNTY	LEA	FIELD	Bar-H	STATE	NM	MAP
OPR	HANKS, ROGER C., LTD.					
	1 Bridwell-State					
	Sec. 1, T-9-S, R-32-E					
	1980' FNL, 1980' FEL of Sec.					
	Spd 3-2-67					
	Cmp 5-26-67					
	CLASS		EL			
	FORMATION	DATUM	FORMATION	DATUM		
CSG & SX - TUBING						
11 3/4" 305' 300 Sx						
8 5/8" 3650' 300 Sx						
5 1/2" 9417' 340 CF						
LOGS EL GR RA IND HC A	TD 9417'					

Penn. Perfs 9138-42' Pmpd 105 BOPD + 687 BW. Pot. Based on 24 hr test, gravity 47., GOR TSTM.

Distribution limited and publication prohibited by subscribers' agreement.
Reproduction rights reserved by Williams & Lee Scouting Service, Inc.

CONT. Ard
DATE

PROP DEPTH 9300' TYPE RT

F.R. 2-16-67; Opr's Elev. 4411
PD 9300' - Bough "C"
Contr. - Ard
5-4-67 AMEND OPERATOR & LEASE NAME: Formerly Hanks,
Roger C. Ltd. #1 State "A"
5-25-67 AMEND OPERATOR: Formerly Lario Oil & Gas Co.
3-7-67 TD 3650', rng 8 5/8" casing.
3-14-67 Drlg. 5415'.
Cored 4350-90', rec 24.6' being:
4.6' frac dolo., sucrosic, tr. large vuggs,
fair bldg oil;
5' dns dolo., tr. fracs & PPP;
1' dns dolo., tr. fracs & PPP, bldg gas;
2' dns sli frac dolo., tr. bldg oil;
10' frac dolo., PPP & scatt small vuggs, fair
bldg oil;
2' frac dolo., PPP & scatt small vuggs, sul odor.

3-14-67

Cont.

DST 4335-90', open 30 mins,
rec 160' Sli O&GCM,
30 min ISIP 1358#, FP 98-118#,
1 hr FSIP 1358#.

(Tool partially plugged)

DST 4330-90', open 30 mins,
Rec 125' Sli O&HCCM,
30 min ISIP 1358#, FP 98-276#,
30 min FSIP 1358#.

3-21-67

Drlg. 7800' sh.

3-28-67

Drlg. 8711' lm.

4-4-67

SH: San Andres 3620'
TD 9400', on DST 9370-9400'.
DST 9123-65', open 2 hrs,
GTS 3 mins @ 600 MCFGPD

4-11-67

Rec 180' HO&GCM + 970' OCM + 650' Salt Wtr,
1 hr ISIP 2388#, FP 216-793#,
2 hr FSIP 2388#.

DST 9174-9250', open 2 hrs,
Rec 180' mud + 6000' salt wtr,
30 min ISIP 3239#, FP 948-2820#,
30 min FSIP 3037#.

TD 9417', MORT

DST 9370-9400', open 1 hr,
rec 4700' gas in DP, 180' H G & Sli OCM, +
620' H GC Salt Wtr

1 hr ISIP 3540#, FP 197-375#,
30 min FSIP 3519#.

4-17-67

TD 9417', tight.

5-1-67

TD 9417', tight.

Perf 9135-42', 9145-48' W/1 SPF

Acid (9135-48') 250 gals (MA)

Flwd 4 BO + 84 B Salt Wtr in 13 hrs thru
1/4" chk., IF 400# (9135-48')

5-1-67 Cont.
Sqzd 9135-48' W/100 sx.
5-8-67 TD 9417', WOO.
Perf @ 9138', 9139', 9140', 9141', 9142'
W/2 SPI
Acid (9138-42') 250 gals (MA)
Swbd 116 BW, w/tr. oil in 8 hrs (9138-42')
5-15-67 TD 9417', RU Kobe Pump.
5-22-67 TD 9417', RU Kobe Pump.
5-31-67 TD 9417', RU Kobe Pump
6-5-67 TD 9417', TOP
Pmpd 87 BO + 756 BW in 24 hrs (9138-42')
6-12-67 TD 9417', TOP
6-19-67 TD 9417', TOP
6-26-67 TD 9417', WO Pot.
Pmpd 105 BO + 687 BW in 24 hrs.

7-3-67 TD 9417', COMPLETE.
LOG TOPS: Yates 2396', SA 3627', Gler
5028', Tubb 6500', Abo 7373', Wolfcamp
8533', Bough "C" 9122'.

**NEW MEXICO OIL CONSERVATION COMMISSION
WELL LOCATION AND ACREAGE DEDICATION PLAT**

Form 1-102
Supersedes C-128
Effective 1-1-65

All distances must be from the outer boundaries of the Section.

Operator Roger C. Hanks		Lease Aug 15, 1969		Well No. 1	
Unit Letter G	Section 1	Township 9S	Range 32E	County Lea	
Actual Footage Location of Well: 1980 feet from the North line and 1980 feet from the East line					
Ground Level Elev.	Producing Formation Bough "C"		Pool Bar U Pennsylvanian	Dedicated Acreage; 160 Acres	

1. Outline the acreage dedicated to the subject well by colored pencil or hachure marks on the plat below.
2. If more than one lease is dedicated to the well, outline each and identify the ownership thereof (both as to working interest and royalty).
3. If more than one lease of different ownership is dedicated to the well, have the interests of all owners been consolidated by communitization, unitization, force-pooling, etc?

☐ Yes ☐ No If answer is "yes," type of consolidation _____

If answer is "no," list the owners and tract descriptions which have actually been consolidated. (Use reverse side of this form if necessary.) _____

No allowable will be assigned to the well until all interests have been consolidated (by communitization, unitization, forced-pooling, or otherwise) or until a non-standard unit, eliminating such interests, has been approved by the Commission.

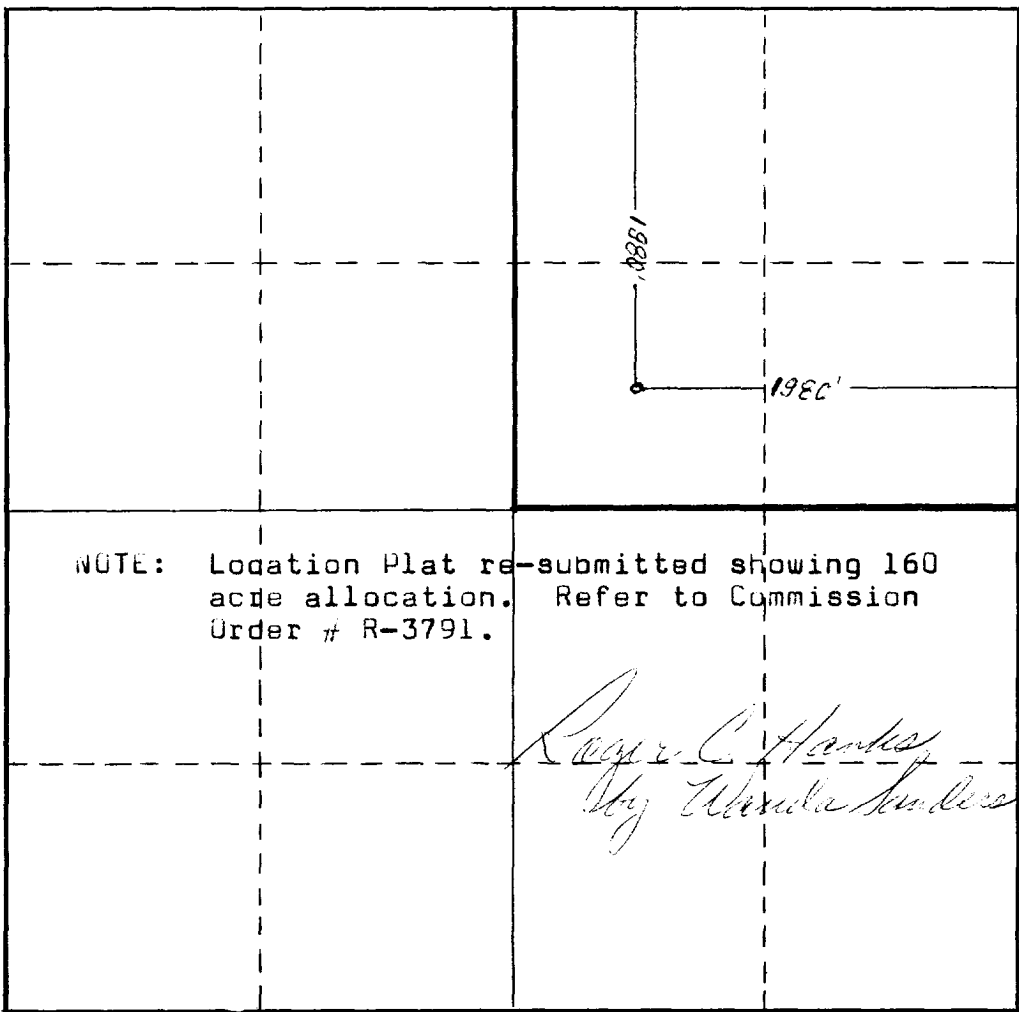

CERTIFICATION

I hereby certify that the information contained herein is true and complete to the best of my knowledge and belief.

Name *Wanda Sanders*
 Position **Secretary to Mr. Hanks**
 Company **Roger C. Hanks**
 Date **August 14, 1969**

I hereby certify that the well location shown on this plat was plotted from field notes of actual surveys made by me or under my supervision, and that the same is true and correct to the best of my knowledge and belief.

Date Surveyed _____

Registered Professional Engineer
and/or Land Surveyor

Certificate No. _____

